

FAP RTE.	SECTION	COUNTY	TOTAL SHEETS	SHEET NO.
331	3-2, 8X-1, 4-2	SALINE	220	28
STA.		TO STA.		
FED. ROAD DIST. NO.		ILLINOIS	FED. AID PROJECT	

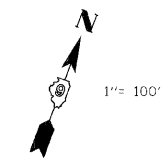

COORDINATE DATA			
STATION	NORTHING	EASTING	REMARKS
993+24.48	392,086.94	919,590.67	P.I. CURVE 20 ILL. 13 RELOCATION
964+76.35	390,223.10	917,437.08	P.C. CURVE 20 ILL. 13 RELOCATION
1019+28.73	392,086.05	922,438.81	P.T. CURVE 20 ILL. 13 RELOCATION

CURVE DATA								
CURVE	P.I. STATION	Δ	D	T	L	R	M	CHORD
20	993+24.48	40° 53' 34"	0° 45' 00"	2,848.13'	5,452.38'	7,639.44'	481.29'	5,337.39'

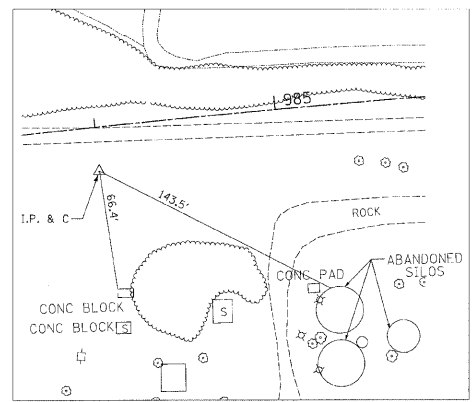
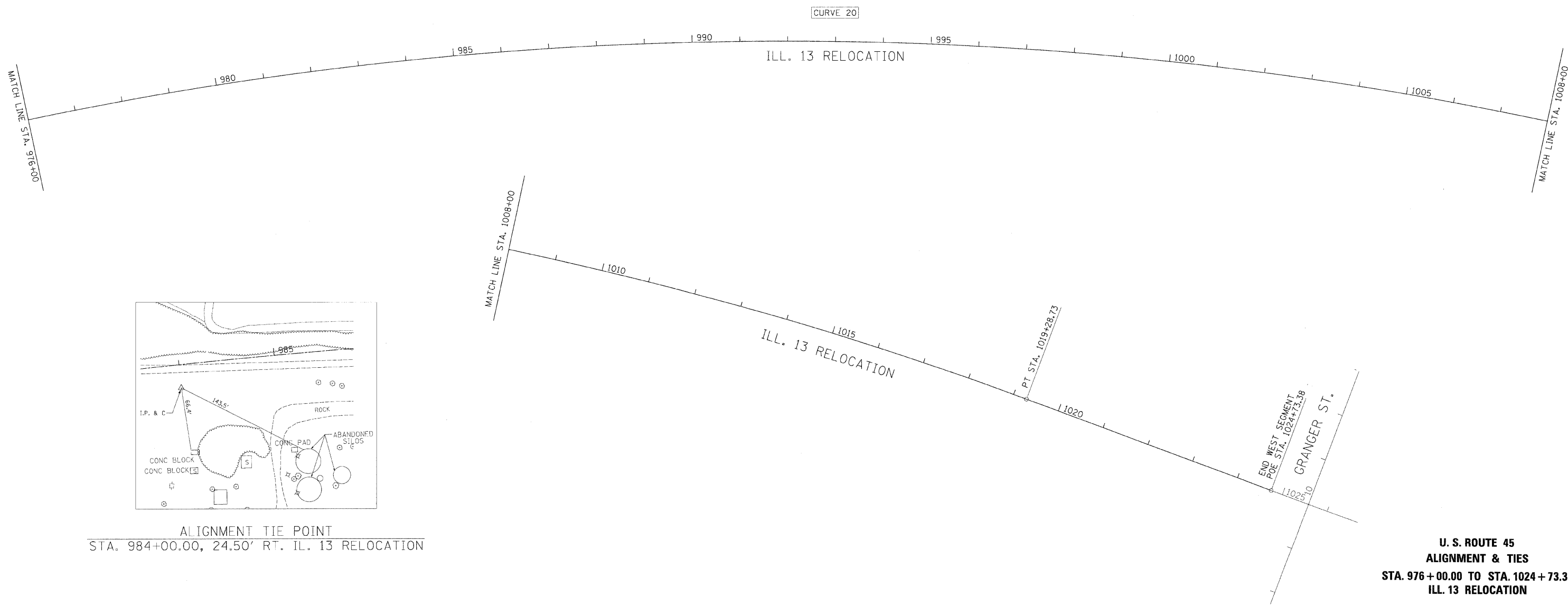

ALIGNMENT TIE POINT
STA. 984+00.00, 24.50' RT. IL. 13 RELOCATION

**U. S. ROUTE 45
ALIGNMENT & TIES
STA. 976 + 00.00 TO STA. 1024 + 73.38
ILL. 13 RELOCATION**

CHECKED BY: B/W PLOT DATE: 2/2/2009
DRAWN BY: DMS PLOT SCALE: 1/8"=1'-0"

M:\PROJECTS\PROJECTS\ROADWAY\COMMON\
Active File:
002-3266-00n