

BY	DATE
FINAL SURVEY	
PLOTTED	
NOTE BOOK	
AREAS CHECKED	
NO.	

BY	DATE
ORIGINAL SURVEY	
PLOTTED	
NOTE BOOK	
AREAS CHECKED	
NO.	

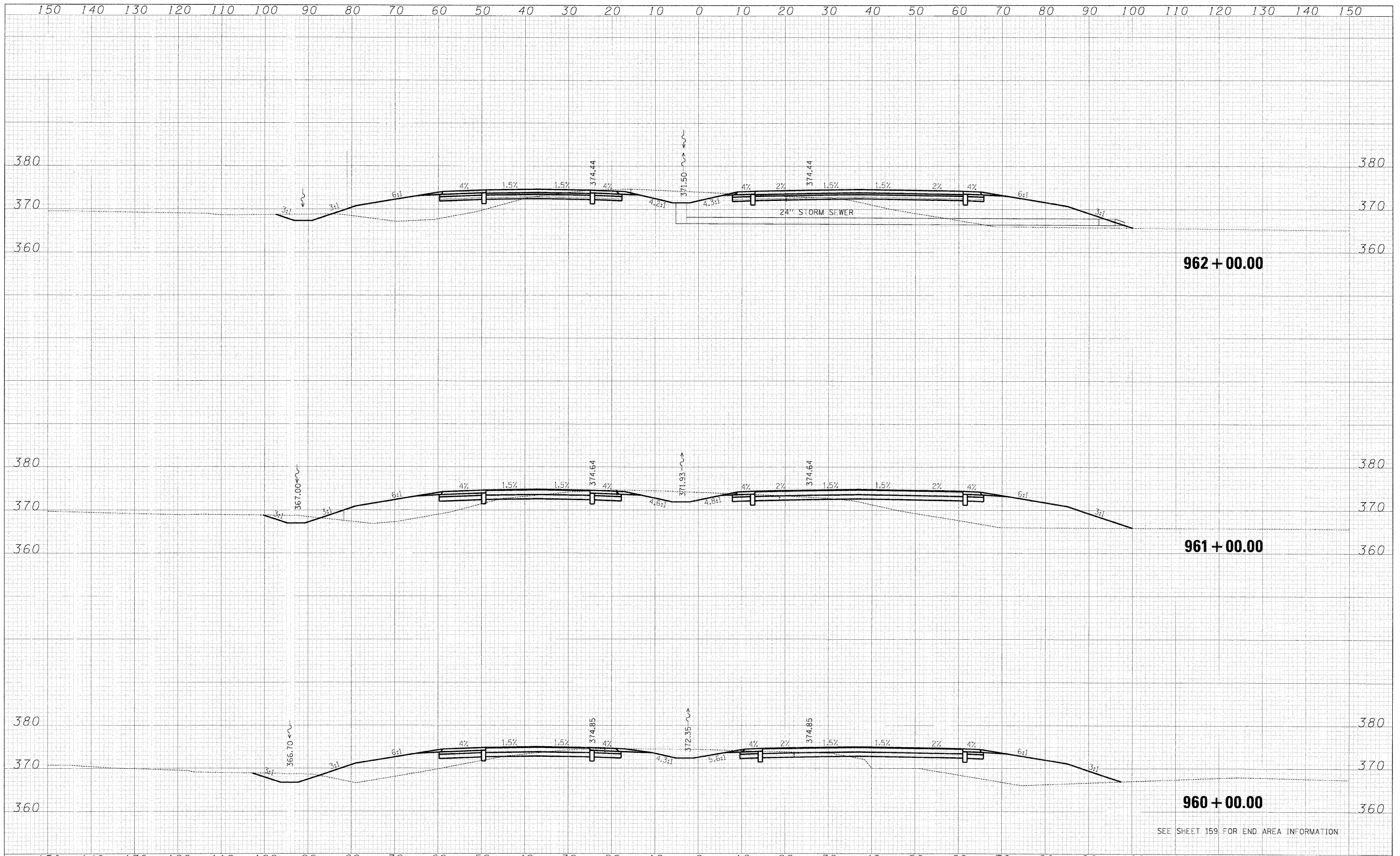

SEE SHEET 159 FOR END AREA INFORMATION

FILE NAME = IL13_west.xsec.sheets.dgn	USER NAME = bwe:gard	DESIGNED - BJW	REVISED -	<b>STATE OF ILLINOIS</b> <b>DEPARTMENT OF TRANSPORTATION</b>	<b>CROSS SECTIONS-ILL 13 RELOCATION</b>	F.A. RTE. 331	SECTION 3-2, 8X-1, (8X-1)B, 4-2	COUNTY SALINE	TOTAL SHEETS 164	SHEET NO. 220
PLLOT SCALE = 1:10	CHECKED - JPN	REVISIED -	CONTRACT NO. 78058							
PLLOT DATE = 2/2/2009	DATE - 02-02-09	REVISIED -	ILLINOIS FED. AID PROJECT							
SCAL: SHEET NO. OF SHEETS STA. 960+00.00 TO STA. 962+00.00										