

DATE	
BY	
FINAL SURVEY	
PLOTTED	
NOTE BOOK	
AREAS	
AREAS CHECKED	

DATE	
BY	
ORIGINAL SURVEY	
PLOTTED	
NOTE BOOK	
AREAS	
AREAS CHECKED	

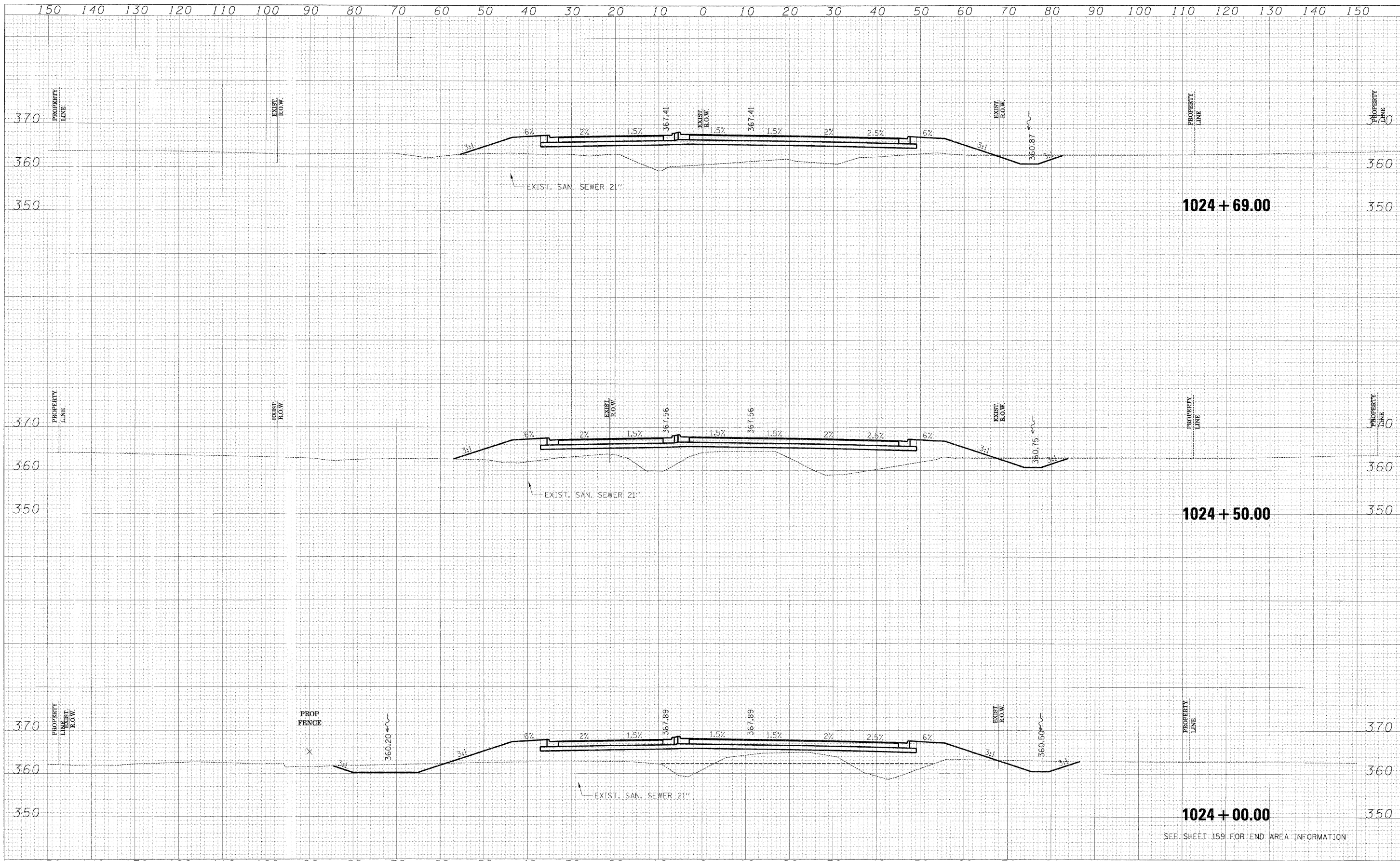

FILE NAME = IL13_west_xsec_sheets.dgn	USER NAME = bweigand	DESIGNED - BJW	REVISED -	<p align="center"><b>STATE OF ILLINOIS</b> <b>DEPARTMENT OF TRANSPORTATION</b></p> <p align="center"><b>CROSS SECTIONS-ILL 13 RELOCATION</b></p> <p>SCALE: SHEET NO. 01 OF SHEETS STA. 1024+00.00 TO STA. 1024+69.00</p>	F.A. RTE. 331	SECTION 3-2, 8X-1, (8X-1)B, 4-2	COUNTY SALINE	TOTAL SHEETS 190	SHEET NO. 220
		DRAWN - DMS	REVISED -		FED. ROAD DIST. NO. [ILLINOIS] FED. AID PROJECT	CONTRACT NO. 78058			
		CHECKED - JPN	REVISED -						
		DATE - 02-02-09	REVISED -						

SEE SHEET 159 FOR END AREA INFORMATION