

DATE	
BY	
FINAL SURVEY	
SURVEYED	
PLOTTED	
NOTE BOOK	
NO.	
AREAS CHECKED	

DATE	
BY	
ORIGINAL SURVEY	
SURVEYED	
PLOTTED	
NOTE BOOK	
NO.	
AREAS CHECKED	

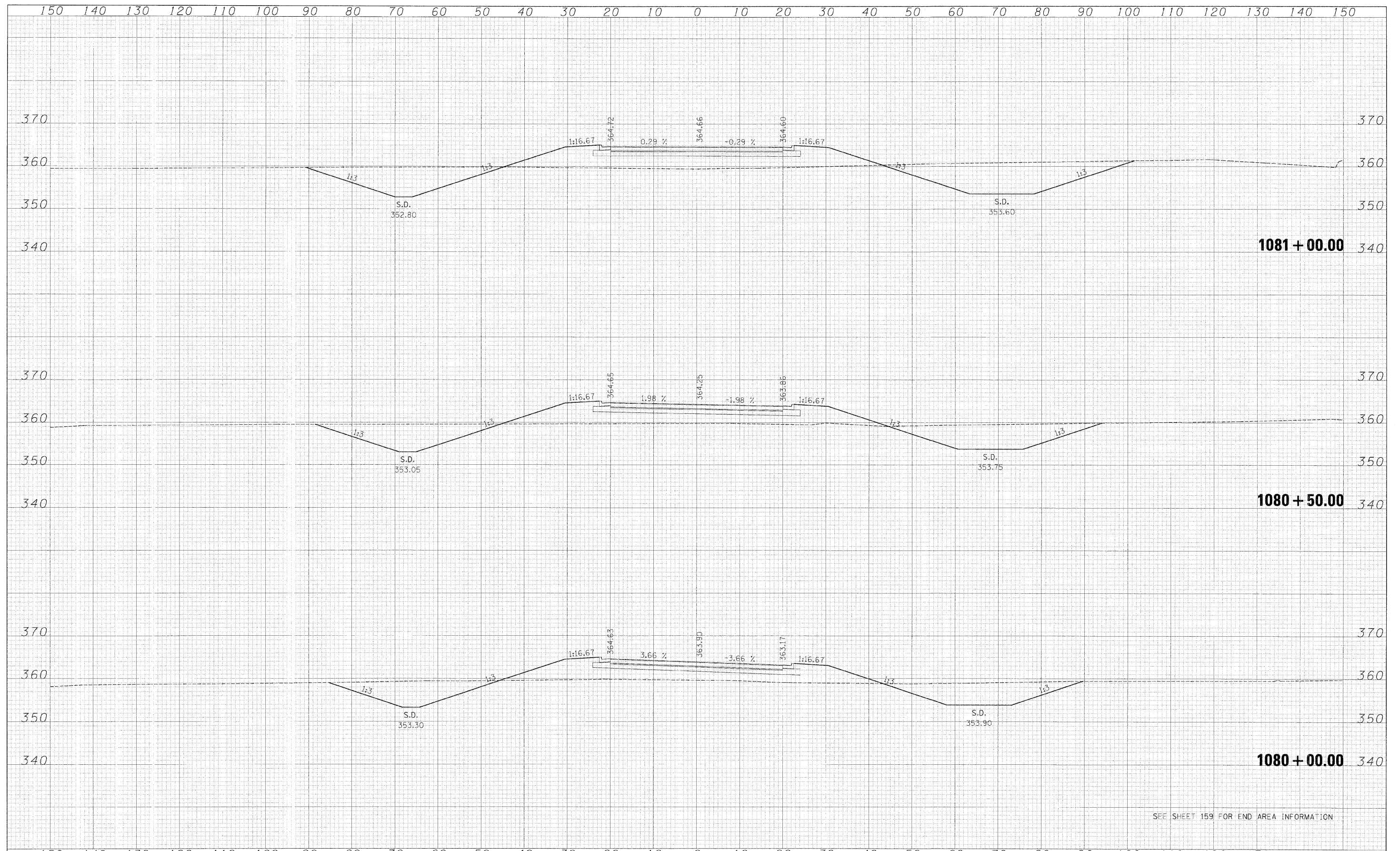

SEE SHEET 159 FOR END AREA INFORMATION

FILE NAME = IL13_east_xsec_sheets.dgn	USER NAME = bweigand	DESIGNED - BJW	REVISED -	STATE OF ILLINOIS DEPARTMENT OF TRANSPORTATION	CROSS SECTIONS-ILL 13 RELOCATION			F.A. RTE. 331	SECTION 3-2, 8X-1, (RX-1)B, 4-2	COUNTY SALINE	TOTAL SHEETS 195	SHEET NO. 220
PLOT SCALE = 1:10	CHECKED JPN	DATE - 02-02-09	REVISED -		SCALE:	SHEET NO.	OF SHEETS	STA. 1080+00.00 TO STA. 1081+00.00	FED. ROAD DIST. NO.	ILLINOIS FED. AID PROJECT	CONTRACT NO. 78058	