

LOCAL R.T.E.	SECTION	COUNTY	TOTAL SHEETS	SHEET NO.
M.S. 1040	05-00010-00-PV	HENRY	136	44
STA. 81+00		TO STA. 85+20		
FED. ROAD DIST. NO. 2		ILLINOIS FED. AID PROJECT		

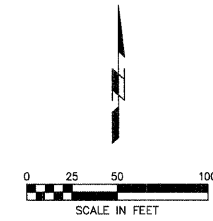

**SHIVE HATTERY**  
 Cedar Rapids, IA \ Iowa City, IA \ Des Moines, IA  
 Moline, IL \ Bloomington, IL \ Chicago, IL  
 SHIVE-HATTERY, INC. 1701 RIVER DRIVE, SUITE 200 MOLINE, IL 61265  
 PHONE (309) 764-7650 FAX (309) 764-8618  
 http://www.shive-hattery.com  
 ILLINOIS FIRM NUMBER: 184-000214



PLAN	SURVEYED	DATE
	PLOTTED	BY
	CHECKED	
	REVISIONS	
	NO. OF PAGES	
	FILE NAME	
	NO.	

PROFILE	SURVEYED	DATE
	PLOTTED	BY
	CHECKED	
	REVISIONS	
	NO. OF PAGES	
	FILE NAME	
	NO.	

PLOT DATE = #DATE#  
 FILE NAME = #FILE#  
 PLOT SCALE = #SCALE#  
 USER NAME = #USER#

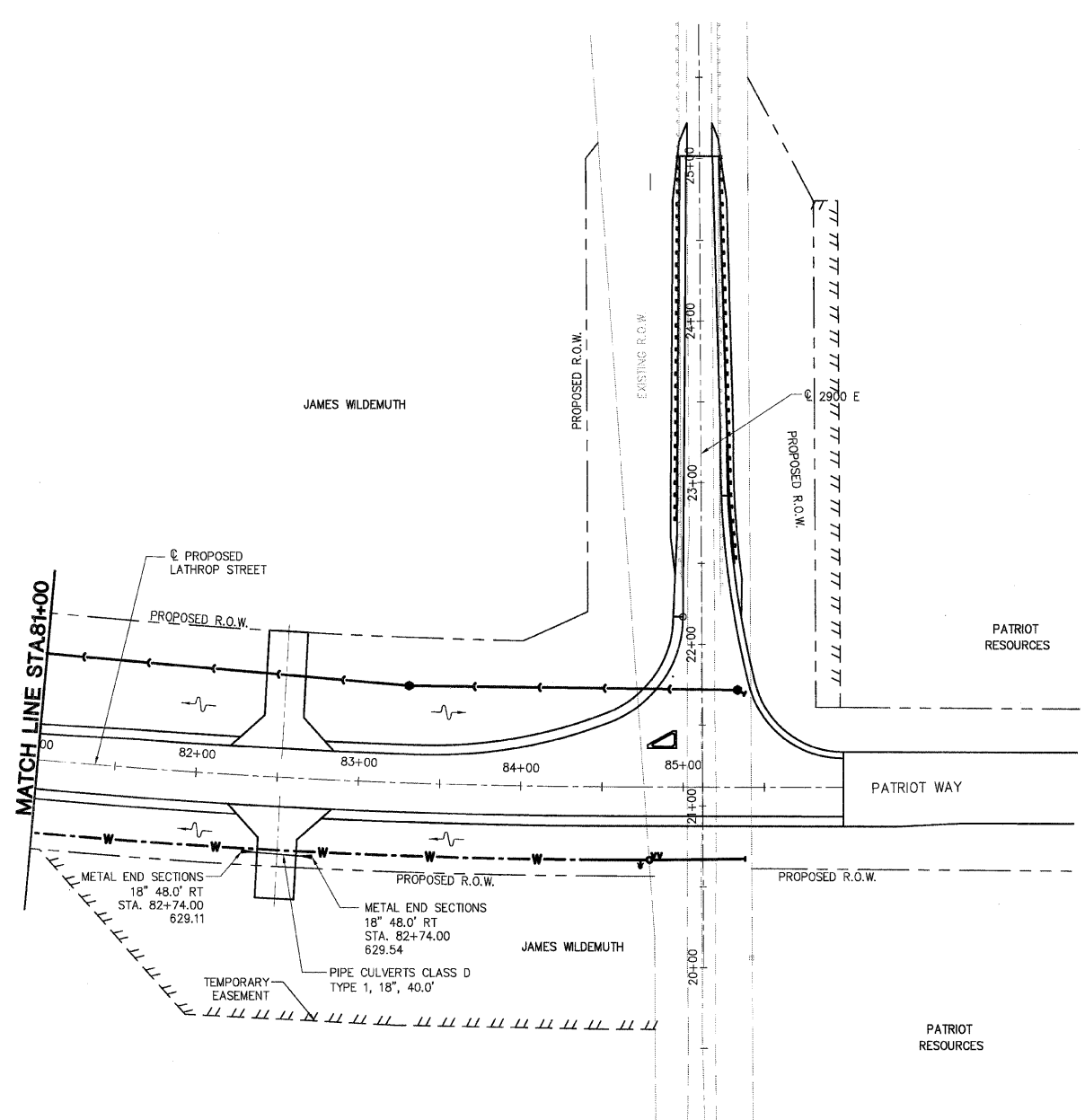

**LEGEND**

- W --- PROPOSED WATER MAIN
- S --- PROPOSED SANITARY SEWER
- W --- WATER MAIN BY OTHERS
- S --- SANITARY SEWER BY OTHERS
- ST --- EXISTING STORM SEWER OR FIELD TILE
- ST --- PROPOSED STORM SEWER

**HORIZONTAL SCALE**

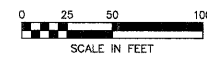

**VERTICAL SCALE**

