

LOCAL RTE.	SECTION	COUNTY	TOTAL SHEETS	SHEET NO.
MS 1040	05-00010-00-PV	HENRY	136	45
STA. 4+97	TO STA. 20+50			
FED. ROAD DIST. NO. 2	ILLINOIS	FED. AID PROJECT		

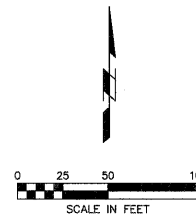

Old Engineering - Environmental Services - Landscape Architecture - Surveying
 1017 7th Avenue, Suite 200, Lincoln, IL 62550
 Phone (618) 782-7941 Fax (618) 782-7942

- BENCHMARKS:**
- NGS MONUMENT MF1033 1.8 MILES EAST OF ANNAPAN. ELEV. 654.90
 - 5/8" REBAR AT EAST EDGE OF SIDEWALK ON WEST SIDE OF IL 78 AT EXTENSION OF LATHROP RD. @ STA. 110+82.55, 39.3' LT. ELEV. = 624.59



DATE	BY

PLAN

REVIEWED BY: _____
 PLOTTED BY: _____
 CHECKED BY: _____
 DATE: _____

DATE	BY

PROFILE

REVIEWED BY: _____
 PLOTTED BY: _____
 CHECKED BY: _____
 DATE: _____

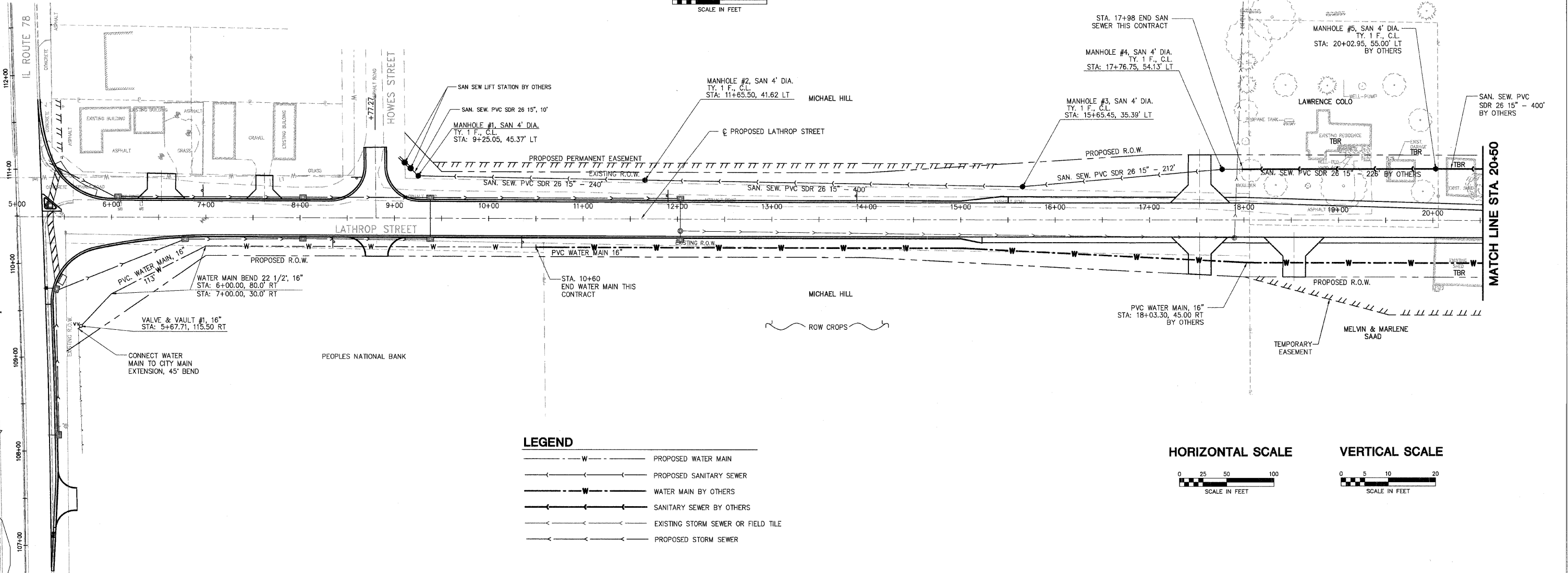

LEGEND

	PROPOSED WATER MAIN
	PROPOSED SANITARY SEWER
	WATER MAIN BY OTHERS
	SANITARY SEWER BY OTHERS
	EXISTING STORM SEWER OR FIELD TILE
	PROPOSED STORM SEWER

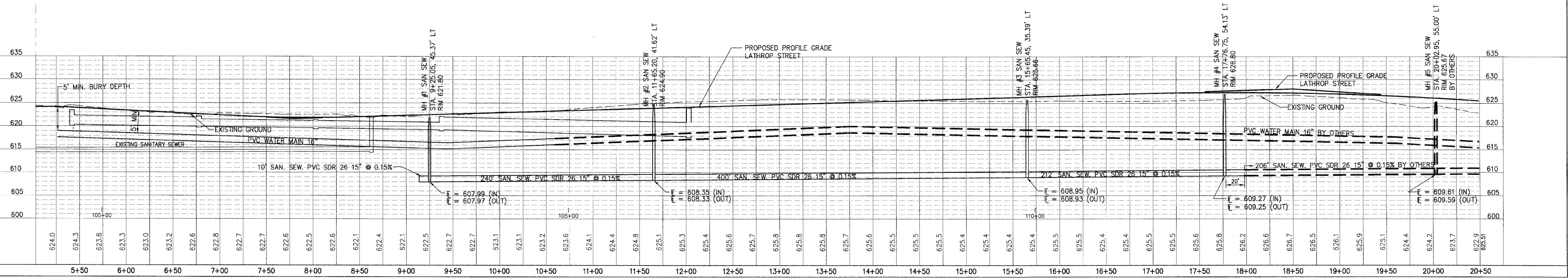
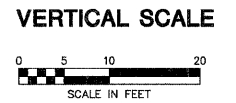
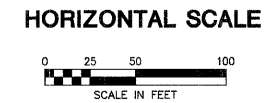

PLOT DATE = 04/01/08
 FILE NAME = 0511045
 PLOT SCALE = 1/4\"/>