

**STATE OF ILLINOIS**  
**DEPARTMENT OF TRANSPORTATION**  
**DIVISION OF HIGHWAYS**

**PROPOSED LOCAL AGENCY IMPROVEMENT**  
**FEDERAL-AID HBP PROJECT**  
**HIGHWAY BRIDGE PROGRAM**

**INDEX OF SHEETS**

- 1 = COVER SHEET
- 2 = SUMMARY OF QUANTITIES
- 3-4 = SCHEDULES
- 5 = GENERAL NOTES & TYPICAL SECTIONS
- 6 = DEMOLITION PLAN
- 7 = PLAN & PROFILE
- 8 = GENERAL PLAN & ELEVATION
- 9 = RIPRAP LAYOUT
- 10 = SUPERSTRUCTURE
- 11 = SUPERSTRUCTURE DETAILS
- 12 = NORTH ABUTMENT DETAILS
- 13 = SOUTH ABUTMENT DETAILS
- 14 = PIER #1 & #2 DETAILS
- 15 = ALUMINUM RAILING, TYPE L DETAILS
- 16-17 = CROSS SECTIONS
- 18 = INLET SPECIAL NO. 2 (MODIFIED) DETAIL

**STANDARDS**

- 000001-05 STANDARD SYMBOLS, ABBREVIATIONS & PATTERNS
- 001006 DECIMAL OF AN INCH AND OF A FOOT
- 280001-04 TEMPORARY EROSION CONTROL SYSTEMS
- 420001-07 PAVEMENT JOINTS
- 420101-04 24' (7.2m) JOINTED PCC PAVEMENT
- 424001-05 CURB RAMPS FOR SIDEWALKS
- 515001-03 NAME PLATE FOR BRIDGES
- 606001-04 CONCRETE CURB TYPE B AND COMBINATION CONCRETE CURB AND GUTTER
- 630001-08 STEEL PLATE BEAM GUARDRAIL
- 631031-07 TRAFFIC BARRIER TERMINAL, TYPE 6
- 664001-02 CHAIN LINK FENCE
- 701006-03 OFF-ROAD OPERATIONS, 2L, 2W, 15' (4.5 m) TO 24" (600 mm) FROM PAVEMENT EDGE
- 701301-03 LANE CLOSURE, 2L, 2W, SHORT TIME OPERATIONS
- 701901-01 TRAFFIC CONTROL DEVICES
- 720011-01 METAL POSTS FOR SIGNS, MARKERS & DELINEATORS
- 728001-01 TELESCOPING STEEL SIGN SUPPORT
- 729001-01 APPLICATIONS OF TYPES A & B METAL POSTS (FOR SIGNS & MARKERS)
- B. L. R. 22-6 TYPICAL APPLICATION OF TRAFFIC CONTROL DEVICES FOR CONSTRUCTION ON RURAL LOCAL HIGHWAYS

**MUNICIPAL STREET 6548B**  
**SECTION 98-00484-00-BR**  
**INDEPENDENCE AVENUE OVER S. BRANCH OF KENT CREEK**  
**CITY OF ROCKFORD**  
**PROJECT NO. BHM-5099(50)**  
**JOB NO. C-92-091-99**

NAME AND ADDRESS OF UTILITIES	TYPE
City of Rockford Attn: Jeff Rostamo 425 East State Street Rockford, Illinois 61104 (815) 987-5570	TELEPHONE
Comcast Attn: Mr. Mike Owens 4150 Kishwaukee Street Rockford, Illinois 61109 (815) 395-8977	CABLE & TELEPHONE
ComEd Attn: Mr. Tom Stutzman (630) 526-7094	ELECTRIC
Nicor Attn: Mr. Mike Lenox 123 Energy Avenue Rockford, Illinois 61109-1099 (815) 490-2869	GAS
Rock River Water Reclamation Attn: Mr. Mike Weber P.O. Box 7450 Rockford, Illinois 61126 (815) 387-7678	WATERWATER TREATMENT

STATE OF ILLINOIS DEPARTMENT OF TRANSPORTATION DIVISION OF HIGHWAYS	
APPROVED	<u>FEBRUARY 3</u> 2009 <i>John J. ... P.E.</i> CITY OF ROCKFORD, CITY ENGINEER
PASSED	<u>FEBRUARY 18</u> 2009 <i>John T. ...</i> DISTRICT 2 ENGINEER OF LOCAL ROADS & STREETS
RELEASING FOR BID BASED ON LIMITED REVIEW	<u>FEBRUARY 18</u> 2009 <i>James F. ...</i> DEPUTY DIRECTOR OF HIGHWAYS, REGION 2 ENGINEER

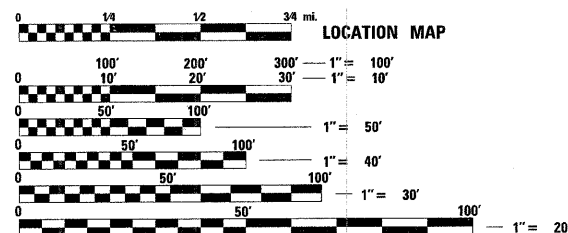

FULL SIZE PLANS HAVE BEEN PREPARED USING STANDARD ENGINEERING SCALES. REDUCED SIZED PLANS WILL NOT CONFORM TO STANDARD SCALES. IN MAKING MEASUREMENTS ON REDUCED PLANS, THE ABOVE SCALES MAY BE USED.

J.U.L.I.E.  
JOINT UTILITY LOCATION INFORMATION FOR EXCAVATION  
1-800-892-0123  
OR 811



**CONTRACT NO. 85453**

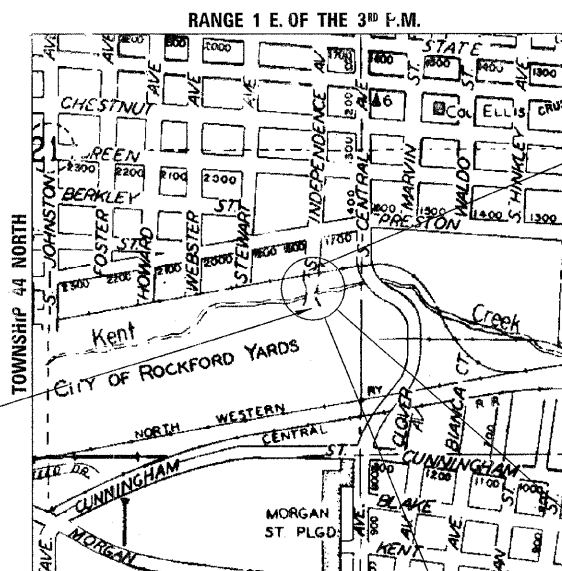

**SECTION BEGINS  
STA. 18 + 30**

**SECTION ENDS  
STA. 21 + 20**

LOCATION MAP

NET LENGTH 290 FEET = 0.05 MILES

**SECTION 98-00484-00-BR**  
A THREE SPAN (12'-9 3/4" : 26'-10 1/4" : 12'-9 3/4")  
13" REINFORCED CONCRETE SLAB ON  
REINFORCED CONCRETE PIERS &  
ABUTMENTS @ STA. 20+00. SKEW 5°  
RT. AHEAD.

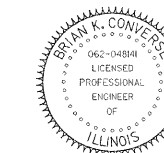

*Brian K. Converse*  
DATE: 2/5/2009  
EXPIRES 11/30/09

**WILLETT,  
HOFMANN &  
ASSOCIATES, INC.**  
CONSULTING ENGINEERS  
Land Surveying - Transportation - Structural  
Environmental - Architecture

809 East Second Street Dixon, Illinois 61021  
Phone 815.284.3381 Fax 815.284.3385  
Design Firm #184-000918  
www.willettthofmann.com