

RTE. NO.	SECTION	COUNTY	TOTAL SHEETS	SHEET NO.
CH 2006-00275-00-PV		LaSALLE	218	29
STA. N/A		TO STA. N/A		
FED. ROAD DIST. NO. 3		ILLINOIS	FED. AID PROJECT	

CONTRACT NO. 87352

### STAGE 2 DETOUR SIGNING

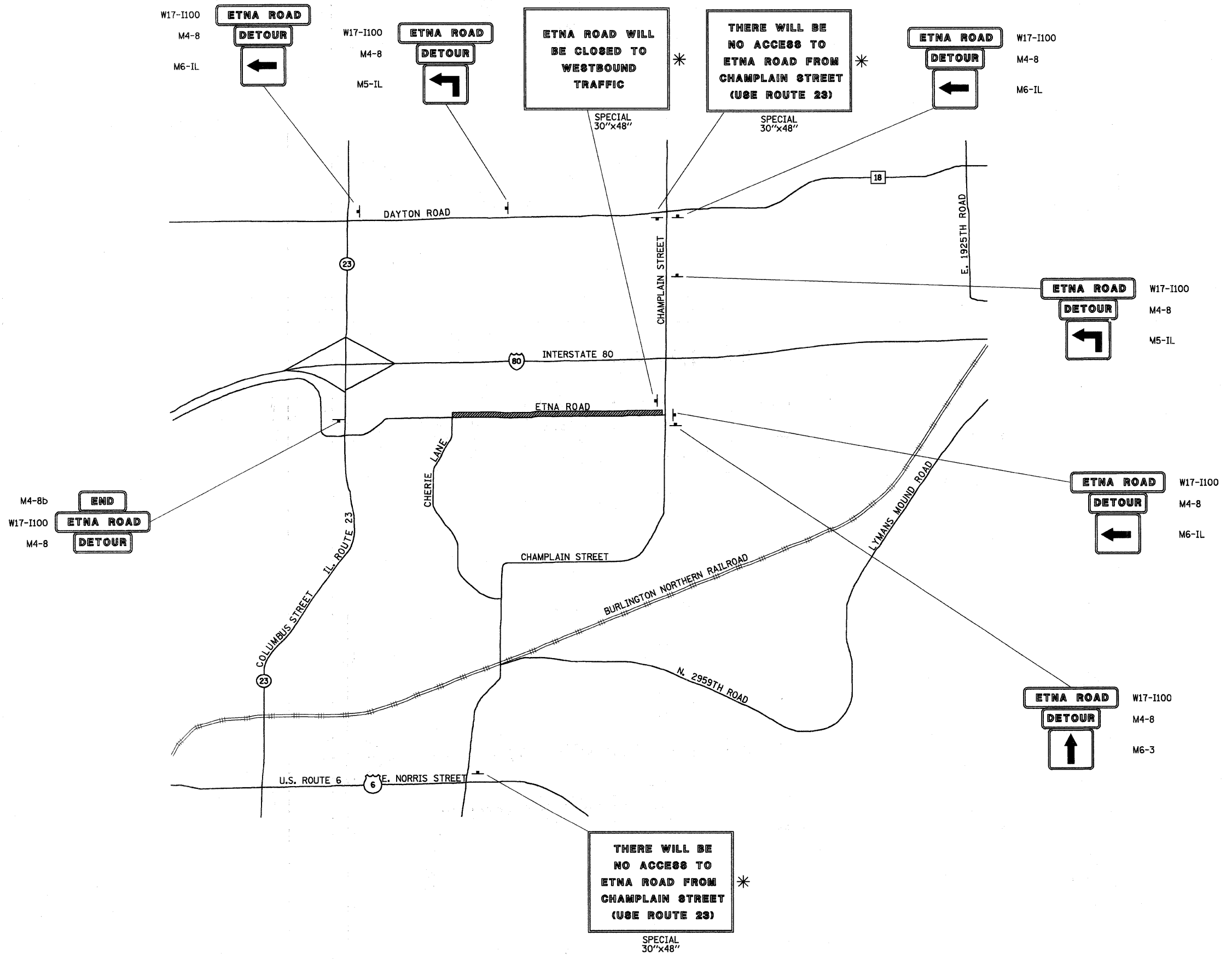

#### DETOUR GENERAL NOTES

- 1.) ALL SIGNING SHALL BE IN ACCORDANCE WITH THE APPLICABLE PROVISIONS OF THE STATE OF ILLINOIS "STANDARD SPECIFICATIONS FOR ROAD AND BRIDGE CONSTRUCTION ADOPTED JAN. 1, 2007", "THE QUALITY STANDARD FOR WORK ZONE TRAFFIC CONTROL DEVICES ADOPTED 1990", AND THE LATEST EDITION OF THE STATE OF ILLINOIS "MANUAL OF UNIFORM TRAFFIC CONTROL DEVICES".
- 2.) THE ENGINEER SHALL BE NOTIFIED IN WRITING AT LEAST THREE WEEKS PRIOR TO THE DAY THE DETOUR IS TO BE IN EFFECT.
- 3.) THE CONTRACTOR SHALL SUPPLY TO THE ENGINEER THE NAMES TELEPHONE NUMBERS OF HIS OR HER REPRESENTATIVES RESPONSIBLE FOR THE DETOUR SIGNING PRIOR TO THE START OF WORK. THE LASALLE COUNTY HIGHWAY DEPARTMENT REPRESENTATIVE IS:  
MR. LARRY KINZER  
LASALLE COUNTY HIGHWAY DEPARTMENT  
1400 NORTH 27TH ROAD P.O. BOX 128  
OTTAWA, IL 61350
- 4.) THE CONTRACTOR SHALL BE RESPONSIBLE FOR ENSURING THAT ALL BARRICADES, SIGNS, LIGHTS AND OTHER DEVICES INSTALLED BY HIM OR HER ARE IN PLACE AND OPERATING 24 HOURS EACH DAY INCLUDING SUNDAYS AND HOLIDAYS DURING THE TIME THE DETOUR IS IN EFFECT.
- 5.) THE CONTRACTOR SHALL MAKE ALL CHANGES IN SIGNING THAT ARE DEEMED NECESSARY BY THE ENGINEER.
- 6.) THE ENGINEER SHALL BE NOTIFIED AT LEAST TWO (2) HOURS BEFORE THE ROAD IS TO BE OPENED TO TRAFFIC.

\* POST MOUNTED SIGNS SHALL BE INSTALLED TWO WEEKS PRIOR TO BEGINNING STAGE 2 CONSTRUCTION.



#### DETOUR LEGEND

- POST MOUNTED SIGN
- ▨ ROAD CLOSURE LOCATION (WESTBOUND)

#### NOTE

BEFORE THE DETOUR IS OPENED TO TRAFFIC, THE CONTRACTOR MUST COORDINATE WITH THE FIRE DISTRICT, LASALLE COUNTY SHERIFF'S DEPARTMENT, SCHOOL DISTRICTS AND ILLINOIS DEPARTMENT OF TRANSPORTATION.