

RTE. NO.	SECTION	COUNTY	TOTAL SHEETS	SHEET NO.
CH 20	06-00275-00-PV	LoSALLE	218	33
STA. N/A		TO STA. N/A		
FED. ROAD DIST. NO. 3		ILLINOIS	FED. AID PROJECT	

CONTRACT NO. 87352

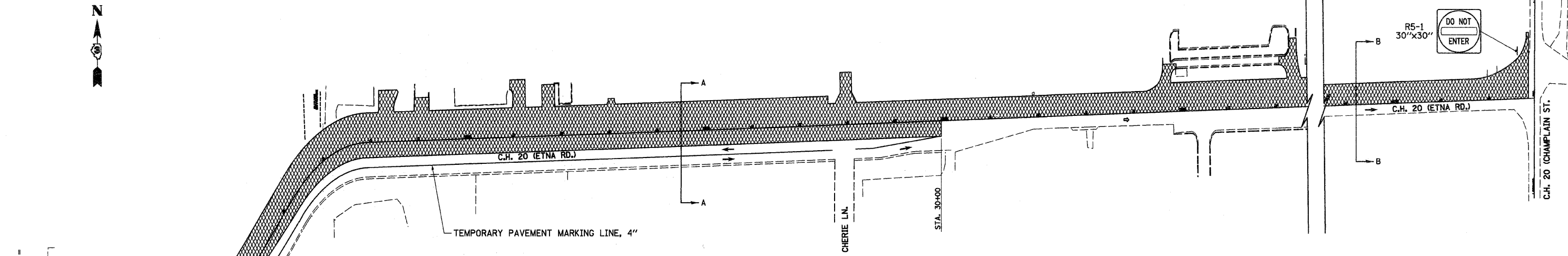

STAGE 2 TRAFFIC CONTROL PLAN

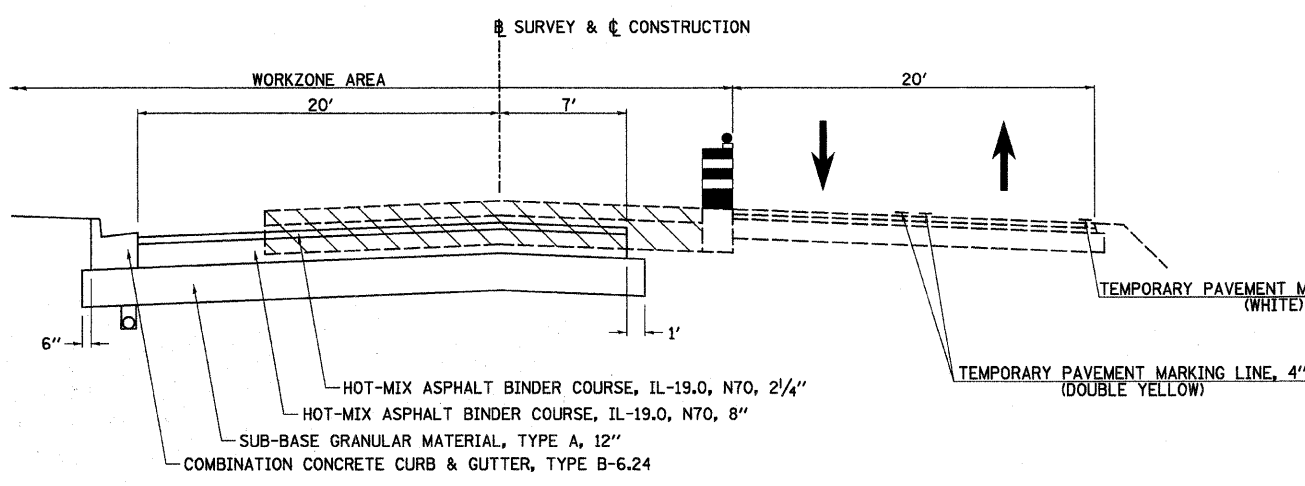

SECTION A-A
STA. 14+00 TO STA. 30+00

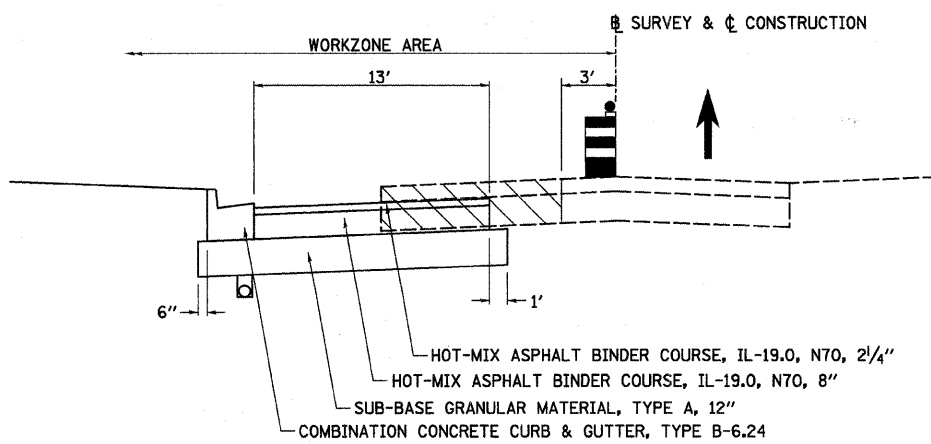

SECTION B-B
STA. 30+00 TO STA. 62+85±

LEGEND

→ DIRECTION OF TRAFFIC

▨ WORKZONE AREA

TRAFFIC CONTROL AND PROTECTION

"ONE WAY" SIGNS SHALL BE PLACED ACROSS FROM ALL LOCATIONS ENTERING ETNA RD., EAST OF CHERIE LN.

RELOCATE STOP SIGN ON CHERIE LN.

TRAFFIC CONTROL AND PROTECTION SHALL BE PERFORMED IN ACCORDANCE WITH THE TRAFFIC CONTROL PLAN AND SECTION 701 OF THE STANDARD SPECIFICATIONS AS AMENDED BY THE SPECIAL PROVISION FOR CONSTRUCTION ZONE TRAFFIC CONTROL LRS-3.

TWO WAY TRAFFIC WEST OF CHERIE LN. & ONE WAY TRAFFIC EAST OF CHERIE LN. SHALL BE ACCOMMODATED DURING ALL NON-WORK HOURS.

DRUMS WITH WORKING LIGHTS SHALL BE REQUIRED TO DELINEATE THE TRAVEL WAY. THE MAXIMUM SPACING SHALL BE 50 FEET, CENTER TO CENTER ALONG TANGENTS; AND 25 FEET, CENTER TO CENTER ALONG RADII TO SIDE ROADS AND ENTRANCES.

THE FOLLOWING TRAFFIC CONTROL STANDARDS ARE THE MINIMUM REQUIREMENTS FOR THE TRAFFIC CONTROL FOR THIS PROJECT: 701001, 701006, 701011, 701301, 701326, 701501, 701502, 702001.

STAGE 2 CONSTRUCTION

IMPLEMENT DETOUR ROUTE AND ESTABLISH STAGE 2 TRAFFIC FLOW.

REMOVE EXISTING PAVEMENT TO LIMITS SHOWN ON CROSS SECTIONS.

CONSTRUCT STORM SEWER SYSTEM ALONG NORTH SIDE OF ROADWAY.

CONSTRUCT NEW WESTBOUND LANES & CENTER TURN LANE (EXCLUDING SURFACE COURSE) FROM IL. RTE. 23 TO STA. 30+00.

CONSTRUCT NEW WESTBOUND LANE (EXCLUDING SURFACE COURSE) FROM STA. 30+00 TO CHAMPLAIN ST.