

SEC. 1 T. 33 N. R. 3 E. 3RD PM

HAROLD R. CLEMENS, et al.  
LOT 2

RTE. NO.	SECTION	COUNTY	TOTAL SHEETS	SHEET NO.
CH 2006-00275-00-PV		LOGSALLE	218	49
STA. 168+00 TO STA. 174+00		CONTRACT NO. 87352		
FED. ROAD DIST. NO. 3		ILLINOIS FED. AID PROJECT		

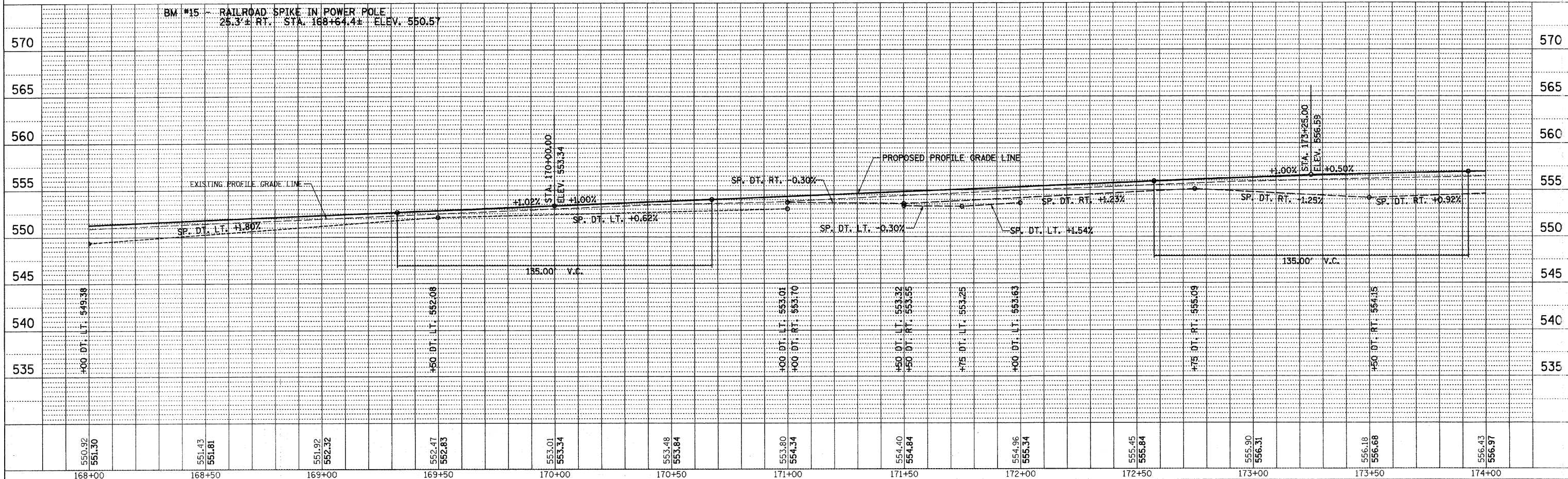
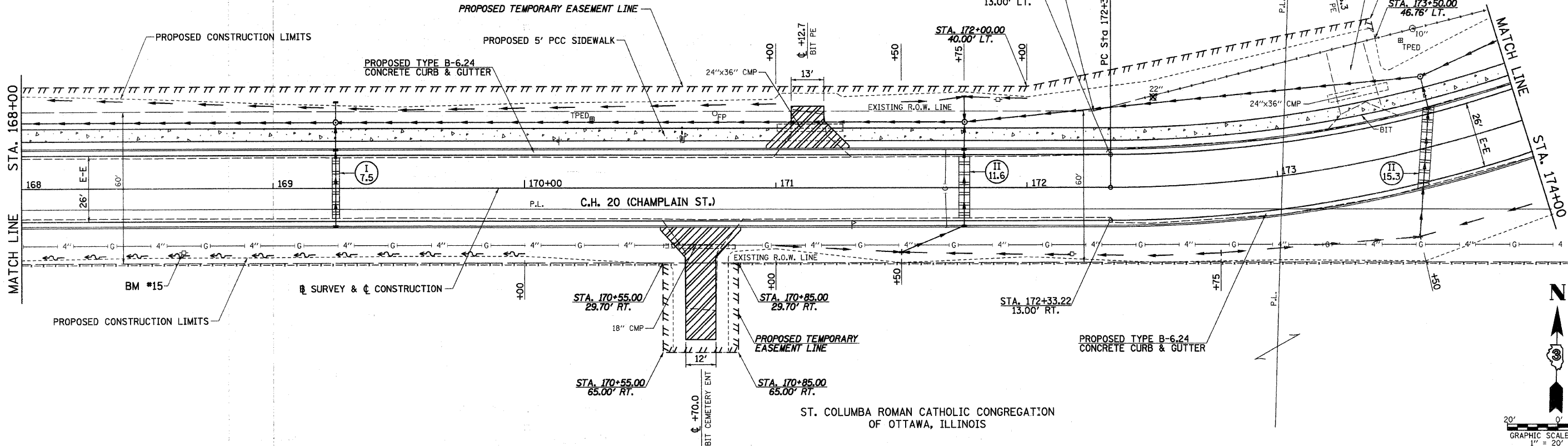

PLAN	SURVEYED	DATE
NOTE BOOK	PLotted	
NO.	CHECKED	
	BY	
	DATE	

PROFILE	SURVEYED	DATE
NOTE BOOK	PLotted	
NO.	CHECKED	
	BY	
	DATE	