

ROUTE NO.	SECTION	COUNTY	TOTAL SHEETS	SHEET NO.
CH 2006-00275-00-PV		LOGSALLE	218	102
STA. 9+50		TO STA. 21+00		
FED. ROAD DIST. NO. 3		ILLINOIS	FED. AID PROJECT	
CONTRACT NO. 87352				

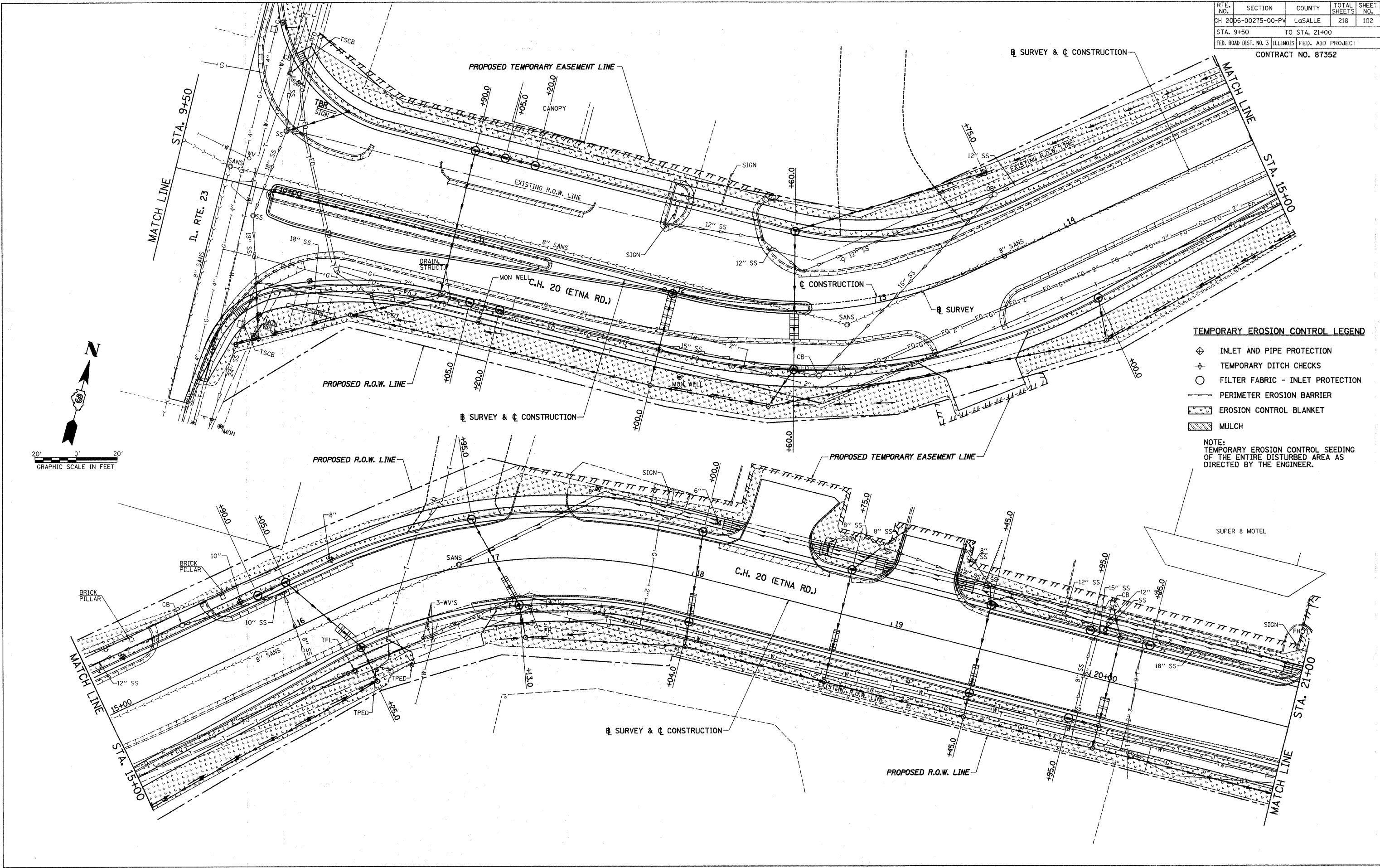

**TEMPORARY EROSION CONTROL LEGEND**

- ◆ INLET AND PIPE PROTECTION
- ◇ TEMPORARY DITCH CHECKS
- FILTER FABRIC - INLET PROTECTION
- PERIMETER EROSION BARRIER
- ▨ EROSION CONTROL BLANKET
- ▩ MULCH

NOTE:  
TEMPORARY EROSION CONTROL SEEDING  
OF THE ENTIRE DISTURBED AREA AS  
DIRECTED BY THE ENGINEER.

