

SECTION 32, T. 12 N., R. 5 W., 3rd P.M.

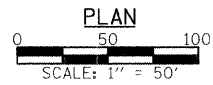

- UTILITIES**
- CONSOLIDATED COMMUNICATIONS
1-800-553-7611
 - AMEREN CIPS
1-888-789-2477
 - CHARTER COMMUNICATIONS
1-217-287-7992
 - ATMOS
1-888-824-3434
 - VILLAGE OF FARMERSVILLE
1-217-227-4169

BENCHMARKS: BM#7 - 60d NAIL & WASHER IN POWER POLE
41' LT. STA. 289+56 EL. 636.58

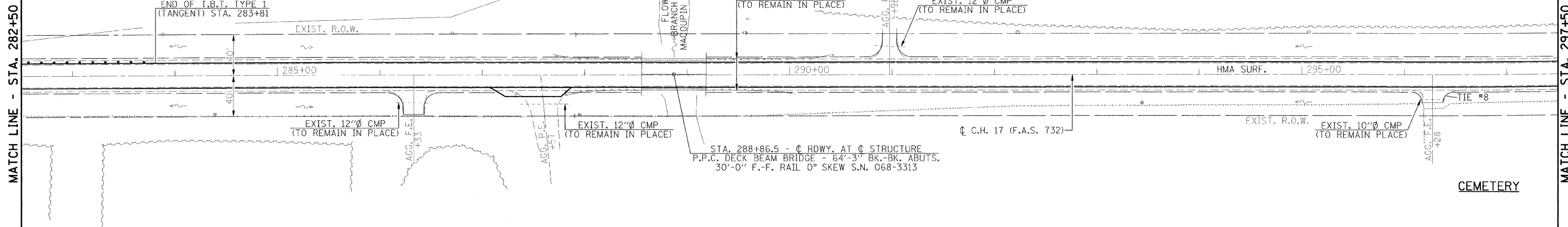
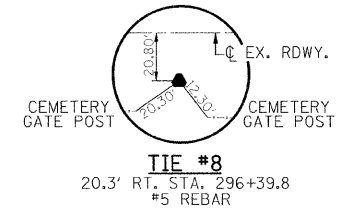
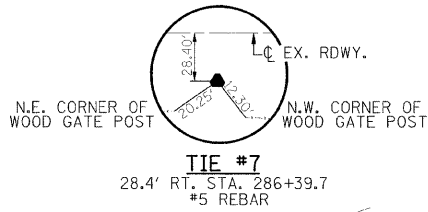
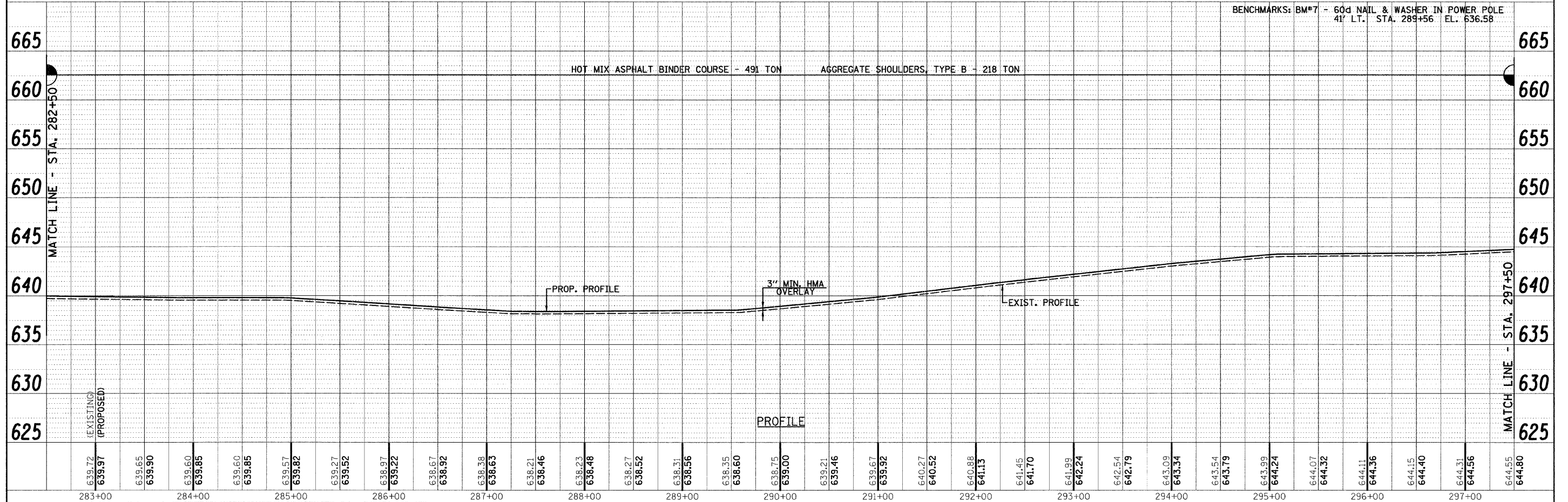

639.72 639.97	639.65 639.90	639.60 639.85	639.60 639.85	639.57 639.82	639.27 639.52	638.97 639.22	638.67 638.92	638.38 638.63	638.21 638.46	638.23 638.48	638.27 638.52	638.31 638.56	638.35 638.60	638.75 639.00	639.21 639.46	639.67 639.92	640.27 640.52	640.88 641.13	641.45 641.70	641.99 642.24	642.54 642.79	643.09 643.34	643.54 643.79	643.99 644.24	644.07 644.32	644.11 644.36	644.15 644.40	644.31 644.56	644.55 644.80
283+00	284+00	285+00	286+00	287+00	288+00	289+00	290+00	291+00	292+00	293+00	294+00	295+00	296+00	297+00															

FILE NAME =

USER NAME = #USER#

DESIGNED -

DRAWN -

CHECKED -

DATE -

PLLOT SCALE = #SCALE#

PLLOT DATE = #DATE#

REVISED -

REVISED -

REVISED -

REVISED -

REVISED -

REVISED -

REVISED -

REVISED -

Allen Henderson & Associates, Inc.
Civil and Structural Engineers Springfield, IL.
62703 Phone: (217)544-8033 IL Design Firm
No. 184-001907

PLAN & PROFILE

SCALE: 1" = 50'

SHEET NO. OF SHEETS STA. 209+20 TO STA. 342+20

F.A.S. RTE. 732	SECTION 07-00125-02-RS	COUNTY MONTGOMERY	TOTAL SHEETS 57	SHEET NO. 14
CONTRACT NO. 93480			ILLINOIS FED. AID PROJECT	

PLAN

SURVEYED BY

DATE

PLotted

CHECKED

BY

NO. _____

PROFILE

SURVEYED BY

DATE

PLotted

CHECKED

BY

NO. _____