

SECTION 32, T. 12 N., R. 5 W., 3rd P.M.

PLAN	SURVEYED	BY	DATE
	PLOTTED		
	CHECKED		
	BY		
	NOTE BOOK NO.		
	CADD FILE NAME		

PROFILE	SURVEYED	BY	DATE
	PLOTTED		
	CHECKED		
	BY		
	NOTE BOOK NO.		
	STRUCTURE NOTATION CHRD		

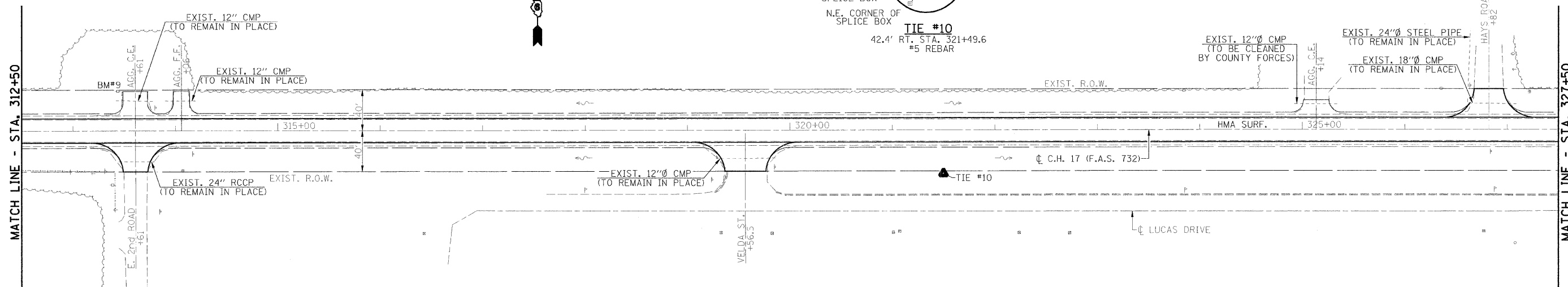

- UTILITIES**
- CONSOLIDATED COMMUNICATIONS
1-800-553-7611
 - AMEREN CIPS
1-888-789-2477
 - CHARTER COMMUNICATIONS
1-217-287-7992
 - ATMOS
1-888-824-3434
 - VILLAGE OF FARMERSVILLE
1-217-227-4169

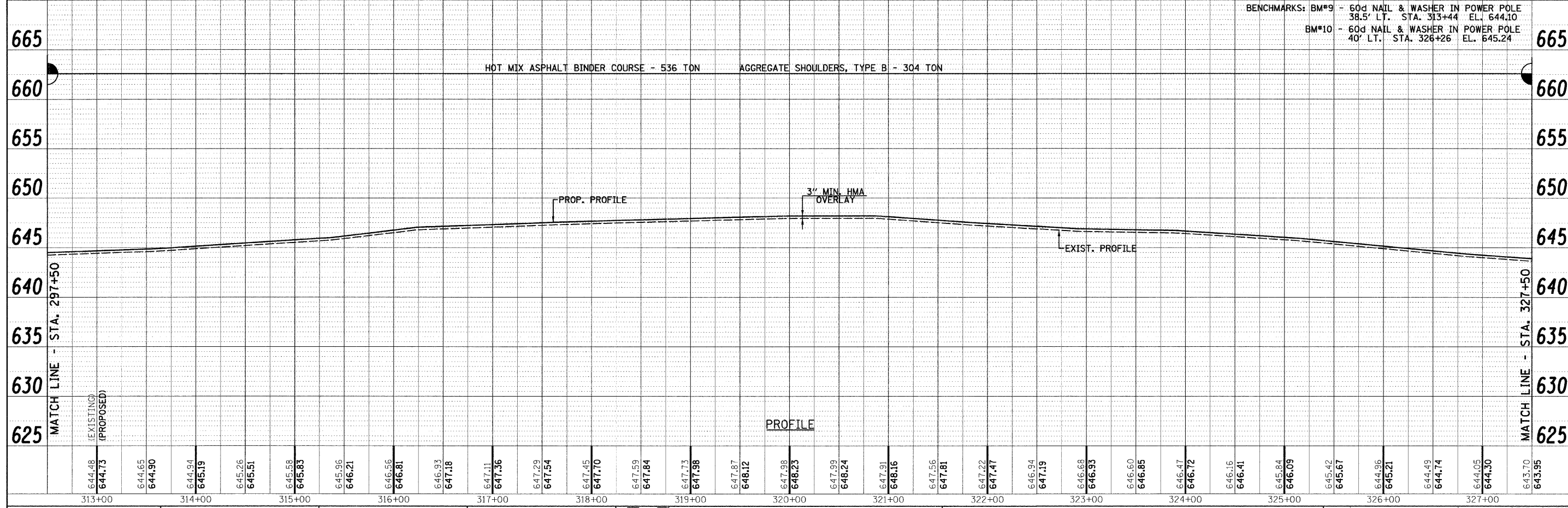
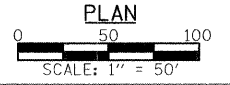

644.48	644.73	644.65	644.90	644.94	645.19	645.26	645.51	645.58	645.83	645.96	646.21	646.56	646.81	646.93	647.18	647.11	647.36	647.29	647.54	647.45	647.70	647.59	647.84	647.73	647.98	647.87	648.12	647.98	648.23	647.99	648.24	647.91	648.16	647.56	647.81	647.22	647.47	646.94	647.19	646.88	646.93	646.60	646.85	646.47	646.72	646.16	646.41	645.94	646.09	645.42	645.67	644.36	645.21	644.49	644.74	644.05	644.30	643.70	643.95
313+00	314+00	315+00	316+00	317+00	318+00	319+00	320+00	321+00	322+00	323+00	324+00	325+00	326+00	327+00																																													

Allen Henderson & Associates, Inc.
Civil and Structural Engineers Springfield, IL.
62703 Phone: (217)544-8033 IL Design Firm
No. 184-001907

DESIGNED -	REVISED -		PLAN & PROFILE		F.A.S. RTE.	SECTION	COUNTY	TOTAL SHEETS	SHEET NO.
DRAWN -	REVISED -		732	07-00125-02-RS	MONTGOMERY	57	16		
CHECKED -	REVISED -		SCALE: 1" = 50' SHEET NO. OF SHEETS STA. 209+20 TO STA. 342+20		CONTRACT NO. 9348				
DATE -	REVISED -		FED. ROAD DIST. NO. ILLINOIS FED. AID PROJECT						