

F.A.P. RTE.	SECTION	COUNTY	TOTAL SHEETS	SHEET NO.
781	1YRS	CRAWFORD	212	64
STA. 15+200 TO STA. 15+550				
FED. ROAD DIST. NO.		ILLINOIS	FED. AID PROJECT	

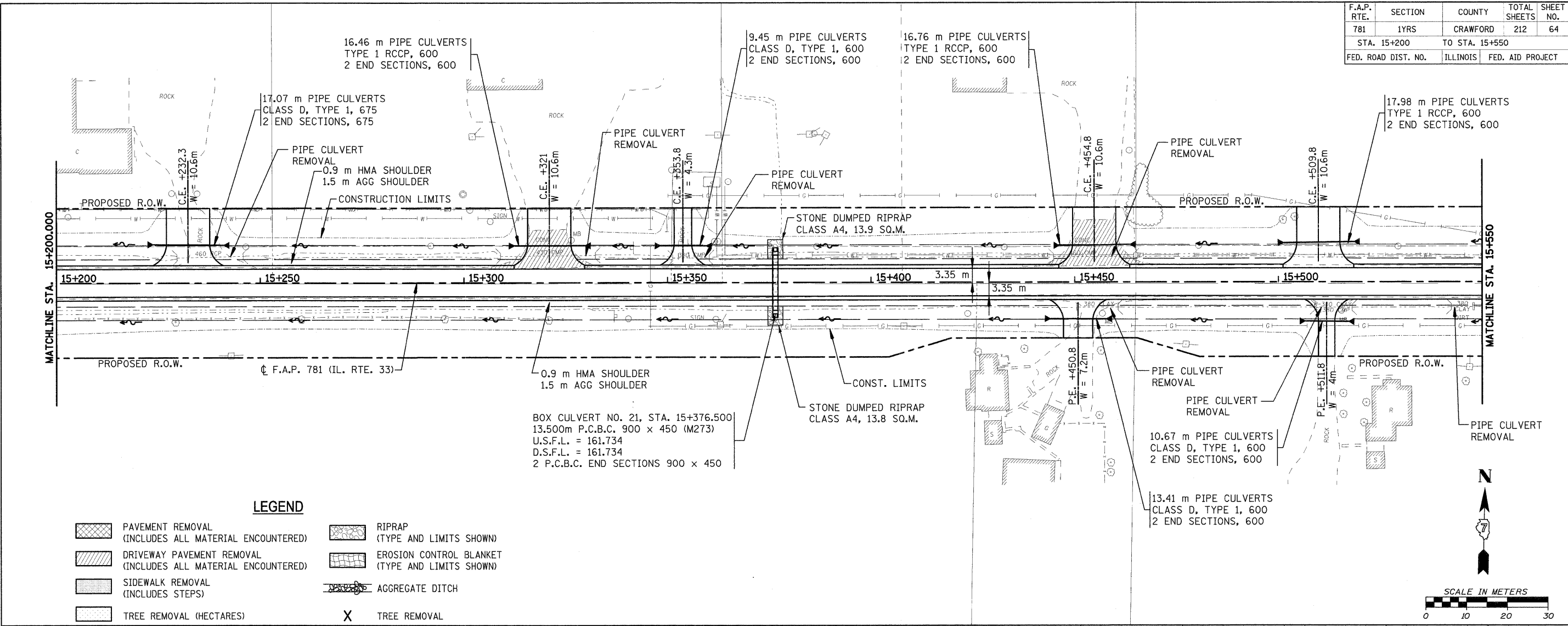

LEGEND

- PAVEMENT REMOVAL (INCLUDES ALL MATERIAL ENCOUNTERED)
- DRIVEWAY PAVEMENT REMOVAL (INCLUDES ALL MATERIAL ENCOUNTERED)
- SIDEWALK REMOVAL (INCLUDES STEPS)
- TREE REMOVAL (HECTARES)
- RIPRAP (TYPE AND LIMITS SHOWN)
- EROSION CONTROL BLANKET (TYPE AND LIMITS SHOWN)
- AGGREGATE DITCH
- TREE REMOVAL

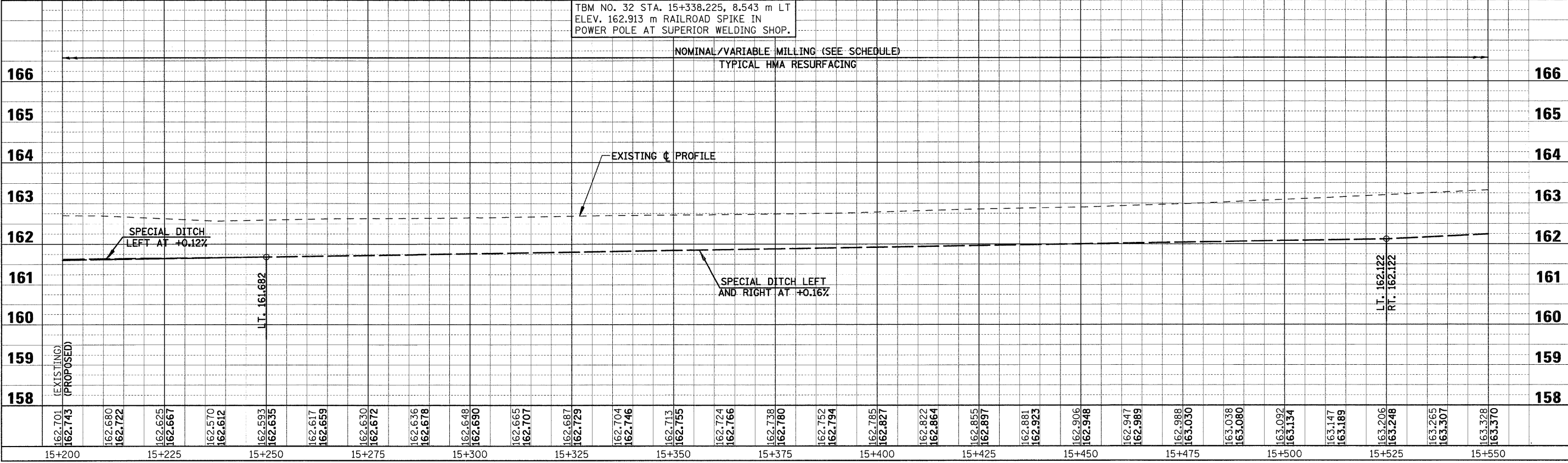
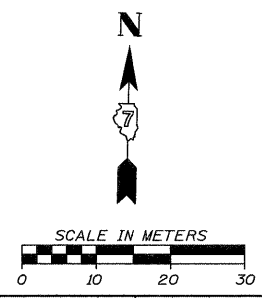

TBM NO. 32 STA. 15+338.225, 8.543 m LT
ELEV. 162.913 m RAILROAD SPIKE IN
POWER POLE AT SUPERIOR WELDING SHOP.

NOMINAL/VARIABLE MILLING (SEE SCHEDULE)
TYPICAL HMA RESURFACING

EXISTING C PROFILE

SPECIAL DITCH
LEFT AT +0.12%

SPECIAL DITCH LEFT
AND RIGHT AT +0.16%