

INDEX OF SHEETS

SHEET NO.	DESCRIPTION
1	TITLE SHEET & SUMMARY OF QUANTITIES
2	PLAN & PROFILE, TYPICAL SECTIONS, GENERAL NOTES & STONE RIPRAP DITCH DESIGN
3-4	ROADWAY CROSS SECTIONS
5-13	BRIDGE DESIGN

STANDARDS

000001-05	STANDARD SYMBOLS, ABBREVIATIONS & PATTERNS (8 SHEETS)
280001-04	TEMPORARY EROSION CONTROL SYSTEMS (2 SHEETS)
666001-01	RIGHT OF WAY MARKERS
701901-01	TRAFFIC CONTROL DEVICES (3 SHEETS)
B.L.R. 21-8	TYPICAL APPLICATION OF TRAFFIC CONTROL DEVICES FOR CONSTRUCTION ON RURAL LOCAL HIGHWAYS
B.L.R. 22-6	TYPICAL APPLICATION OF TRAFFIC CONTROL DEVICES FOR CONSTRUCTION ON RURAL LOCAL HIGHWAYS (TWO-LANE TWO-WAY RURAL TRAFFIC) (ROAD CLOSED TO THRU TRAFFIC)

SUMMARY OF QUANTITIES

QUANTITY	UNIT	ITEM	X081-2A CODE NO.
710.00	CU YD	EARTH EXCAVATION	20200100
348.00	CU YD	CHANNEL EXCAVATION	20300100
126.00	CU YD	FURNISHED EXCAVATION	20400800
0.60	ACRE	SEEDING, CLASS 2 (SPECIAL)	25001000
7.00	EACH	TEMPORARY DITCH CHECKS	28000300
16.00	TON	AGGREGATE (EROSION CONTROL)	28001000
300.00	TON	STONE DUMPED RIPRAP, CLASS A4	28100807
35.00	TON	STONE RIPRAP DITCH	28102600
365.00	TON	AGGREGATE SURFACE COURSE, TYPE B	40200800
1.00	EACH	REMOVAL OF EXISTING STRUCTURES	50100100
23.60	CU YD	CONCRETE STRUCTURES	50300225
2.80	CU YD	CONCRETE ENCASEMENT	50300280
1536.00	SO FT	PRECAST PRESTRESSED CONCRETE DECK BEAMS (27" DEPTH)	50400505
2520.00	POUND	REINFORCEMENT BARS	50800105
123.00	FOOT	STEEL RAILING, TYPE S1	50900205 *
560.00	FOOT	FURNISHING STEEL PILES HP12X53	51201600
560.00	FOOT	DRIVING PILES	51202305
1.00	EACH	NAME PLATES	51500100
40.00	FOOT	PIPE CULVERTS, CLASS D, TYPE 1 36"	54200241
10.00	EACH	FURNISHING AND ERECTING RIGHT-OF-WAY MARKERS	66600105
1.00	L SUM	MOBILIZATION	67100100

* SPECIALTY ITEMS

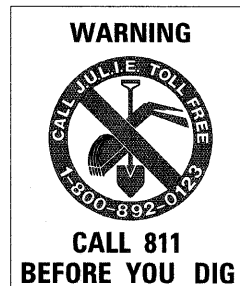

DESIGN DESIGNATION:
 DESIGN SPEED: 30 MPH
 HIGHWAY CLASS - LOCAL ROAD
 EXISTING STRUCTURE NO.: 024-3082
 PROPOSED STRUCTURE NO.: 024-3136
 CURRENT A.D.T. = 200
 CONTRACT NO. 95571



STATE OF ILLINOIS
DEPARTMENT OF TRANSPORTATION
PLANS FOR PROPOSED
FEDERAL AID – H.B.P. PROJECT

C.H. 4 EDWARDS COUNTY SECTION 06-00061-00-BR

PROJECT NO. BROS-047(031) JOB NO. C-97-071-09

CONTRACT #95571 WEST VILLAGE CREEK

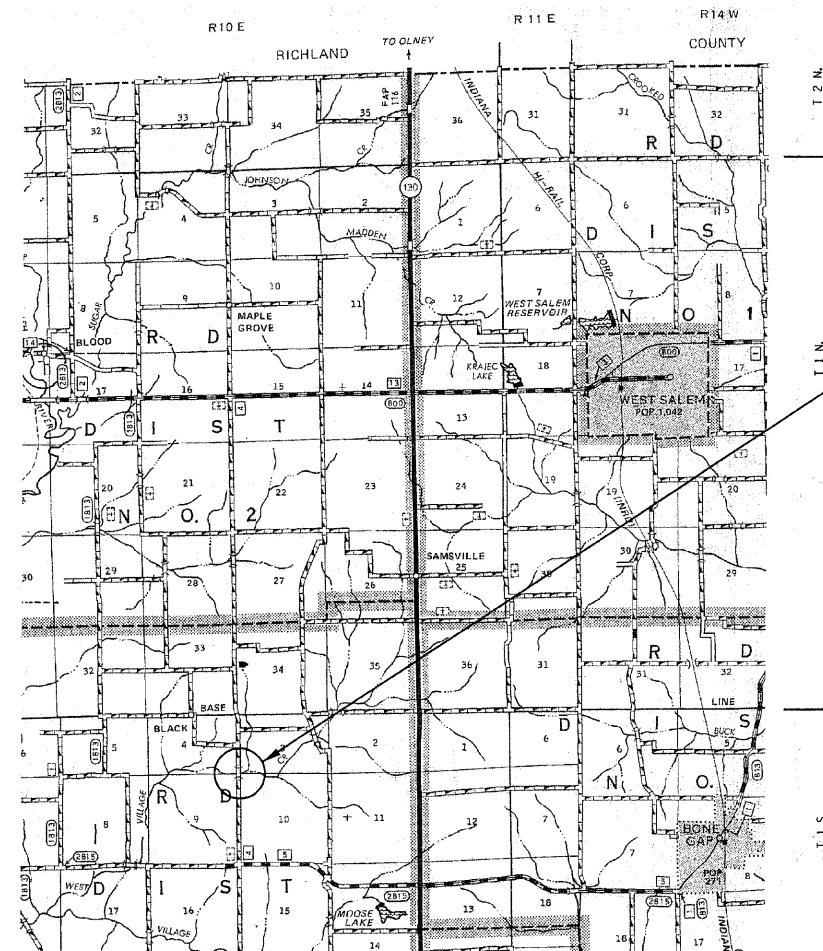

LAYOUT
 APPROXIMATE SCALE 1 INCH = 1 MILE



GROSS LENGTH	575.00 FT	0.109 MILES
OMISSIONS	0.00 FT	0.00 MILES
NET LENGTH	575.00 FT	0.109 MILES

PLAN	1" = 50'	
PROFILE	1" = 50'	
PROFILE VERT.	1" = 5'	

SECTION 06-00061-00-BR
 BEGINS STATION 2+00

STATION 5+00, STRUCTURE NO. 024-3136
 A 64' LONG SINGLE SPAN PRECAST
 PRESTRESSED CONCRETE DECK BEAM BRIDGE
 (27" DEPTH), 24' ROADWAY, 0° SKEW.

SECTION 06-00061-00-BR
 ENDS STATION 7+75

APPROVED Jan 28TH 20 09
 COUNTY ENGINEER

PASSED 2/5 20 09
 Mameen El-Kast
 DISTRICT SEVEN ENGINEER OF
 LOCAL ROADS & STREETS

Releasing For
 Bid Based on
 Limited Review 2/5 20 09
 Roger L. Drushell
 DEPUTY DIRECTOR OF HIGHWAYS,
 REGION FOUR ENGINEER

STATE OF ILLINOIS
 DEPARTMENT OF TRANSPORTATION

C.H.	SECTION	COUNTY	TOTAL SHEETS	SHEET NO.
4	06-00061-00-BR	EDWARDS	13	1

FED. ROAD DIST. NO. 7 ILLINOIS FED. AID PROJECT
 PROJECT # BROS-047(031) CONTRACT # 95571
 LEC JOB # H081008ED WEST VILLAGE CREEK

323 W. 3RD ST.
 P.O. BOX 160
 MT. CARMEL, IL
 62863
 PHONE:
 (618)-262-8661
 FAX:
 (618)-263-3327

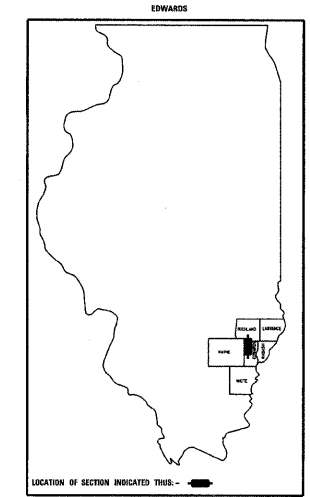

PROFESSIONAL DESIGN FIRM
 LAND SURVEY &
 PROFESSIONAL ENGINEERING CORPORATION
 184-00887
 (82-032435)(35-002769)



AARON M. MEFFORD
 NAME
 Signature
 SIGNATURE
 1-27-09
 DATE
 11-30-09
 EXPIRES

WEST VILLAGE CREEK
 COUNTY HIGHWAY 4
 EDWARDS COUNTY, ILLINOIS

SHEET TITLE:

TITLE SHEET

SCALE:	VARIES
BY:	AMM
DATE:	2/26/09
REV:	

1 OF 13
 SHEETS
 SHEET NO. 1