

**GENERAL NOTES:**

THIS SECTION SHALL BE CONSTRUCTED IN ACCORDANCE WITH THE PLANS, SPECIAL PROVISIONS AND "STANDARD SPECIFICATIONS FOR ROAD AND BRIDGE CONSTRUCTION", ADOPTED JANUARY 1, 2007.

THE WORK INVOLVED ON THIS SECTION CONSISTS OF THE REMOVAL OF THE EXISTING STRUCTURE, THE CONSTRUCTION OF A 64 FOOT LONG SINGLE SPAN PRECAST, PRESTRESSED CONCRETE DECK BEAM BRIDGE, EARTH APPROACHES, AGGREGATE SURFACE COURSE AND OTHER MISCELLANEOUS ITEMS NECESSARY TO COMPLETE THIS SECTION.

ALL ELEVATIONS ARE BASED ON U.S.G.S. MEAN SEA LEVEL DATUM.

IT SHALL BE THE CONTRACTOR'S RESPONSIBILITY TO CONTACT ALL THE UTILITIES, AFFECTING THE PROJECT, PRIOR TO CONSTRUCTION.

**TYPICAL CROSS SECTION PROPOSED**

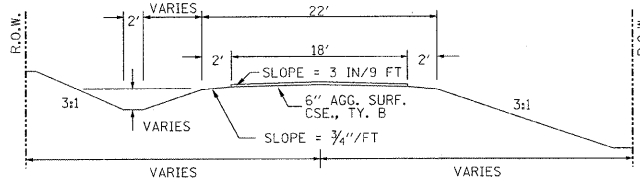

**TYPICAL CROSS SECTION EXISTING**

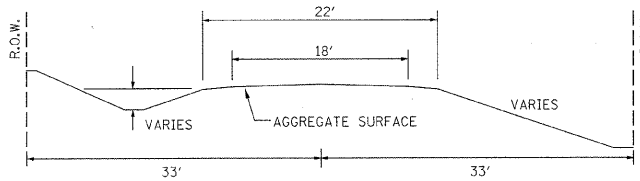

**UTILITIES:**

J.U.L.T.E. 1-800-892-0123

VERIZON  
1-618-395-6191

WAYNE-WHITE ELECTRIC CO-OP  
1-618-842-2196

**FIELD ENTRANCE DETAIL**

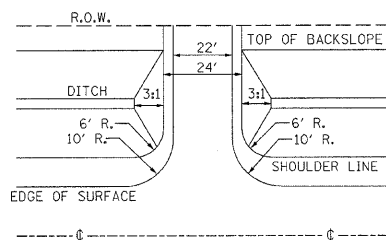

NOTE: CONSTRUCT SPECIAL DITCH

STA 3+00 TO STA 4+74.6 LT  
STA 3+00 TO STA 4+75.8 RT  
STA 5+24.2 TO STA 7+00 LT  
STA 5+25 TO STA 7+50 RT

NOTE: CONSTRUCT STONE RIPRAP DITCH

STA 5+24 LT TO STA 5+80 LT (0.62 TON/LIN FT)  
35 TON STONE RIPRAP DITCH ALLOWED IN PROPOSAL.

**STONE RIPRAP DITCH DESIGN**

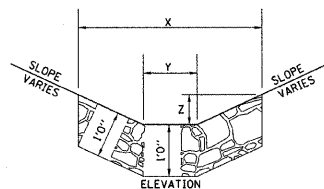
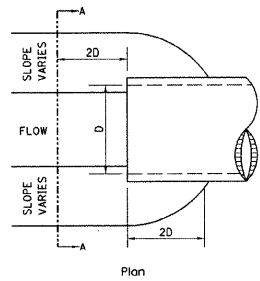

NOTE:

BOTTOM OF DITCH	SLOPE	TON/LIN. FT
1 1/2h	2h 3h	
2 FT	X= 5 FT 6 FT 8 FT	
Y= 2 FT	2 FT 2 FT	
Z= 1 FT	1 FT 1 FT	
	0.40 0.48 0.62	

NOTE: FOR PLACEMENT, QUALITY GRADATION AND OTHER MISCELLANEOUS REQUIREMENTS FOR STONE RIPRAP DITCH-SEE SPECIAL PROVISIONS.

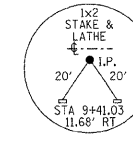
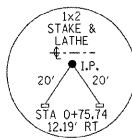

DAVID K. URFER TRUSTEE  
D.K. URFER REVOCABLE TRUST

RANDALL D. &  
SANDRA L. LONGBONS

DONALD KARMAN &  
NORMA M. LONGBONS

DONALD KARMAN &  
NORMA M. LONGBONS

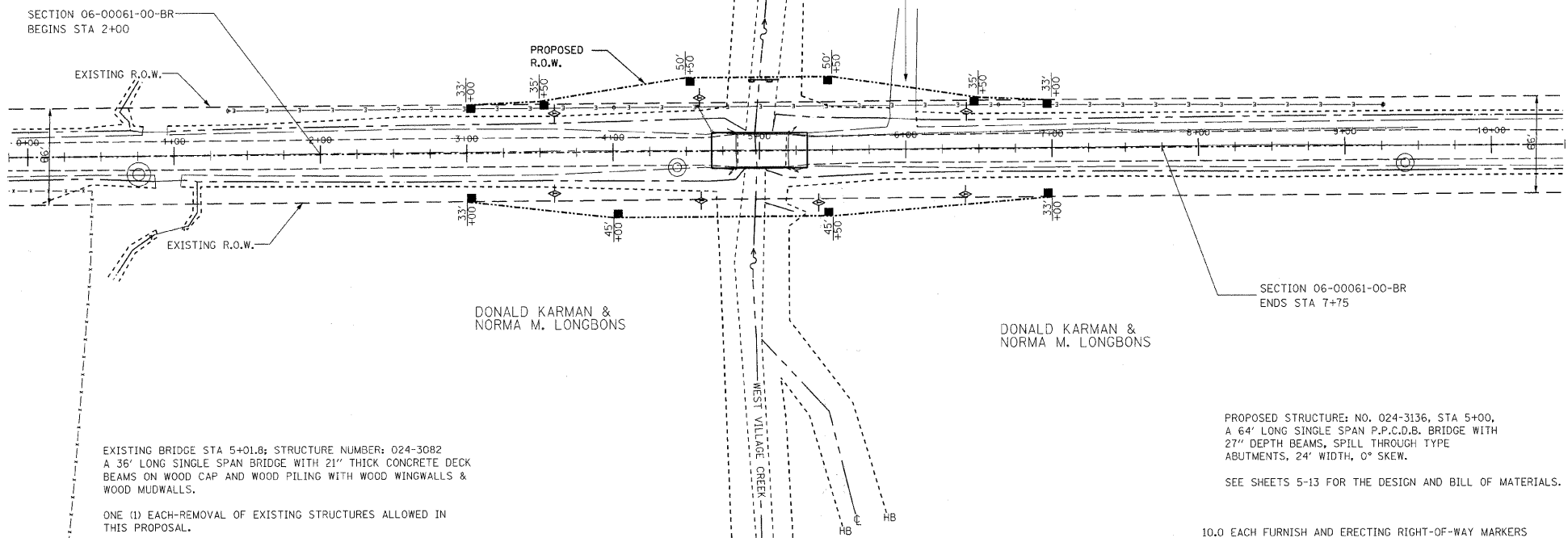

EXISTING BRIDGE STA 5+01.8; STRUCTURE NUMBER: 024-3082  
A 36' LONG SINGLE SPAN BRIDGE WITH 21" THICK CONCRETE DECK BEAMS ON WOOD CAP AND WOOD PILING WITH WOOD WINGWALLS & WOOD MUDWALLS.

ONE (1) EACH-REMOVAL OF EXISTING STRUCTURES ALLOWED IN THIS PROPOSAL.

NOTE: FILL NEXT TO BRIDGE TO BE AGGREGATE SURFACE COURSE

TEMPORARY DITCH CHECKS  
AGGREGATE (EROSION CONTROL)

10.0 EACH FURNISH AND ERECTING RIGHT-OF-WAY MARKERS  
7.0 EACH TEMPORARY DITCH CHECKS  
16.0 TONS AGGREGATE (EROSION CONTROL)  
0.6 ACRES SEEDING, CLASS 2 SPECIAL REQUIRED

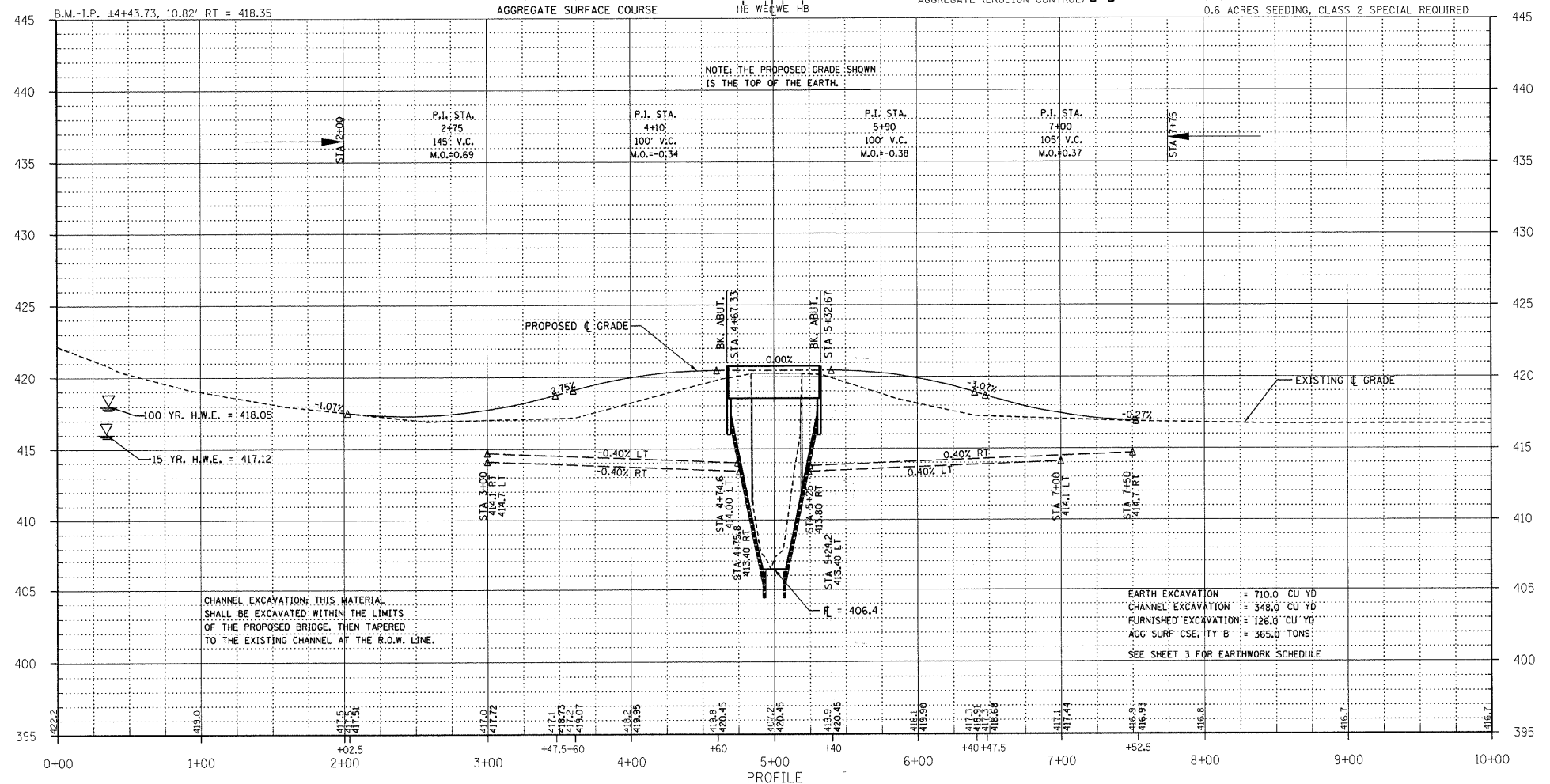

CHANNEL EXCAVATION: THIS MATERIAL SHALL BE EXCAVATED WITHIN THE LIMITS OF THE PROPOSED BRIDGE, THEN TAPERED TO THE EXISTING CHANNEL AT THE R.O.W. LINE.

EARTH EXCAVATION = 710.0 CU YD  
CHANNEL EXCAVATION = 348.0 CU YD  
FURNISHED EXCAVATION = 126.0 CU YD  
AGG SURF CSE, TY B = 365.0 TONS!  
SEE SHEET 3 FOR EARTHWORK SCHEDULE

C.H.	SECTION	COUNTY	TOTAL SHEETS	SHEET NO.
4	06-00061-00-BR	EDWARDS	13	2

323 W. 3RD ST.  
P.O. BOX 160  
MT. CARMEL, IL 62863  
PHONE: (618)-262-8651  
FAX: (618)-263-3327

405 W. STATE ST.  
SUITE 1  
PRINCETON, IN 47670  
PHONE: (812)-386-7611  
FAX: (812)-385-2812



PROFESSIONAL DESIGN FIRM  
LAND SURVEY & PROFESSIONAL ENGINEERING CORPORATION  
184-000897  
(62-032435)(35-002769)



AARON M. MEFFORD  
NAME  
SIGNATURE  
DATE  
1-27-09  
11-30-09  
EXPIRES

WEST VILLAGE CREEK  
COUNTY HIGHWAY 4  
EDWARDS COUNTY, ILLINOIS

SHEET TITLE:	
PLAN & PROFILE	
SCALE:	VARIES
BY:	AMM
DATE:	11/24/08
REV:	
2	OF 13
SHEETS	
SHEET NO. 2	