

LEGEND

- (C) REMOVAL OF LIGHTING CONTROLLER 84500110
- (H) REMOVE EXISTING HANDHOLE 89502380
- (L) REMOVE EXISTING LIGHT POLE & OR FOUNDATION 84200500, 84200700

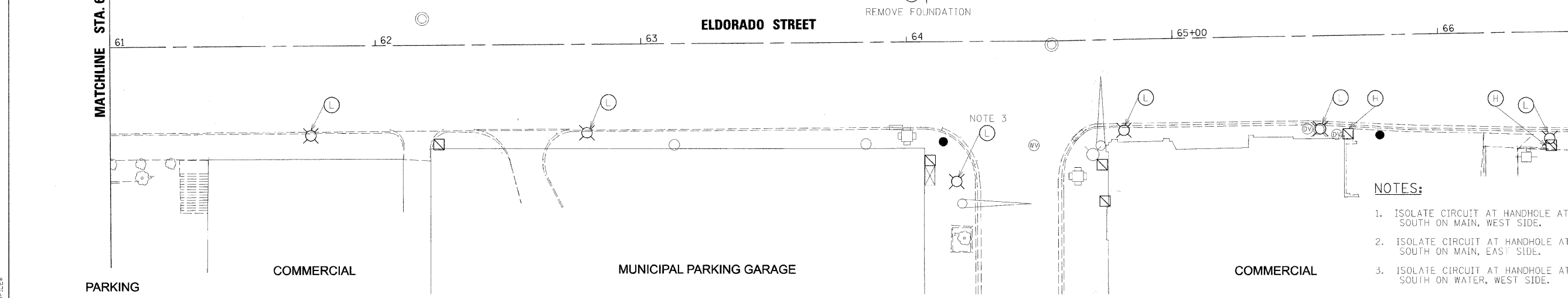
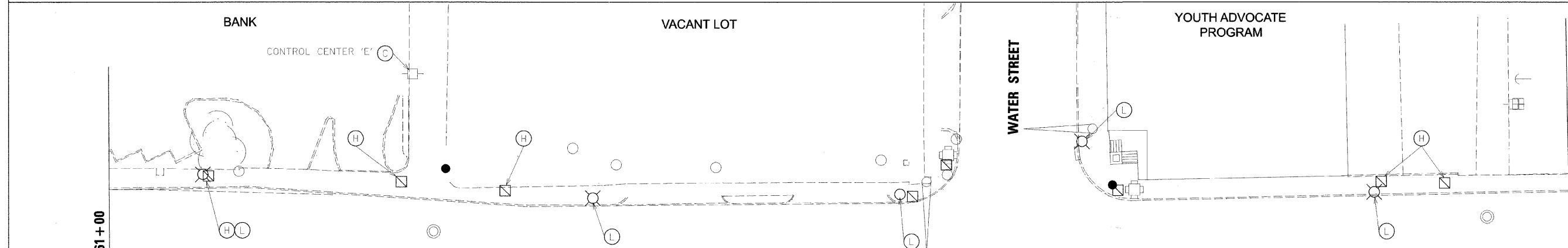
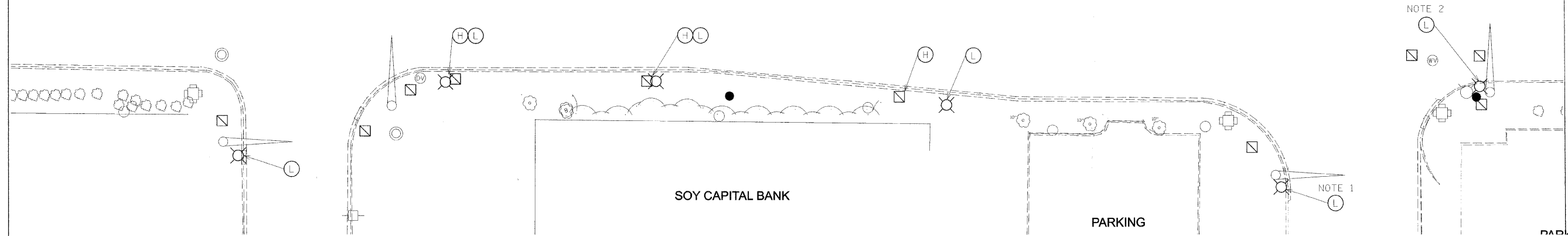
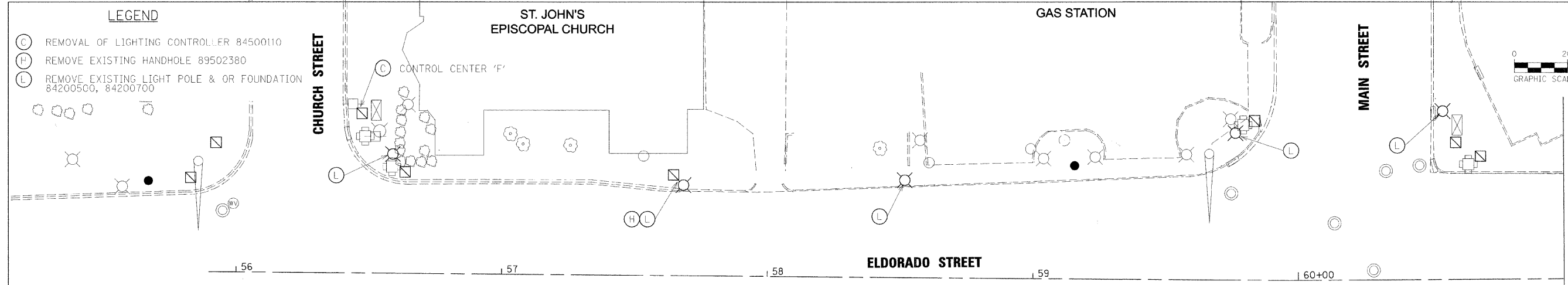
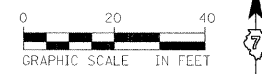

- NOTES:**
1. ISOLATE CIRCUIT AT HANDHOLE AT NEXT LIGHT POLE SOUTH ON MAIN, WEST SIDE.
 2. ISOLATE CIRCUIT AT HANDHOLE AT NEXT LIGHT POLE SOUTH ON MAIN, EAST SIDE.
 3. ISOLATE CIRCUIT AT HANDHOLE AT NEXT LIGHT POLE SOUTH ON WATER, WEST SIDE.

FILE NAME = FILE#



USER NAME =	DESIGNED - DAD	REVISED - March 13, 2009
PLOT SCALE =	DRAWN - DAD/KJB/WM	REVISED - March 23, 2009
PLOT DATE =	CHECKED - JJM	REVISED -
	DATE -	REVISED -

**STATE OF ILLINOIS
DEPARTMENT OF TRANSPORTATION**

**ROADWAY LIGHTING DEMOLITION PLANS
STA 55+80 TO 66+50**

SHEET NO. 1 OF 3 SHEETS STA. 55+80 TO STA. 66+50

F.A.P. RTE.	SECTION	CITY	TOTAL SHEETS	SHEET NO.
323	06-00625-00-SW	DECATUR	121	79
ELDORADO STREETScape PROJECT		CONTRACT NO. 95574		
FED. ROAD DIST. NO.		ILLINOIS FED. AID PROJECT: TE-00071351		