

ROAD CLOSED

FAU ROUTE	IDOT SECTION	COUNTY
9277	04-00031-00-PV	ST. CLAIR
FEDERAL AID PROJECT		ILLINOIS
IDOT JOB NO.	C-98-309-06	
IDOT CONTRACT NO.	97327	

THOUVENOT, WADE & MOERCHEN, INC.
ENGINEERS ♦ SURVEYORS ♦ PLANNERS



- CORPORATE OFFICE**
4940 OLD COLLINSVILLE RD.
SWANSEA, ILLINOIS 62226
TEL (618) 624-4488
FAX (618) 624-6688
corp@twm-inc.com
- EDWARDSVILLE OFFICE**
1015B CENTURY DRIVE
EDWARDSVILLE, ILLINOIS 62025
TEL (618) 656-4040
FAX (618) 656-4343
edwardsville@twm-inc.com
- ST. LOUIS OFFICE**
1001 CRAIG ROAD, SUITE 260
ST. LOUIS, MISSOURI 63146
TEL (314) 236-5052
FAX (314) 872-2194
stlouis@twm-inc.com
- WATERLOO OFFICE**
113 SOUTH MAIN STREET
WATERLOO, ILLINOIS 62298
TEL (618) 939-5050
FAX (618) 939-3938
waterloo@twm-inc.com

ILLINOIS PROFESSIONAL DESIGN FIRM	184-001220
PROFESSIONAL ENGINEERING CORP.	62-035370
PROFESSIONAL STRUCTURAL ENGR. CORP.	81-005202
ILLINOIS PROF. LAND SURVEYING CORP.	048-000029
MISSOURI PROFESSIONAL ENGR. CORP.	NC 001528
MISSOURI LAND SURVEYING CORP.	NC 000346

Signature: _____
Signature Date: _____
Expiration Date: _____

STATEMENT OF RESPONSIBILITY
I hereby confirm that the document herein to be authenticated by my seal is restricted to this sheet, and I hereby disclaim any responsibility for all other drawings, specifications, estimates, reports or other documents or instruments relating to or intended to be utilized for any other part of the architectural, engineering or survey project.

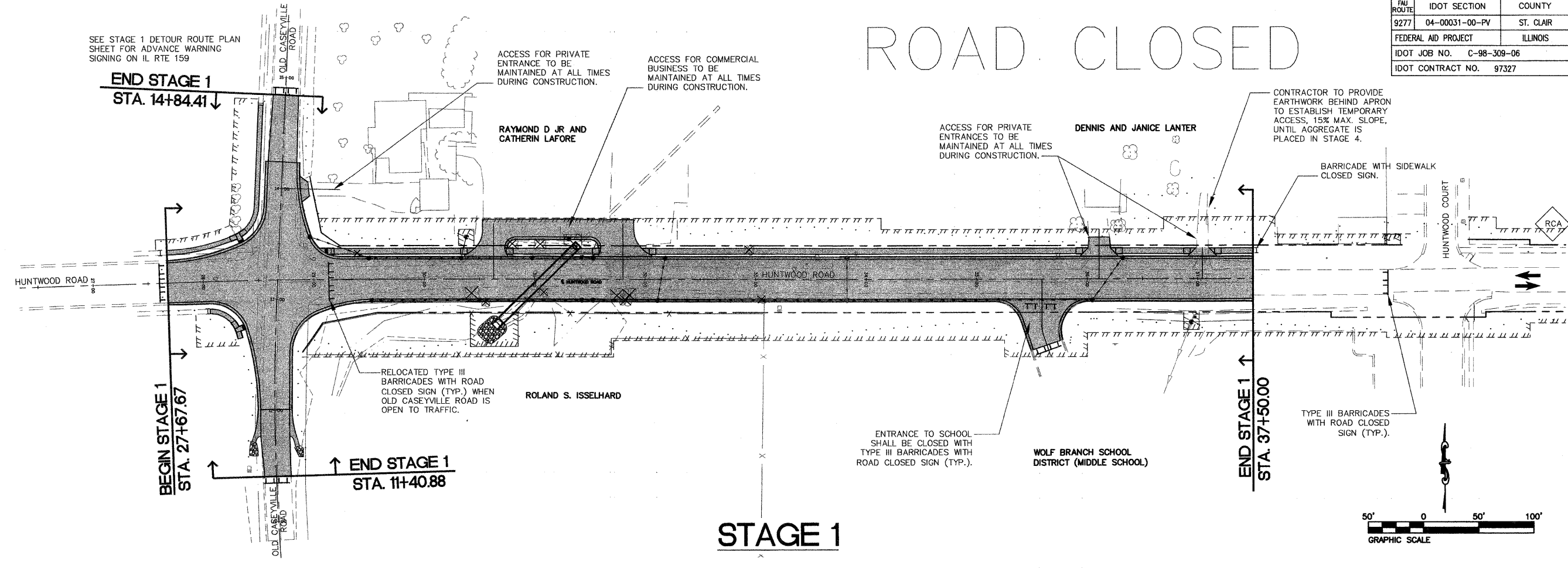

ALL STAGED CONSTRUCTION NOTES:

- THE CONTRACTOR SHALL FOLLOW THE CONSTRUCTION STAGES AND SEQUENCING OF THE STAGES AS SHOWN.
- ALL HMA SURFACE COURSE AND PERMANENT PAVEMENT MARKINGS SHALL BE COMPLETED AFTER ALL STAGE CONSTRUCTION IS COMPLETE.
- ALL TRAFFIC CONTROL MEASURES SHALL BE LIGHTED.
- THE CONTRACTOR WILL BE PERMITTED TO UTILIZE THE EXISTING HUNTWOOD ROAD PAVEMENT FOR THE TRANSPORT OF EXCESS CUT BETWEEN STAGES.
- SHOULD THE CONTRACTOR ELECT TO UTILIZE A SEPARATE HAUL ROAD FOR THE TRANSPORT OF EXCESS MATERIAL, THE CONTRACTOR IS RESPONSIBLE FOR THE USE OF WATER FOR DUST CONTROL. THE ENGINEER SHALL ESTABLISH THE APPLICATION RATE. ALL COSTS INCLUDED IN THE COST OF CONTRACT.
- THE CONTRACTOR SHALL PROVIDE TRAFFIC CONTROL ACCORDING TO APPLICABLE HIGHWAY STANDARDS INCLUDED IN THESE PLANS WHILE HAULING EXCESS CUT BETWEEN STAGES.
- THE CONTRACTOR SHALL PROVIDE ACCESS TO ALL RESIDENCES, COMMERCIAL, FIREHOUSE, CHURCH AND SCHOOL THROUGHOUT CONSTRUCTION.
- THE CONTRACTOR SHALL PROVIDE 1/2" STEEL PLATE COVERS FOR INLETS THAT WILL HAVE TEMPORARY TRAFFIC RUN OVER THEM PRIOR TO THE PLACEMENT OF THE CURB AND GUTTER FRAME AND GRATES. THE COST OF THE STEEL PLATE COVERS SHALL BE INCLUDED IN THE CONTRACT UNIT PRICES FOR DRAINAGE STRUCTURE ITEMS.
- CONTRACTOR SHALL PLUG ANY INLETS THAT ARE TO BE INSTALLED BUT HAVE CONNECTIONS TO BE MADE IN LATER STAGES OF CONSTRUCTION. THE COST OF THE PLUGS SHALL BE INCLUDED IN THE CONTRACT UNIT PRICES FOR STORM SEWER ITEMS.
- CONTRACTOR TO ESTABLISH AND MAINTAIN TEMPORARY DRAINAGE AND EROSION CONTROL FOR EACH STAGE OF CONSTRUCTION. COST INCLUDED IN THE COST OF THE CONTRACT.
- TRAFFIC DIRECTIONAL ARROWS ARE FOR INFORMATION AND SHEET CLARITY ONLY.
- TEMPORARY PAVEMENT MARKINGS TO BE INSTALLED ON COMPLETED PHASES OF WORK PRIOR TO OPENING UNDER TWO-WAY TRAFFIC.
- THE CONTRACTOR SHALL PROVIDE TRAFFIC CONTROL ACCORDING TO APPLICABLE HIGHWAY STANDARDS INCLUDED IN THESE PLANS FOR ROAD CLOSURES AT ALL INTERSECTIONS.
- FOR SHEET CLARITY AND TO MINIMIZE REDUNDANCY, NOT ALL TRAFFIC CONTROL ITEMS AS REQUIRED BY HIGHWAY STANDARDS ARE SHOWN ON THESE STAGING SHEETS. TRAFFIC CONTROL ITEMS NOT SHOWN SHOULD BE INSTALLED PER THE APPLICABLE HIGHWAY STANDARDS.
- SIGNAGE PROVIDED FOR STAGE CONSTRUCTION IS INCLUDED IN THE COST OF TRAFFIC CONTROL.
- EARTH CUT QUANTITY FOR DETOUR INCLUDES THE EARTH CUT REQUIRED TO PLACE TEMPORARY AGGREGATE RUNAROUND. OIL AND CHIP PAVEMENT REMOVAL QUANTITY INCLUDES THE REMOVAL OF THE TEMPORARY AGGREGATE RUNAROUND. SEE EARTHWORK SCHEDULE.

STAGE 1 CONSTRUCTION NOTES

- CONSTRUCT ALL IMPROVEMENTS FOR THIS STAGE, EXCEPT THE 2" HMA SURFACE COURSE AND PERMANENT PAVEMENT MARKINGS, UNLESS OTHERWISE NOTED.
- HUNTWOOD ROAD WILL BE CLOSED EXCEPT TO LOCAL TRAFFIC - LAFORE, LANTER AND ISSELHARD, PROPERTIES TO MAINTAIN ACCESS.
- WOLF BRANCH MIDDLE SCHOOL ENTRANCE AT STA. 35+59.07, WILL BE CLOSED TO ALL TRAFFIC WITH BARRICADES. SCHOOL TRAFFIC WILL UTILIZE THE ENTRANCE AT STA. 39+20.69 DURING THIS STAGE.
- THE CLOSURE OF OLD CASEYVILLE ROAD TO THRU TRAFFIC SHALL NOT EXCEED TWO WEEKS.

TITLE: STAGED CONSTRUCTION AND TRAFFIC CONTROL PLAN STAGE 1
PROJECT: HUNTWOOD ROAD RECONSTRUCTION VILLAGE OF SWANSEA ST. CLAIR COUNTY

REV.	DATE	DESCRIPTION

DRAWN BY: DRB	SHEET
DESIGNED BY: DRB	24
CHECKED BY: SJK	OF 104 SHEETS
APPROVED BY: SJK	PROJECT DESCRIPTION
PROJECT NUMBER: T20-030356	Huntwood Road Reconstruction

- ISSUED FOR REVIEW
- ISSUED FOR BIDDING
- ISSUED FOR CONSTR.
- RECORD DRAWING