

CENTERLINE CURVE DATA

**CURVE NO. 3**  
 P.I. STA. = 15+69.10  
 Δ = 47°02'56"  
 D = 33°42'12"  
 R = 170.00'  
 T = 74.00'  
 L = 139.60'  
 E = 15.41'  
 S.E. = >  
 S.A. = >  
 S.R. = > NO SUPERELEVATIONS

**CURVE NO. 4**  
 P.I. STA. = 17+14.27  
 Δ = 67°05'58"  
 D = 47°44'47"  
 R = 120.00'  
 T = 79.58'  
 L = 140.53'  
 E = 23.99'  
 S.E. = >  
 S.A. = >  
 S.R. = > NO SUPERELEVATIONS

**CURVE NO. 5**  
 P.I. STA. = 18+90.39  
 Δ = 51°32'37"  
 D = 47°44'47"  
 R = 120.00'  
 T = 57.94'  
 L = 107.95'  
 E = 13.25'  
 S.E. = >  
 S.A. = >  
 S.R. = > NO SUPERELEVATIONS

STORM SEWERS

- 2 3 TO 4 53 FT. 12" SS1 WMQ @ 0.57% TRENCH BACKFILL NONE REQUIRED
- 3 4 TO 5 62 FT. 12" SS1, RCC, STORM DRAIN, AND SEWER PIPE, CL. IV @ 0.97% TRENCH BACKFILL 8.1 CU. YDS.
- 4 7 TO 8 37 FT. 12" SS1, RCC, STORM DRAIN, AND SEWER PIPE, CL. IV @ 2.03% TRENCH BACKFILL 2.8 CU. YDS.
- 5 6 TO 9 67 FT. 12" SS1 WMQ @ 0.60% TRENCH BACKFILL 9.1 CU. YDS.
- 6 6 TO 9 56 FT. 12" SS1 WMQ @ 3.39% TRENCH BACKFILL 4.6 CU. YDS.

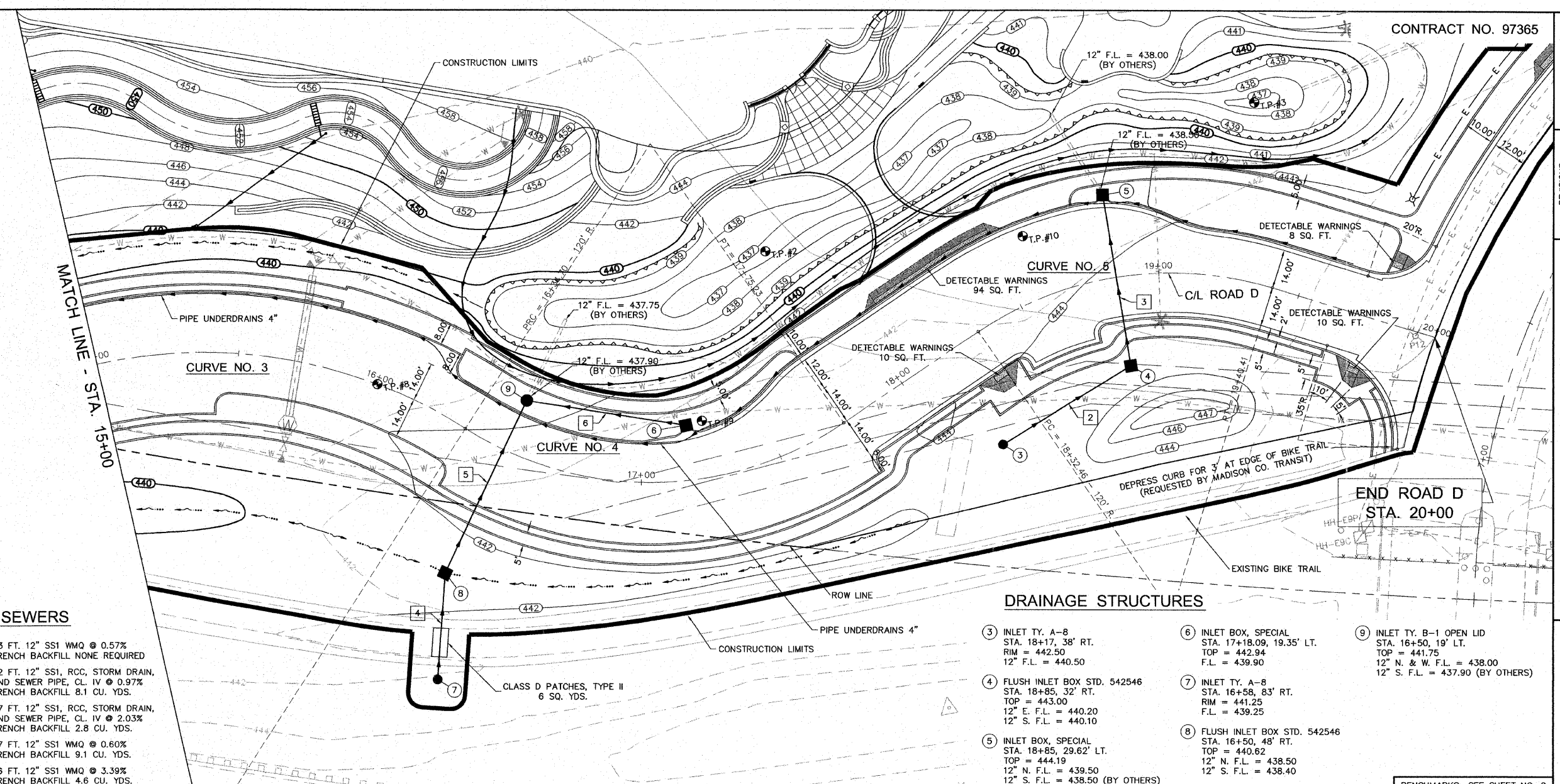

DRAINAGE STRUCTURES

- 3 INLET TY. A-8 STA. 18+17, 38' RT. RIM = 442.50 12" F.L. = 440.50
- 4 FLUSH INLET BOX STD. 542546 STA. 18+85, 32' RT. TOP = 443.00 12" E. F.L. = 440.20 12" S. F.L. = 440.10
- 5 INLET BOX, SPECIAL STA. 18+85, 29.62' LT. TOP = 444.19 12" N. F.L. = 439.50 12" S. F.L. = 438.50 (BY OTHERS)
- 6 INLET BOX, SPECIAL STA. 17+18.09, 19.35' LT. TOP = 442.94 F.L. = 439.90
- 7 INLET TY. A-8 STA. 16+58, 83' RT. RIM = 441.25 F.L. = 439.25
- 8 FLUSH INLET BOX STD. 542546 STA. 16+50, 48' RT. TOP = 440.62 12" N. F.L. = 438.50 12" S. F.L. = 438.40
- 9 INLET TY. B-1 OPEN LID STA. 16+50, 19' LT. TOP = 441.75 12" N. & W. F.L. = 438.00 12" S. F.L. = 437.90 (BY OTHERS)

BENCHMARKS: SEE SHEET NO. 2

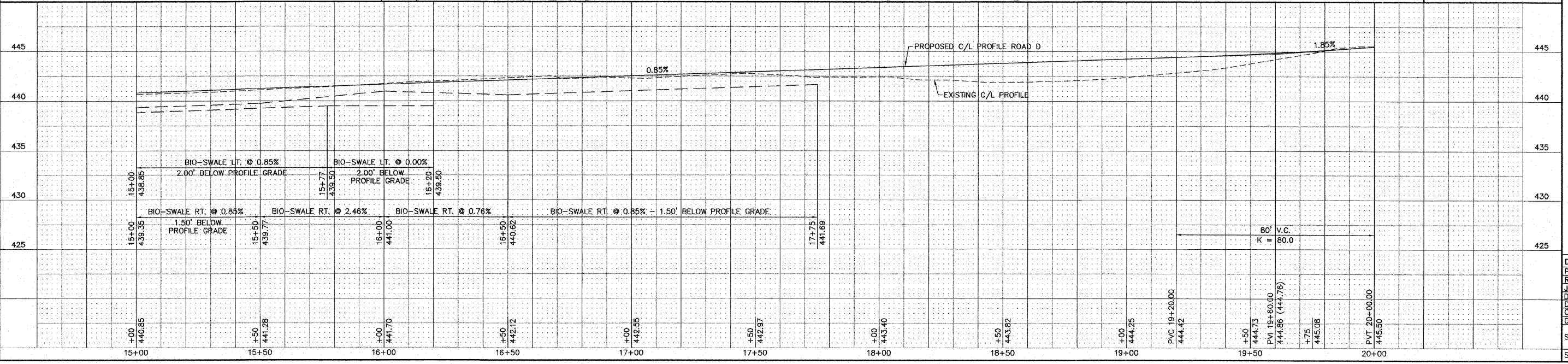

REVISIONS

**SMS ENGINEERS**  
 Sheppard, Morgan & Schwaab, Inc.  
 CONSULTING ENGINEERS AND LAND SURVEYORS  
 215 Market Street, P.O. Box E, Alton, IL 62002 618/462-9795 E-mail: mail@smsengineers.com  
 10 Central Industrial Drive, Granite City, IL 62040 618/877-4700 E-mail: mail@smsengineers.com  
 DESIGN FIRM # 184-000992

LEWIS & CLARK COMMUNITY COLLEGE  
 SECTION 05-00001-00-PK  
 ACCESS ROADS FOR THE  
 NATIONAL GREAT RIVERS RESEARCH AND EDUCATION CENTER  
 PLAN AND PROFILE - ROAD D

DWG. NO. RWY P-P-DWG  
 REF. BK. PG. 1  
 JOB NO. 457111.1  
 DSN. BY: DEG  
 DWN. BY: CAD  
 CHK. BY: DEG  
 DATE: SEPT. 8, 2008  
 SCALE: 1" = 20' H.  
 1" = 5' V.  
 SHEET 12 OF 36

S:\Land Projects\AAC 40523\dwg\Phase1\RWY P-P.dwg, 2/2/2009 9:02:10 AM, jman, 1:20