

CONTRACT NO. 97365

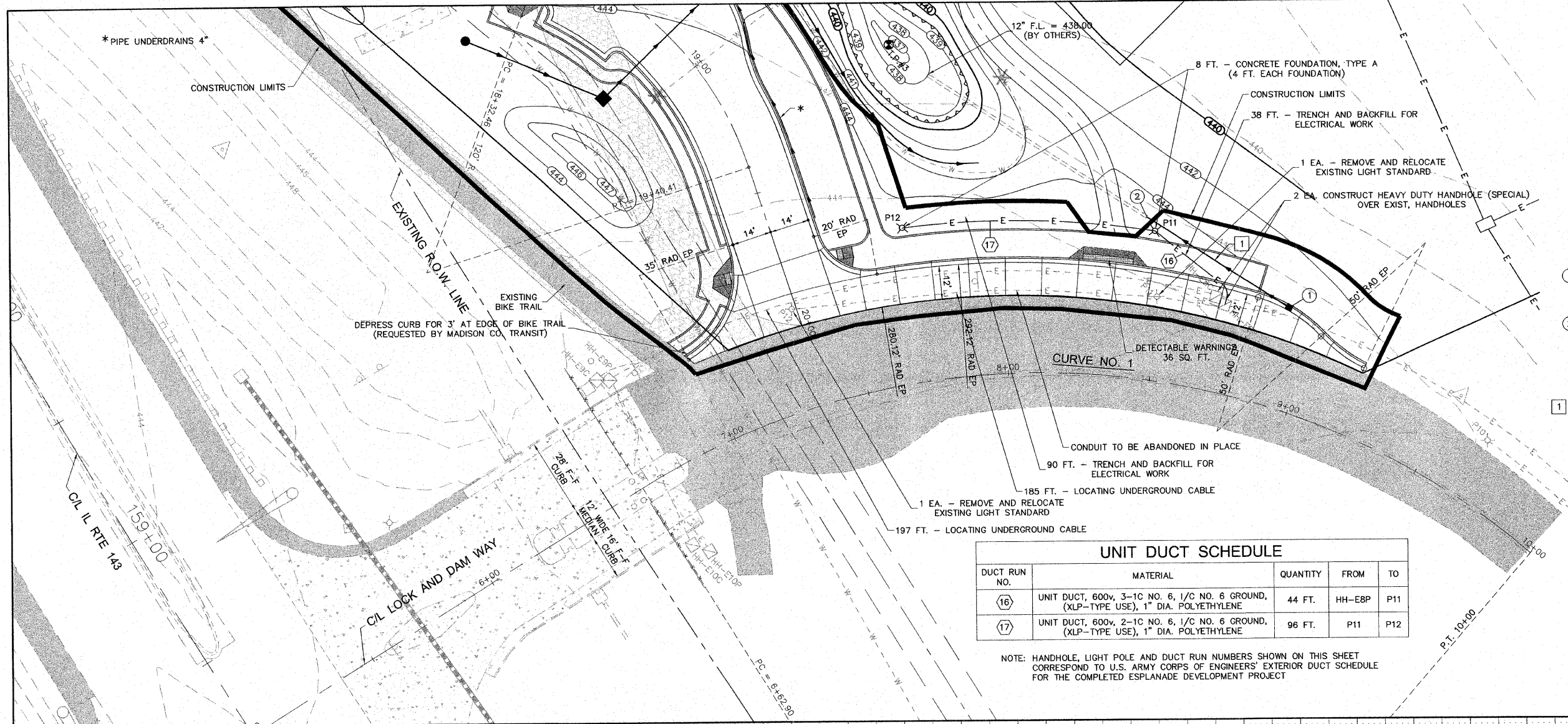
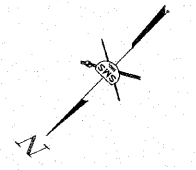
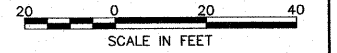

**DRAINAGE STRUCTURES**

- ① INLET TY. A-3V SPECIAL STA. 8+90, 36.14' LT. T.C. = 443.68 12" F.L. = 440.68
- ② CONNECT TO PIPE STUBBED OUT BY OTHERS 12" F.L. = 439.62

**STORM SEWERS**

- ① ① TO ② 60 FT. 12" SS1 WMQ @ 1.76% TRENCH BACKFILL 14.0 CU. YDS.

**CENTERLINE CURVE DATA**

**CURVE NO. 1**

P.I. STA. = 8+58.58  
 $\Delta = 72^{\circ}53'06''$   
 $D = 21^{\circ}37'16''$   
 $R = 265.00'$   
 $T = 195.68'$   
 $L = 337.10'$   
 $E = 64.42'$

DUCT RUN NO.	MATERIAL	QUANTITY	FROM	TO
①⑥	UNIT DUCT, 600v, 3-1C NO. 6, 1/C NO. 6 GROUND, (XLP-TYPE USE), 1" DIA. POLYETHYLENE	44 FT.	HH-EBP	P11
①⑦	UNIT DUCT, 600v, 2-1C NO. 6, 1/C NO. 6 GROUND, (XLP-TYPE USE), 1" DIA. POLYETHYLENE	96 FT.	P11	P12

NOTE: HANDHOLE, LIGHT POLE AND DUCT RUN NUMBERS SHOWN ON THIS SHEET CORRESPOND TO U.S. ARMY CORPS OF ENGINEERS' EXTERIOR DUCT SCHEDULE FOR THE COMPLETED ESPLANADE DEVELOPMENT PROJECT

BENCHMARKS: SEE SHEET NO. 2

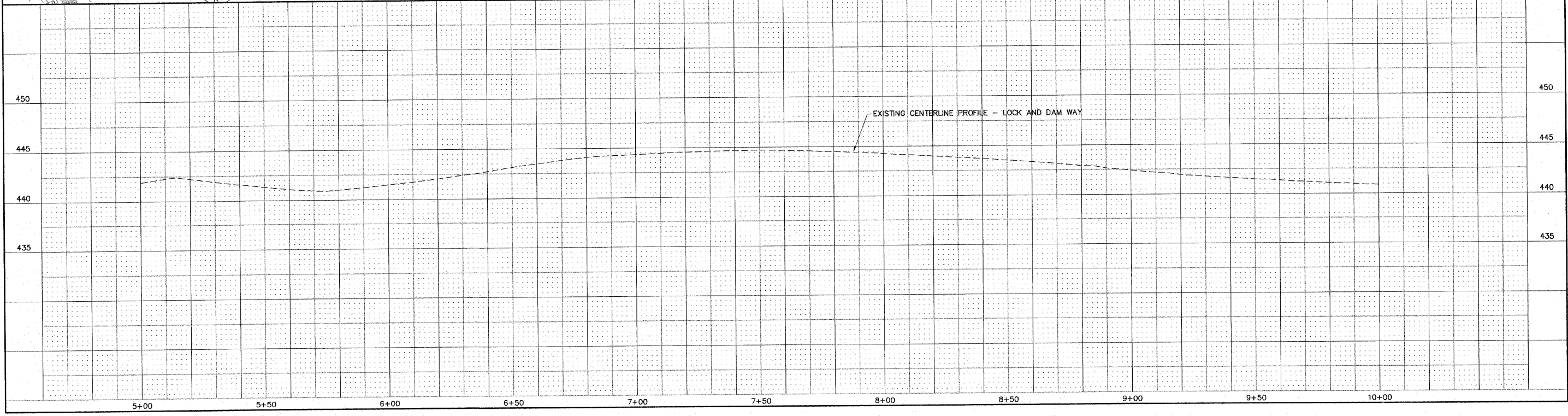

REVISIONS

**SMS ENGINEERS**  
**Sheppard, Morgan & Schwaab, Inc.**  
 CONSULTING ENGINEERS AND LAND SURVEYORS  
 215 Marine Street, P.O. Box E, Alton, IL 62002 618/462-9795 E-mail: mail@smsengineers.com  
 10 Central Industrial Drive, Granite City, IL 62040 618/877-8700 E-mail: mail@smsengineers.com  
 DESIGN FIRM # 184-000992

LEWIS & CLARK COMMUNITY COLLEGE  
 SECTION 05-00001-00-PK  
 ACCESS ROADS FOR THE  
 NATIONAL GREAT RIVERS RESEARCH AND EDUCATION CENTER  
 PLAN AND PROFILE - LOCK AND DAM WAY

DWG. NO.	PHASE 1 L&D WAY P-P.DWG
REF. BK.	PG. -
JOB. NO.	457111.1
DSN. BY:	DEG
DWN. BY:	CAD
CHK. BY:	DEG
DATE:	SEPT. 8, 2008
SCALE:	1" = 20' H. 1" = 5' V.
SHEET	14 OF 36