

F.A.P. RTE.	SECTION	COUNTY	TOTAL SHEETS	SHEET NO.
312	101-2(A,B,R)	ALEXANDER	152	46
STA. TO STA.				
FED. ROAD DIST. NO.			ILLINOIS FED. AID PROJECT	

N  
1:500 RATIO



**CURVE 5**  
 Prop. Curve DETA  
 PI Sta. 0+042.90  
 $\Delta = 15^\circ 02' 16.89''$   
 T = 42.897 m  
 R = 325.000 m  
 L = 85.056 m  
 E = 2.819 m  
 PC Sta. 0+000.000  
 PT Sta. 0+085.300

**CURVE 6**  
 Prop. Curve DETA.2  
 PI Sta. 0+128.200  
 $\Delta = 15^\circ 02' 16.90''$  (LT)  
 T = 42.897 m  
 R = 325.000 m  
 L = 85.056 m  
 E = 2.819 m  
 PC Sta. 0+085.300  
 PT Sta. 0+170.600

NO.	AREAS CHECKED	DATE	BY

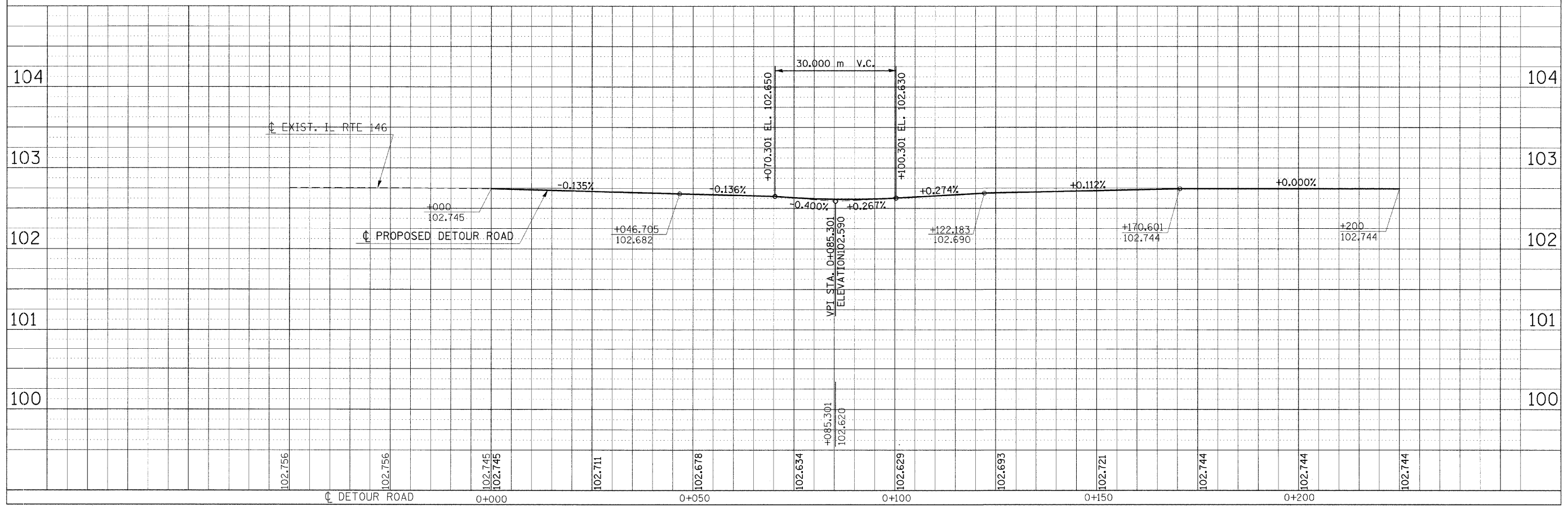
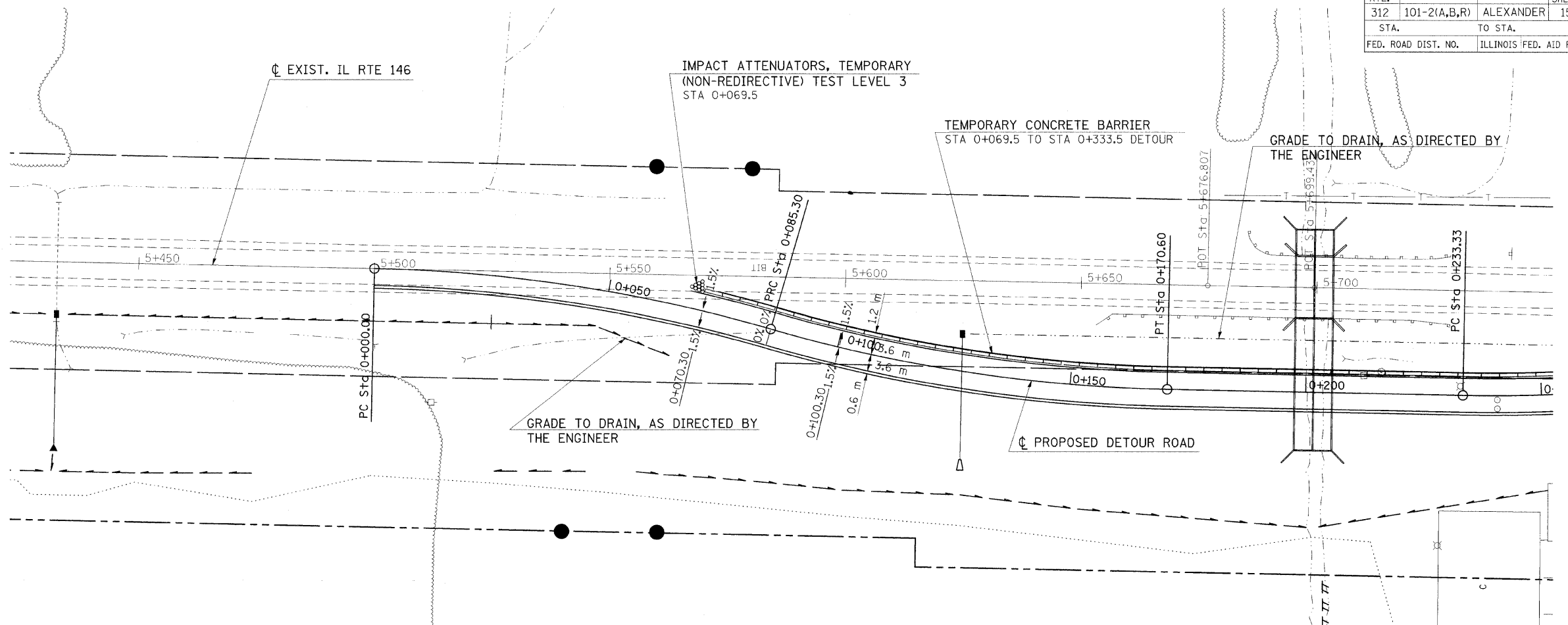

Thursday October 30, 2008 @ 2:24:22 PM  
 ct:\p\... \P\MIDOT\HEADCN\dms43642\m02599p1.dgn LV=2-20,24-60,62-63

**PLAN-PROFILE DETOUR ROAD - STA 0+000 TO STA 0+225**