

F.A.P. RTE.	SECTION	COUNTY	TOTAL SHEETS	SHEET NO.
312	101-2(A,B,R)	ALEXANDER	152	53
STA.	TO STA.			
FED. ROAD DIST. NO.	ILLINOIS FED. AID PROJECT			

NOTE: CONSTRUCTION LIMITS ON NORTH SIDE HAVE BEEN OMITTED FOR CLARITY.

FINAL SURVEY	DATE
SURVEYED	BY
PLOTTED	
TEMP. DATE	
NOTE BOOK NO.	
AREAS CHECKED	

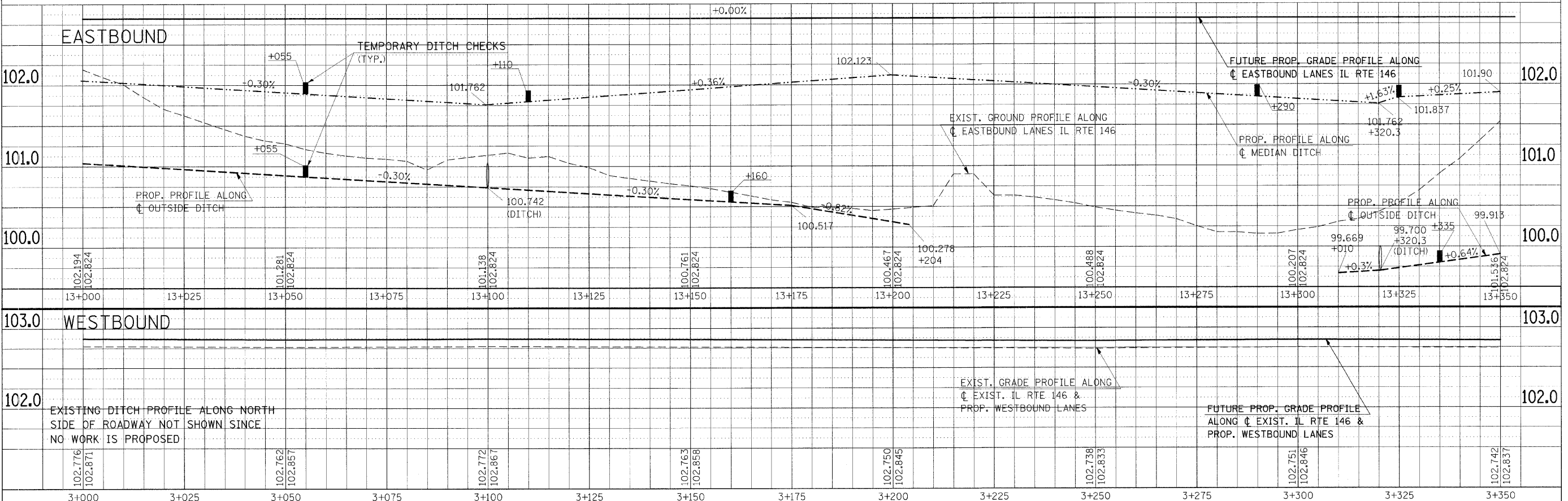
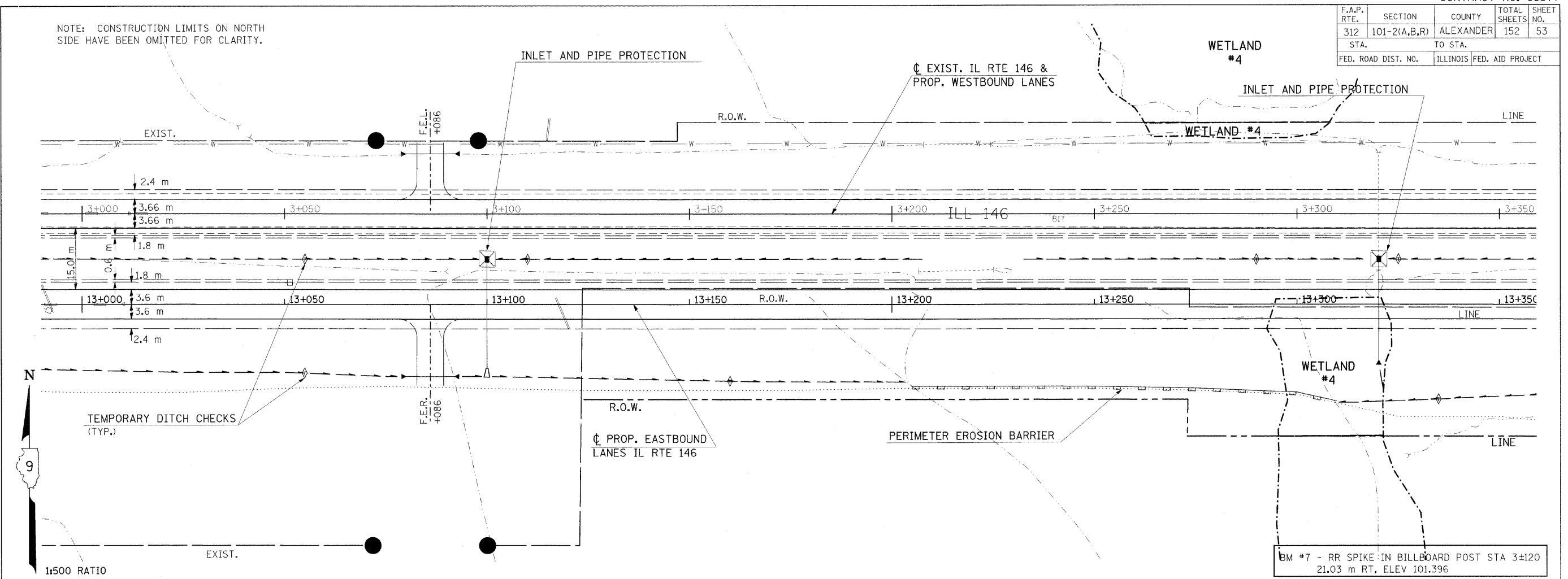

Friday November 21, 2008 @ 11:46:07 AM
 c:\pwwork\pwwork\pwwork\headon\adms\3542\m02599\pi.dgn LV=2-23,25-60,62-63
 c:\pwwork\pwwork\pwwork\headon\adms\3542\m02599\pi.dgn LV=1-26,24-63
 c:\pwwork\pwwork\pwwork\headon\adms\3542\m02599\pi.dgn LV=2-9,11,13-17,19,21-23,25-68

TEMPORARY EROSION CONTROL PLAN - STA 3+000 TO STA 3+350