

F.A.P. RTE.	SECTION	COUNTY	TOTAL SHEETS	SHEET NO.
312	101-2(A,B,R)	ALEXANDER	152	55
STA.	TO STA.		FED. ROAD DIST. NO.	
	ILLINOIS		FED. AID PROJECT	

NOTE: CONSTRUCTION LIMITS ON NORTH SIDE HAVE BEEN OMITTED FOR CLARITY.

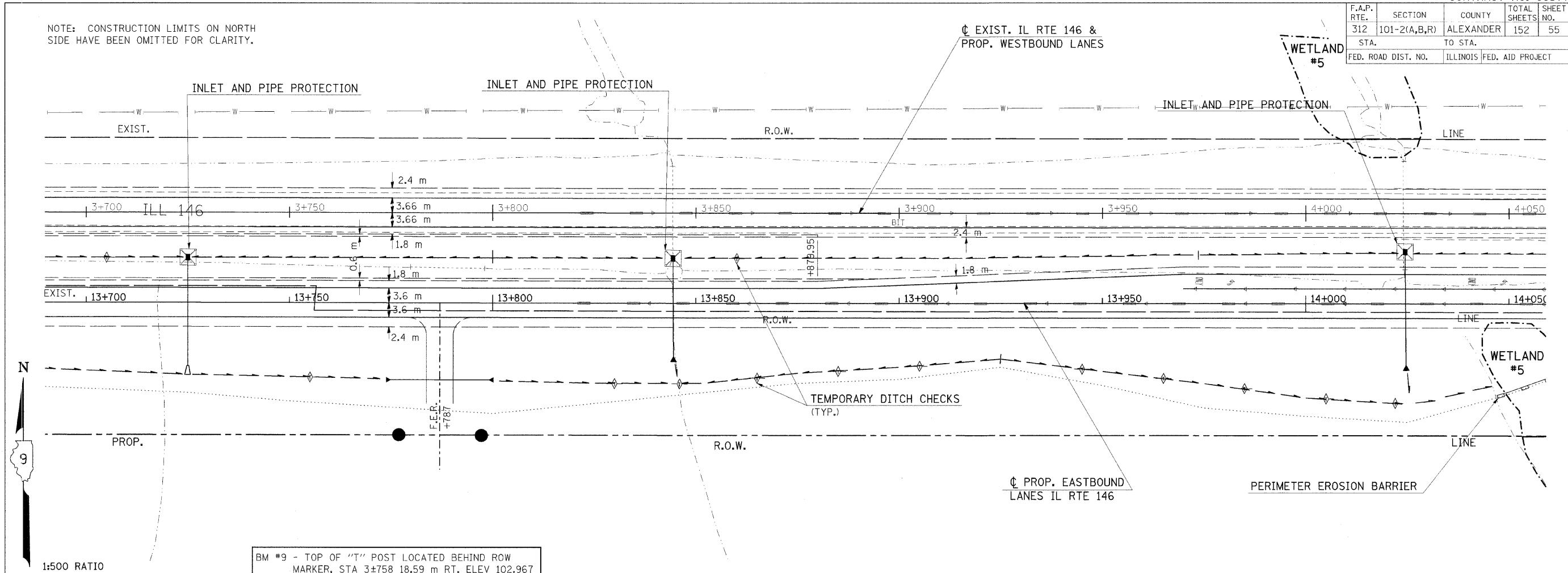

BY	DATE
FINAL SURVEY	
SURVEY PLOTTED	
NOTE BOOK	
TEMPLATE	
AREAS CHECKED	
NO.	



1:500 RATIO

BM #9 - TOP OF "T" POST LOCATED BEHIND ROW
 MARKER, STA 3+758 18.59 m RT, ELEV 102.967

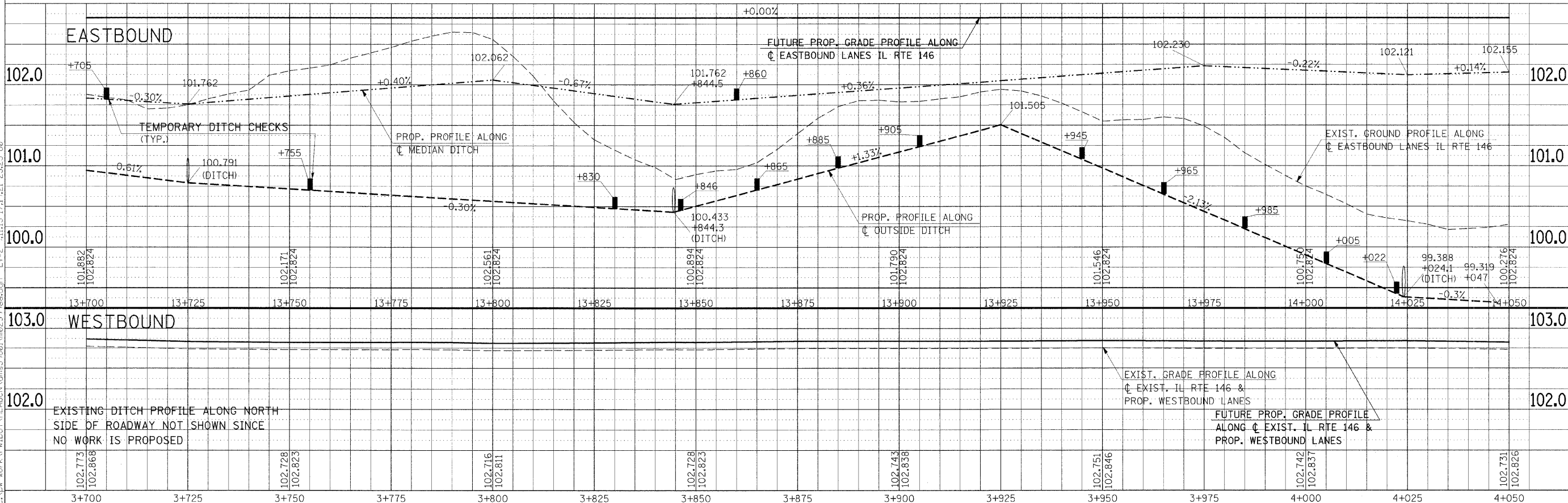

Friday, November 21, 2008 @ 11:47:33 AM
 c:\pwork\work\pwork\headcn\dm\33642\m02599\pl.dgn LV=2-23,25-60,62-63
 c:\pwork\work\pwork\headcn\dm\33642\m02599\pl.dgn LV=1-21,24-62
 c:\pwork\work\pwork\headcn\dm\33642\m02599\pl.dgn LV=2-6,11,13-17,19,21-23,25-60

TEMPORARY EROSION CONTROL PLAN - STA 3+700 TO STA 4+050