

F.A.P. RTE.	SECTION	COUNTY	TOTAL SHEETS	SHEET NO.
312	101-2(A,B,R)	ALEXANDER	152	96
STA. 2+625.40			TO STA. 2+675.00	
FED. ROAD DIST. NO.			ILLINOIS FED. AID PROJECT	

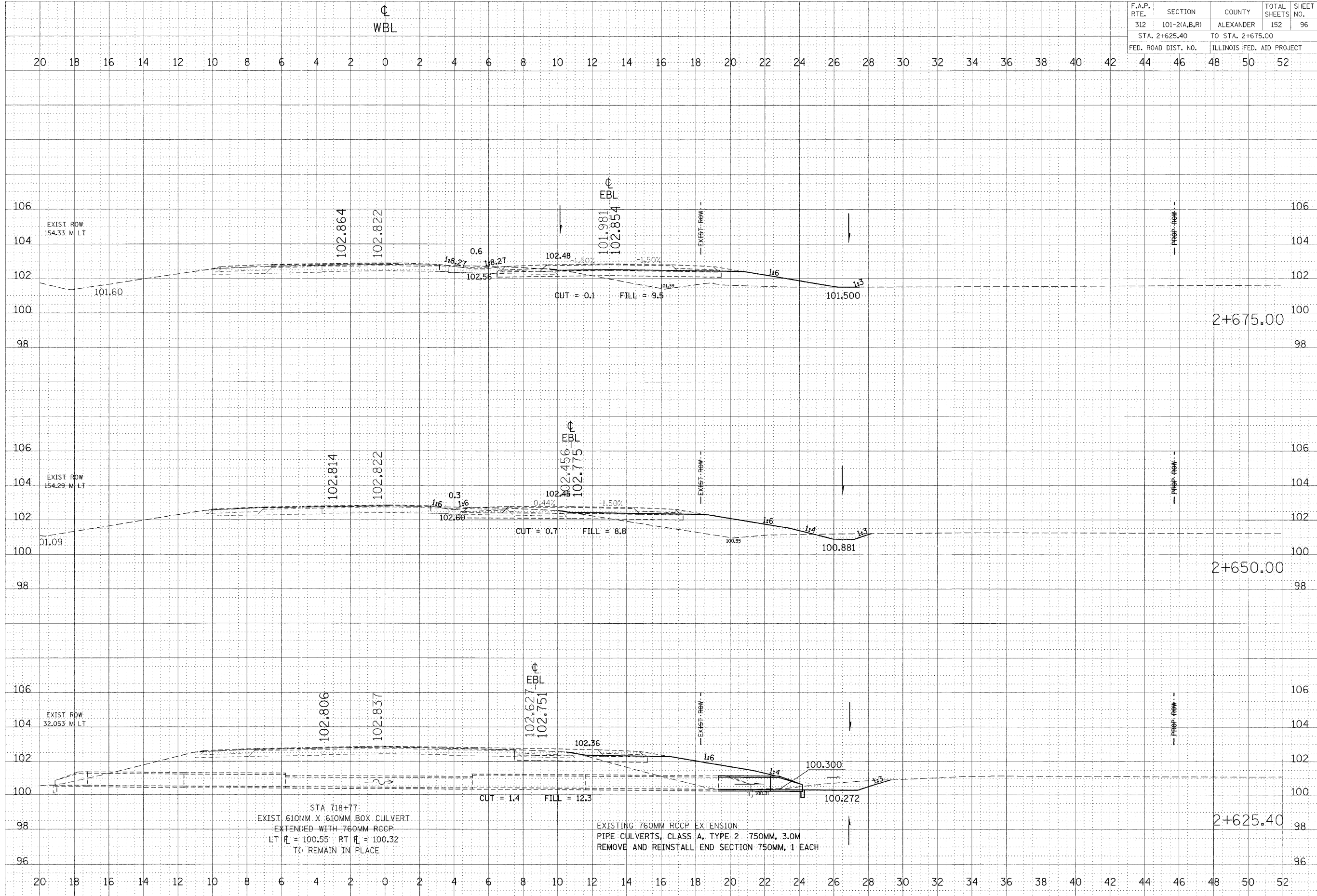

STA 718+77
 EXIST 610MM X 610MM BOX CULVERT
 EXTENDED WITH 760MM RCCP
 LT \bar{r} = 100.55 RT \bar{r} = 100.32
 TO REMAIN IN PLACE

EXISTING 760MM RCCP EXTENSION
 PIPE CULVERTS, CLASS A, TYPE 2 750MM, 3.0M
 REMOVE AND REINSTALL END SECTION 750MM, 1 EACH

NO.	AREAS CHECKED	DATE	BY

NO.	AREAS CHECKED	DATE	BY

PLOT DATE = 10/27/2008
 FILE NAME = c:\pwworkspace\pwworkspace\1011\1011\1011.dwg
 PLOT SCALE = 1:2000000 m / M.
 USER NAME = jef@bentley.com