

P.I. STA. 12+88.45
(TO BE SET)
N. 1000.00
E. 1288.45

ENTRANCES TO BE BUILT
RT. STA. 11+70 F.E. -12.0% AGG. 16' SURF.
RT. STA. 12+67 F.E. -12.0% AGG. 34' SURF.
QUANTITIES INCLUDED IN EARTHWORK TABLE.

EXISTING STRUCTURE NO. 041-3027
STATION 10+00 - SEVEN SPAN TIMBER DECK &
STRINGER BRIDGE ON TIMBER PILE BENT ABUTMENTS
AND PIERS WITH TIMBER WINGWALLS.
101.45' FC-F.C. ABUTS; 16.0' o.-o. DECK

DATE	
BY	
SURVEYED	
PLOTTED	
GRADES CHECKED	
STRUCTURE NOTATION CHECKED	
NOTE BOOK NO.	
FILE NAME	

DATE	
BY	
SURVEYED	
PLOTTED	
GRADES CHECKED	
STRUCTURE NOTATION CHECKED	
NOTE BOOK NO.	
FILE NAME	

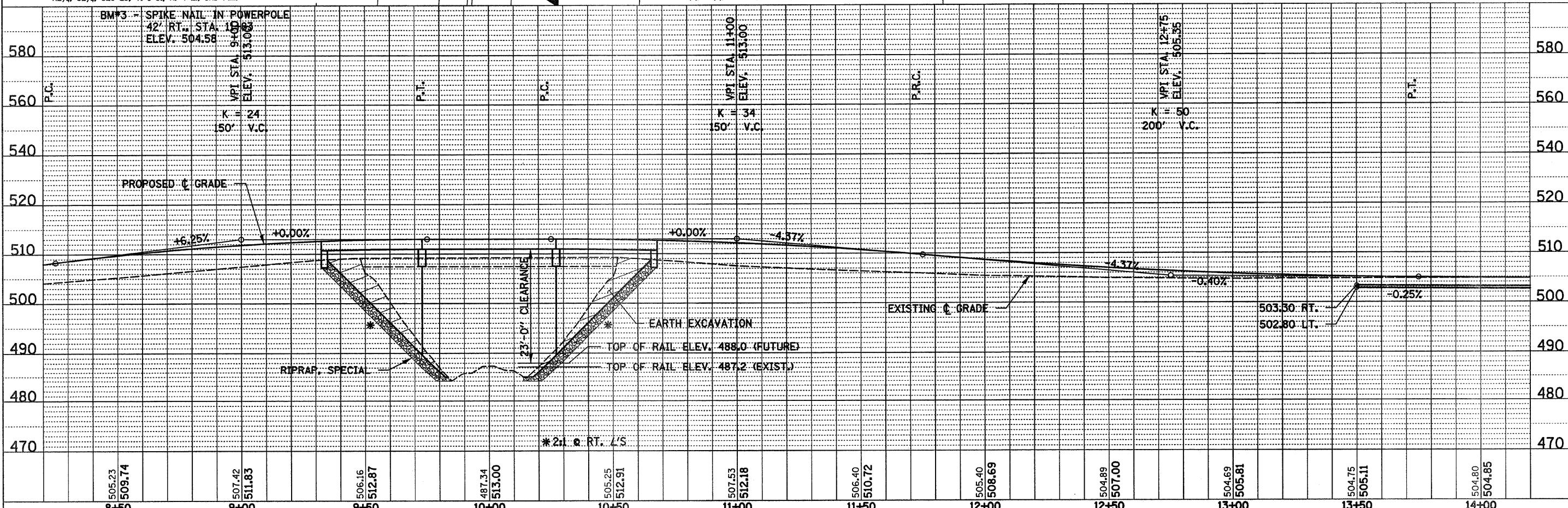

FILE NAME = 080126-shr-pp2.dgn	USER NAME =	DESIGNED - J.W.F.	REVISED -	STATE OF ILLINOIS JEFFERSON COUNTY HIGHWAY DEPARTMENT HAMPTON, LENZINI & RENWICK, INC. CIVIL & STRUCTURAL ENGINEERS LAND SURVEYORS SCALE: 1" = 20' SHEET NO. 2 OF 3 SHEETS	PLAN & PROFILE MALECKI ROAD T.R. SECTION COUNTY TOTAL SHEETS SHEET NO. 131 07-06121-00-BR JEFFERSON 30 6 FARRINGTON ROAD DISTRICT CONTRACT NO. 99350 FED. ROAD DIST. NO. ILLINOIS FED. AID PROJECT
	PLOT SCALE =	DRAWN - D.T.M.	REVISED -		
	CHECKED - S.W.M.	REVISED -			
	DATE = 06/26/08	REVISED -			