

ALADDIN FARMS
SW/4, NW/4, SEC 24, T. 1 S., R. 4 E., 3RD P.M.

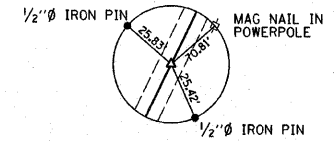

P.O.T. STA. 18+00.78
1/2" Ø IRON PIN (SET)
N. 1417.26
E. 1630.92

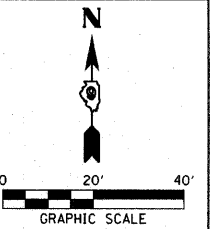

PLAN	SURVEYED	DATE
	PLOTTED	BY
	REVIEWED	
	NOTED	
	NO. OF MAY CHECKED	
	NO.	
	FILE NAME	

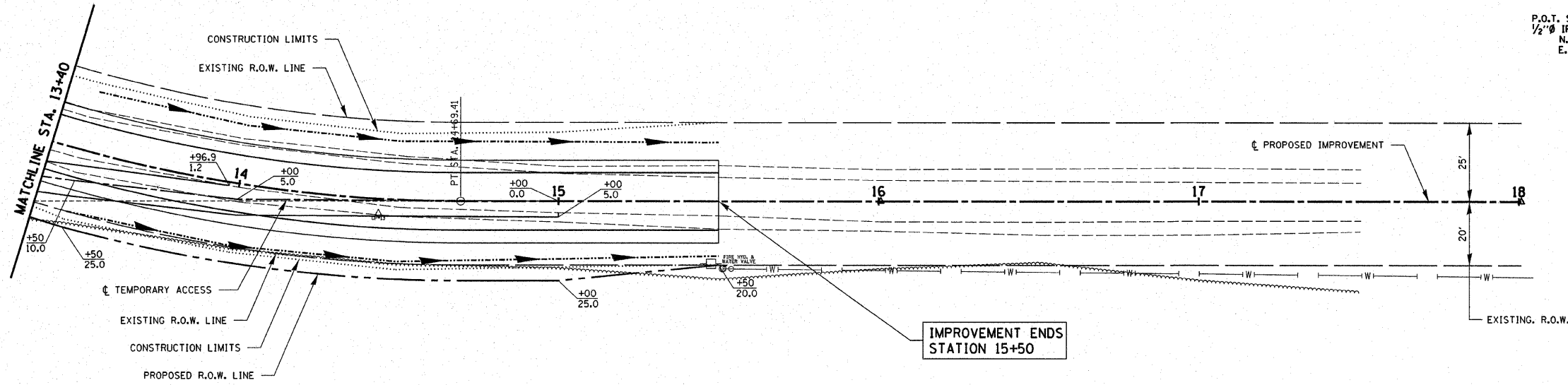

CROPLAND

MARSH YOUNGBLOOD
NW/4, SW/4, SEC 24, T. 1 S., R. 4 E., 3RD P.M.

PROFILE	SURVEYED	DATE
	PLOTTED	BY
	REVIEWED	
	NOTED	
	NO. OF MAY CHECKED	
	NO.	
	FILE NAME	

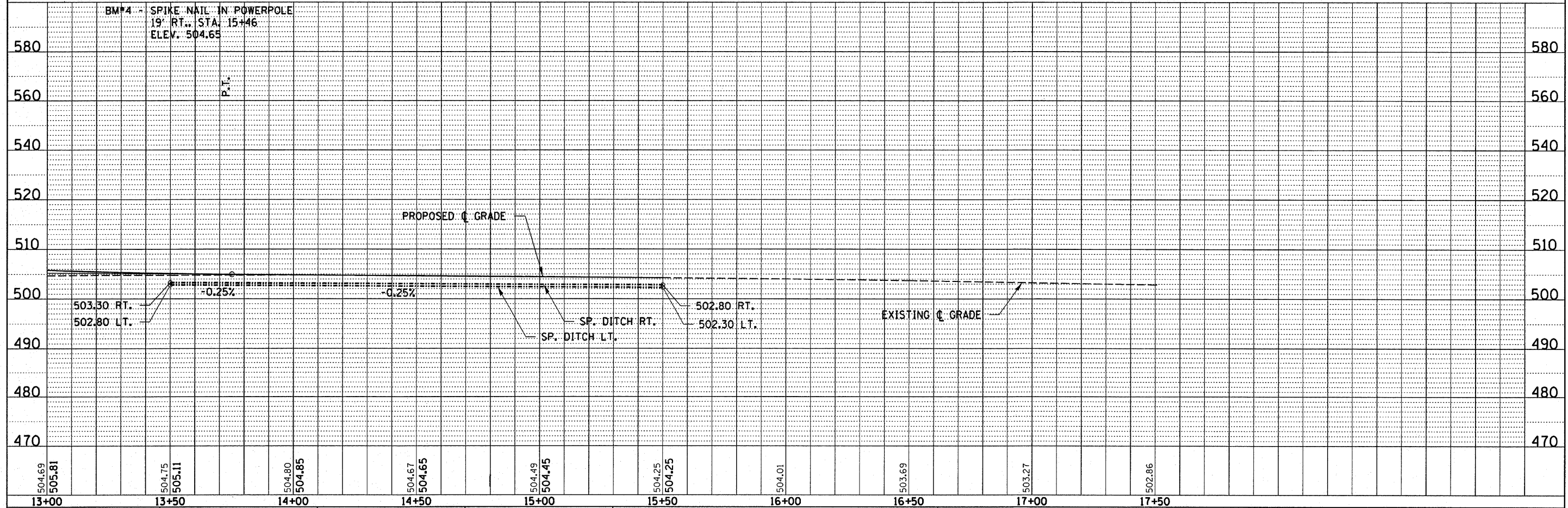

FILE NAME = 080126-sh1-pp3.dgn	USER NAME =	DESIGNED - J.W.F.	REVISED -	<p>STATE OF ILLINOIS JEFFERSON COUNTY HIGHWAY DEPARTMENT</p> <p>HLR HAMPTON, LENZINI & RENWICK, INC. CIVIL & STRUCTURAL ENGINEERS LAND SURVEYORS</p> <p>SCALE: 1" = 20' SHEET NO. 1 OF 3 SHEETS</p>	<p>PLAN & PROFILE MALECKI ROAD</p> <p>T.R. SECTION COUNTY TOTAL SHEETS SHEET NO. 131 07-06121-00-BR JEFFERSON 30 7 FARRINGTON ROAD DISTRICT CONTRACT NO. 99350 FED. ROAD DIST. NO. ILLINOIS FED. AID PROJECT</p>
		DRAWN - D.T.M.	REVISED -		
		CHECKED - S.W.M.	REVISED -		
		DATE - 06/26/08	REVISED -		
				STA. 2+33.45 TO STA. 8+20.00	