

LEGEND

- CRUSHED AGGREGATE BASE COURSE (P-209), 7" DEPTH
- PORTLAND CEMENT CONCRETE (P-501), 6" DEPTH
CRUSHED AGGREGATE BASE COURSE (P-209), 6" DEPTH
- EXISTING CONCRETE PAVEMENT TO REMAIN
- 1 1/2" (P-401) HMA
1 1/2" (P-201) HMA
CRUSHED AGGREGATE BASE COURSE (P-209), 8" DEPTH
- 1 1/2" (P-401) HMA
1 1/2" (P-201) HMA
8" BITUMINOUS BASE COURSE (P-201)
CRUSHED AGGREGATE BASE COURSE (P-209), 8" DEPTH
- EXISTING ASPHALT PAVEMENT TO REMAIN
- REMOVE EXISTING CONCRETE
- REMOVE EXISTING PAVEMENT

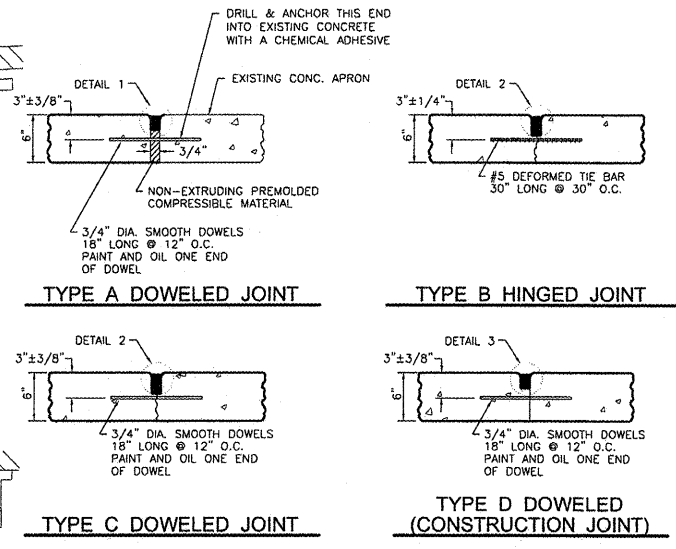

JOINT DETAILS
NOT TO SCALE

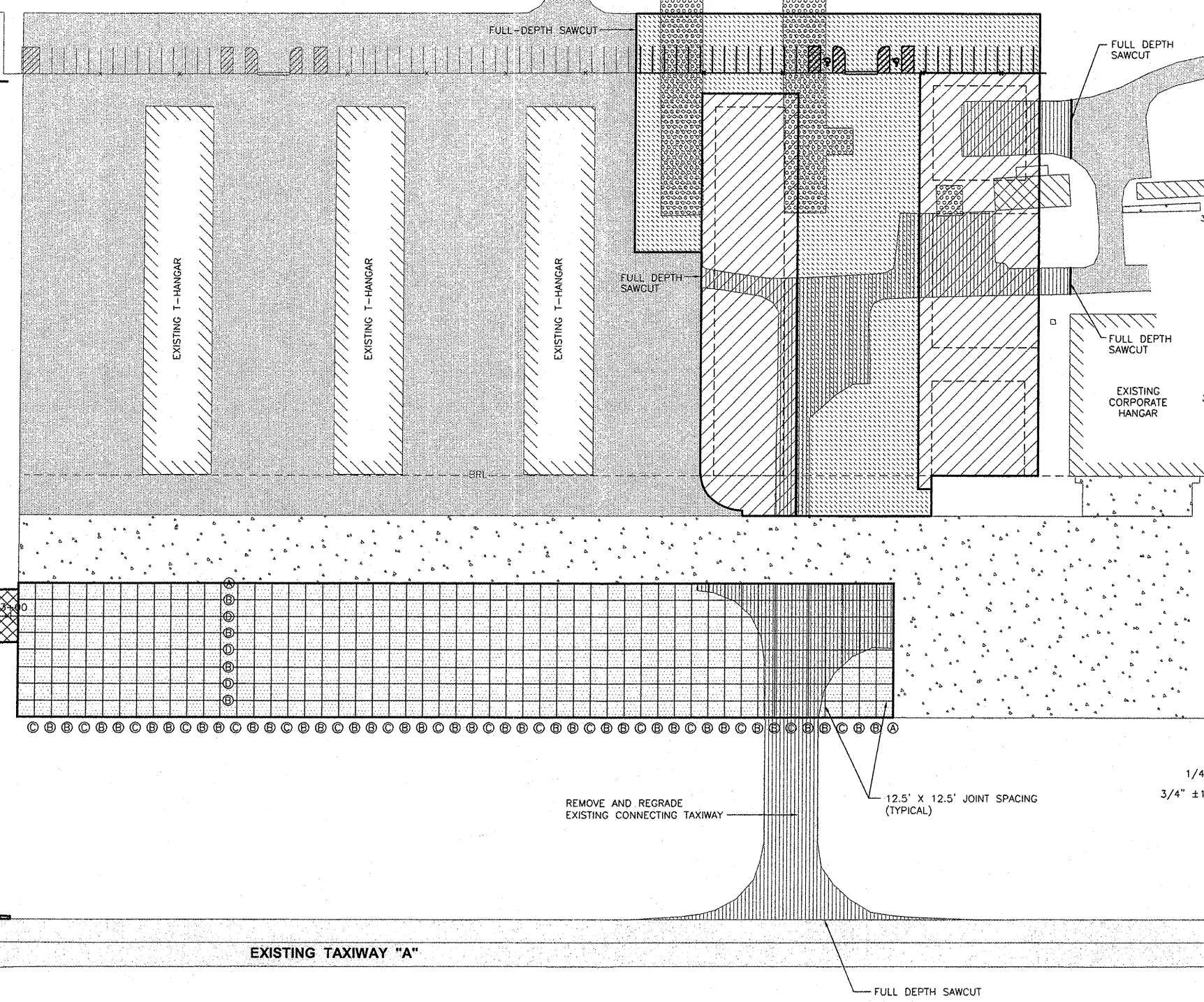
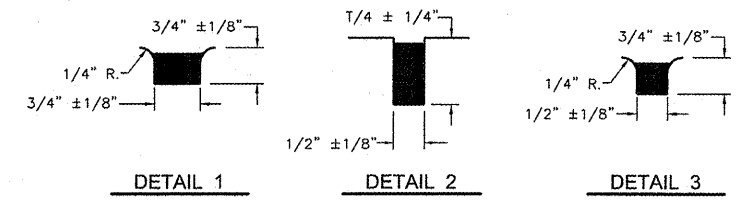

JOINT FILLER DETAILS
NOT TO SCALE

NOTE: ALL SAWCUTS ARE INCIDENTAL TO THE PROJECT.

INTERSECTION OF CENTERLINES
STA. 66+01.10 (EXISTING TAXIWAY "A")
STA. 9+82.98 (PROPOSED CONNECTING TAXIWAY)

CHAMLIN & ASSOCIATES, INC. © 2009
Drawing Name: MORRIS_MUNI_AIRPORT_PAVING_PLAN
Last Modified: Feb 09, 2009 - 2:28pm
Plotted on: Feb 10, 2009 - 10:42am by nick

DRAWN BY: JMT/NET	LEVEL	BY	DATE	REVISIONS	DESCRIPTION
CHECKED BY: KWH					
DATE: 2/09					

CHAMLIN & ASSOCIATES
PERU MORRIS
ILLINOIS

MORRIS MUNICIPAL AIRPORT
MORRIS, ILLINOIS

PAVING PLAN

CONSTRUCTION PLANS

CURRENT AS OF: 2/09	
SCALE: AS NOTED	SHEET 4
FILE NO.: 1002.74 Y-	OF 11