

LEGEND:

- EDGE LIGHT
- GUIDANCE SIGN
- ELECTRICAL CABLE
- STORM SEWER OR UNDERDRAIN
- INLET
- OUTLET
- STORM MANHOLE
- SANITARY MANHOLE
- DRAINAGE DITCH
- CONDUIT OR DUCT BANK
- PROPOSED PAVEMENT MILLING
- PROPOSED PAVEMENT REMOVAL

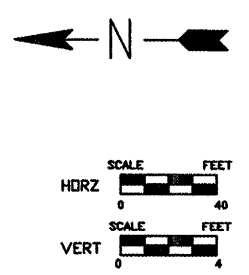

PROPOSED AR401610 - BITUMINOUS SURFACE COURSE:
 STA. 880+67.57 TO 882+40 = 8" DEPTH
 STA. 882+40 TO 884+31.11 = VARIABLE DEPTH OVERLAY WITH 3" MIN.

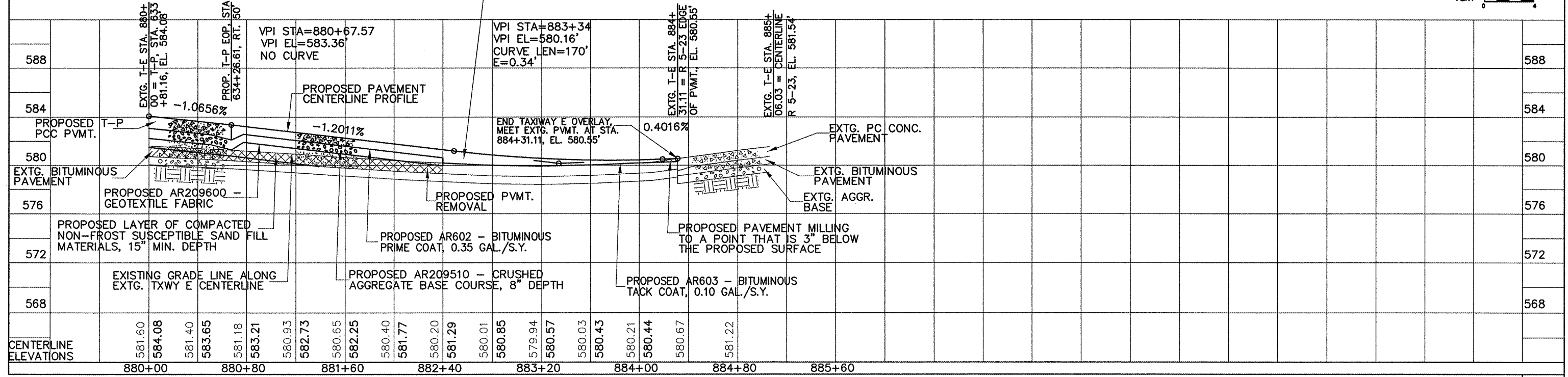

EXISTING TAXIWAY E PLAN & PROFILE, STA 880+00 TO STA 885+60

G:\Airport\A08T032 TP MID PVMTPP1.dwg, 4/1/2009 8:03:55 AM, jefim