

QUAD CITY INTERNATIONAL AIRPORT
 TAXIWAY P, PHASE II - MIDDLE PAVING
 ILL. MLI-3854, QU008
 SHEET 58 OF 82

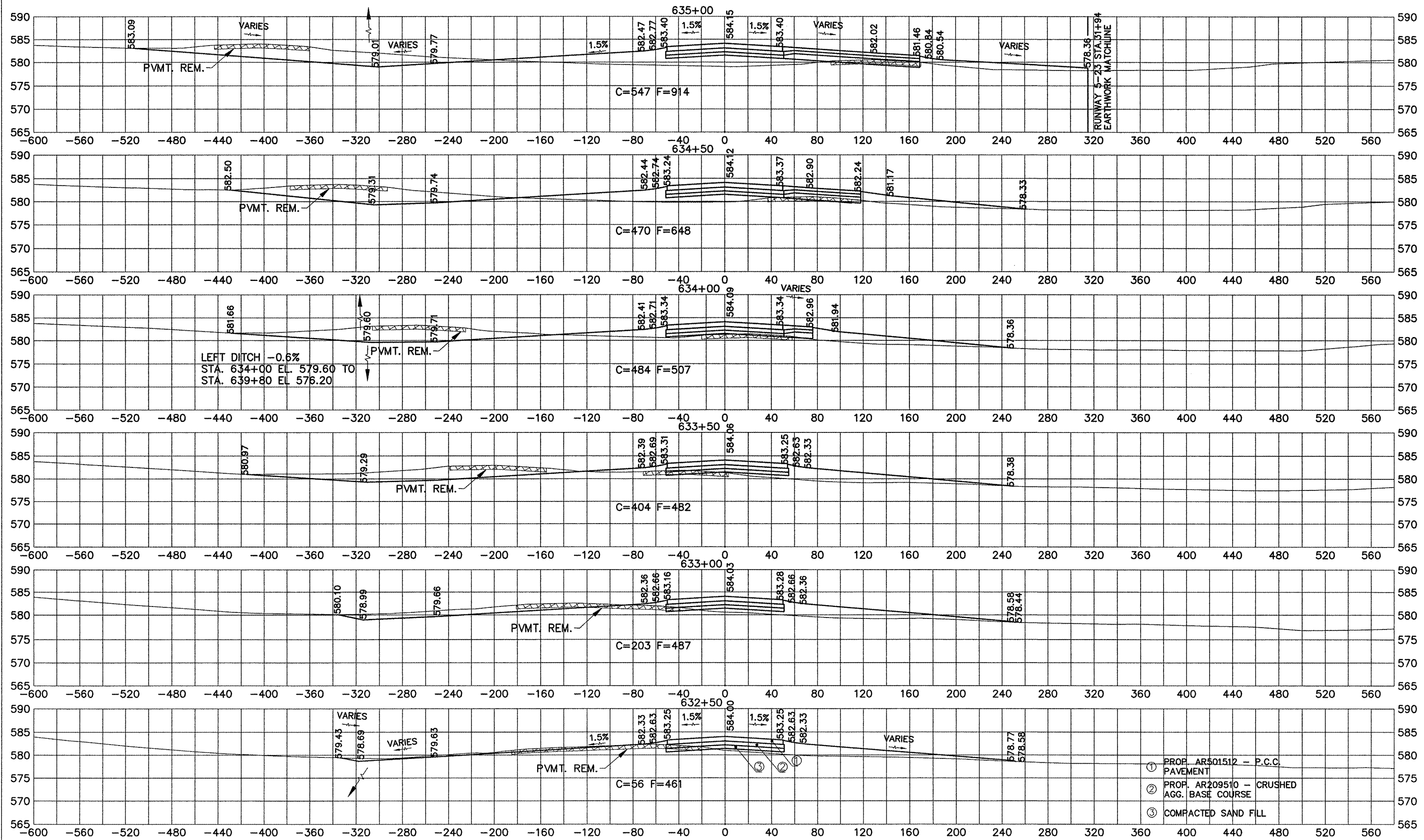

- ① PROF. AR501512 - P.C.C. PAVEMENT
- ② PROF. AR209510 - CRUSHED AGG. BASE COURSE
- ③ COMPACTED SAND FILL

G:\airport\A08T032 TP MID PVMT\SECTIONS P MID PVMT.dwg, 4/1/2009 8:35:30 AM, jefrn