

**PHASING PLAN GENERAL NOTES (CONT'D):**

(NOTES CONTINUED ON PHASING PLAN NOTES - PPN1)

6. PROJECT LIGHTING OUTSIDE OF DAYLIGHT HOURS:  
 WORK PERFORMED BY THE CONTRACTOR OUTSIDE OF DAYLIGHT HOURS SHALL BE DONE UNDER SUFFICIENT ARTIFICIAL AREA LIGHTING TO ALLOW FOR PROPER CONSTRUCTION METHODS AND INSPECTIONS. LIGHT SHALL CONSIST OF MOVEABLE POLE MOUNTED FLOODLIGHTS AND/OR SPOTLIGHTS OF SUFFICIENT NUMBER TO ILLUMINATE THE WORK AREA. VEHICLE HEADLIGHTS WILL BE ALLOWED ONLY IN ADDITION TO OTHER LIGHTS MENTIONED ABOVE. LIGHTING SHALL BE AS APPROVED BY THE ENGINEER AND SHALL NOT BE USED IF THEY AFFECT FLIGHT SAFETY.

7. EXISTING UTILITY COORDINATION:  
 COORDINATION BY THE CONTRACTOR WITH THE EXISTING UTILITIES SHALL BE COMPLETED BEFORE CONSTRUCTION IS STARTED. SEE SECTION 50-17 OF THE SPECIAL PROVISIONS FOR SPECIFIC REQUIREMENTS. THE LOCATION OF UNDERGROUND UTILITIES AS INDICATED ON THE PLANS HAS BEEN OBTAINED FROM EXISTING RECORDS. NEITHER THE OWNER NOR THE ENGINEER ASSUMES ANY RESPONSIBILITY WHATEVER IN RESPECT TO THE ACCURACY, COMPLETENESS, OR SUFFICIENCY OF THE INFORMATION. THERE IS NO GUARANTEE, EITHER EXPRESSED OR IMPLIED, THAT THE LOCATIONS, SIZE AND TYPE OF MATERIAL OF EXISTING UNDERGROUND UTILITIES AS INDICATED ARE REPRESENTATIVE OF THOSE TO BE ENCOUNTERED DURING CONSTRUCTION. IT SHALL BE THE CONTRACTOR'S RESPONSIBILITY TO DETERMINE THE ACTUAL LOCATION OF ALL SUCH FACILITIES, INCLUDING SERVICE CONNECTIONS TO UNDERGROUND UTILITIES. PRIOR TO CONSTRUCTION, THE CONTRACTOR SHALL NOTIFY THE UTILITY COMPANY/OWNER OF HIS OPERATIONAL PLANS. THE CONTRACTOR SHALL MAKE ARRANGEMENTS FOR DETAILED INFORMATION AND ASSISTANCE IN LOCATING UTILITIES. IN THE EVENT AN UNEXPECTED UTILITY INTERFERENCE IS ENCOUNTERED DURING CONSTRUCTION, THE CONTRACTOR SHALL IMMEDIATELY NOTIFY THE UTILITY COMPANY, THE OWNER AND THE ENGINEER. ANY SUCH MAINS AND/OR SERVICES DISTURBED BY THE CONTRACTOR'S OPERATIONS SHALL BE RESTORED IMMEDIATELY AT HIS EXPENSE TO THE SATISFACTION OF THE OWNER AND THE ENGINEER.

SHOULD A UTILITY COMPANY OR GOVERNMENT AGENCY BE UNABLE TO LOCATE FACILITIES, THE CONTRACTOR SHALL LOCATE THESE FACILITIES. PAYMENT FOR THIS LOCATION SHALL BE INCIDENTAL TO THE IMPROVEMENTS REQUIRING THE LOCATIONS.

8. TRAFFIC CONTROL PAYMENT:

PAYMENT FOR ALL AIRSIDE AND ROADWAY TRAFFIC CONTROL INCLUDING, BUT NOT LIMITED TO, TEMPORARY CONSTRUCTION FENCING, BARRICADES, SIGNING, AIR OPERATIONS AREA (A.O.A.) LATH AND RIBBON, ETC. SHALL BE INCIDENTAL TO THE CONTRACT. TYPE 2 BARRICADES WITH STEADY BURN RED LIGHTS SHALL BE PLACED ON 15' CENTERS AND HAVE ORANGE CONSTRUCTION FENCING BETWEEN EACH SET OF BARRICADES. TYPE 2 BARRICADES SHALL BE PLACED AS SHOWN ON THIS PLAN AND AS DIRECTED BY THE ENGINEER FOR WORK ADJACENT TO THE EXPEDITED WORK AREA. WHEN NOT IN USE, THESE BARRICADES SHALL BE STORED AT THE CONTRACTOR'S STAGING AREA OR OFF SITE. ACCESS TO THE ACTIVE RUNWAY AND TAXIWAY PAVEMENTS (TOWER CONTROLLED AREAS) SHALL BE SIGNED WITH STOP SIGNS MOUNTED ON THE CLOSEST BARRICADES (2 EACH, RIGHT AND LEFT) AT THE ENTRANCE. IN ADDITION TO THE STOP SIGNS, WARNING SIGNS (2 EACH, RIGHT AND LEFT) SHALL BE MOUNTED. WARNING SIGNS SHALL STATE "TOWER CONTROL AREA / UNAUTHORIZED ACCESS SUBJECT TO FINE." ALL TYPE II AND TYPE III BARRICADES SHALL CONFORM TO IDOT STANDARD DETAIL 702001. ALL PAVEMENT DROP-OFFS GREATER THAN 24" REQUIRE TYPE II BARRICADES WITH EXTENDED LEGS. FOR AIRSIDE BARRICADE PLACEMENT, SEE SEQUENCE OF CONSTRUCTION SHEETS.

9. DRIVERS TRAINING AND BADGING:

DRIVER'S TRAINING AND BADGING SHALL BE REQUIRED FOR THE CONTRACTOR'S SUPERVISORY PERSONNEL, OTHER CONSTRUCTION PERSONNEL CAN BE WITHIN THE AIRFIELD LIMITS PROVIDED THAT THEY ARE UNDER ESCORT AND IN THE PRESENCE OF AN AUTHORIZED SUPERVISOR. THE DRIVER'S TRAINING AND BADGING OF THE INITIAL SUPERVISORY PERSONNEL MUST BE COMPLETED PRIOR TO THE START OF CONSTRUCTION.

10. DUST CONTROL REQUIREMENTS:

THE CONTRACTOR SHALL BE REQUIRED TO PROVIDE DUST CONTROL AT ALL TIMES DURING THE PROJECT DURATION. A WATER TRUCK SHALL BE REQUIRED TO BE ON SITE DURING ALL CONSTRUCTION OPERATION WORKING HOURS, UNLESS WAIVED BY THE DEPUTY DIRECTOR OF OPERATIONS. PAYMENT FOR DUST CONTROL SHALL BE INCIDENTAL TO THE CONTRACT.

11. OPERATIONAL SAFETY ON AIRPORT DURING CONSTRUCTION (AC 150/5370-2E):

ALL WORK SHALL CONFORM TO AC 150/5370-2E OPERATIONAL SAFETY ON AIRPORT DURING CONSTRUCTION. THIS AC IS AVAILABLE AT [www.faa.gov/arp/pdf/5370-2e.pdf](http://www.faa.gov/arp/pdf/5370-2e.pdf).

12. STAGING AREA:

THE CONTRACTOR'S MATERIAL AND EQUIPMENT, WHEN NOT IN USE, SHALL BE STORED IN THE CONTRACTOR'S STAGING AREA. ALL DELIVERIES, EQUIPMENT REFUELING, EQUIPMENT MAINTENANCE AND EQUIPMENT TRANSFERS SHALL TAKE PLACE WITHIN THE CONTRACTOR'S STAGING AREA.

13. AIRFIELD LIGHTING COORDINATION:

THE CONTRACTOR SHALL BE REQUIRED TO ESTABLISH A COORDINATION PLAN WITH THE AIRPORT DEPUTY DIRECTOR OF OPERATIONS OR HIS DESIGNATED REPRESENTATIVE, REGARDING DE-ENERGIZING AND ENERGIZING OF THE AIRFIELD LIGHTING CIRCUITS AT THE START AND END OF EACH CONSTRUCTION DAY. THE CONTRACTOR SHALL BE RESPONSIBLE FOR LOCATING ALL AIRPORT OWNED UTILITIES AND SHALL BE DONE SO AT NO EXTRA COST TO THE CONTRACT.

14. WEEKLY COORDINATION MEETINGS:

WEEKLY COORDINATION MEETINGS SHALL BE REQUIRED TO DISCUSS PROJECT PROGRESS. AS A MINIMUM, PROJECT SCHEDULE AND GATE VISITOR LOGS SHALL BE DISCUSSED. REPRESENTATION BY THE PRIME CONTRACTOR IS MANDATORY.

15. TEMPORARY CABLES:

ALL EXISTING TAXIWAY AND RUNWAY AIRFIELD LIGHTING CIRCUITS, FAA CABLES AND OTHER AIRPORT ELECTRICAL CABLES SHALL REMAIN IN SERVICE UNTIL REPLACED AS ACCEPTABLE TO THE RESIDENT ENGINEER AND AIRPORT FOR ALL PHASES. ALL TEMPORARY CABLING AND SPLICING NECESSARY TO KEEP THE CIRCUITS IN OPERATION SHALL BE CONSIDERED INCIDENTAL TO CONTRACT.

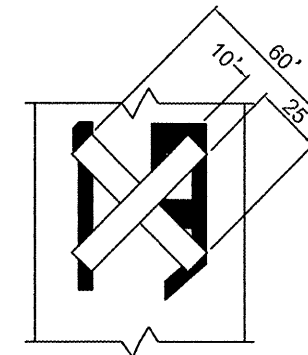

**CLOSED RUNWAY MARKER DETAIL**  
 ON PAVEMENT - NO SCALE

1. CLOSED RUNWAY MARKERS SHALL BE YELLOW.
2. MARKERS SHALL BE A MATERIAL APPROVED BY THE ENGINEER AND THE AIRPORT.
3. CONTRACTOR SHALL MAINTAIN AND RELOCATE MARKERS AS SHOWN ON THE PLANS OR AS NEEDED TO FACILITATE CONSTRUCTION.
4. MARKERS SHALL BE PLACED OVER EXISTING RUNWAY NUMERALS AS SHOWN.
5. COST OF FURNISHING, INSTALLING, MAINTAINING AND REMOVING MARKERS SHALL BE CONSIDERED INCIDENTAL TO THE CONTRACT.
6. DURING VARIOUS PHASES OF WORK, IT WILL BE NECESSARY TO CLOSE RUNWAYS TO AIR TRAFFIC ON A TEMPORARY BASIS AS COORDINATED WITH THE AIRPORT AND TOWER PERSONNEL. THE CONTRACTOR SHALL MARK THE RUNWAYS TO BE CLOSED BY PLACING A YELLOW CROSS AT THE LOCATION AND DIMENSIONS DETAILED ON THIS SHEET OR AS DIRECTED BY THE ENGINEER AND AIRPORT. THE CROSSES ARE SHOWN ON THE RESPECTIVE RUNWAYS ACCORDING TO THE VARIOUS PHASES OF WORK AS DELINEATED IN THE SUGGESTED SEQUENCE OF CONSTRUCTION.

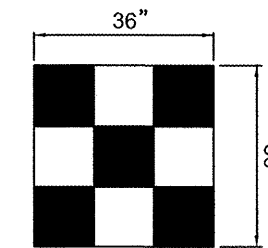

**CONSTRUCTION EQUIPMENT AND TRUCK SIGNAL FLAG**  
 NOT TO SCALE

**PHASING PLAN DETAILS (PPD1)**

RO016



Chicago Rockford International Airport



Rockford, Illinois

Greater Rockford Airport Authority

AIP: 3-17-0088-XX  
 RFD-3862

Rehab. Txy B South (Phase 1)

Revisions

Date	Description

0 1  
 THIS BAR IS EQUAL TO 1" AT FULL SCALE (17 X 11).

DESIGN BY:	CMT- RFD
DRAWN BY:	CMT- RFD
CHECKED BY:	CMT- RFD
APPROVED BY:	JGP
DATE:	1-23-2009
JOB No:	06258-04-00

**PHASING PLAN DETAILS (PPD1)**

9