

FEB 10, 2009 4:47 PM HAGL000382  
 C:\AIRPORTS\STLOUIS\B37-06RWYD\AIRPORT\SHEETS\R-701PWP.DWG - Layout1

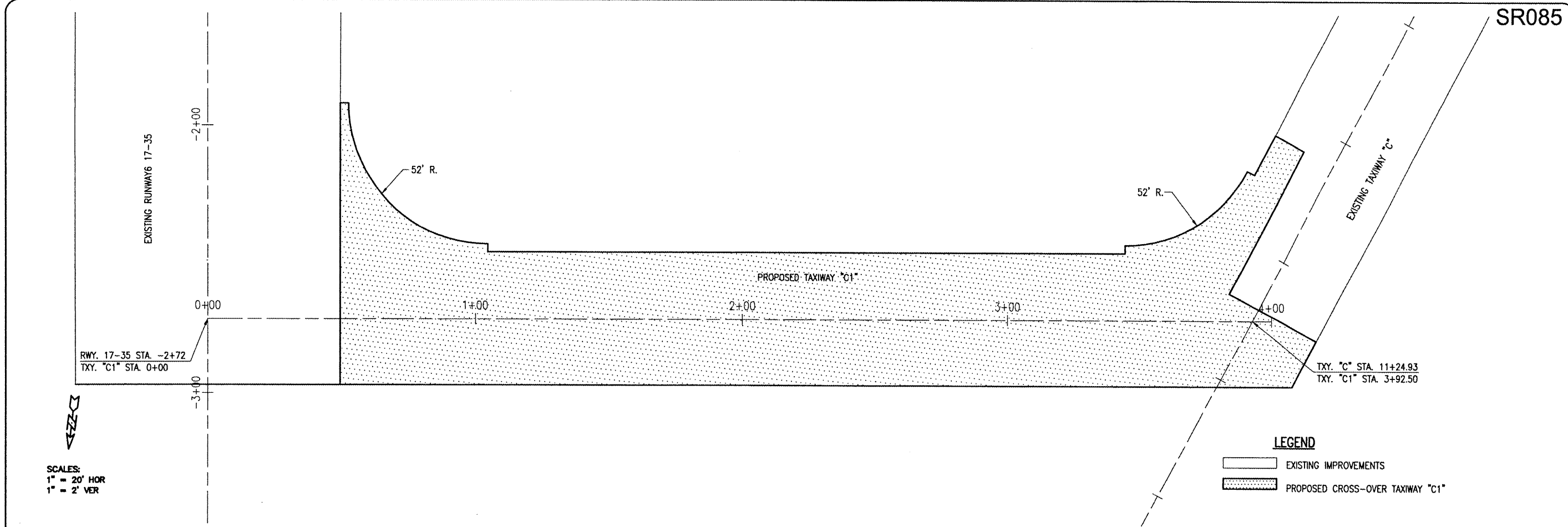

SCALES:  
 1" = 20' HOR  
 1" = 2' VER

**LEGEND**

- EXISTING IMPROVEMENTS
- PROPOSED CROSS-OVER TAXIWAY "C1"

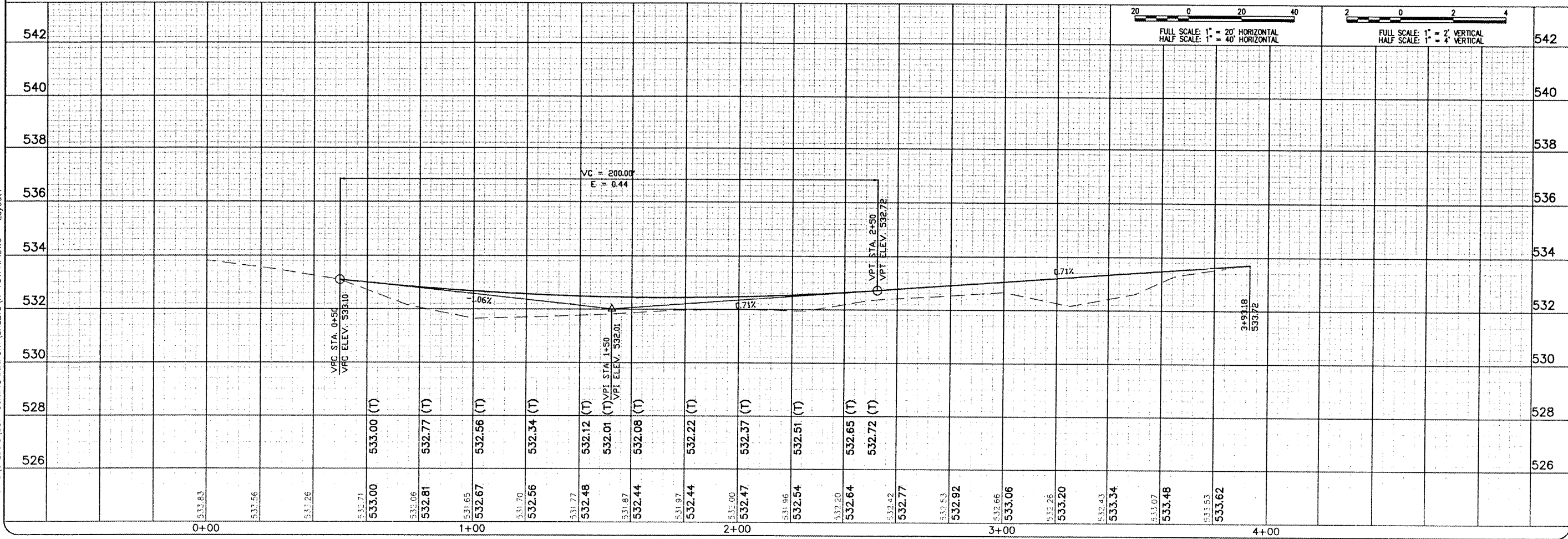

DATE	REVISION	BY

ST. LOUIS REGIONAL AIRPORT  
  
 EAST ALTON, ILLINOIS  
 A.I.P. PROJ.: 3-17-0002-B42  
 IL PROJ.: ALN-3825

H&E Project No. 637066RWD-0800 Drawing R-701PWP.DWG Scale H. 1" = 20' V. 1" = 2' Date 05/28/08	LAYOUT JEO 05/28/08 DRAWN JEO 05/28/08 REVIEWED CAH 07/11/08
---	--

**HANSON**  
 Hanson Professional Services Inc.  
 1526 South Sixth Street  
 Springfield, Illinois 62703-2886  
 Offices Nationwide

RUNWAY SAFETY  
 AREA IMPROVEMENTS  
 PROPOSED  
 PLAN AND PROFILE  
 FOR TAXIWAY "C1"