

THE LOCATION, SIZE AND TYPE OF MATERIAL OF EXISTING UNDERGROUND UTILITIES INDICATED ON THE PLANS IS NOT REPRESENTED AS BEING ACCURATE, SUFFICIENT OR COMPLETE. IT SHALL BE THE CONTRACTOR'S RESPONSIBILITY TO DETERMINE THE ACTUAL LOCATION OF ALL SUCH FACILITIES, INCLUDING SERVICE CONNECTIONS TO UNDERGROUND UTILITIES. PRIOR TO CONSTRUCTION, THE CONTRACTOR SHALL NOTIFY THE UTILITY COMPANIES OF HIS OPERATIONAL PLANS AND SHALL OBTAIN FROM THE RESPECTIVE UTILITY COMPANIES DETAILED INFORMATION AND ASSISTANCE RELATIVE TO THE LOCATION OF THEIR FACILITIES AND THE WORKING SCHEDULE OF THE COMPANIES FOR REMOVAL OR ADJUSTMENT WHERE REQUIRED. IN THE EVENT AN UNEXPECTED UTILITY INTERFERENCE IS ENCOUNTERED DURING CONSTRUCTION, THE CONTRACTOR SHALL IMMEDIATELY NOTIFY THE UTILITY COMPANY OF JURISDICTION. THE ENGINEER SHALL ALSO BE IMMEDIATELY NOTIFIED. ANY SUCH MAINS AND SERVICES SHALL BE RESTORED TO SERVICE AT ONCE AND PAID FOR BY THE CONTRACTOR AT NO ADDITIONAL COST TO THE CONTRACT.

CALL J.U.L.I.E. FOR UTILITY INFORMATION AT 1-800-892-0123.

QUANTITIES THIS SHEET			
ITEM NO.	DESCRIPTION	UNIT	QUANTITY
AR108158	1/C #8 5KV UG CABLE IN UD	L.F.	2,257
AR110502	2-WAY CONCRETE ENCASED DUCT	L.F.	56
AR125410	MITL-STAKE MOUNTED	EACH	13
AR125415	MITL-BASE MOUNTED	EACH	2
AR125443	TAXI GUIDANCE SIGN 3 CHARECTER	EACH	1
AR125444	TAXI GUIDANCE SIGN 4 CHARECTER	EACH	1
AR125447	TAXI GUIDANCE SIGN 7 CHARECTER	EACH </td <td>1</td>	1
AR125540	MI THRESHOLD LIGHT STAKE MOUNTED	EACH	6
AR125545	MI THRESHOLD LIGHT BASE MOUNTED	EACH	2

- LEGEND**
- EXISTING IMPROVEMENTS
 - PROPOSED CROSS-OVER TAXIWAY "C1"
 - EXISTING 1/C #8 5KV U.G. CABLE IN U.D.
 - EXISTING UNDERGROUND ELECTRIC
 - PROPOSED 1/C #8 5KV U.G. CABLE IN U.D.
 - PROPOSED ELECTRICAL DUCT
 - EXISTING STAKE MOUNTED RUNWAY LIGHT
 - EXISTING STAKE MOUNTED TAXIWAY LIGHT
 - PROPOSED STAKE MOUNTED TAXIWAY LIGHT
 - PROPOSED BASE MOUNTED TAXIWAY LIGHT
 - PROPOSED STAKE MOUNTED RUNWAY THRESHOLD LIGHT
 - PROPOSED BASE MOUNTED RUNWAY THRESHOLD LIGHT
 - PROPOSED TAXI GUIDANCE SIGN

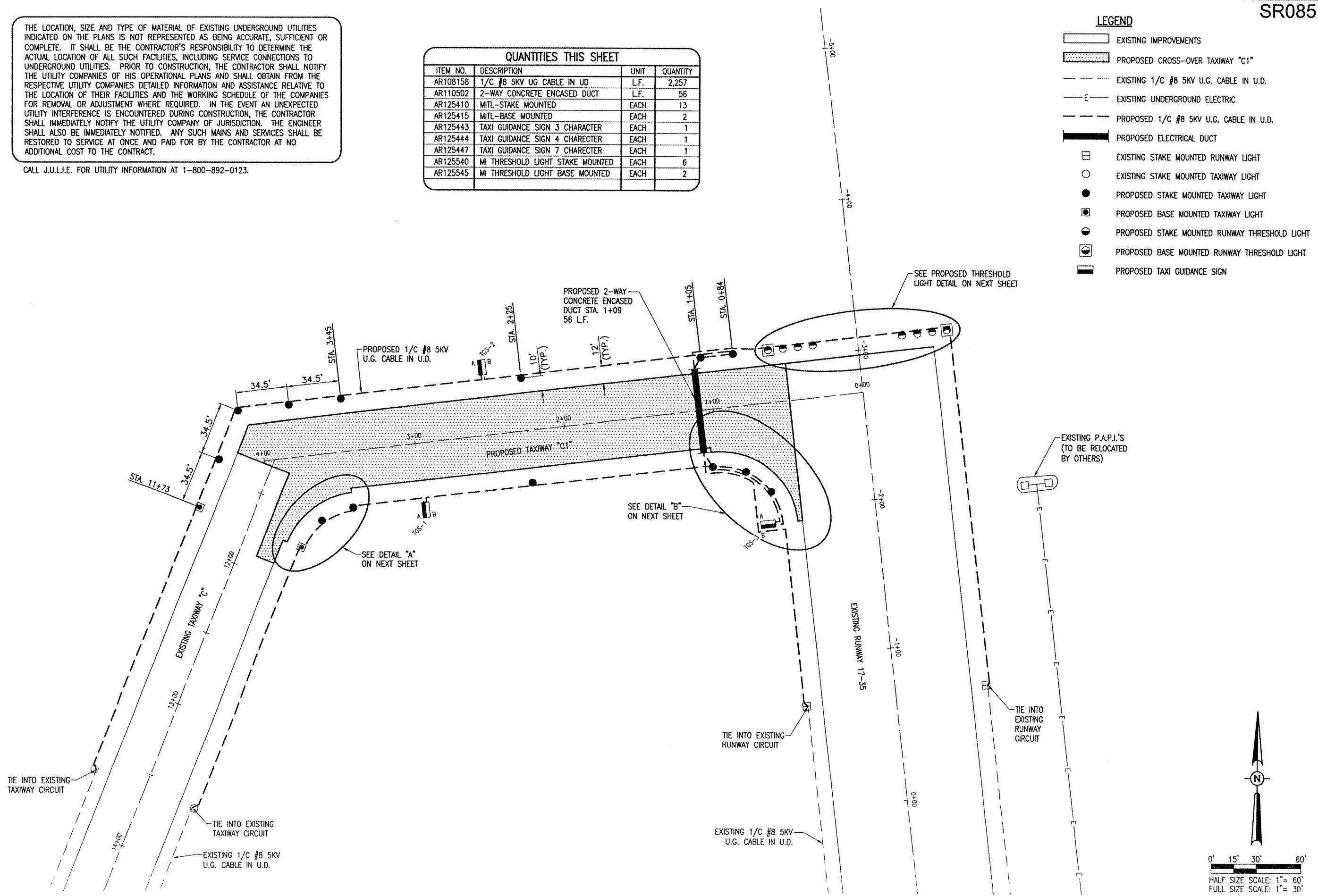

<p>ST. LOUIS REGIONAL AIRPORT</p> <p>St. Louis Regional Airport</p> <p>EAST ALTON, ILLINOIS</p> <p>IL. PROJ.: ALN-3825 A.I.P. PROJ.: 3-17-0002-B42</p>	<table border="1" style="width: 100%; border-collapse: collapse;"> <tr> <th>DATE</th> <th>REVISION</th> <th>BY</th> </tr> <tr> <td> </td> <td> </td> <td> </td> </tr> </table>	DATE	REVISION	BY				<table border="1" style="width: 100%; border-collapse: collapse;"> <tr> <td> <p>HL Project No. 83706RWD_0800</p> <p>File Name: R-142ELE.DWG</p> <p>Scale: 1" = 30'</p> <p>Date: 02/11/08</p> </td> <td> <table border="1" style="width: 100%; border-collapse: collapse;"> <tr> <td>LAYOUT</td> <td>CAH</td> <td>02/11/08</td> </tr> <tr> <td>DRAWN</td> <td>BAK</td> <td>02/11/08</td> </tr> <tr> <td>REVIEWED</td> <td>CAH</td> <td>07/11/08</td> </tr> </table> </td> </tr> <tr> <td colspan="2" style="text-align: center;"> <p>HANSON</p> <p>Hanson Professional Services Inc.</p> <p>1525 South State Street</p> <p>Springfield, Illinois 62703-2886</p> <p>Offices Nationwide</p> </td> </tr> <tr> <td colspan="2" style="text-align: center;"> <p>RUNWAY SAFETY AREA IMPROVEMENTS</p> <p>PROPOSED ELECTRICAL PLAN FOR RUNWAY END 17</p> </td> </tr> <tr> <td colspan="2" style="text-align: center;"> <p>16</p> <p>16 of 81 sheets</p> </td> </tr> </table>	<p>HL Project No. 83706RWD_0800</p> <p>File Name: R-142ELE.DWG</p> <p>Scale: 1" = 30'</p> <p>Date: 02/11/08</p>	<table border="1" style="width: 100%; border-collapse: collapse;"> <tr> <td>LAYOUT</td> <td>CAH</td> <td>02/11/08</td> </tr> <tr> <td>DRAWN</td> <td>BAK</td> <td>02/11/08</td> </tr> <tr> <td>REVIEWED</td> <td>CAH</td> <td>07/11/08</td> </tr> </table>	LAYOUT	CAH	02/11/08	DRAWN	BAK	02/11/08	REVIEWED	CAH	07/11/08	<p>HANSON</p> <p>Hanson Professional Services Inc.</p> <p>1525 South State Street</p> <p>Springfield, Illinois 62703-2886</p> <p>Offices Nationwide</p>		<p>RUNWAY SAFETY AREA IMPROVEMENTS</p> <p>PROPOSED ELECTRICAL PLAN FOR RUNWAY END 17</p>		<p>16</p> <p>16 of 81 sheets</p>	
DATE	REVISION	BY																							
<p>HL Project No. 83706RWD_0800</p> <p>File Name: R-142ELE.DWG</p> <p>Scale: 1" = 30'</p> <p>Date: 02/11/08</p>	<table border="1" style="width: 100%; border-collapse: collapse;"> <tr> <td>LAYOUT</td> <td>CAH</td> <td>02/11/08</td> </tr> <tr> <td>DRAWN</td> <td>BAK</td> <td>02/11/08</td> </tr> <tr> <td>REVIEWED</td> <td>CAH</td> <td>07/11/08</td> </tr> </table>	LAYOUT	CAH	02/11/08	DRAWN	BAK	02/11/08	REVIEWED	CAH	07/11/08															
LAYOUT	CAH	02/11/08																							
DRAWN	BAK	02/11/08																							
REVIEWED	CAH	07/11/08																							
<p>HANSON</p> <p>Hanson Professional Services Inc.</p> <p>1525 South State Street</p> <p>Springfield, Illinois 62703-2886</p> <p>Offices Nationwide</p>																									
<p>RUNWAY SAFETY AREA IMPROVEMENTS</p> <p>PROPOSED ELECTRICAL PLAN FOR RUNWAY END 17</p>																									
<p>16</p> <p>16 of 81 sheets</p>																									

FEB 10 2009 4:50 PM HACL000382
 I:\ARPORTS\STLOUIS\837-06RWD\AIRPORT\SHEETS\R-142ELE.DWG - Rwy 17 END

