

SR085

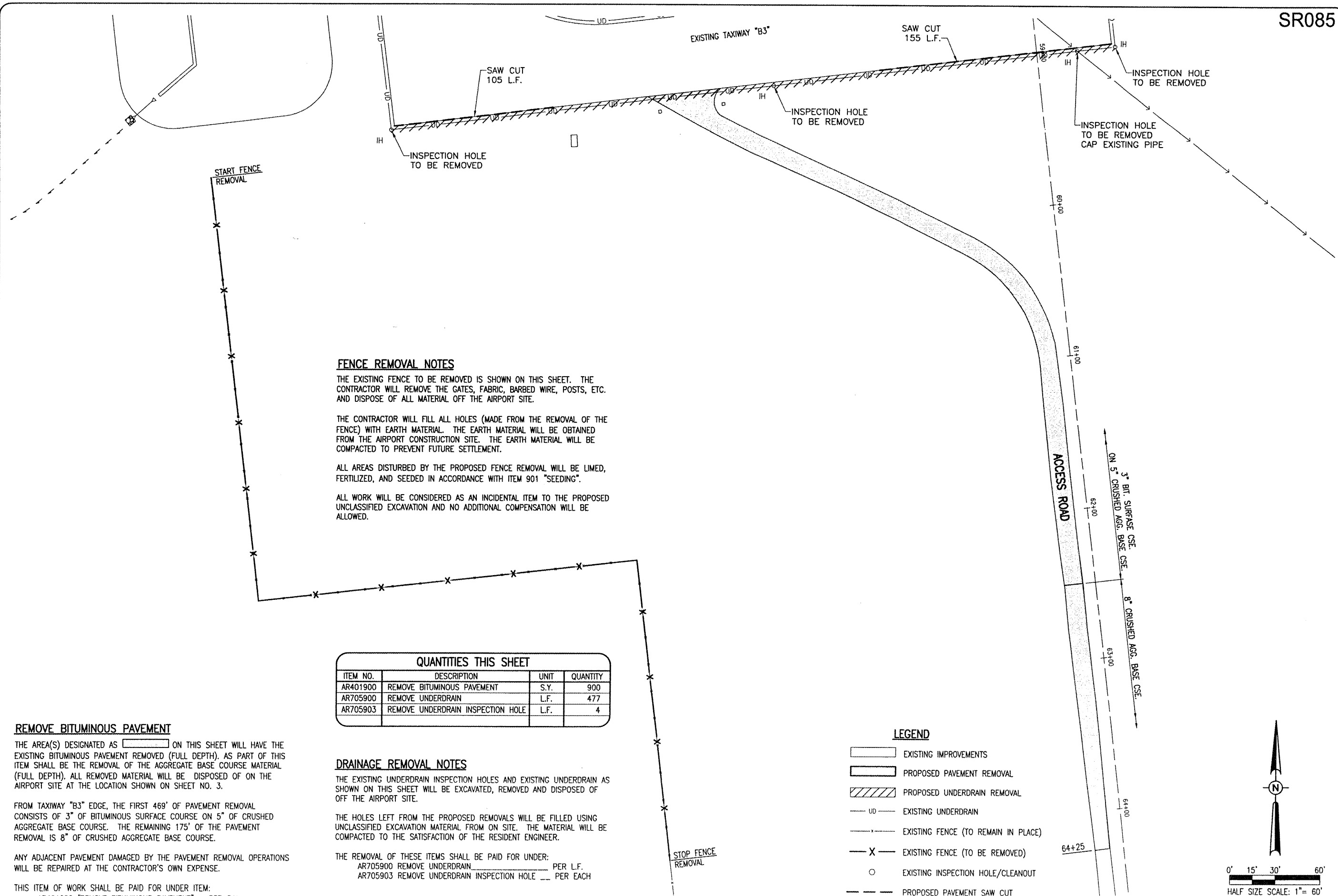

**FENCE REMOVAL NOTES**

THE EXISTING FENCE TO BE REMOVED IS SHOWN ON THIS SHEET. THE CONTRACTOR WILL REMOVE THE GATES, FABRIC, BARBED WIRE, POSTS, ETC. AND DISPOSE OF ALL MATERIAL OFF THE AIRPORT SITE.

THE CONTRACTOR WILL FILL ALL HOLES (MADE FROM THE REMOVAL OF THE FENCE) WITH EARTH MATERIAL. THE EARTH MATERIAL WILL BE OBTAINED FROM THE AIRPORT CONSTRUCTION SITE. THE EARTH MATERIAL WILL BE COMPACTED TO PREVENT FUTURE SETTLEMENT.

ALL AREAS DISTURBED BY THE PROPOSED FENCE REMOVAL WILL BE LIMED, FERTILIZED, AND SEEDED IN ACCORDANCE WITH ITEM 901 "SEEDING".

ALL WORK WILL BE CONSIDERED AS AN INCIDENTAL ITEM TO THE PROPOSED UNCLASSIFIED EXCAVATION AND NO ADDITIONAL COMPENSATION WILL BE ALLOWED.

QUANTITIES THIS SHEET			
ITEM NO.	DESCRIPTION	UNIT	QUANTITY
AR401900	REMOVE BITUMINOUS PAVEMENT	S.Y.	900
AR705900	REMOVE UNDERDRAIN	L.F.	477
AR705903	REMOVE UNDERDRAIN INSPECTION HOLE	L.F.	4

**DRAINAGE REMOVAL NOTES**

THE EXISTING UNDERDRAIN INSPECTION HOLES AND EXISTING UNDERDRAIN AS SHOWN ON THIS SHEET WILL BE EXCAVATED, REMOVED AND DISPOSED OF OFF THE AIRPORT SITE.

THE HOLES LEFT FROM THE PROPOSED REMOVALS WILL BE FILLED USING UNCLASSIFIED EXCAVATION MATERIAL FROM ON SITE. THE MATERIAL WILL BE COMPACTED TO THE SATISFACTION OF THE RESIDENT ENGINEER.

THE REMOVAL OF THESE ITEMS SHALL BE PAID FOR UNDER:  
 AR705900 REMOVE UNDERDRAIN \_\_\_\_\_ PER L.F.  
 AR705903 REMOVE UNDERDRAIN INSPECTION HOLE \_\_\_\_\_ PER EACH

**REMOVE BITUMINOUS PAVEMENT**

THE AREA(S) DESIGNATED AS [ ] ON THIS SHEET WILL HAVE THE EXISTING BITUMINOUS PAVEMENT REMOVED (FULL DEPTH). AS PART OF THIS ITEM SHALL BE THE REMOVAL OF THE AGGREGATE BASE COURSE MATERIAL (FULL DEPTH). ALL REMOVED MATERIAL WILL BE DISPOSED OF ON THE AIRPORT SITE AT THE LOCATION SHOWN ON SHEET NO. 3.

FROM TAXIWAY "B3" EDGE, THE FIRST 469' OF PAVEMENT REMOVAL CONSISTS OF 3" OF BITUMINOUS SURFACE COURSE ON 5" OF CRUSHED AGGREGATE BASE COURSE. THE REMAINING 175' OF THE PAVEMENT REMOVAL IS 8" OF CRUSHED AGGREGATE BASE COURSE.

ANY ADJACENT PAVEMENT DAMAGED BY THE PAVEMENT REMOVAL OPERATIONS WILL BE REPAIRED AT THE CONTRACTOR'S OWN EXPENSE.

THIS ITEM OF WORK SHALL BE PAID FOR UNDER ITEM:  
 AR401900 "REMOVE BITUMINOUS PAVEMENT" - PER S.Y.

**LEGEND**

- [ ] EXISTING IMPROVEMENTS
- [ ] PROPOSED PAVEMENT REMOVAL
- [ ] PROPOSED UNDERDRAIN REMOVAL
- UD EXISTING UNDERDRAIN
- EXISTING FENCE (TO REMAIN IN PLACE)
- X- EXISTING FENCE (TO BE REMOVED)
- EXISTING INSPECTION HOLE/CLEANOUT
- - - PROPOSED PAVEMENT SAW CUT

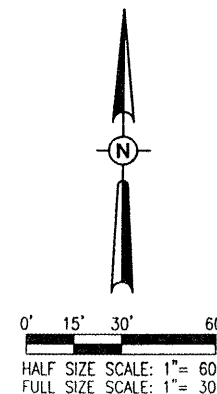

REVISION	DATE	BY

ST. LOUIS REGIONAL AIRPORT  
**St. Louis Regional**  
 EAST ALTON, ILLINOIS  
 A.I.P. PROJ.: ALN-3825 IL PROJ.: ALN-0002-B42

HE Project No. 83706RWYD_0800	MDR	02/08/08
Revision R-1.11 PREL.DWG	MDR	02/08/08
Scale 1"=30'	CAH	07/11/08
Date 02/08/08		

**HANSON**  
 Hanson Professional Services Inc.  
 1525 South Sixth Street  
 Springfield, Illinois 62703-2886  
 Offices Nationwide

RUNWAY SAFETY AREA IMPROVEMENTS  
 PROPOSED PAVEMENT PREPARATION PLAN FOR RUNWAY END 35

FEB 10, 2009 4:46 PM HAGL000382 \\A:\AIRPORTS\STLOUIS\B37-06RWYD\AIRPORT\SHETS\R-111PRP.DWG - RWY 35 END