

F.A.U. RTE.	SECTION	COUNTY	TOTAL SHEETS	SHEET NO.
530	14-00010-00-RS	DuPAGE	21	1
FED. ROAD DIST. NO.		ILLINOIS	CONTRACT NO. 61B20	

FOR INDEX OF SHEETS, SEE SHEET NO. 2

STATE OF ILLINOIS
DEPARTMENT OF TRANSPORTATION
DIVISION OF HIGHWAYS

PLANS FOR PROPOSED
FEDERAL AID HIGHWAY

FAU 2530 (POWIS ROAD)
NORTH VILLAGE BOUNDARY TO FAU 3804 (SMITH ROAD)
RESURFACING
SECTION NO. 14-00010-00-RS
PROJECT NO. M-4003(468)
VILLAGE OF WAYNE
DuPAGE COUNTY
JOB NO. C-91-190-15

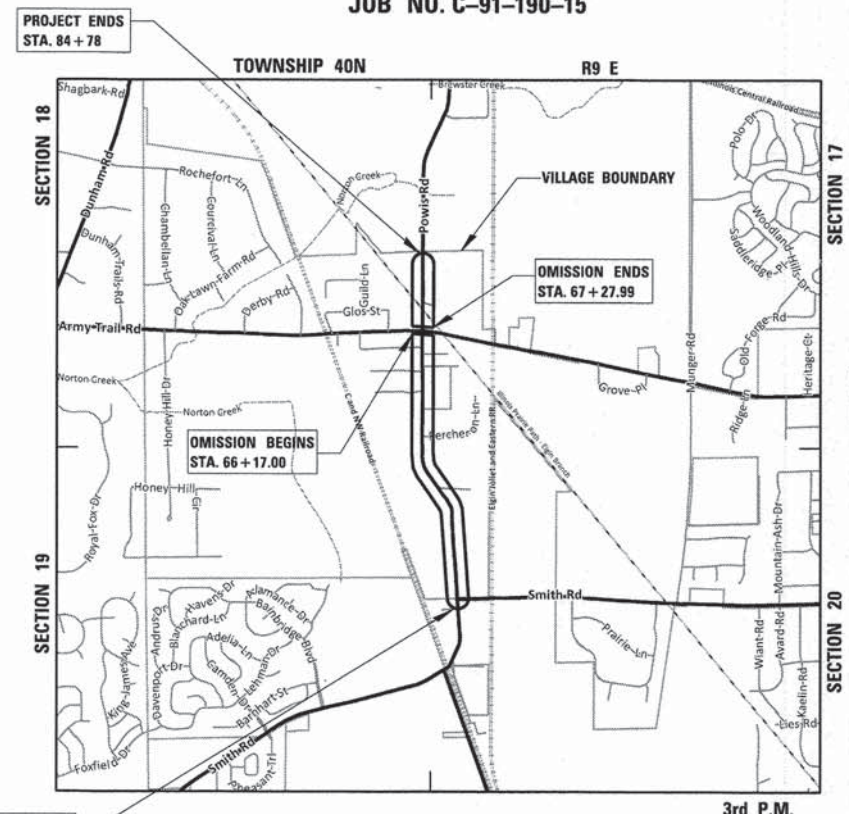

THE PROJECT IS LOCATED IN THE VILLAGE OF WAYNE



TRAFFIC DATA

POWIS ROAD
ADT (YEAR) = 7,650 (2013)
POSTED SPEED LIMIT = 30 MPH (SOUTH OF ARMY TRAIL ROAD)
35 MPH (NORTH OF ARMY TRAIL ROAD)

DESIGN DESIGNATION: MAJOR COLLECTOR/MINOR ARTERIAL

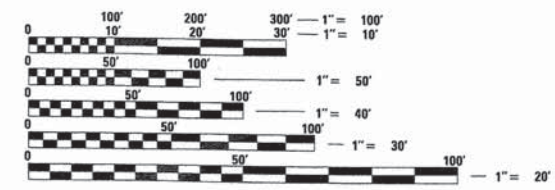

FULL SIZE PLANS HAVE BEEN PREPARED USING STANDARD ENGINEERING SCALES. REDUCED SIZED PLANS WILL NOT CONFORM TO STANDARD SCALES. IN MAKING MEASUREMENTS ON REDUCED PLANS, THE ABOVE SCALES MAY BE USED.

J.U.L.I.E.
JOINT UTILITY LOCATION INFORMATION FOR EXCAVATION
8-1-1 OR 1-800-892-0123

POWIS ROAD
GROSS LENGTH OF PROJECT = 7,383 LINEAL FEET (1.39 MILES)
NET LENGTH OF PROJECT = 7,272 LINEAL FEET (1.38 MILES)

FEDERAL AID PROGRAM ENGINEER: FAWAD AQUEEL, P.E. (847) 705-4021
SCHAUMBURG, ILLINOIS

CB CHRISTOPHER B. BURKE ENGINEERING LTD.
9575 West Higgins Road, Suite 600
Rosemont, Illinois 60018 (847) 823-0500

PROFESSIONAL DESIGN FIRM NO. 184-001175
EXPIRATION DATE: 04/30/15

CONTRACT NO. 61B20

STATE OF ILLINOIS
DEPARTMENT OF TRANSPORTATION
DIVISION OF HIGHWAYS

APPROVED 1/29 2015
Quinn Pugh
VILLAGE PRESIDENT, VILLAGE OF WAYNE

PASSED FEBRUARY 6 2015
C. Holt
DISTRICT 1 ENGINEER OF LOCAL ROADS AND STREETS

RELEASING FOR BID BASED ON LIMITED REVIEW February 6 2015
John Fortman
DEPUTY DIRECTOR OF HIGHWAYS, REGION ONE ENGINEER

LEE M. FELL
062-053708
REGISTERED PROFESSIONAL ENGINEER OF ILLINOIS

Lee M. Fell
ENGINEER

1/29/15
DATE

LEE M. FELL
ILLINOIS REGISTRATION No. 062-053708
EXPIRATION DATE: 11/30/2015

PRINTED BY THE AUTHORITY OF THE STATE OF ILLINOIS

GENERAL NOTES

SPECIFICATIONS, STANDARDS AND SPECIAL PROVISIONS

ALL CONSTRUCTION SHALL BE DONE IN ACCORDANCE WITH THE "STANDARD SPECIFICATIONS FOR ROAD AND BRIDGE CONSTRUCTION", ADOPTED JANUARY 1, 2012; THE "SUPPLEMENTAL SPECIFICATIONS AND RECURRING SPECIAL PROVISIONS", THE LATEST REVISION; THE LATEST EDITION OF THE "ILLINOIS MANUAL ON UNIFORM TRAFFIC CONTROL DEVICES FOR STREETS AND HIGHWAYS", (IMUTCD; THE "STANDARD SPECIFICATIONS FOR TRAFFIC CONTROL ITEMS", SSTCI), "THE STANDARD SPECIFICATIONS FOR WATER AND SEWER MAIN CONSTRUCTION IN ILLINOIS" MAY 1996 FIFTH EDITION, THE "DETAILS" IN THE PLANS AND THE "SPECIAL PROVISIONS" INCLUDED IN THE CONTRACT DOCUMENTS.

ANY REFERENCE TO STANDARDS THROUGHOUT THE PLANS OR SPECIAL PROVISIONS SHALL BE INTERPRETED AS THE LATEST IDOT HIGHWAY STANDARD.

CODES OF THE IEPA TITLE 35, AND O.S.H.A. SHALL BE ADHERED TO FOR THE CONSTRUCTION OF THIS PROJECT.

ALL TRAFFIC CONTROL AND OTHER ADVISORY SIGNS NEEDED FOR CONSTRUCTION ARE TO BE FURNISHED BY THE CONTRACTOR IN ACCORDANCE WITH SECTION 700 OF THE STANDARD SPECIFICATIONS.

ALL REQUIRED PERMITS FROM THE PROPER GOVERNING AGENCY SHALL BE OBTAINED FOR CONSTRUCTION ALONG OR ACROSS EXISTING STREETS OR HIGHWAYS. THE CONTRACTOR SHALL MAKE ARRANGEMENTS FOR THE PROPER BRACING, SHEETING, SHORING AND OTHER REQUIRED PROTECTION OF ALL ROADWAYS BEFORE CONSTRUCTION BEGINS. THE CONTRACTOR SHALL BE RESPONSIBLE FOR ANY DAMAGE TO THE STREETS OR ROADWAYS AND ASSOCIATED STRUCTURES AND SHALL MAKE REPAIRS AS NECESSARY TO THE SATISFACTION OF THE ENGINEER, AT THE CONTRACTOR'S OWN EXPENSE. THE CONTRACTOR SHALL BE RESPONSIBLE FOR THE INSTALLATION AND MAINTENANCE OF ADEQUATE SIGNS AND WARNING DEVICES TO INFORM AND PROTECT THE PUBLIC.

UTILITIES

THE CONTRACTOR SHALL BE RESPONSIBLE FOR CONTACTING THE OWNERS OF ALL EXISTING UTILITY FACILITIES SO THAT THE UTILITIES AND THEIR APPURTENANCES MAY BE LOCATED AND ADJUSTED OR MOVED, IF NECESSARY, PRIOR TO THE START OF CONSTRUCTION OPERATIONS. THE CONTRACTOR SHALL COOPERATE WITH ALL UTILITY OWNERS AS PROVIDED FOR IN THE STANDARD SPECIFICATIONS.

THE LOCATIONS OF EXISTING DRAINAGE STRUCTURES, STORM AND SANITARY SEWERS, WATER SERVICE LINES AND OTHER UTILITY LINES ARE APPROXIMATE, AND THE DEPARTMENT AND VILLAGE DO NOT GUARANTEE THEIR ACCURACY. THEIR EXACT HORIZONTAL AND VERTICAL LOCATIONS ARE TO BE DETERMINED IN THE FIELD BY THE CONTRACTOR AT HIS OWN EXPENSE.

THE CONTRACTOR SHALL BE RESPONSIBLE FOR THE PROTECTION OF ALL UNDERGROUND OR SURFACE UTILITIES EVEN THOUGH THEY MAY NOT BE SHOWN ON THE PLANS. ANY UTILITY THAT IS DAMAGED DURING CONSTRUCTION SHALL BE REPAIRED OR REPLACED TO THE SATISFACTION OF THE ENGINEER OR THE VILLAGE. THIS WORK SHALL BE AT THE CONTRACTOR'S EXPENSE.

BEFORE STARTING ANY EXCAVATION, THE CONTRACTOR SHALL CALL "JULIE" AT 8-1-1 FOR FIELD LOCATIONS OF BURIED ELECTRIC, TELEPHONE, GAS AND CABLE.

THE CONTRACTOR SHALL CONTACT IDOT'S BUREAU OF MATERIALS (PHONE 847-705-4337) AT LEAST 24 HOURS BEFORE PLACING HOT-MIX ASPHALT OR PORTLAND CEMENT CONCRETE.

STAKING

THE CONTRACTOR SHALL PROTECT AND CAREFULLY PRESERVE ALL SECTION OR SUBSECTION MONUMENTS OR PROPERTY OR REFERENCE MARKERS UNTIL THE ENGINEER, VILLAGE, AND ITS AGENT OR AN AUTHORIZED SURVEYOR HAS WITNESSED OR OTHERWISE REFERENCE THEIR LOCATIONS.

WATER, STORM SEWER AND SANITARY SEWER

WHENEVER DURING CONSTRUCTION OPERATIONS ANY LOOSE MATERIAL IS DEPOSITED IN THE FLOW LINE OF DRAINAGE STRUCTURES SUCH THAT THE NATURAL FLOW OF WATER IS OBSTRUCTED, IT SHALL BE REMOVED AT THE CLOSE OF EACH WORKING DAY. AT THE CONCLUSION OF CONSTRUCTION OPERATIONS, ALL UTILITY STRUCTURES SHALL BE FREE FROM DIRT AND DEBRIS. THE WORK SPECIFIED ABOVE WILL NOT BE PAID FOR SEPARATELY BUT SHALL BE INCLUDED IN THE COST OF INLET FILTERS.

ALL EXISTING OR PROPOSED STORM SEWER DAMAGED BY THE CONTRACTOR DURING CONSTRUCTION SHALL BE REPLACED BY THE CONTRACTOR AND INCLUDED IN THE COST OF HOT-MIX ASPHALT SURFACE REMOVAL, 3".

MISCELLANEOUS

ACCESS: THE CONTRACTOR SHALL PROVIDE ACCESS TO ABUTTING PROPERTY AT ALL TIMES DURING THE CONSTRUCTION OF THIS PROJECT, EXCEPT FOR PERIODS OF SHORT DURATION. THE COST TO PROVIDE ACCESS SHALL BE PAID FOR AND INCLUDED IN THE ITEM TEMPORARY ACCESS (ROAD) OR TEMPORARY ACCESS (PRIVATE ENTRANCE).

DIMENSIONS: IT SHALL BE THE CONTRACTOR'S RESPONSIBILITY TO VERIFY ALL DIMENSIONS AND CONDITIONS EXISTING IN THE FIELD PRIOR TO ORDERING MATERIALS AND BEGINNING CONSTRUCTION.

ALL SAWCUTTING SHALL BE INCLUDED IN THE COST OF THE REMOVAL ITEMS AND SHALL BE PERFORMED PRIOR TO BEGINNING REMOVAL. ANY ITEMS OF WORK REMOVED PRIOR TO SAWCUTTING WILL NOT BE MEASURED FOR PAYMENT.

CLASS D PATCHES, 6" WILL BE DETERMINED BY THE ENGINEER IN THE FIELD AND WILL NOT EXCEED THE PLANNED QUANTITY.

THE THICKNESSES OF HOT-MIX ASPHALT MIXTURES SHOWN IN THE PLANS ARE NOMINAL. DEVIATIONS MAY OCCUR DUE TO IRREGULARITIES IN THE SURFACES OR BASIS ON WHICH THEY ARE TO BE PLACED. PLAN THICKNESSES SHOULD BE CONSIDERED THE MINIMUM THICKNESS PERMITTED.

FRESH OIL SIGNS SHALL BE POSTED AT BOTH ENDS OF THE ROADWAY AND ALL SIDE STREETS AS DIRECTED BY THE ENGINEER. CONSTRUCTION AHEAD SIGNS SHALL BE PLACED AT ALL SIDE STREETS AND BOTH ENDS OF THE ROADWAY WHILE CONSTRUCTION IS IN PROGRESS. THIS WILL NOT BE PAID FOR SEPARATELY BUT SHALL BE INCLUDED IN THE COST OF THE APPLICABLE TRAFFIC CONTROL PAY ITEMS OR STANDARD 701501.

CONTRACTOR SHALL NOT PLACE SOD UNTIL THE TEMPERATURE IS 80 OR LESS AND THE FORECAST FOR THE NEXT 7 DAYS SHOWS TEMPERATURES OF 80 OR LESS. IF ALL OTHER PAY ITEMS ARE COMPLETED, THE CONTRACTOR WILL NOT BE CHARGED WORKING DAYS FOR DELAYS IN PARKWAY RESTORATION DUE TO TEMPERATURE.

NO CONSTRUCTION SHALL BEGIN UNTIL ALL PROPER TEMPORARY SIGNS AND BARRICADES HAVE BEEN INSTALLED.

AT NO TIME SHALL LESS THAN HALF OF THE STREET BE AVAILABLE FOR PARKING.

ALL ROADS MUST HAVE ONLY ONE LONGITUDINAL JOINT WHILE PAVING.

VANDALISM - SPECIAL ATTENTION IS CALLED TO THE SPECIAL PROVISION FOR "INSPECTION" AS WELL AS ARTICLE 107.30 OF THE "STANDARD SPECIFICATIONS." ANY DEFACED WORK AS DETERMINED AND DIRECTED BY THE VILLAGE SHALL BE CORRECTED OR REPLACED TO THE SATISFACTION OF THE ENGINEER BY THE CONTRACTOR AT HIS SOLE EXPENSE PRIOR TO FINAL PAYMENT. THE VILLAGE OF WAYNE WILL COOPERATE WITH THE CONTRACTOR TO MINIMIZE VANDALISM, BUT THE CONTRACTOR SHALL BE ULTIMATELY RESPONSIBLE TO CORRECT ANY DAMAGE. THE VILLAGE WILL NOT BE RESPONSIBLE FOR THE SECURITY OF THE WORK SITE IN THIS REGARD, OTHER THAN NORMAL PATROLLING AND RESPONSE TO EMERGENCIES. THE COST OF ADDITIONAL SECURITY REQUIRED TO MEET THIS SPECIAL PROVISION SHALL BE SOLELY THE CONTRACTOR'S RESPONSIBILITY.

DESCRIPTION

COVER SHEET

SHEET NO.

1

GENERAL NOTES AND HIGHWAY STANDARDS

2

SUMMARY OF QUANTITIES

3

TYPICAL SECTIONS

4

EXISTING CONDITIONS AND REMOVAL PLAN

5-11

PROPOSED PLAN

12-18

BUTT JOINT AND HMA TAPER DETAILS

19

DISTRICT ONE TYPICAL PAVEMENT MARKINGS

20

TRAFFIC CONTROL AND PROTECTION FOR SIDE ROADS, INTERSECTIONS, AND DRIVEWAYS

21

ARTERIAL ROAD INFORMATION SIGN

21A

HIGHWAY STANDARDS

000001-06	STANDARD SYMBOLS, ABBREVIATIONS, AND PATTERNS
442201-03	CLASS C AND D PATCHES
701006-05	OFF ROAD OPERATIONS, 2L, 2W, 15' TO 24" FROM PAVEMENT EDGE
701311-03	LANE CLOSURE, 2L, 2W, MOVING OPERATIONS - DAY ONLY
701501-06	URBAN LANE CLOSURE, 2L, 2W, UNDIVIDED
701901-04	TRAFFIC CONTROL DEVICES

DISTRICT ONE DETAILS

TC-10	TRAFFIC CONTROL & PROTECTION FOR SIDE ROADS, INTERSECTIONS, AND DRIVEWAYS
TC-13	DISTRICT ONE TYPICAL PAVEMENT MARKINGS
TC-22	ARTERIAL ROAD INFORMATION SIGN
BD-32	BUTT JOINT AND HMA TAPER DETAILS

SUMMARY OF QUANTITIES

SPECIAL PROVISION	SPECIALTY ITEM	CODE NO.	ITEM	UNIT	CONSTRUCTION CODE	
					TOTAL QUANTITY 0005	
~		40600275	BITUMINOUS MATERIALS (PRIME COAT)	POUND	16,000	
		40600400	MIXTURE FOR CRACKS, JOINTS, AND FLANGEWAYS	TON	100	
		40600825	POLYMERIZED LEVELING BINDER (MACHINE METHOD), N50	TON	1,150	
		40600982	HOT-MIX ASPHALT SURFACE REMOVAL - BUTT JOINT	SQ YD	130	
		40603335	HOT-MIX ASPHALT SURFACE COURSE, MIX "D", N50	TON	2,320	
		44000161	HOT-MIX ASPHALT SURFACE REMOVAL, 3"	SQ YD	19,950	
		44201713	CLASS D PATCHES, TYPE I, 6 INCH	SQ YD	250	
		44201717	CLASS D PATCHES, TYPE II, 6 INCH	SQ YD	250	
		44201721	CLASS D PATCHES, TYPE III, 6 INCH	SQ YD	250	
		44201723	CLASS D PATCHES, TYPE IV, 6 INCH	SQ YD	250	
		48101498	AGGREGATE SHOULDERS, TYPE B 4"	SQ YD	1,600	
		50105220	PIPE CULVERT REMOVAL	FOOT	28	
		542A0217	PIPE CULVERTS, CLASS A, TYPE 1 12"	FOOT	28	
		54213657	PRECAST REINFORCED CONCRETE FLARED END SECTIONS 12"	EACH	2	
		67100100	MOBILIZATION	L SUM	1	
		70102620	TRAFFIC CONTROL AND PROTECTION, STANDARD 701501	L SUM	1	
		70102640	TRAFFIC CONTROL AND PROTECTION, STANDARD 701801	L SUM	1	
		70300100	SHORT TERM PAVEMENT MARKING	FOOT	1,000	
		70301000	WORK ZONE PAVEMENT MARKING REMOVAL	SQ FT	1,000	
	*	78000100	THERMOPLASTIC PAVEMENT MARKING - LETTERS AND SYMBOLS	SQ FT	55	
	*	78000200	THERMOPLASTIC PAVEMENT MARKING - LINE 4"	FOOT	27,850	
	*	78000400	THERMOPLASTIC PAVEMENT MARKING - LINE 6"	FOOT	90	
	*	78000600	THERMOPLASTIC PAVEMENT MARKING - LINE 12"	FOOT	175	
	*	78000650	THERMOPLASTIC PAVEMENT MARKING - LINE 24"	FOOT	55	
~		X2080250	TRENCH BACKFILL, SPECIAL	CU YD	10	
~		X4021000	TEMPORARY ACCESS (PRIVATE ENTRANCE)	EACH	30	
~		X4023000	TEMPORARY ACCESS (ROAD)	EACH	11	
~		Z0013798	CONSTRUCTION LAYOUT	L SUM	1	
~		Z0030850	TEMPORARY INFORMATION SIGNING	SQ FT	100	

*INDICATES SPECIALTY ITEM

~INDICATES SPECIAL PROVISION

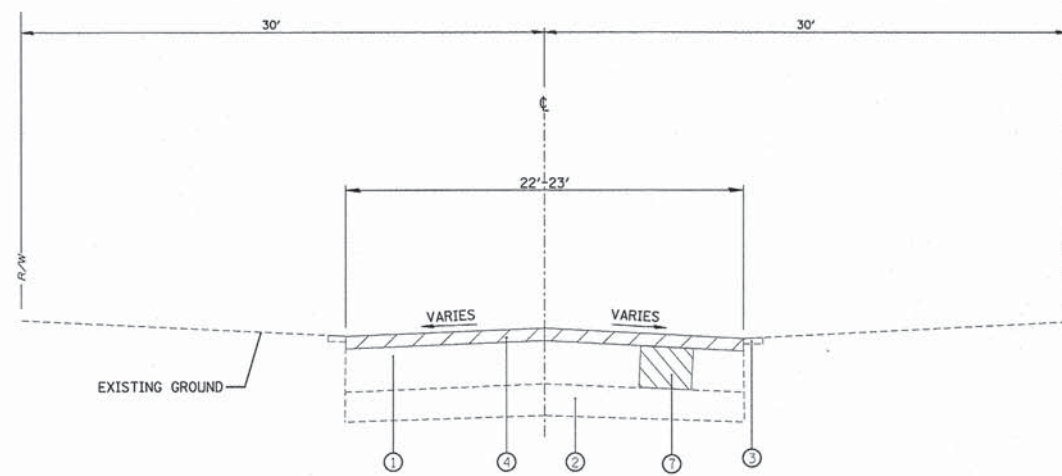

EXISTING TYPICAL SECTION
STA. 10+95 TO STA 84+78, POWIS ROAD

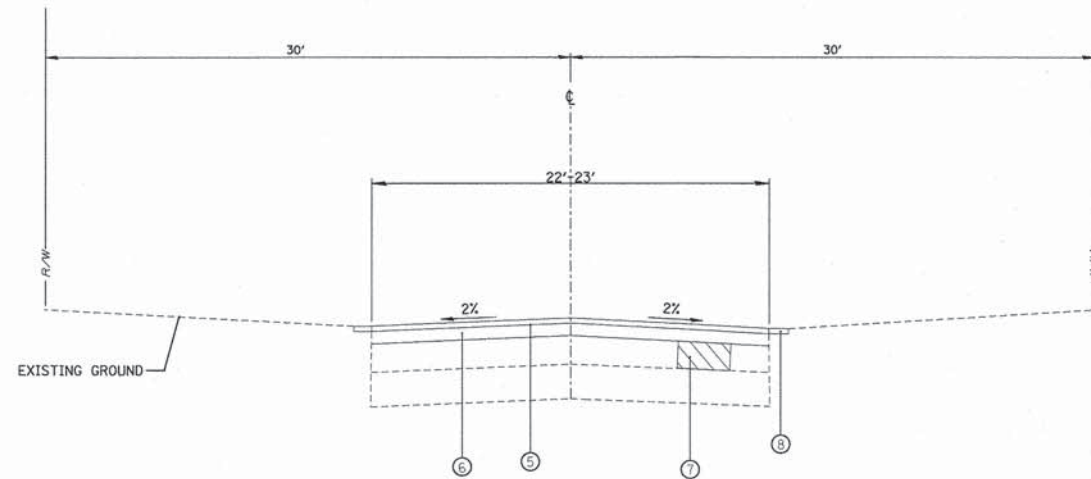

PROPOSED TYPICAL SECTION
STA. 10+95 TO STA 84+78, POWIS ROAD

NOTE:

PAVING OF THE FULL ROADWAY WIDTH SHALL BE COMPLETED AT THE END OF EACH DAY OF PAVING TO PREVENT A LONGITUDINAL COLD JOINT FROM APPEARING WHEN OPPOSITE SIDES OF THE ROAD ARE PAVED ON DIFFERENT DAYS. THE CONTRACTOR SHALL ALSO ENSURE THAT AT THE END OF EACH DAY EACH PASS ENDS AT APPROXIMATELY THE SAME STATION TO PREVENT A COLD JOINT.

HOT-MIX ASPHALT MIXTURE REQUIREMENTS	
ITEM	VOIDS
HOT-MIX ASPHALT SURFACE COURSE, MIX "D", NSO (IL 9.5 mm), 2"	4% @ 50 GYR.
POLYMERIZED LEVELING BINDER COURSE, (MACHINE METHOD), NSO, 1" (SHALL BE PLACED IN 1 LIFT)	3.5% @ 50 GYR.
CLASS D PATCHES, 6" (HMA BINDER IL-19MM)	4% @ 70 GYR.

NOTE:

1. THE UNIT WEIGHT USED TO CALCULATE ALL HOT-MIX ASPHALT SURFACE MIXTURE IS 112 LBS/SY/IN.
2. THE "AC TYPE" FOR POLYMERIZED HMA MIXES SHALL BE "SBS/SBR PG 76-22" AND FOR NON-POLYMERIZED HMA THE "AC TYPE" SHALL BE "PG 64-22" UNLESS MODIFIED BY DISTRICT ONE SPECIAL PROVISIONS.
3. FOR "PERCENT OF RAP" SEE DISTRICT ONE SPECIAL PROVISIONS.
4. THE HIGH SIDE OF THE ROADWAY SHALL BE PAVED FIRST.

LEGEND

- ① EXISTING HOT-MIX ASPHALT PAVEMENT
- ② EXISTING AGGREGATE BASE
- ③ EXISTING GRAVEL SHOULDER
- ④ HOT-MIX ASPHALT SURFACE REMOVAL, VARIABLE DEPTH
- ⑤ PROPOSED BITUMINOUS MATERIAL (PRIME COAT)
- ⑥ HOT-MIX ASPHALT PAVEMENT (FULL DEPTH) - 3"
 - *HOT-MIX ASPHALT SURFACE COURSE, MIX "D" NSO - 2"
 - *POLYMERIZED LEVELING BINDER COURSE, (MACHINE METHOD), NSO - 1"
- ⑦ CLASS D PATCHES, 6" (AS DIRECTED BY THE ENGINEER)
- ⑧ AGGREGATE SHOULDERS, TYPE B 4"

CORE DETAILS

CORE NUMBER	ASPHALT THICKNESS	BASE THICKNESS
1	9 3/4"	0"
2	7"	4"
3	9 1/2"	0"
4	7 3/4"	0"
5	8"	0"
6	9 1/2"	3"
7	6 1/2"	0"
8	7 3/4"	4"
9	8"	0"
10	6 3/4"	3"

FILE NAME =	USER NAME = jlapaglia	DESIGNED - LMF	REVISED -
N:\MAYNE\910843\H0198\Civil\typ_910843\H0198-01.sht		DRAWN - EDT	REVISED -
	PLOT SCALE = NOT TO SCALE	CHECKED - JGS	REVISED -
	PLOT DATE = 1/30/2015	DATE - 12/05/14	REVISED -

**STATE OF ILLINOIS
DEPARTMENT OF TRANSPORTATION**

**POWIS ROAD
TYPICAL SECTIONS**

SCALE: 50' SHEET NO. 4 OF 21 SHEETS STA. TO STA.

F.A.U. RTE.	SECTION	COUNTY	TOTAL SHEETS	SHEET NO.
530	14-00010-00-RS	DuPAGE	21	4
CONTRACT NO. 61B20			ILLINOIS FED. AID PROJECT	

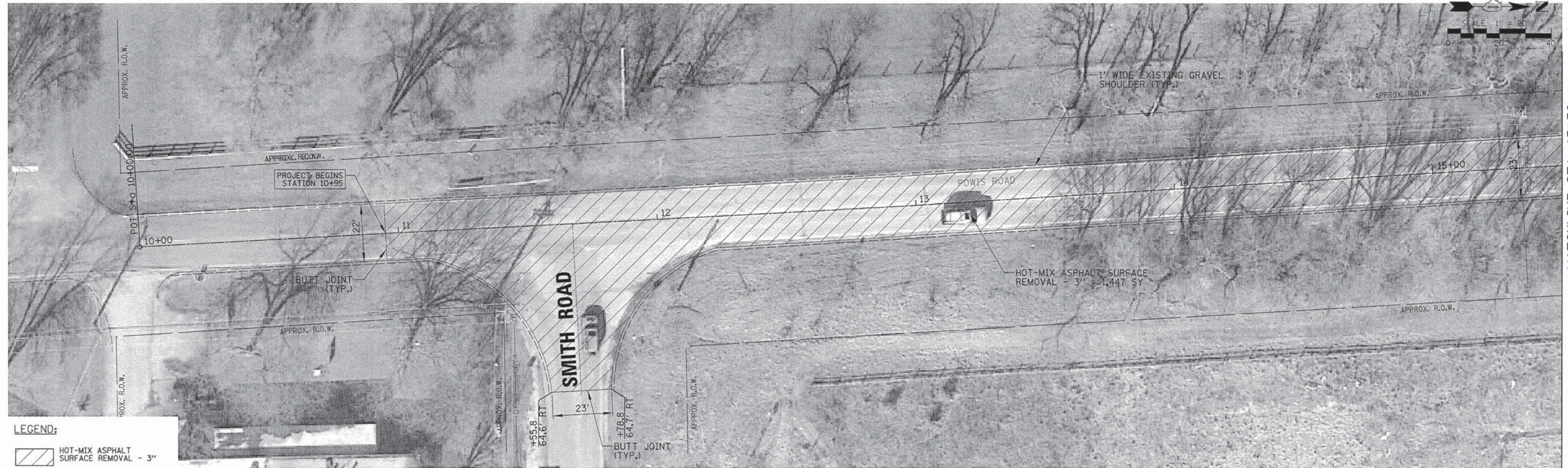

- LEGEND:**
- HOT-MIX ASPHALT SURFACE REMOVAL - 3"
 - CULVERT TO BE REMOVED
 - 1' WIDE EXISTING GRAVEL SHOULDER

MATCHLINE STA. 15+50

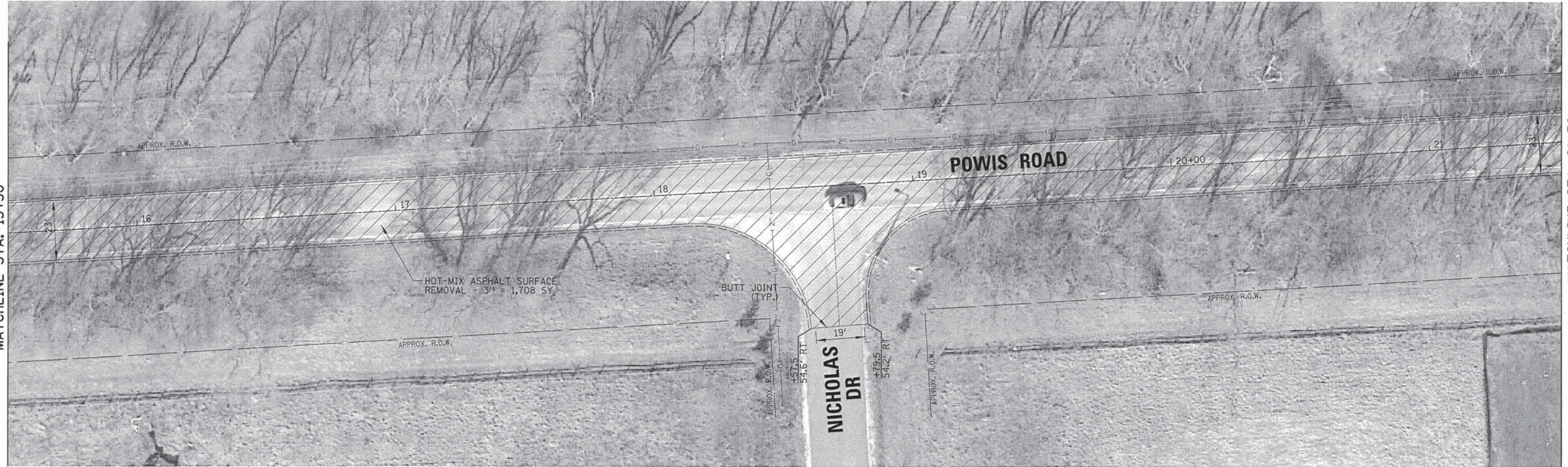

MATCHLINE STA. 15+50

MATCHLINE STA. 21+50

FILE NAME =	USER NAME = jlapaglia	DESIGNED - LMF	REVISED -
N:\WAYNE\910043\H0198\Civil\rem_910043\H0198-01.sht		DRAWN - FCP	REVISED -
PLOT SCALE = 20'		CHECKED - JGS	REVISED -
PLOT DATE = 1/30/2015		DATE - 12/05/14	REVISED -

**STATE OF ILLINOIS
DEPARTMENT OF TRANSPORTATION**

**POWIS ROAD
EXISTING CONDITIONS AND REMOVAL PLAN**

SCALE: 20' SHEET NO. 5 OF 21 SHEETS STA. TO STA.

F.A.U. RTE.	SECTION	COUNTY	TOTAL SHEETS	SHEET NO.
2745	14-00085-00-RS	LAKE	21	5
CONTRACT NO. 61B20			ILLINOIS FED. AID PROJECT	

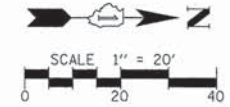
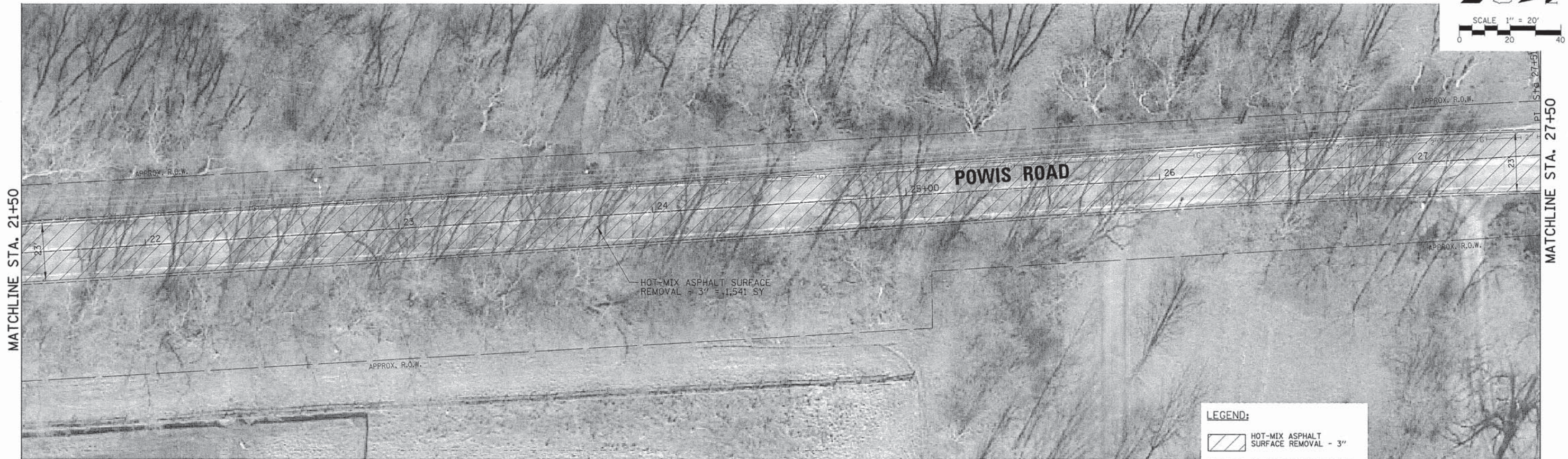

LEGEND:

- HOT-MIX ASPHALT SURFACE REMOVAL - 3"
- CULVERT TO BE REMOVED
- 1' WIDE EXISTING GRAVEL SHOULDER

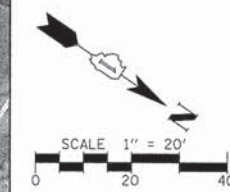
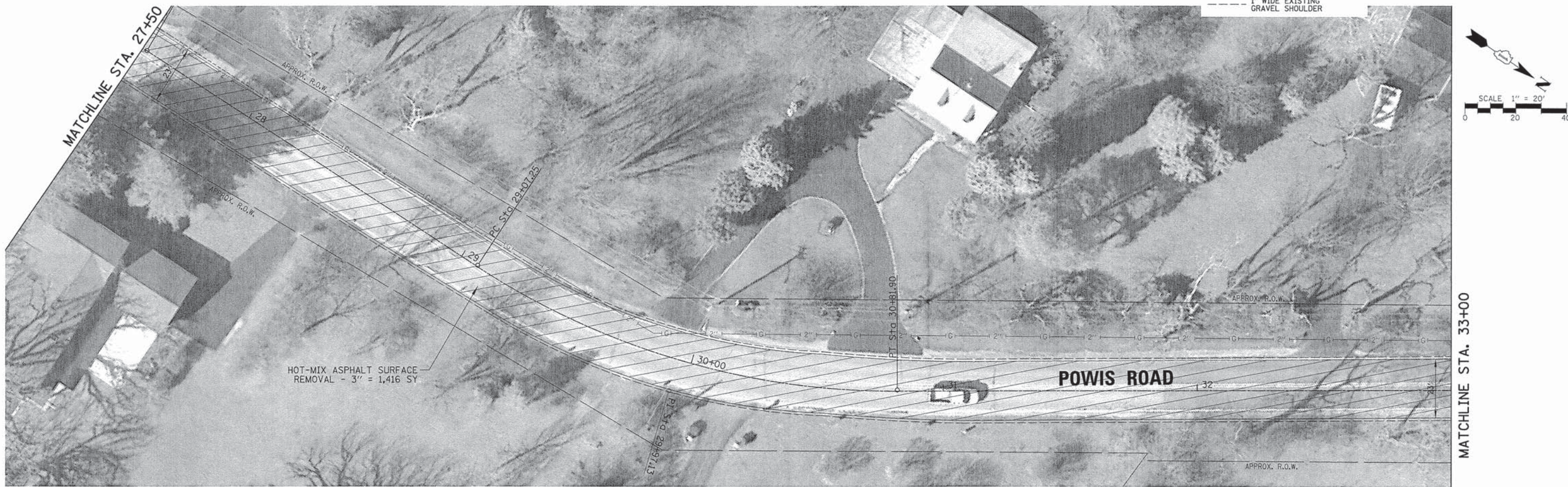

FILE NAME =	USER NAME = jlapaglia	DESIGNED - LMF	REVISED -	STATE OF ILLINOIS DEPARTMENT OF TRANSPORTATION	POWIS ROAD EXISTING CONDITIONS AND REMOVAL PLAN	F.A.U. RTE. 2745	SECTION 14-00085-00-RS	COUNTY LAKE	TOTAL SHEETS 21	SHEET NO. 6		
	PLOT SCALE = 20'	CHECKED - JGS	REVISED -			SCALE: 20'	SHEET NO. 6 OF 21 SHEETS	STA.	TO STA.	CONTRACT NO. 61B20		
	PLOT DATE = 1/30/2015	DATE - 12/05/14	REVISED -			ILLINOIS FED. AID PROJECT						

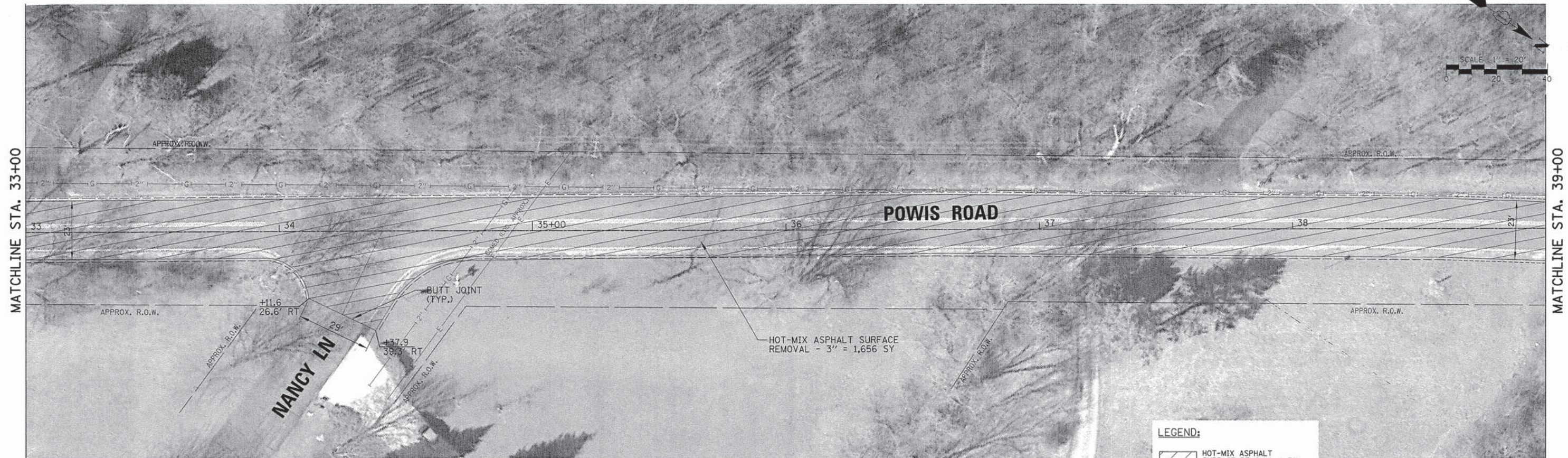

MATCHLINE STA. 33+00

MATCHLINE STA. 39+00

LEGEND:

- HOT-MIX ASPHALT SURFACE REMOVAL - 3"
- CULVERT TO BE REMOVED
- 1' WIDE EXISTING GRAVEL SHOULDER

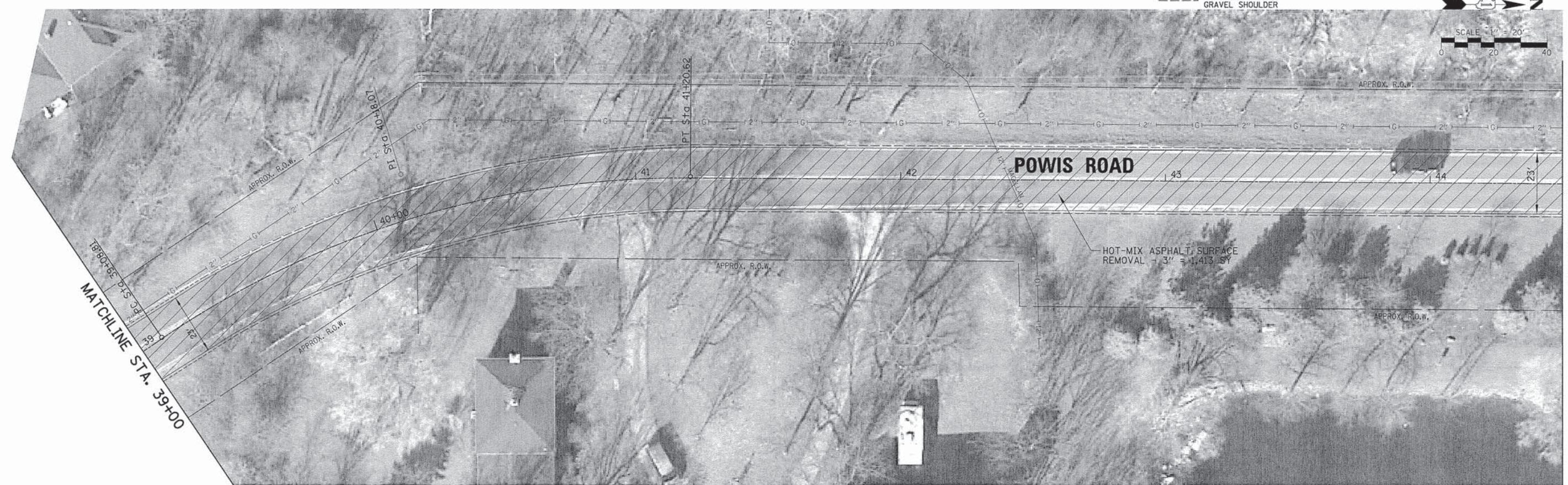
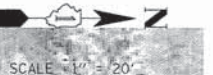
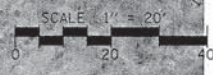

MATCHLINE STA. 44+50

FILE NAME =	USER NAME = jlapogis	DESIGNED - LMF	REVISED -
N:\WAYNE\910043\H0190\Civil\rem_910043\H0198-03.sht		DRAWN - FCP	REVISED -
	PLOT SCALE = 20'	CHECKED - JGS	REVISED -
	PLOT DATE = 1/30/2015	DATE - 12/05/14	REVISED -

**STATE OF ILLINOIS
DEPARTMENT OF TRANSPORTATION**

POWIS ROAD EXISTING CONDITIONS AND REMOVAL PLAN			
SCALE: 20'	SHEET NO. 7 OF 21 SHEETS	STA. _____	TO STA. _____

F.A.U. RTE.	SECTION	COUNTY	TOTAL SHEETS	SHEET NO.
2745	14-00085-00-RS	LAKE	21	7
CONTRACT NO. 61B20				
ILLINOIS FED. AID PROJECT				

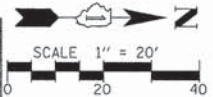

MATCHLINE STA. 44+50

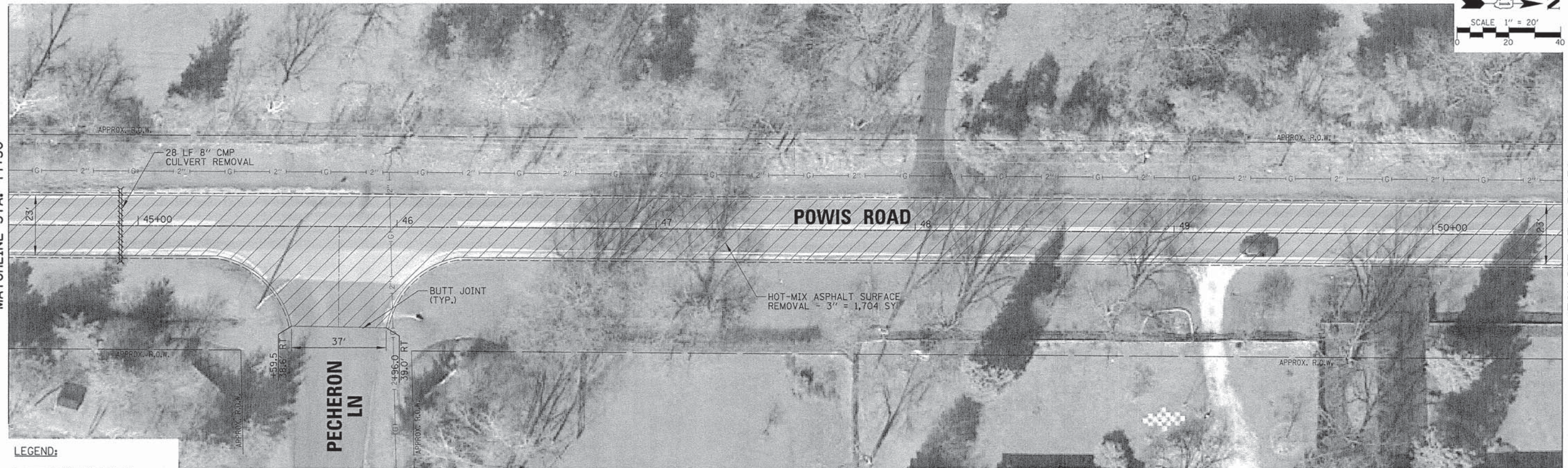

MATCHLINE STA. 50+50

- LEGEND:**
- HOT-MIX ASPHALT SURFACE REMOVAL - 3"
 - CULVERT TO BE REMOVED
 - 1' WIDE EXISTING GRAVEL SHOULDER

MATCHLINE STA. 50+50

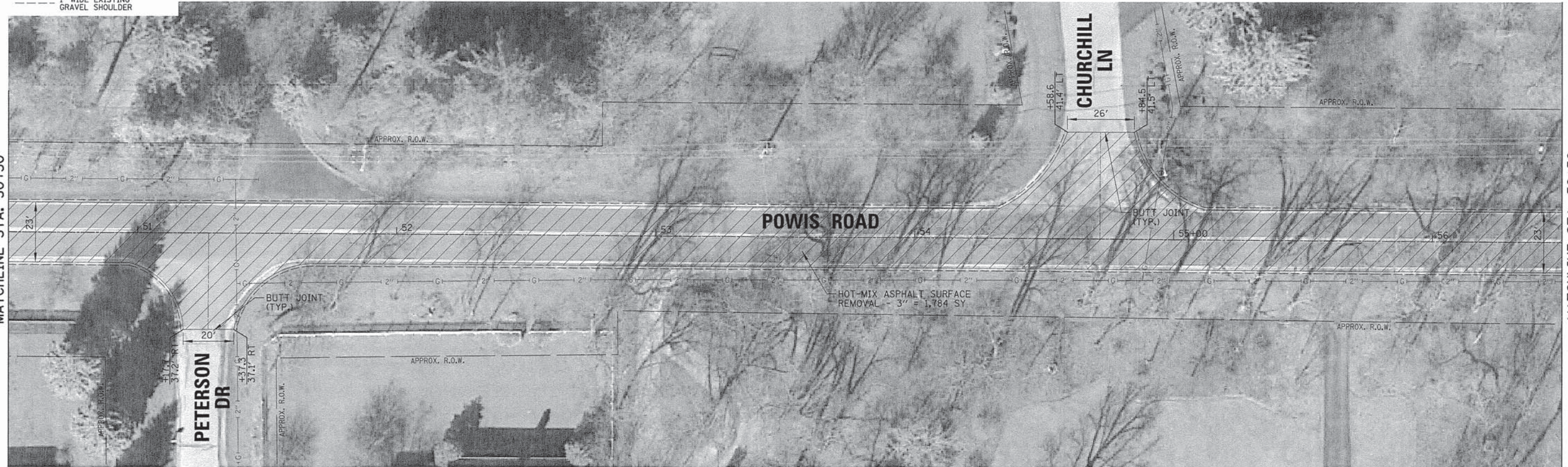

MATCHLINE STA. 56+50

FILE NAME =	USER NAME = jlapogio	DESIGNED - LMF	REVISED -
N:\MAYNE\910043\H0198\Civil\rem_910043\H0198-04.sht		DRAWN - FCP	REVISED -
	PLOT SCALE = 20'	CHECKED - JGS	REVISED -
	PLOT DATE = 1/30/2015	DATE = 12/05/14	REVISED -

**STATE OF ILLINOIS
DEPARTMENT OF TRANSPORTATION**

POWIS ROAD EXISTING CONDITIONS AND REMOVAL PLAN			
SCALE: 20'	SHEET NO. 8 OF 21 SHEETS	STA.	TO STA.

F.A.U. RTE.	SECTION	COUNTY	TOTAL SHEETS	SHEET NO.
2745	14-00085-00-RS	LAKE	21	8
CONTRACT NO. 61B20				
ILLINOIS FED. AID PROJECT				

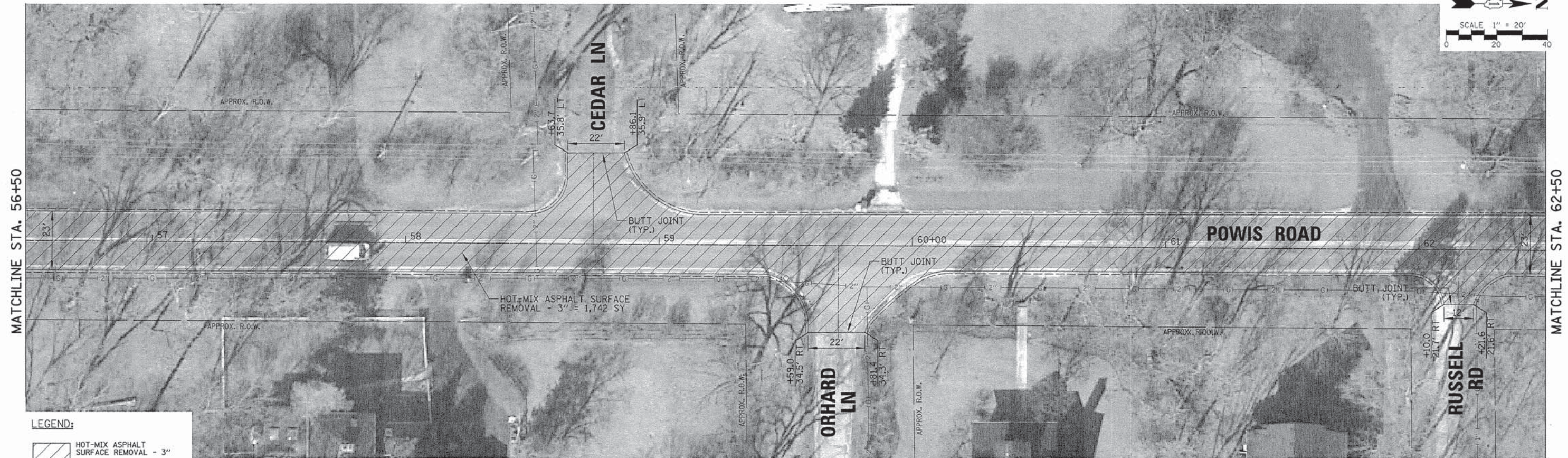
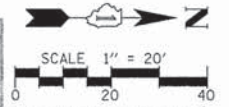

MATCHLINE STA. 56+50

MATCHLINE STA. 62+50

- LEGEND:**
- HOT-MIX ASPHALT SURFACE REMOVAL - 3"
 - CULVERT TO BE REMOVED
 - 1' WIDE EXISTING GRAVEL SHOULDER

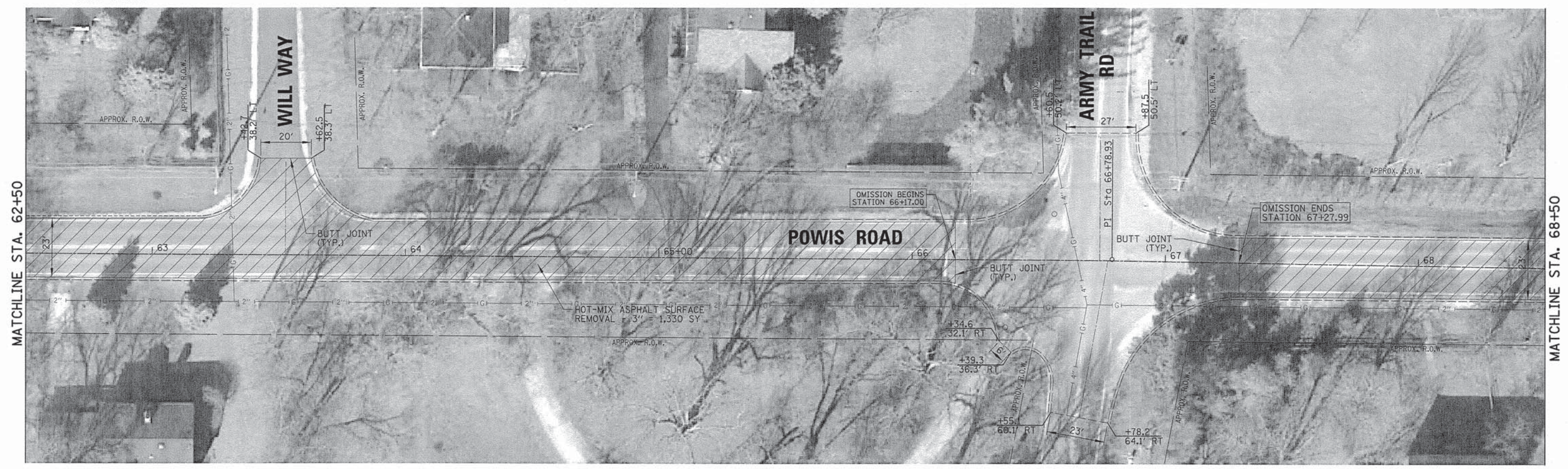

MATCHLINE STA. 62+50

MATCHLINE STA. 68+50

FILE NAME =	USER NAME = jlopagio	DESIGNED - LMF	REVISED -
N:\WAYNE\910043\H0190\Civil\rem_910043.H0190-05.sht		DRAWN - FCP	REVISED -
	PLOT SCALE = 20'	CHECKED - JGS	REVISED -
	PLOT DATE = 1/30/2015	DATE - 12/05/14	REVISED -

**STATE OF ILLINOIS
DEPARTMENT OF TRANSPORTATION**

POWIS ROAD EXISTING CONDITIONS AND REMOVAL PLAN			
SCALE: 20'	SHEET NO. 9 OF 21 SHEETS	STA. TO STA.	

F.A.U. RTE.	SECTION	COUNTY	TOTAL SHEETS	SHEET NO.
2745	14-00085-00-RS	LAKE	21	9
CONTRACT NO. 61B20				
ILLINOIS FED. AID PROJECT				

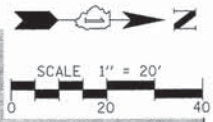

MATCHLINE STA. 68+50

MATCHLINE STA. 74+50

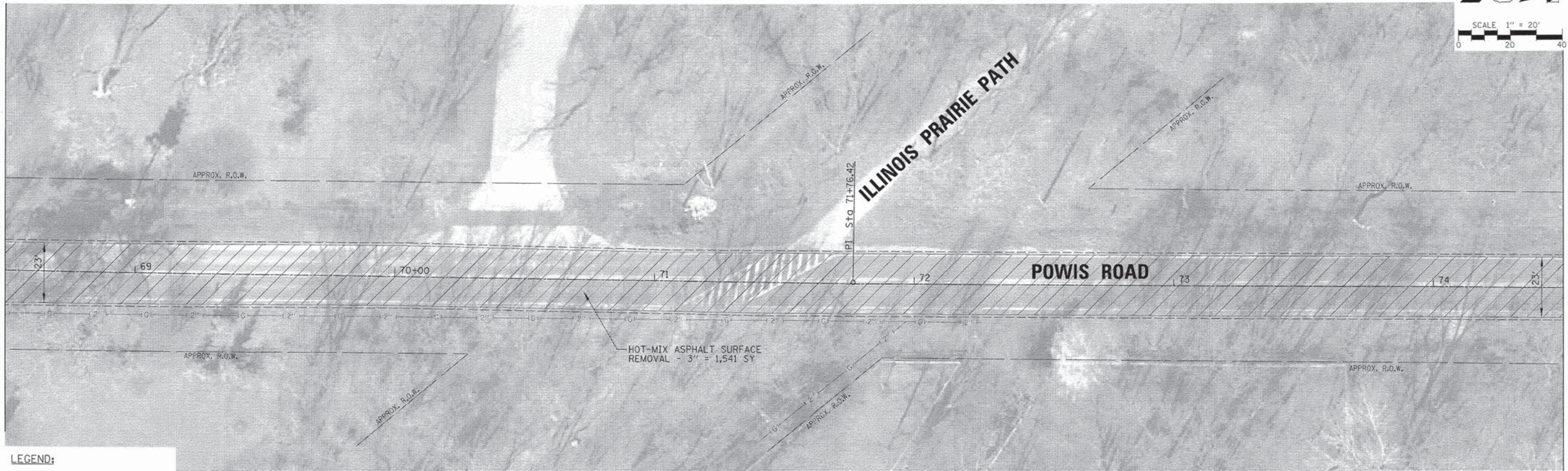

LEGEND:

- HOT-MIX ASPHALT SURFACE REMOVAL - 3"
- CULVERT TO BE REMOVED
- 1' WIDE EXISTING GRAVEL SHOULDER

MATCHLINE STA. 74+50

MATCHLINE STA. 80+50

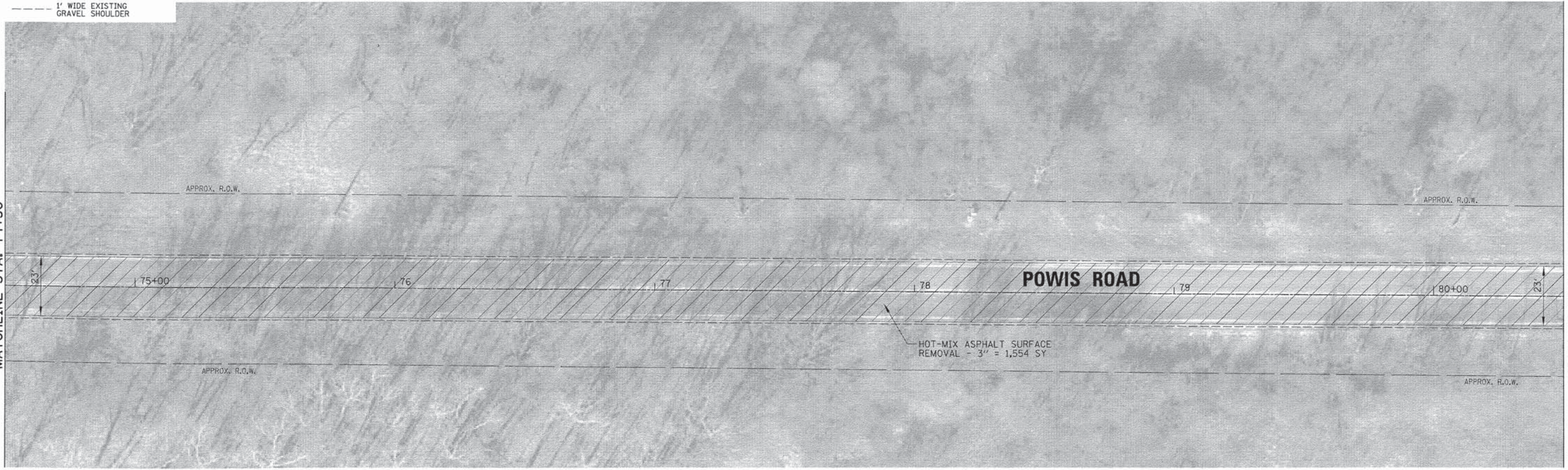

FILE NAME =	USER NAME = jlopogla	DESIGNED = LMF	REVISED =
N:\WAYNE\918043\H0198\Civil\com_918043\H0198-06.sht		DRAWN = FCP	REVISED =
	PLOT SCALE = 20'	CHECKED = JGS	REVISED =
	PLOT DATE = 2/6/2015	DATE = 02/06/15	REVISED =

**STATE OF ILLINOIS
DEPARTMENT OF TRANSPORTATION**

**POWIS ROAD
EXISTING CONDITIONS AND REMOVAL PLAN**

SCALE: 20' SHEET NO. 10 OF 21 SHEETS STA. TO STA.

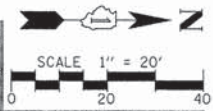

F.A.U. RTE.	SECTION	COUNTY	TOTAL SHEETS	SHEET NO.
2745	14-00085-00-RS	LAKE	21	10
CONTRACT NO. 61B20				
ILLINOIS FED. AID PROJECT				

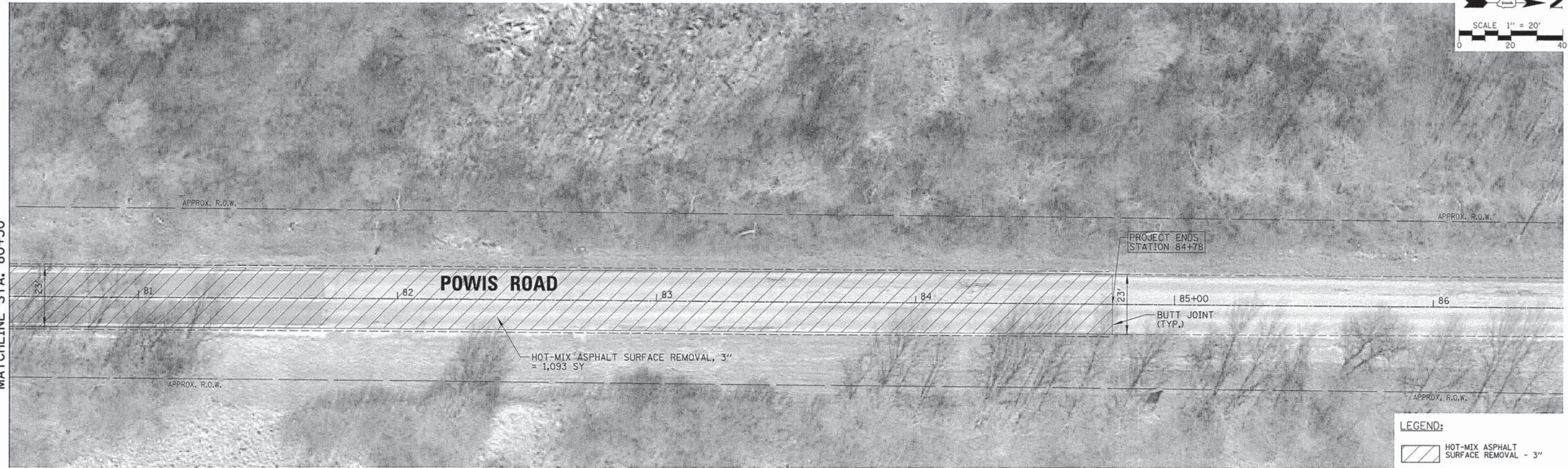

MATCHLINE STA. 80+50



LEGEND:

	HOT-MIX ASPHALT SURFACE REMOVAL - 3"
	CULVERT TO BE REMOVED
	1' WIDE EXISTING GRAVEL SHOULDER

FILE NAME =	USER NAME = jlapaglia	DESIGNED - LMF	REVISED -
N:\WAYNE\910043\H0198\Civil\rem_910043.H0198-07.sht		DRAWN - FCP	REVISED -
	PLOT SCALE = 20'	CHECKED - JGS	REVISED -
	PLOT DATE = 1/30/2015	DATE - 12/05/14	REVISED -

**STATE OF ILLINOIS
DEPARTMENT OF TRANSPORTATION**

POWIS ROAD EXISTING CONDITIONS AND REMOVAL PLAN			
SCALE: 20'	SHEET NO. 11 OF 21 SHEETS	STA.	TO STA.

F.A.U. RTE.	SECTION	COUNTY	TOTAL SHEETS	SHEET NO.
2745	14-00085-00-RS	LAKE	21	11
CONTRACT NO. 61B20				
ILLINOIS FED. AID PROJECT				

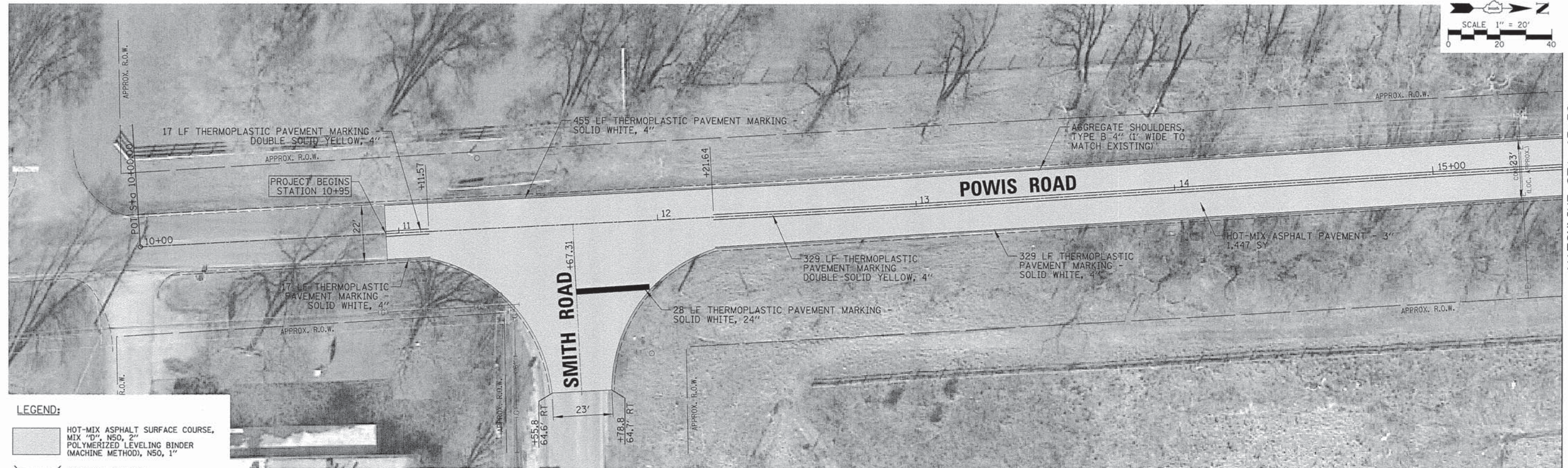
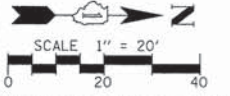

LEGEND:

HOT-MIX ASPHALT SURFACE COURSE, MIX "D", NSO, 2" POLYMERIZED LEVELING BINDER (MACHINE METHOD), NSO, 1"

PROPOSED CULVERT

AGGREGATE SHOULDERS, TYPE B 4"

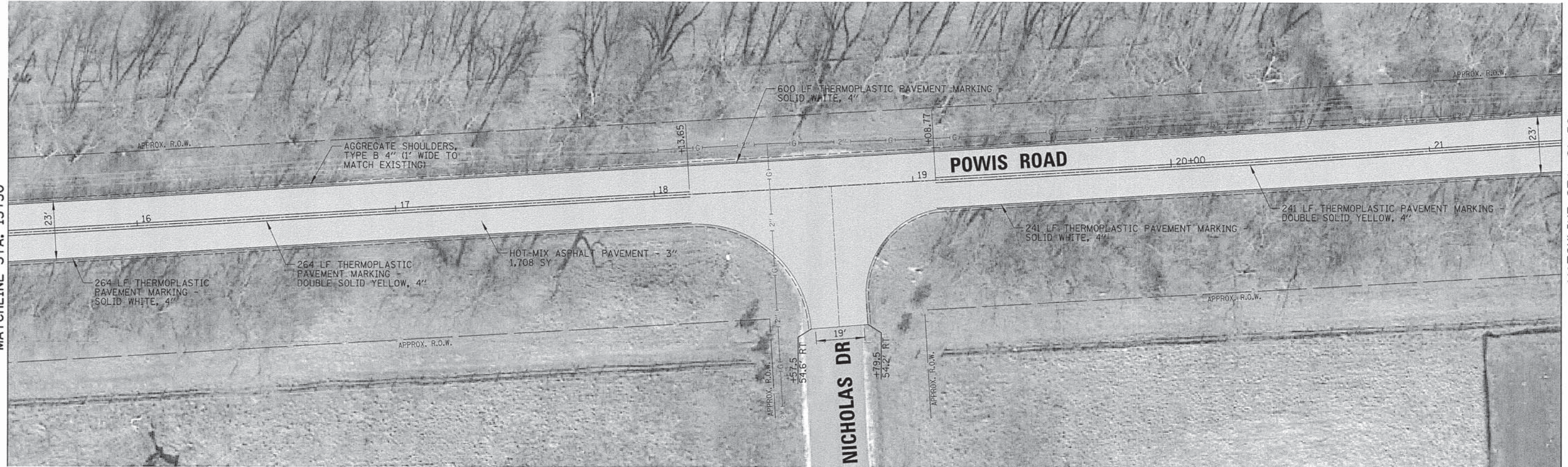

FILE NAME = N:\WAYNE\910043.H0198\Civil\plan_910043.H0198-01.sht	USER NAME = jlepeglio	DESIGNED - LMF	REVISED -	STATE OF ILLINOIS DEPARTMENT OF TRANSPORTATION	POWIS ROAD PROPOSED PLAN	F.A.U. RTE. 2745	SECTION 14-00085-00-RS	COUNTY LAKE	TOTAL SHEETS 21	SHEET NO. 12		
PLOT SCALE = 20'		DRAWN - FCP	REVISED -			SCALE: 20'	SHEET NO. 12 OF 21 SHEETS	TO STA.	CONTRACT NO. 61B20			
PLOT DATE = 1/30/2015		CHECKED - JGS	REVISED -			ILLINOIS FED. AID PROJECT						
		DATE = 12/05/14	REVISED -									

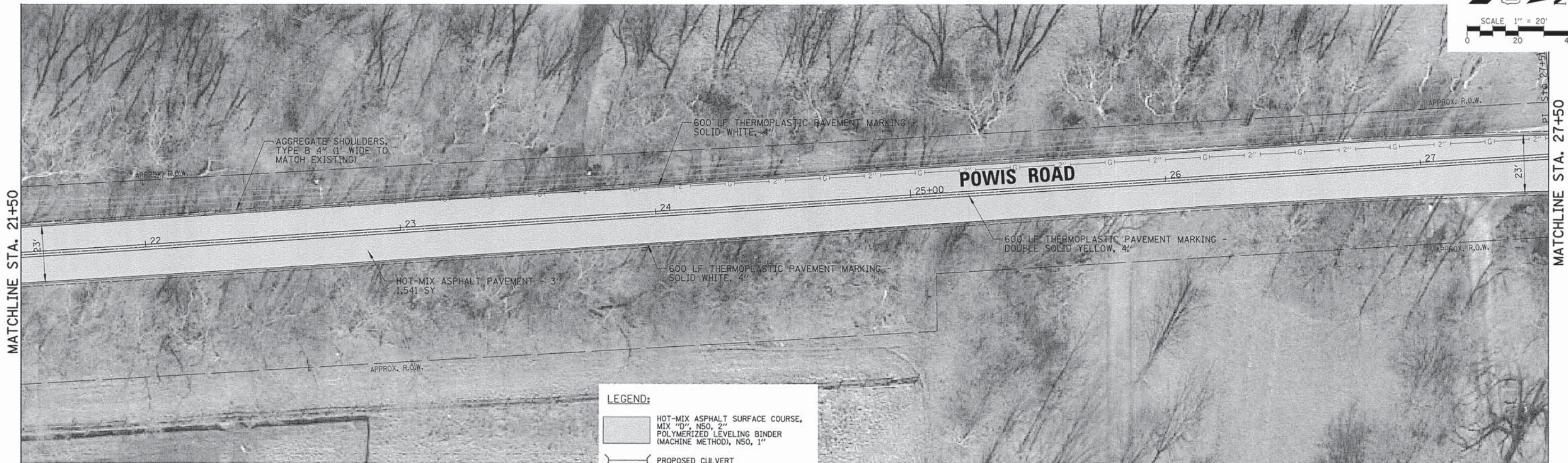

LEGEND:

- HOT-MIX ASPHALT SURFACE COURSE, MIX "D", N50, 2" POLYMERIZED LEVELING BINDER (MACHINE METHOD), N50, 1"
- PROPOSED CULVERT
- AGGREGATE SHOULDERS, TYPE B 4"

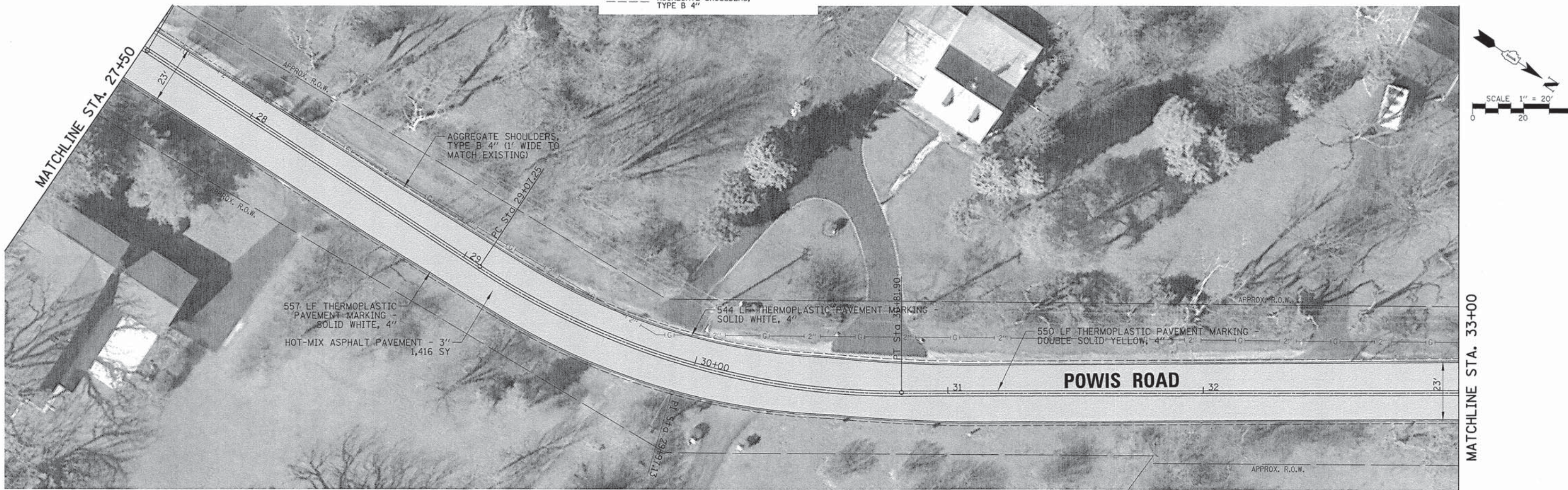

FILE NAME =	USER NAME = jlopegio	DESIGNED - LMF	REVISED -	STATE OF ILLINOIS DEPARTMENT OF TRANSPORTATION	POWIS ROAD PROPOSED PLAN	F.A.U. RTE.	SECTION	COUNTY	TOTAL SHEETS	SHEET NO.	
		DRAWN - FCP	REVISED -			2745	14-00085-00-RS	LAKE	21	13	
		CHECKED - JGS	REVISED -			CONTRACT NO. 61B20					
		DATE - 12/05/14	REVISED -			ILLINOIS FED. AID PROJECT					
PLOT SCALE = 20'		DATE = 12/05/14		SCALE: 20'		SHEET NO. 13 OF 21 SHEETS		STA.		TO STA.	

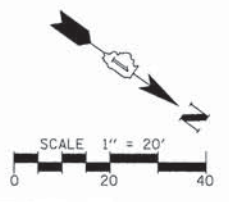

MATCHLINE STA. 33+00

MATCHLINE STA. 39+00

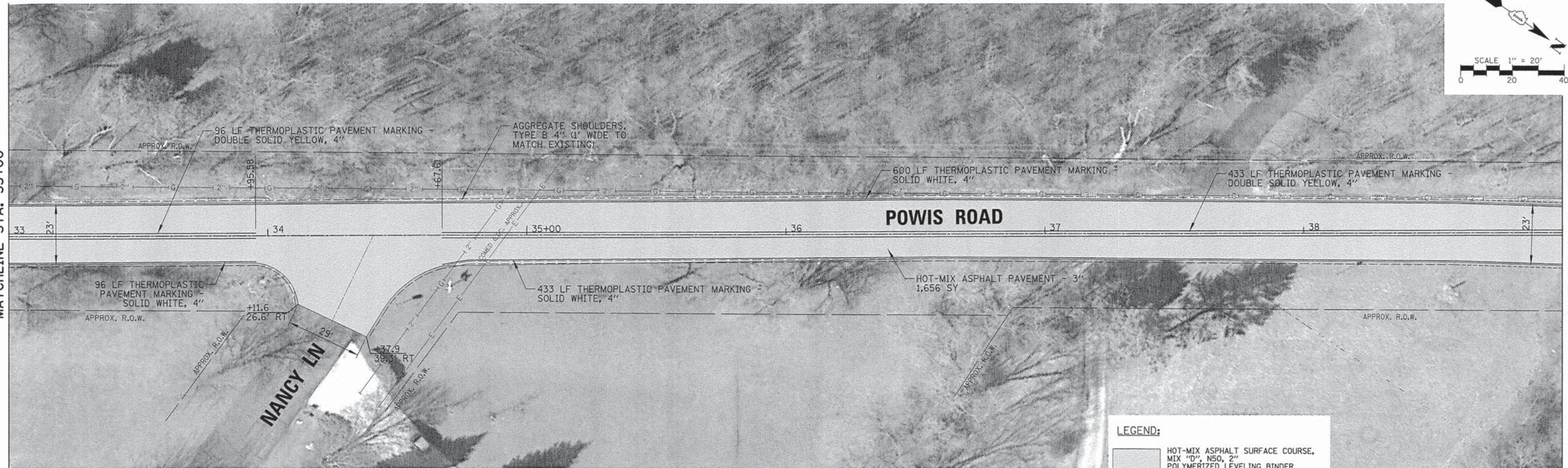

LEGEND:

- HOT-MIX ASPHALT SURFACE COURSE, MIX "D", N50, 2" POLYMERIZED LEVELING BINDER (MACHINE METHOD), N50, 1"
- PROPOSED CULVERT
- AGGREGATE SHOULDERS, TYPE B 4"

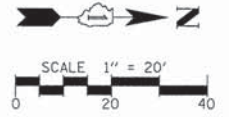

MATCHLINE STA. 44+50

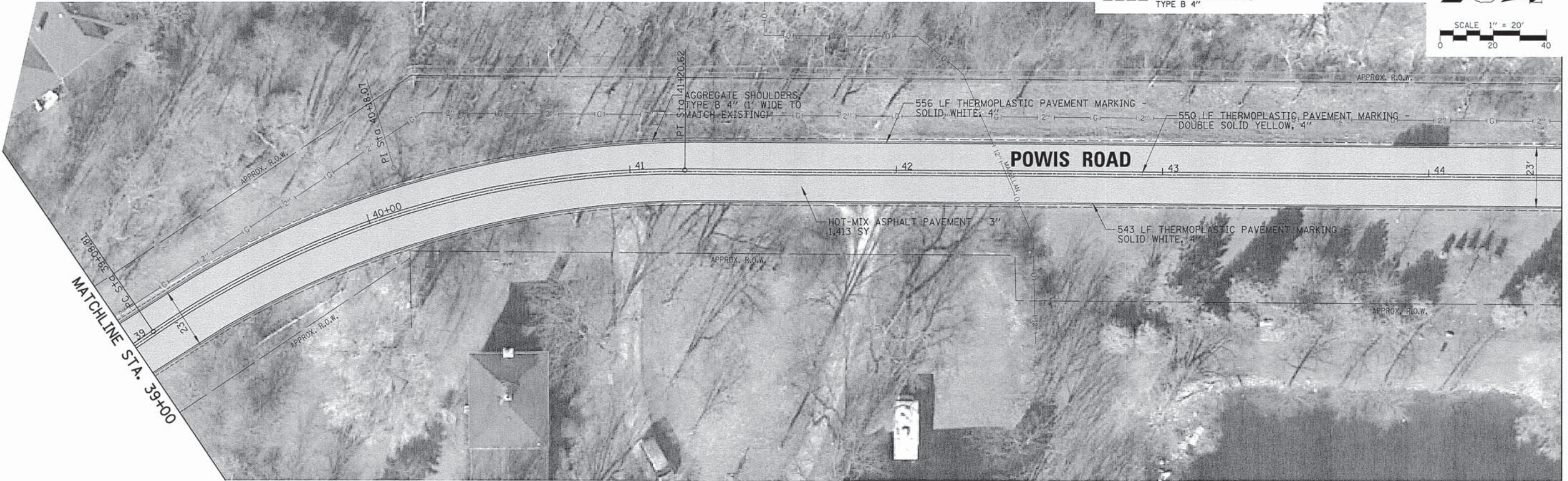

FILE NAME =	USER NAME = jlapogio	DESIGNED - LMF	REVISED -	STATE OF ILLINOIS DEPARTMENT OF TRANSPORTATION	POWIS ROAD PROPOSED PLAN	F.A.U. RTE.	SECTION	COUNTY	TOTAL SHEETS	SHEET NO.	
		DRAWN - FCP	REVISED -			2745	14-00085-00-RS	LAKE	21	14	
	PLOT SCALE = 20'	CHECKED - JGS	REVISED -			CONTRACT NO. 61B20					
	PLOT DATE = 1/30/2015	DATE - 12/05/14	REVISED -			ILLINOIS FED. AID PROJECT					
					SCALE: 20'	SHEET NO. 14 OF 21 SHEETS		STA.	TO STA.		

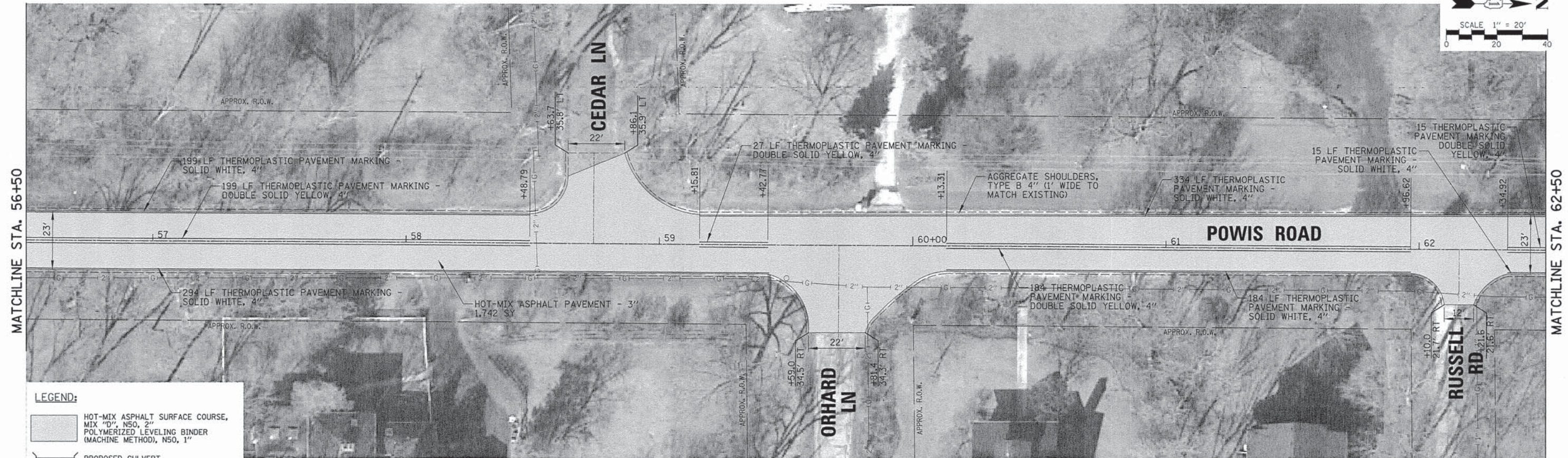

- LEGEND:**
- HOT-MIX ASPHALT SURFACE COURSE, MIX "D", N50, 2" POLYMERIZED LEVELING BINDER (MACHINE METHOD), N50, 1"
 - PROPOSED CULVERT
 - AGGREGATE SHOULDERS, TYPE B 4"

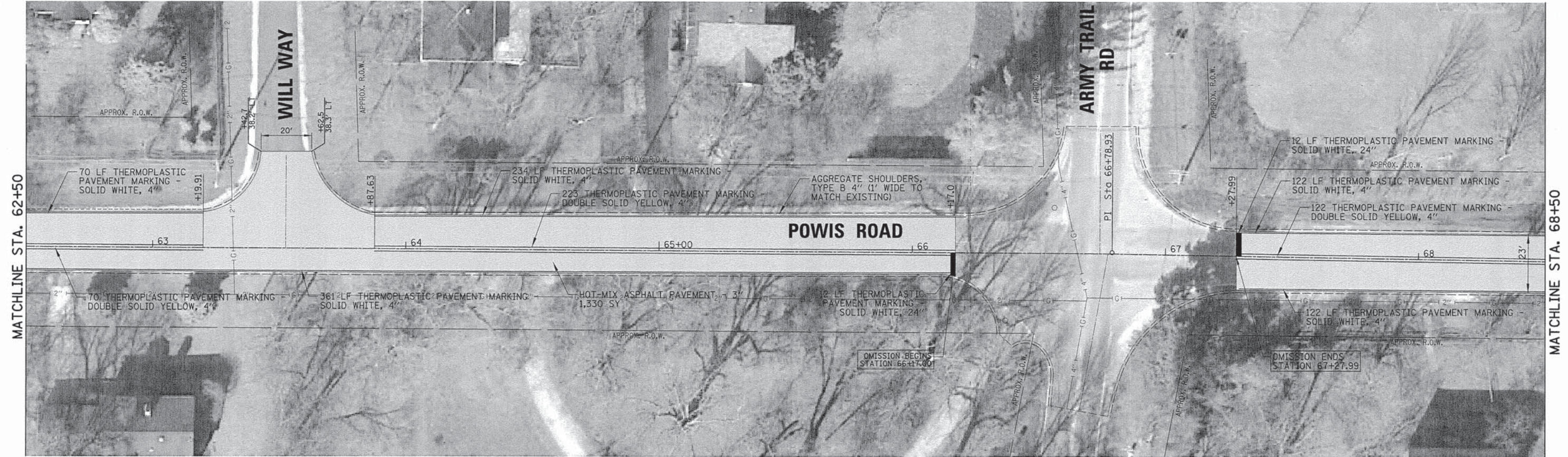

FILE NAME =	USER NAME = jlapogio	DESIGNED - LMF	REVISED -	STATE OF ILLINOIS DEPARTMENT OF TRANSPORTATION	POWIS ROAD PROPOSED PLAN	F.A.U. RTE.	SECTION	COUNTY	TOTAL SHEETS	SHEET NO.	
N:\WAYNE\910043\H0198\Civil\p1n_910043\H0198-05.sht	PLOT SCALE = 20'	DRAWN - FCP	REVISED -			2745	14-00085-00-RS	LAKE	21	16	
	PLOT DATE = 1/30/2015	CHECKED - JGS	REVISED -			CONTRACT NO. 61B20					
		DATE - 12/05/14	REVISED -			ILLINOIS FED. AID PROJECT					

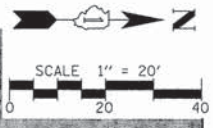

MATCHLINE STA. 68+50

MATCHLINE STA. 74+50

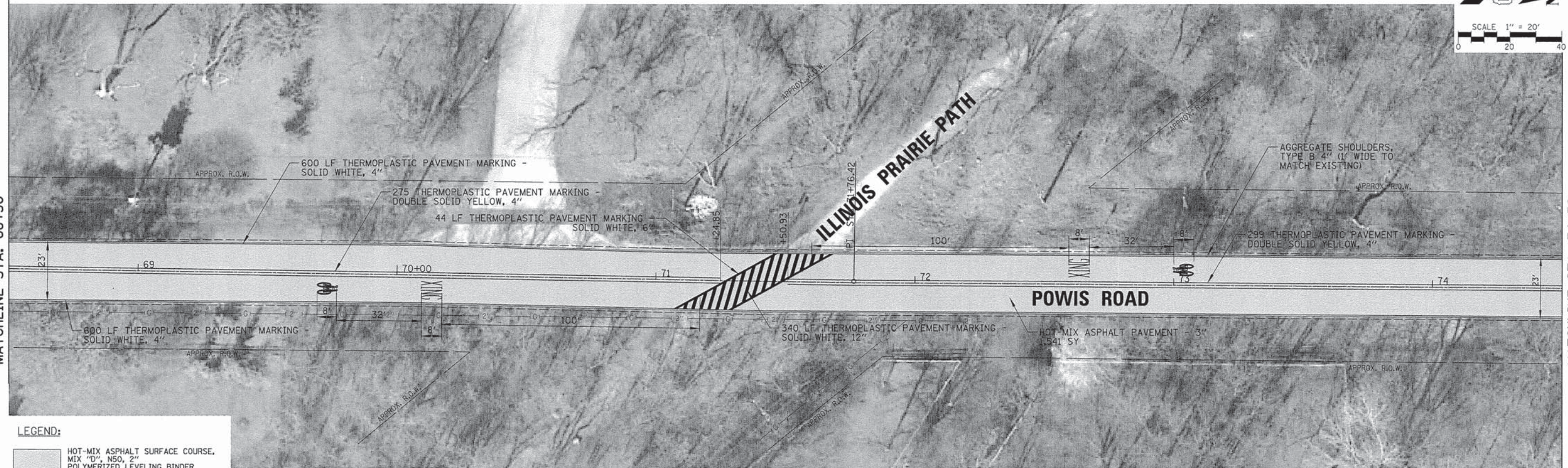

LEGEND:

- HOT-MIX ASPHALT SURFACE COURSE, MIX "D", N50, 2" POLYMERIZED LEVELING BINDER (MACHINE METHOD), N50, 1"
- PROPOSED CULVERT
- AGGREGATE SHOULDERS, TYPE B 4"

MATCHLINE STA. 74+50

MATCHLINE STA. 80+50

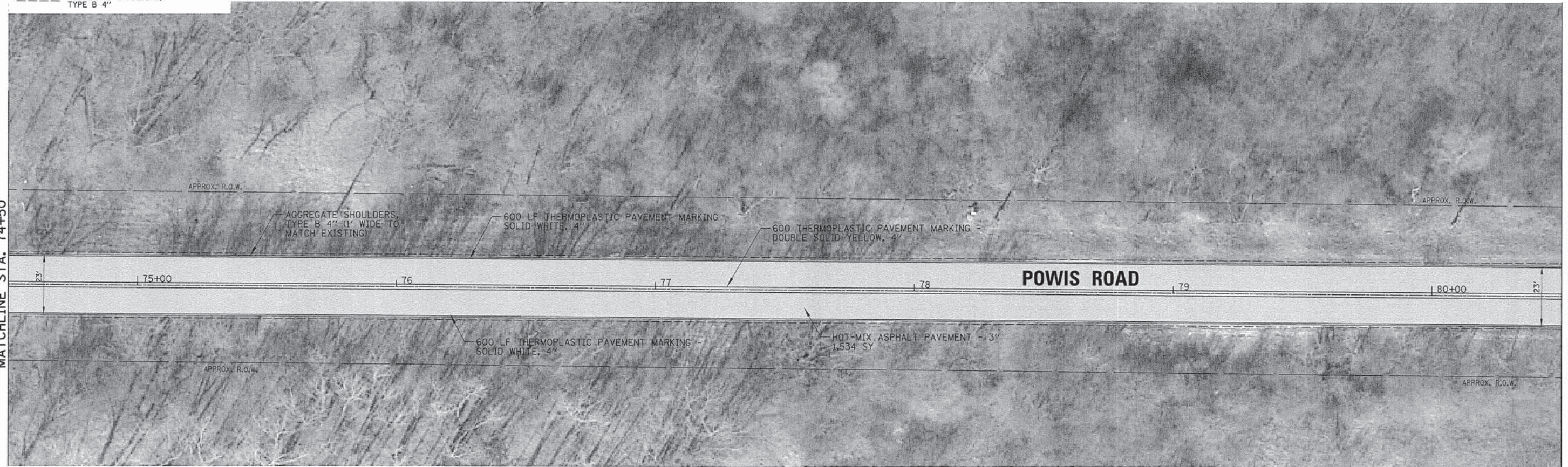

FILE NAME =	USER NAME = jlepego	DESIGNED - LMF	REVISED -	STATE OF ILLINOIS DEPARTMENT OF TRANSPORTATION	POWIS ROAD PROPOSED PLAN	F.A.U. RTE.	SECTION	COUNTY	TOTAL SHEETS	SHEET NO.	
		DRAWN - FCP	REVISED -			2745	14-00085-00-RS	LAKE	21	17	
	PLOT SCALE = 20'	CHECKED - JGS	REVISED -			CONTRACT NO. 61B20					
	PLOT DATE = 1/30/2015	DATE - 12/05/14	REVISED -			ILLINOIS FED. AID PROJECT					
					SCALE: 20'	SHEET NO. 17 OF 21 SHEETS		STA.	TO STA.		

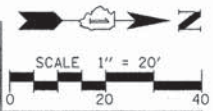

MATCHLINE STA. 80+50

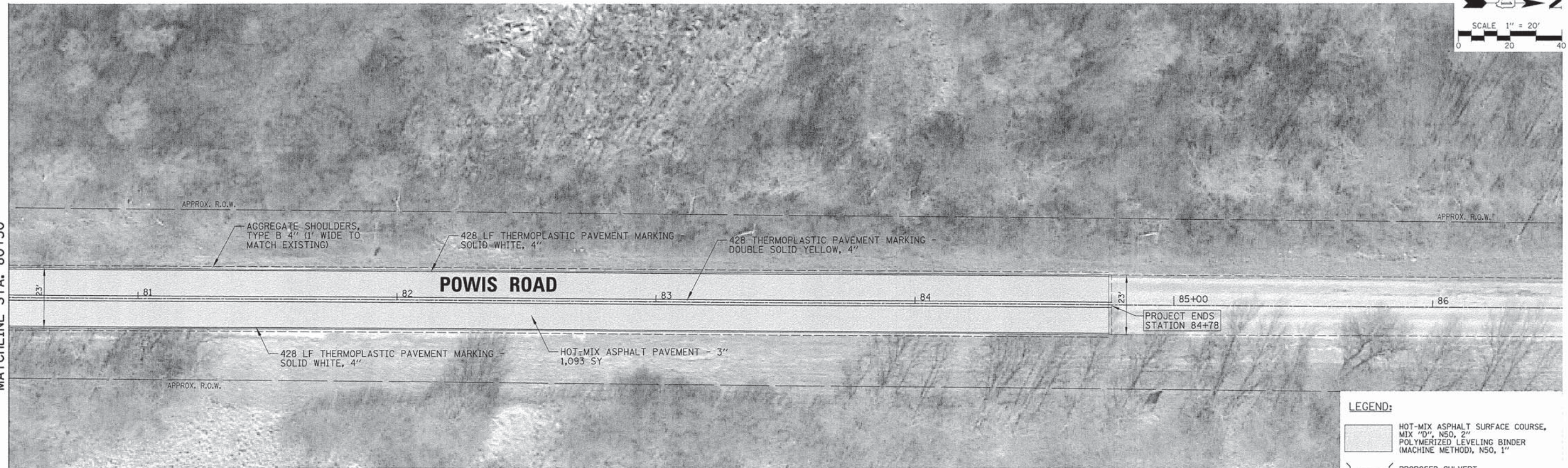

- LEGEND:**
- HOT-MIX ASPHALT SURFACE COURSE, MIX "D", N50, 2" POLYMERIZED LEVELING BINDER (MACHINE METHOD), N50, 1"
 - PROPOSED CULVERT
 - AGGREGATE SHOULDERS, TYPE B 4"

FILE NAME =	USER NAME = jlepogio	DESIGNED - LMF	REVISED -
N:\MAYNE\910243\H0198\Civil\pIn_910243\H0198-07.sht		DRAWN - FCP	REVISED -
	PLOT SCALE = 20'	CHECKED - JGS	REVISED -
	PLOT DATE = 1/30/2015	DATE - 12/05/14	REVISED -

**STATE OF ILLINOIS
DEPARTMENT OF TRANSPORTATION**

**POWIS ROAD
PROPOSED PLAN**

SCALE: 20' SHEET NO. 18 OF 21 SHEETS STA. TO STA.

F.A.U. RTE.	SECTION	COUNTY	TOTAL SHEETS	SHEET NO.
2745	14-00085-00-RS	LAKE	21	18
CONTRACT NO. 61B20				
ILLINOIS FED. AID PROJECT				

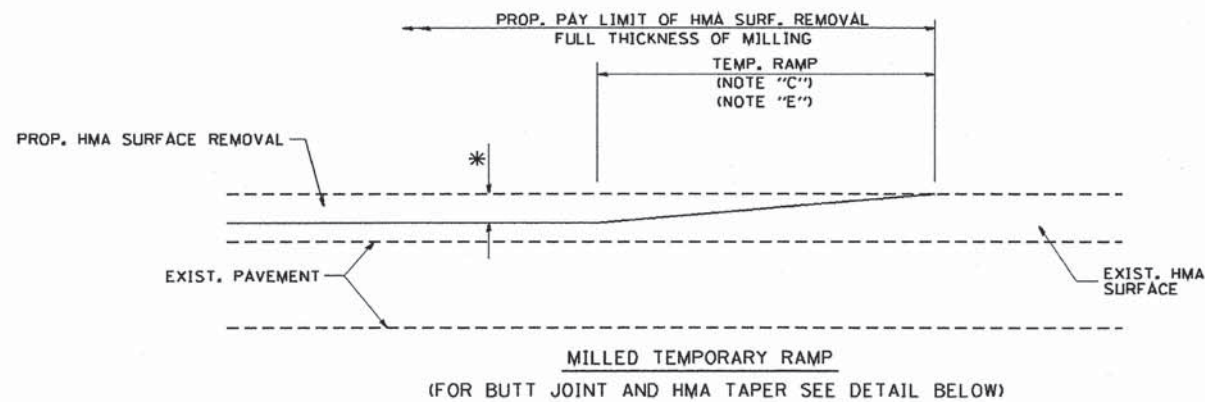

OPTION 1

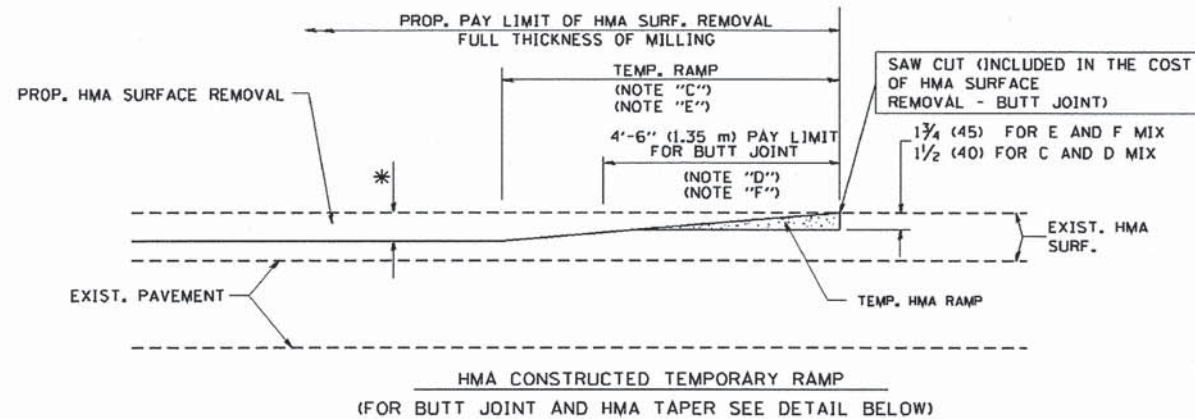

OPTION 2

TYPICAL TEMPORARY RAMP

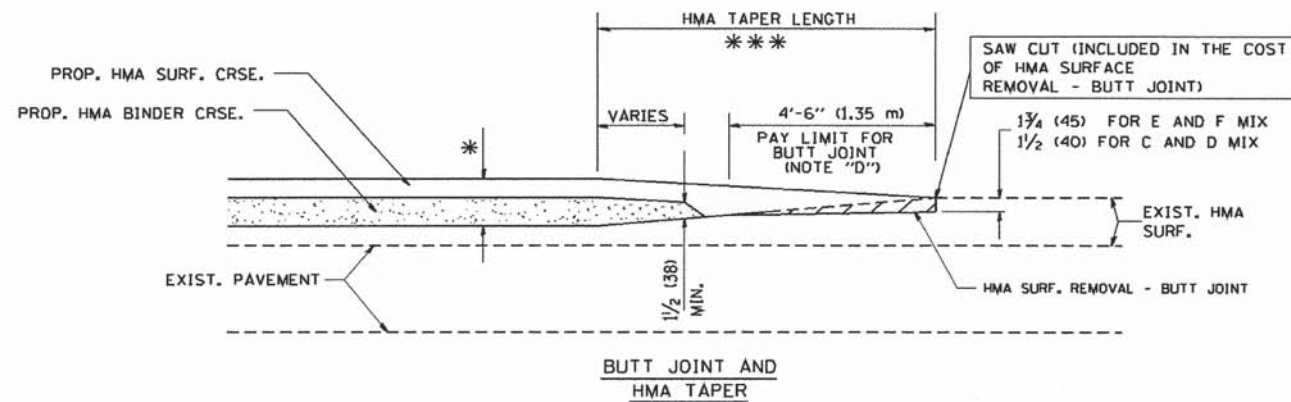

TYPICAL BUTT JOINT AND HMA TAPER FOR MILLING AND RESURFACING

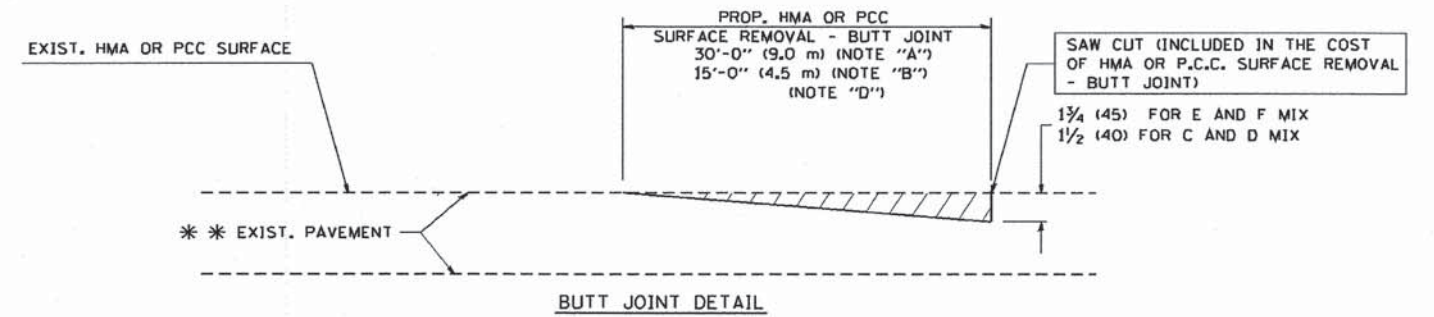

BUTT JOINT DETAIL

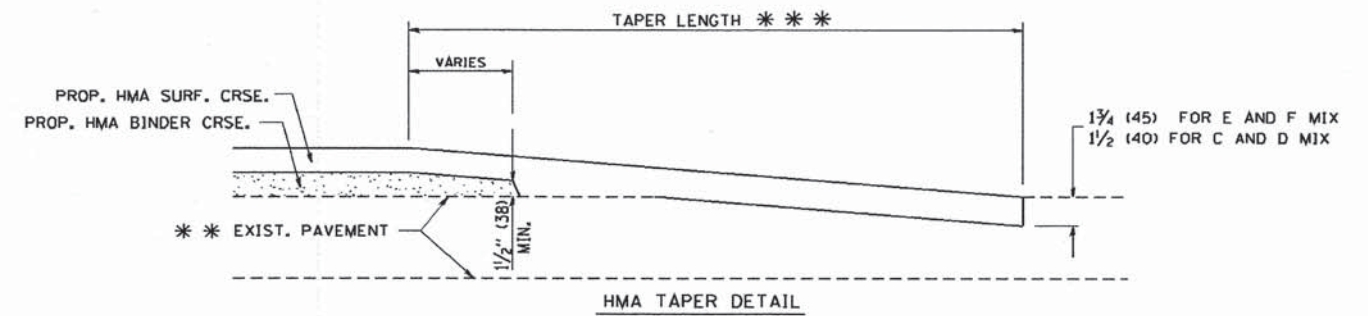

HMA TAPER DETAIL

TYPICAL BUTT JOINT AND HMA TAPER FOR RESURFACING ONLY

*** PC CONCRETE, HMA OR HMA RESURFACED PAVEMENT.

NOTES

- A: MAINLINE ROADWAYS AND MAJOR SIDE ROADS.
 - B: MINOR SIDE ROADS.
 - C: THE TEMP. RAMP SHALL BE CONSTRUCTED IMMEDIATELY UPON REMOVAL OF THE EXISTING HMA SURFACE.
 - D: THE BUTT JOINT SHALL BE CONSTRUCTED IMMEDIATELY PRIOR TO PLACING THE PROPOSED HMA COURSES.
 - E: TAPER THE TEMP. RAMP AT A RATE OF 3'-0" (900 mm) PER 1 INCH (25 mm) OF MILLING THICKNESS.
 - F: INSTALLATION AND REMOVAL OF THE 4'-6" (1.35 m) TEMP. RAMP IS INCLUDED IN COST OF HMA SURFACE REMOVAL - BUTT JOINT
 - G: SEE ARTICLE 406.08 AND 406.14 OF THE STANDARD SPECIFICATIONS FOR "HMA AND/OR PCC SURFACE REMOVAL, BUTT JOINT".
- * SEE TYPICAL SECTIONS FOR MILLING THICKNESS.
- *** 20'-0" (6.1 m) PER 1 (25) RESURFACING (NOTE "A")
10'-0" (3.0 m) PER 1 (25) RESURFACING (NOTE "B")

BASIS OF PAYMENT:

ALL BUTT JOINTS ARE INCIDENTAL TO THE SURFACE COURSE.

ALL DIMENSIONS ARE IN INCHES (MILLIMETERS) UNLESS OTHERWISE SHOWN.

FILE NAME = W:\diststd\22x34\bd32.dgn	USER NAME = gaglianob	DESIGNED - M. DE YONG	REVISED - R. SHAH 10-25-94
		DRAWN -	REVISED - A. ABBAS 03-21-97
	PLOT SCALE = 50.0000 - / IN.	CHECKED -	REVISED - M. GOMEZ 04-06-01
	PLOT DATE = 1/4/2008	DATE - 06-13-90	REVISED - R. BORO 01-01-07

STATE OF ILLINOIS
DEPARTMENT OF TRANSPORTATION

BUTT JOINT AND
HMA TAPER DETAILS

SCALE: NONE SHEET NO. 1 OF 1 SHEETS STA. TO STA.

F.A. RTE.	SECTION	COUNTY	TOTAL SHEETS	SHEET NO.
530	14-00010-00-RS	DuPAGE	21	19
BD400-05 BD32			CONTRACT NO.	
FED. ROAD DIST. NO. 1 ILLINOIS FED. AID PROJECT				

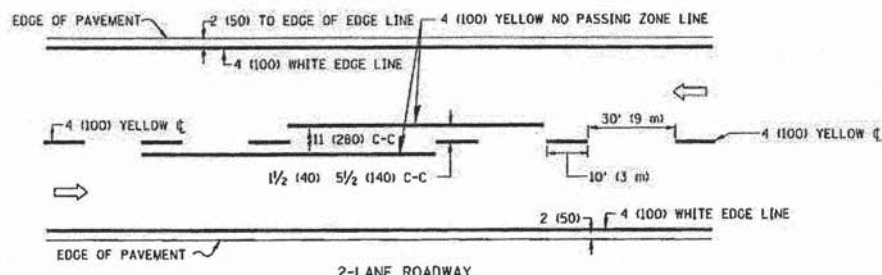

2-LANE ROADWAY

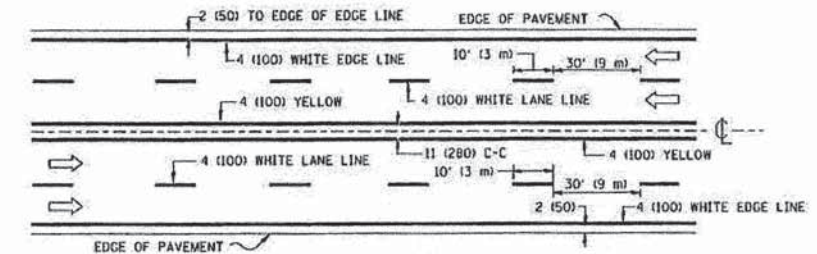

MULTI-LANE UNDIVIDED

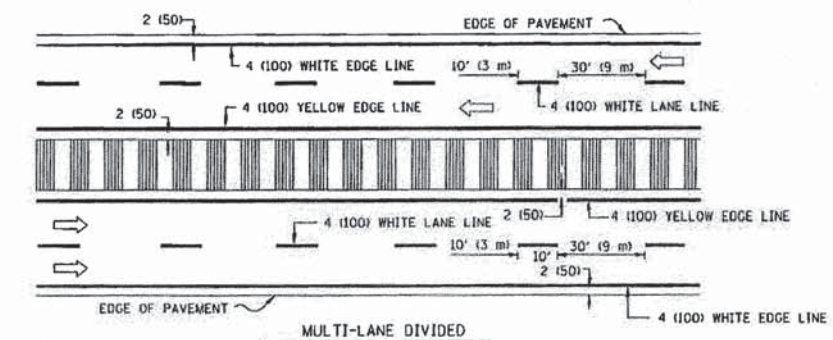

MULTI-LANE DIVIDED WITH MOUNTABLE MEDIAN

NOTE: MEDIANS WITH BARRIER CURB DO NOT REQUIRE AN EDGE LINE

TYPICAL LANE AND EDGE LINE MARKING

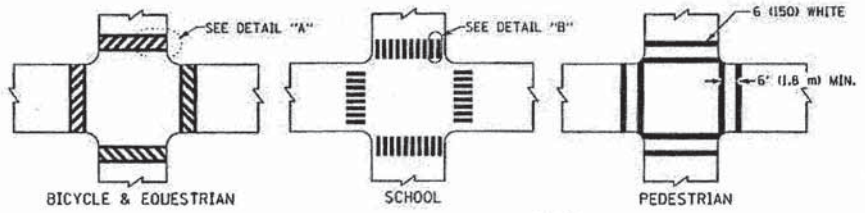

TYPICAL CROSSWALK MARKING

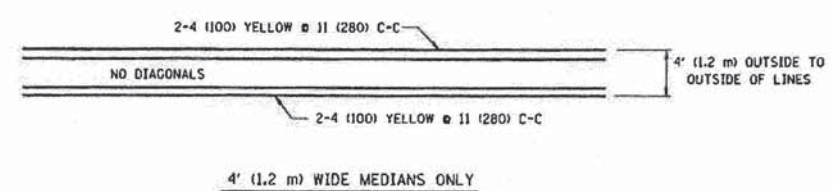

4' (1.2 m) WIDE MEDIANS ONLY

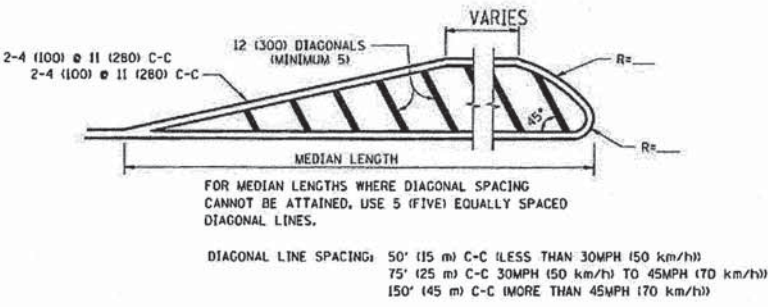

MEDIANS OVER 4' (1.2 m) WIDE

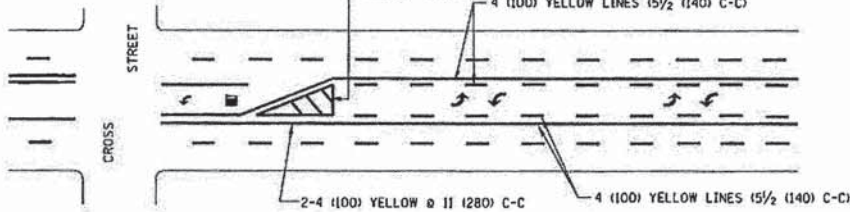

TYPICAL PAINTED MEDIAN MARKING

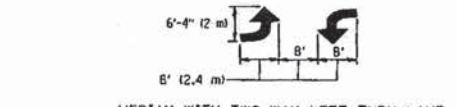

MEDIAN WITH TWO-WAY LEFT TURN LANE

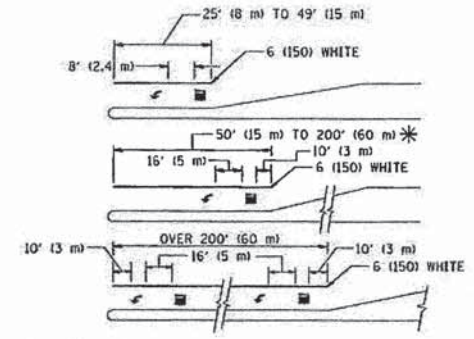

FULL SIZE LETTERS 8' (2.4 m) AND ARROWS SHALL BE USED.
 * TURN LANES IN EXCESS OF 400' (120 m) IN LENGTH MAY HAVE AN ADDITIONAL SET OF ARROW - "ONLY" INSTALLED MIDWAY BETWEEN THE OTHER TWO SETS OF ARROW - "ONLY".

TYPICAL LEFT (OR RIGHT) TURN LANE

TYPICAL TURN LANE MARKING

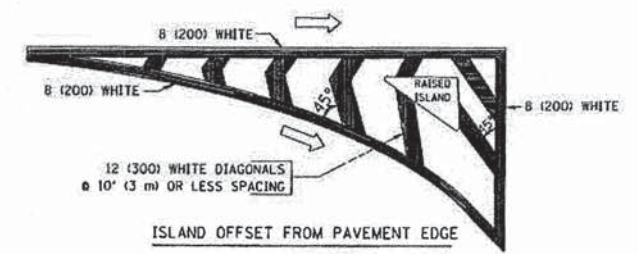

ISLAND OFFSET FROM PAVEMENT EDGE

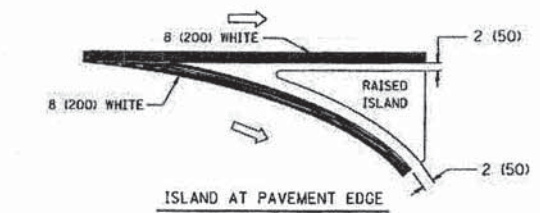

ISLAND AT PAVEMENT EDGE

TYPICAL ISLAND MARKING

TYPE OF MARKING	WIDTH OF LINE	PATTERN	COLOR	SPACING / REMARKS
CENTERLINE ON 2 LANE PAVEMENT	4 (100)	SKIP-DASH	YELLOW	10' (3 m) LINE WITH 30' (9 m) SPACE
CENTERLINE ON MULTI-LANE UNDIVIDED PAVEMENT	2 @ 4 (100)	SOLID	YELLOW	11 (280) C-C
NO PASSING ZONE LINES FOR ONE DIRECTION FOR BOTH DIRECTIONS	4 (100) 2 @ 4 (100)	SOLID SOLID	YELLOW YELLOW	5/2 (140) C-C FROM SKIP-DASH CENTERLINE 11 (280) C-C OMIT SKIP-DASH CENTERLINE BETWEEN
LANE LINES	4 (100) 5 (125) ON FREEWAYS	SKIP-DASH SKIP-DASH	WHITE WHITE	10' (3 m) LINE WITH 30' (9 m) SPACE
DOTTED LINES (EXTENSIONS OF CENTER, LANE OR TURN LANE MARKINGS)	SAME AS LINE BEING EXTENDED	SKIP-DASH	SAME AS LINE BEING EXTENDED	2' (600) LINE WITH 6' (1.8 m) SPACE
EDGE LINES	4 (100)	SOLID	YELLOW-LEFT WHITE-RIGHT	OUTLINE MOUNTABLE MEDIANS IN YELLOW; EDGE LINES ARE NOT USED NEXT TO BARRIER CURB
TURN LANE MARKINGS	6 (150) LINE; FULL SIZE LETTERS & SYMBOLS 8' (2.4m)	SOLID	WHITE	SEE TYPICAL TURN LANE MARKING DETAIL
TWO WAY LEFT TURN MARKING	2 @ 4 (100) EACH DIRECTION 8' (2.4m) LEFT ARROW	SKIP-DASH AND SOLID IN PAIRS	YELLOW WHITE	10' (3 m) LINE WITH 30' (9 m) SPACE FOR SKIP-DASH; 5/2 (140) C-C BETWEEN SOLID LINE AND SKIP-DASH LINE SEE TYPICAL TWO-WAY LEFT TURN MARKING DETAIL
CROSSWALK LINES (PEDESTRIAN) A. DIAGONALS (BIKE & EQUESTRIAN) B. LONGITUDINAL BARS (SCHOOL)	2 @ 6 (150) 12 (300) @ 45° 12 (300) @ 90°	SOLID SOLID SOLID	WHITE WHITE WHITE	NOT LESS THAN 6' (1.8 m) APART 2' (600) APART SEE TYPICAL CROSSWALK MARKING DETAILS.
STOP LINES	24 (600)	SOLID	WHITE	PLACE 4' (1.2 m) IN ADVANCE OF AND PARALLEL TO CROSSWALK, IF PRESENT. OTHERWISE, PLACE AT DESIRED STOPPING POINT, PARALLEL TO CROSSROAD CENTERLINE, WHERE POSSIBLE
PAINTED MEDIANS	2 @ 4 (100) WITH 12 (300) DIAGONALS @ 45° NO DIAGONALS USED FOR 4' (1.2 m) WIDE MEDIANS	SOLID	YELLOW; TWO WAY TRAFFIC WHITE; ONE WAY TRAFFIC	11 (280) C-C FOR THE DOUBLE LINE SEE TYPICAL PAINTED MEDIAN MARKING.
GORE MARKING AND CHANNELIZING LINES	8 (200) WITH 12 (300) DIAGONALS @ 45°	SOLID	WHITE	DIAGONALS: 15' (4.5 m) C-C (LESS THAN 30MPH (50 km/h)) 20' (6 m) C-C 30MPH (50 km/h) TO 45MPH (70 km/h) 30' (9 m) C-C (OVER 45MPH (70 km/h))
RAILROAD CROSSING	24 (600) TRANSVERSE LINES; "RR" IS 6' (1.8 m) LETTERS; 16 (400) LINE FOR "X"	SOLID	WHITE	SEE STATE STANDARD 780001 AREA OF "RR"=3.6 SQ. FT. (0.33 m ²) EACH "X"=54.0 SQ. FT. (5.0 m ²)
SHOULDER DIAGONALS	12 (300) @ 45°	SOLID	WHITE - RIGHT YELLOW - LEFT	50' (15 m) C-C (LESS THAN 30MPH (50 km/h)) 75' (25 m) C-C (30 MPH (50 km/h) TO 45MPH (70 km/h)) 150' (45 m) C-C (OVER 45MPH (70 km/h))

FOR FURTHER DETAILS ON PAVEMENT MARKING REFER TO STANDARD SPECIFICATIONS FOR ROAD AND BRIDGE CONSTRUCTION AND STATE STANDARD 780001.

All dimensions are in inches (millimeters) unless otherwise shown.

FILE NAME =	USER NAME = drivakoagn	DESIGNED - EVERS	REVISED - T. RAMMACHER 10-27-94
o:\pv_work\pvidot\drivakoagn\d0180315\to	3.dgn	DRAWN -	REVISED - C. JUCIUS 09-09-09
	PLOT SCALE = 58.000' / IN.	CHECKED -	REVISED -
	PLOT DATE = 9/9/2009	DATE - 03-19-90	REVISED -

STATE OF ILLINOIS
DEPARTMENT OF TRANSPORTATION

DISTRICT ONE		F.A. RTE.	SECTION	COUNTY	TOTAL SHEETS	SHEET NO.
TYPICAL PAVEMENT MARKINGS		530	14-00010-00-RS	DuPAGE	21	20
SCALE: NONE		SHEET NO. 1 OF 1 SHEETS		STA.	TO STA.	

TC-13		FED. ROAD DIST. NO. 1 (ILLINOIS) FED. AID PROJECT
-------	--	---

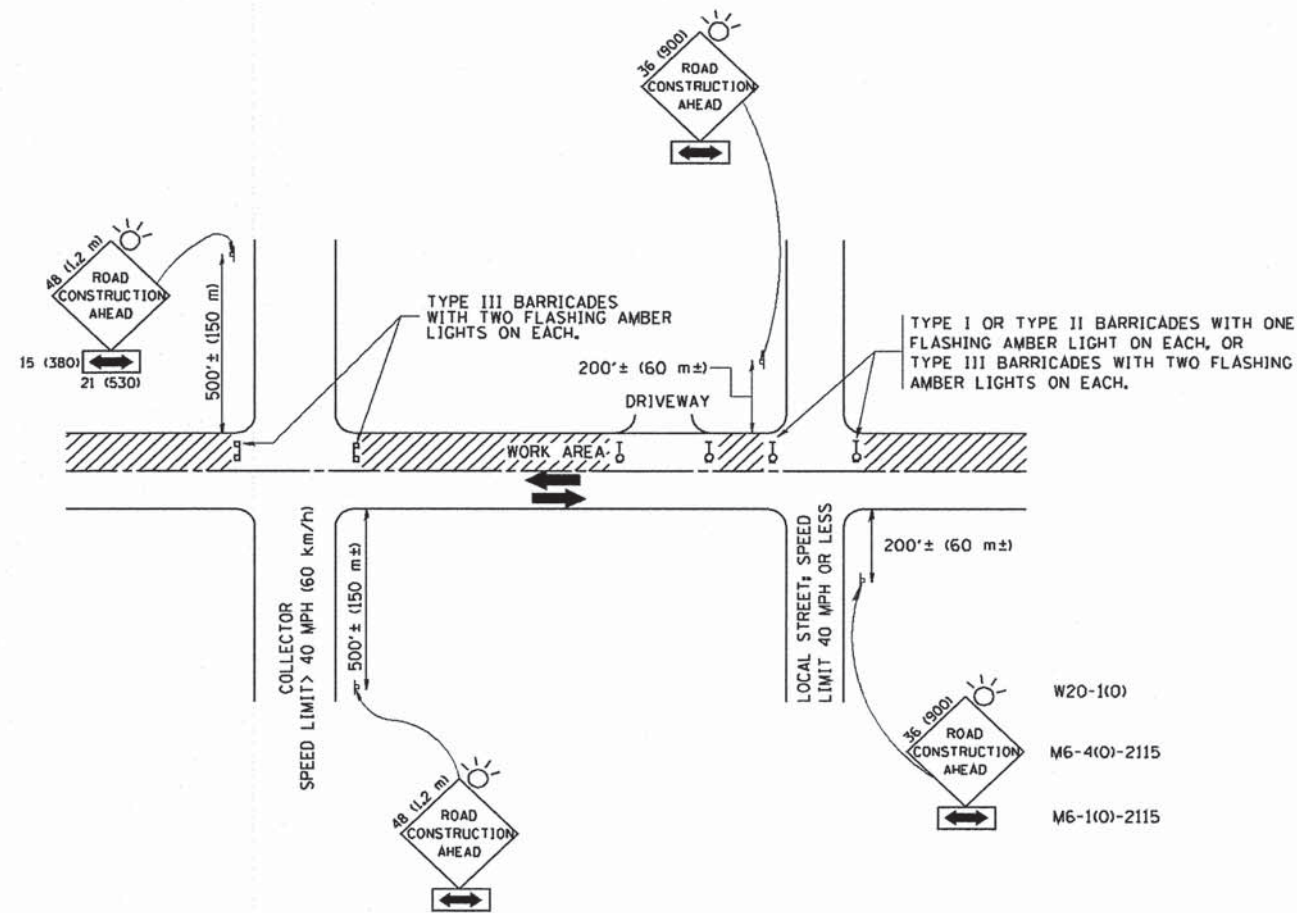

TRAFFIC CONTROL AND PROTECTION FOR SIDE ROADS, INTERSECTIONS, AND DRIVEWAYS

NOTES:

- A. FOR NO LANE RESTRICTION ON THE SIDE ROAD OR DRIVEWAYS**
- SIDE ROAD WITH A SPEED LIMIT OF 40 MPH (60 km/h) OR LESS AS SHOWN ON THE DRAWING AND AS DIRECTED BY THE ENGINEER:
 - ONE ROAD CONSTRUCTION AHEAD SIGN 36 x 36 (900x900) WITH A FLASHER AND FLAG MOUNTED ON IT APPROXIMATELY 200' (60 m) IN ADVANCE OF THE MAIN ROUTE.
 - THE CLOSED PORTION OF THE MAIN ROUTE SHALL BE PROTECTED BY BLOCKING WITH TYPE I, TYPE II OR TYPE III BARRICADES, 1/3 OF THE CROSS SECTION OF THE CLOSED PORTION.
 - SIDE ROAD WITH A SPEED LIMIT GREATER THAN 40 MPH (60 km/h) AS SHOWN ON THE DRAWING AND AS DIRECTED BY THE ENGINEER:
 - ONE ROAD CONSTRUCTION AHEAD SIGN 48 x 48 (1.2 m x 1.2 m) WITH A FLASHER MOUNTED ON IT APPROXIMATELY 500' (150 m) IN ADVANCE OF THE MAIN ROUTE.
 - THE CLOSED PORTION OF THE MAIN ROUTE SHALL BE PROTECTED BY BLOCKING WITH TYPE III BARRICADES, 1/2 OF THE CROSS SECTION OF THE CLOSED PORTION.
- B. FOR A LANE CLOSURE ON A SIDE ROAD OR DRIVEWAY:**
- USE APPLICABLE PORTIONS OF THE TYPICAL APPLICATION OF TRAFFIC CONTROL DEVICES (STD. 701501, STD. 701606 OR THE APPROPRIATE STANDARD). THE SPACING OF SIGNS AND BARRICADES SHALL BE ADJUSTED FOR FIELD CONDITIONS AS DIRECTED BY THE ENGINEER. THE DIRECTIONAL ARROW SHALL BE COVERED OR REMOVED WHEN NO LONGER CONSISTENT WITH THE SIDE ROAD LANE CLOSURE.
- C. ADVANCE WARNING SIGNS ARE TO BE OMITTED ON DRIVEWAY UNLESS OTHERWISE NOTED.**
- D. THE TRAFFIC CONTROL AND PROTECTION FOR SIDE ROADS, INTERSECTIONS, AND DRIVEWAYS SHALL BE INCIDENTAL TO THE COST OF SPECIFIED TRAFFIC CONTROL STANDARDS OR ITEMS.**

All dimensions are in millimeters (inches) unless otherwise shown.

FILE NAME = W:\diststd\22x34\tc10.dgn	USER NAME = gaglianobt	DESIGNED - LHA	REVISED - J. OBERLE 10-18-95
		DRAWN -	REVISED - A. HOUSEH 03-06-96
		CHECKED -	REVISED - A. HOUSEH 10-15-96
		DATE - 06-89	REVISED - T. RAMMACHER 01-06-00

STATE OF ILLINOIS
DEPARTMENT OF TRANSPORTATION

TRAFFIC CONTROL AND PROTECTION FOR
SIDE ROADS, INTERSECTIONS, AND DRIVEWAYS

SCALE: NONE SHEET NO. 21 OF 21 SHEETS STA. TO STA.

F.A. RTE. 530	SECTION 14-00010-00-RS	COUNTY DuPAGE	TOTAL SHEETS 21	SHEET NO. 21
TC-10				
FED. ROAD DIST. NO. 1 ILLINOIS FED. AID PROJECT				

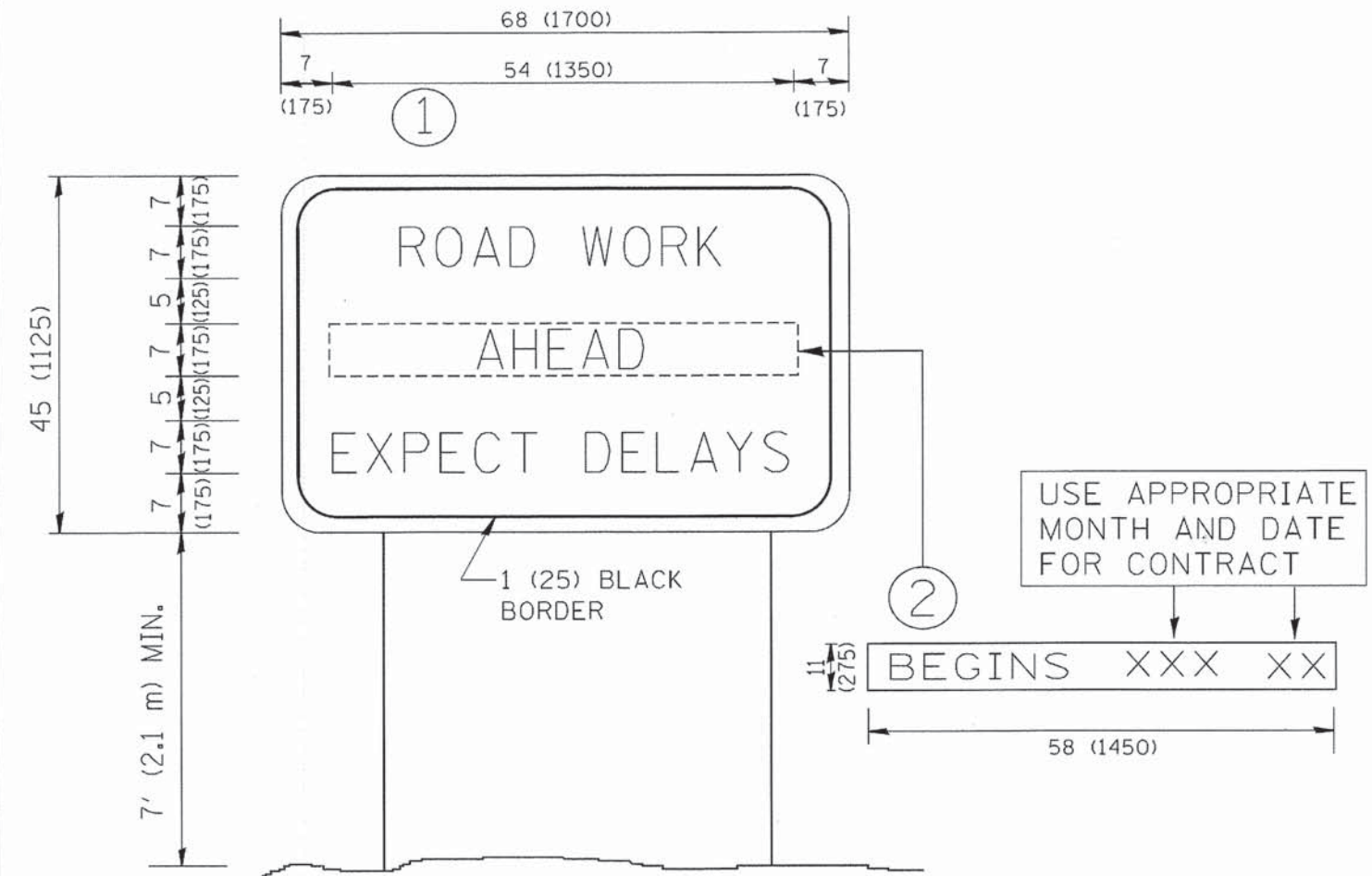

NOTES:

1. USE BLACK LETTERING ON ORANGE BACKGROUND.
2. ERECT SIGNS IN ADVANCE OF THE LOCATION FOR THE "ROAD CONSTRUCTION AHEAD" SIGN AT LOCATIONS AS DIRECTED BY THE ENGINEER.
3. ERECT SIGN ① WITH INSTALLED PANEL ② ONE WEEK PRIOR TO THE START OF CONSTRUCTION.
4. REMOVE PANEL ② SOON AFTER THE START OF CONSTRUCTION.
5. SEE SPECIAL PROVISION FOR "TEMPORARY INFORMATION SIGNING" FOR ADDITIONAL INFORMATION.
6. ONE SIGN ASSEMBLY EQUALS 25.70 SQ. FT. (2.3 SQ. M.)
7. SHALL BE PAID FOR AS TEMPORARY INFORMATION SIGNING.

ALL DIMENSIONS ARE IN INCHES (MILLIMETERS) UNLESS OTHERWISE SHOWN.

FILE NAME *	USER NAME * gaglanobt	DESIGNED -	REVISED - R. MIRS 09-15-97
W:\diststd\22x34\tc22.dgn		DRAWN -	REVISED - R. MIRS 12-11-97
	PLOT SCALE = 50.000 1/ IN.	CHECKED -	REVISED - T. RAMMACHER 02-02-99
	PLOT DATE = 1/4/2008	DATE -	REVISED - C. JUCIUS 01-31-07

STATE OF ILLINOIS
DEPARTMENT OF TRANSPORTATION

ARTERIAL ROAD
INFORMATION SIGN

SCALE: NONE SHEET NO. 1 OF 1 SHEETS STA. TO STA.

F.A. RTE.	SECTION	COUNTY	TOTAL SHEETS	SHEET NO.
2745	14-00085-00-RS	LAKE	21	21A
TC-22		CONTRACT NO. 61B20		
FED. ROAD DIST. NO. 1 ILLINOIS FED. AID PROJECT				