

STATE OF ILLINOIS
DEPARTMENT OF TRANSPORTATION
DIVISION OF HIGHWAYS

F.A.U. RTE.	SECTION	COUNTY	TOTAL SHEETS	SHEET NO.
3887	2014-0B21	KANE	18	1
		ILLINOIS	CONTRACT NO. 62A30	

D-91-128-15

FOR INDEX OF SHEETS, SEE SHEET NO. 2

PROJECT LOCATED IN UNINCORPORATED KANE COUNTY
JUST SOUTH OF THE VILLAGE OF ALGONQUIN

**PROPOSED
HIGHWAY PLANS**

FAU ROUTE 3887 IL 31 (MAIN STREET) OVER ANIMAL CROSSING
SECTION 2014-0821
CULVERT REMOVAL
KANE COUNTY
C-91-128-15



TRAFFIC DATA
POSTED SPEED: 50 MPH
DESIGN SPEED: 55 MPH
FUNCTIONAL CLASSIFICATION:
MINOR ARTERIAL
ADT = 13,900 (2013)

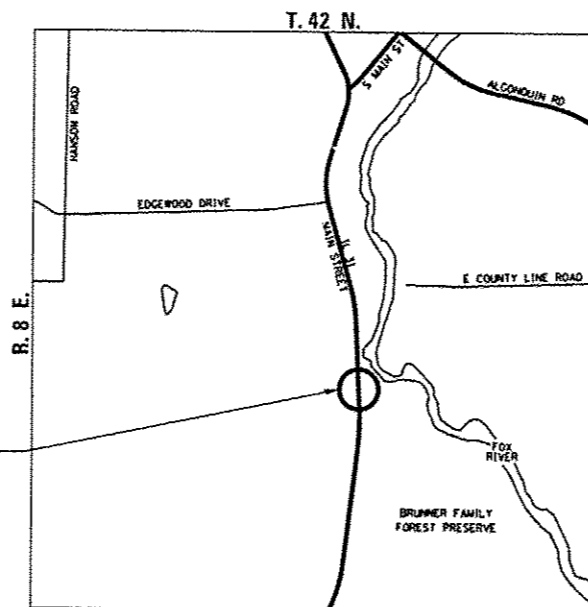

PROJECT LOCATION
STRUCTURE NO. 045-0504

LOCATION MAP
NOT TO SCALE

GROSS LENGTH = 42 FT. = 0.008 MILE
NET LENGTH = 42 FT. = 0.008 MILE

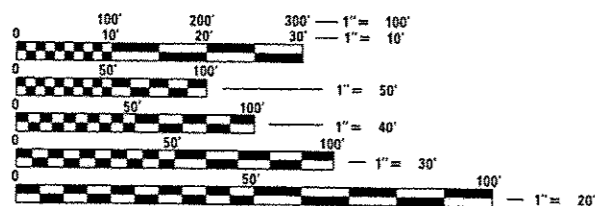

FULL SIZE PLANS HAVE BEEN PREPARED USING STANDARD
ENGINEERING SCALES. REDUCED SIZED PLANS WILL NOT
CONFORM TO STANDARD SCALES. IN MAKING MEASUREMENTS
ON REDUCED PLANS, THE ABOVE SCALES MAY BE USED.

J.U.L.I.E.
JOINT UTILITY LOCATION INFORMATION FOR EXCAVATION
1-800-892-0123
OR 811

PROJECT MANAGER: ISSAM RAYYAN, P.E. (847) 705-4178
PROJECT ENGINEER: ROBERT T. BORO, P.E. (847) 705-4237
CONTRACT NO. 62A30

JAMIL BOU-SAAB
062-047537
REGISTERED
PROFESSIONAL
ENGINEER
ILLINOIS

JAMIL BOU-SAAB
LICENSED PROFESSIONAL ENGINEER
ILLINOIS NO. 062-047537 EXPIRES 11-30-15

STATE OF ILLINOIS
DEPARTMENT OF TRANSPORTATION
DIVISION OF HIGHWAYS

SUBMITTED February 20 20 15
Deputy Director of Highways, Region Engineer
May 20 20 15
Engineer of Design and Environment
May 20 20 15
Director of Highways, Chief Engineer

TERRA
ENGINEERING LTD.

PRINTED BY THE AUTHORITY
OF THE STATE OF ILLINOIS

INDEX OF SHEETS

SHEET NO.	DESCRIPTION
1	COVER SHEET
2	INDEX OF SHEETS, STATE STANDARDS AND GENERAL NOTES
3 - 4	SUMMARY OF QUANTITIES
5	TYPICAL SECTIONS
6	SCHEDULE OF QUANTITIES
7	ALIGNMENT, TIES AND BENCHMARKS
8	PLAN AND PROFILE & PAVEMENT MARKINGS
9	TRAFFIC CONTROL DETOUR PLAN
10	EROSION AND SEDIMENT CONTROL PLAN
11	DRAINAGE AND UTILITY PLAN
12	BENCHING DETAIL FOR EMBANKMENT WIDENING (BD-51)
13	TRAFFIC CONTROL AND PROTECTION FOR SIDE ROAD, INTERSECTION AND DRIVEWAYS (TC-10)
14	TYPICAL APPLICATIONS: RAISED REFLECTIVE PAVEMENT MARKERS (SNOW-LOW RESISTANT) (TC-11)
15	DISTRICT ONE TYPICAL PAVEMENT MARKINGS (TC-13)
16	DETOUR SIGNING FOR CLOSING STATE HIGHWAYS (TC-21)
17 - 18	CROSS SECTIONS

GENERAL NOTES

- BEFORE STARTING ANY EXCAVATION, THE CONTRACTOR SHALL CALL "JULIE" AT (800) 892-0123 FOR FIELD LOCATIONS OF BURIED ELECTRIC, TELEPHONE AND GAS FACILITIES. 48-HOUR NOTIFICATION IS REQUIRED.
- THE CONTRACTOR WILL NOT BE ALLOWED TO SET UP A YARD OR FIELD OFFICE ON STATE PROPERTY WITHOUT WRITTEN PERMISSION FROM THE DEPARTMENT.
- ALL DAMAGE TO EXISTING PAVEMENT MARKINGS OR RAISED REFLECTIVE PAVEMENT MARKERS OUTSIDE THE REMOVAL LINE SHOWN ON THE PLANS SHALL BE REPLACED AT THE CONTRACTOR'S EXPENSE.
- BEFORE STARTING ANY WORK, THE CONTRACTOR SHALL OBTAIN AND RECORD FOR FUTURE REFERENCE, ALL EXISTING PAVEMENT MARKING LINES AND RAISED REFLECTIVE MARKERS IN ORDER THAT THESE LOCATIONS CAN BE RE-ESTABLISHED FOR STRIPING. EXACT LOCATIONS OF ALL PAVEMENT MARKINGS SHALL BE AS DIRECTED BY THE ENGINEER.
- IT SHALL BE THE CONTRACTOR'S RESPONSIBILITY TO VERIFY ALL DIMENSIONS AND CONDITIONS IN THE FIELD PRIOR TO CONSTRUCTION AND ORDERING OF MATERIALS.
- DO NOT SCALE PLANS FOR CONSTRUCTION DIMENSIONS.
- PLAN DIMENSIONS AND DETAILS RELATIVE TO THE EXISTING STRUCTURE HAVE BEEN TAKEN FROM EXISTING PLANS AND ARE SUBJECT TO NOMINAL CONSTRUCTION VARIATIONS. IT SHALL BE THE CONTRACTOR'S RESPONSIBILITY TO VERIFY SUCH DIMENSIONS AND DETAILS IN THE FIELD AND MAKE NECESSARY APPROVED ADJUSTMENTS PRIOR TO CONSTRUCTION AND ORDERING OF MATERIALS. SUCH VARIATIONS SHALL NOT BE CAUSE FOR ADDITIONAL COMPENSATION FOR A CHANGE IN SCOPE OF WORK, HOWEVER, THE CONTRACTOR WILL BE PAID FOR THE QUANTITY ACTUALLY FURNISHED AT THE UNIT PRICE BID FOR THE WORK.
- THE CONTRACTOR SHALL CONTACT THE DISTRICT ONE TRAFFIC CONTROL SUPERVISOR AT (847) 705-4470 A MINIMUM OF 72 HOURS IN ADVANCE OF BEGINNING OF WORK.
- THE RESIDENT ENGINEER SHALL CONTACT WALTER CZARNY, THE AREA TRAFFIC FIELD ENGINEER, AT (847) 438-2300 A MINIMUM OF TWO (2) WEEKS PRIOR TO PLACEMENT OF PERMANENT PAVEMENT MARKINGS.
- THE CONTRACTOR SHALL DIVERT THE WATER FROM THE WORK AREAS BY A METHOD APPROVED BY THE ENGINEER.
- ALL PAVEMENT PATCHING LOCATIONS WILL BE DETERMINED IN THE FIELD BY THE ENGINEER.
- DURING CONSTRUCTION OPERATIONS, LOOSE MATERIAL DEPOSITS THAT OBSTRUCT THE FLOW OF WATER IN DRAINING THE AREA SHALL BE REMOVED BEFORE THE END OF EACH WORK DAY. AT THE CONCLUSION OF THE CONSTRUCTION OPERATIONS, ALL DRAINAGE STRUCTURES (NEW AND EXISTING) SHALL BE FREE FROM ALL DIRT AND DEBRIS. THIS WORK WILL NOT BE PAID FOR SEPARATELY, BUT SHALL BE CONSIDERED INCIDENTAL TO THE CONTRACT.
- ALL EXCAVATED SOILS FROM THE PROJECT SITE SHALL BE RE-USED AS FILL OR TOPSOIL AT THE PROJECT SITE. NO EXCAVATED SOILS FROM THE PROJECT SITE MAY BE DISPOSED OF AT ANY OFFSITE LOCATION.
- PERIMETER EROSION BARRIER SHALL BE INSTALLED AROUND EXCAVATION STOCKPILES. THIS WORK WILL NOT BE PAID FOR SEPARATELY, BUT SHALL BE CONSIDERED INCIDENTAL TO THE CONTRACT.
- WINGWALL REMOVAL IS INCLUDED IN THE QUANTITY FOR AND PAID FOR AS 'REMOVAL OF EXISTING STRUCTURES'.
- AGGREGATE SHOULDER REMOVAL IS INCLUDED IN THE QUANTITY FOR AND PAID FOR AS 'EARTH EXCAVATION'.

STATE STANDARDS

000001-06	STANDARD SYMBOLS, ABBREVIATIONS AND PATTERNS
280001-07	TEMPORARY EROSION CONTROL SYSTEMS
442201-03	CLASS C AND D PATCHES
630001-10	STEEL PLATE BEAM GUARDRAIL
701001-02	OFF-RD OPERATIONS, 2L, 2W, MORE THAN 15' AWAY
701006-05	OFF-RD OPERATIONS, 2L, 2W, 15' TO 24" FROM PAVEMENT EDGE
701011-04	OFF-RD MOVING OPERATIONS, 2L, 2W, DAY ONLY
701201-04	LANE CLOSURE, 2L, 2W, DAY ONLY, FOR SPEEDS >= 45 MPH
701301-04	LANE CLOSURE, 2L, 2W, SHORT TIME OPERATIONS
701306-03	LANE CLOSURE, 2L, 2W, SLOW MOVING OPERATIONS DAY ONLY, FOR SPEEDS >= 45 MPH
701311-03	LANE CLOSURE, 2L, 2W, MOVING OPERATIONS - DAY ONLY
701901-04	TRAFFIC CONTROL DEVICES
780001-05	TYPICAL PAVEMENT MARKINGS
781001-03	TYPICAL APPLICATIONS RAISED REFLECTIVE PAVEMENT MARKERS

I:\14_Culvert_Removal\14-0205\Design\Civil\CADD_Sheets\01\IL31\0114-At-Index.dwg
 Default



USER NAME = Kylic	DESIGNED - KJC	REVISED -
PLOT SCALE = NTS	DRAWN - KJC	REVISED -
PLOT DATE = 2/17/2015	CHECKED - LVA	REVISED -
	DATE - 02/17/15	REVISED -

STATE OF ILLINOIS
DEPARTMENT OF TRANSPORTATION

IL 31 OVER ANIMAL CROSSING CULVERT REMOVAL
INDEX OF SHEETS, STATE STANDARDS AND GENERAL NOTES

F.A.U. R.T.E.	SECTION	COUNTY	TOTAL SHEETS	SHEET NO.
3887	2014-0821	KANE	18	2
CONTRACT NO. 62A30				
ILLINOIS FED. AID PROJECT				

SCALE: NTS SHEET 1 OF 1 SHEETS STA. TO STA.

URBAN

100% STATE

SP	SI	CODE NO.	ITEM	UNIT	TOTAL QUANTITY	ROADWAY 0040 SN 045-0504
		20100110	TREE REMOVAL (6 TO 15 UNITS DIAMETER)	UNIT	36	36
		20100210	TREE REMOVAL (OVER 15 UNITS DIAMETER)	UNIT	35	35
		20400800	FURNISHED EXCAVATION	CU YD	50	50
		21101505	TOPSOIL EXCAVATION AND PLACEMENT	CU YD	70	70
		20200100	EARTH EXCAVATION	CU YD	528	528
		20201200	REMOVAL AND DISPOSAL OF UNSUITABLE MATERIAL	CU YD	53	53
		21101625	TOPSOIL FURNISH AND PLACE, 6"	SO YD	419	419
		25100635	HEAVY DUTY EROSION CONTROL BLANKET	SO YD	419	419
		28000250	TEMPORARY EROSION CONTROL SEEDING	POUND	3	3
		28000400	PERIMETER EROSION BARRIER	FOOT	316	316
		40600275	BITUMINOUS MATERIALS (PRIME COAT)	POUND	89	89
		44004250	PAVED SHOULDER REMOVAL	SO YD	24	24
		44201833	CLASS D PATCHES, TYPE IV, 15 INCH	SO YD	100	100
		48101500	AGGREGATE SHOULDERS, TYPE B 6"	SO YD	16	16

14 X SPECIALTY ITEM
 • SPECIAL PROVISION ITEM

I:\IL 31 and US 14 Culvert Removals\02-154-025\Design\Civil\0400 Sheets\01\IL31US14-ht-505.31.dgn
 5001



USER NAME = KJcC	DESIGNED - KJC	REVISED -
PLOT SCALE = NTS	DRAWN - KJC	REVISED -
PLOT DATE = 2/17/2015	CHECKED - LVA	REVISED -
	DATE - 02/17/15	REVISED -

**STATE OF ILLINOIS
DEPARTMENT OF TRANSPORTATION**

**IL 31 OVER ANIMAL CROSSING CULVERT REMOVAL
SUMMARY OF QUANTITIES**

SCALE: NTS SHEET 1 OF 2 SHEETS STA. TO STA.

F.A.U. RTE. 3887	SECTION 2014-0821	COUNTY KANE	TOTAL SHEETS 18	SHEET NO. 3
CONTRACT NO. 62A30			ILLINOIS FED. AID PROJECT	

URBAN

100% STATE

ROADWAY

0040

SN 045-0504

SP	SI	CODE NO.	ITEM	UNIT	TOTAL QUANTITY	
		48203033	HOT-MIX ASPHALT SHOULDERS, 9"	SO YD	24	24
		50100100	REMOVAL OF EXISTING STRUCTURES	EACH	1	1
X		63000009	STEEL PLATE BEAM GUARDRAIL, TYPE B, 9 FOOT POSTS	FOOT	75	75
		63200310	GUARDRAIL REMOVAL	FOOT	75	75
		67100100	MOBILIZATION	L SUM	1	1
		70106800	CHANGEABLE MESSAGE SIGN	CAL MO	2	2
X		78000200	THERMOPLASTIC PAVEMENT MARKING - LINE 4"	FOOT	120	120
X		78100100	RAISED REFLECTIVE PAVEMENT MARKER	EACH	2	2
		85000200	MAINTENANCE OF EXISTING TRAFFIC SIGNAL INSTALLATION	EACH	1	1
		K1004595	PRUNING FOR SAFETY AND EQUIPMENT CLEARANCE	L SUM	1	1
		X2501700	SEEDING, CLASS 3 (MODIFIED)	ACRE	0.03	0.03
		X7010216	TRAFFIC CONTROL AND PROTECTION, (SPECIAL)	L SUM	1	1
		Z0013798	CONSTRUCTION LAYOUT	L SUM	1	1
		Z0073510	TEMPORARY TRAFFIC SIGNAL TIMING	EACH	15	15

X SPECIALTY ITEM
 • SPECIAL PROVISION ITEM

I:\IL 31 and US 14 Culvert Removals 02-154-0050\Drawings\Civil\0400 Sheets\0411 310514-INT-000 31.dgn
 000 2



USER NAME = KyleC	DESIGNED - KJC	REVISED -
PLOT SCALE = NTS	DRAWN - KJC	REVISED -
PLOT DATE = 2/17/2015	CHECKED - LVA	REVISED -
	DATE - 02/17/15	REVISED -

STATE OF ILLINOIS
 DEPARTMENT OF TRANSPORTATION

IL 31 OVER ANIMAL CROSSING CULVERT REMOVAL
 SUMMARY OF QUANTITIES

SCALE: NTS SHEET 2 OF 2 SHEETS STA. TO STA.

F.A.U. RTE. 3887	SECTION 2014-0021	COUNTY KANE	TOTAL SHEETS 18	SHEET NO. 4
CONTRACT NO. 62A30				ILLINOIS FED. AID PROJECT

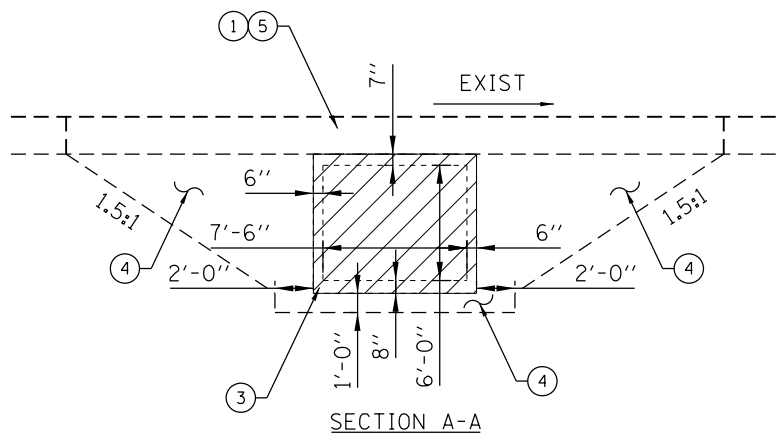
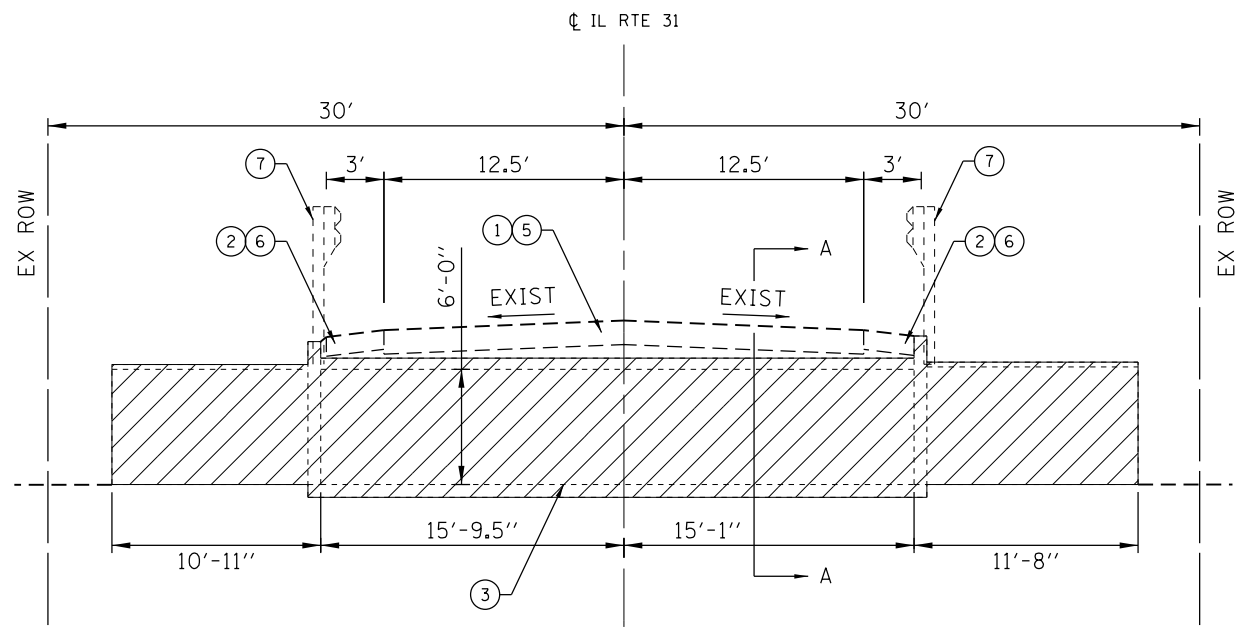

IL ROUTE 31 OVER ANIMAL CROSSING
(1.4 MILES SOUTH OF IL ROUTE 62)
EXISTING REINFORCED BOX CULVERT

- EXISTING/REMOVAL LEGEND**
- ① EXISTING PAVEMENT
 - ② EXISTING BITUMINOUS SHOULDER
 - ③ EXISTING 7.5' X 6' BOX CULVERT
 - ④ EARTH EXCAVATION
 - ⑤ CLASS D PATCHES, TYPE IV, 15"
 - ⑥ PAVED SHOULDER REMOVAL
 - ⑦ GUARDRAIL REMOVAL

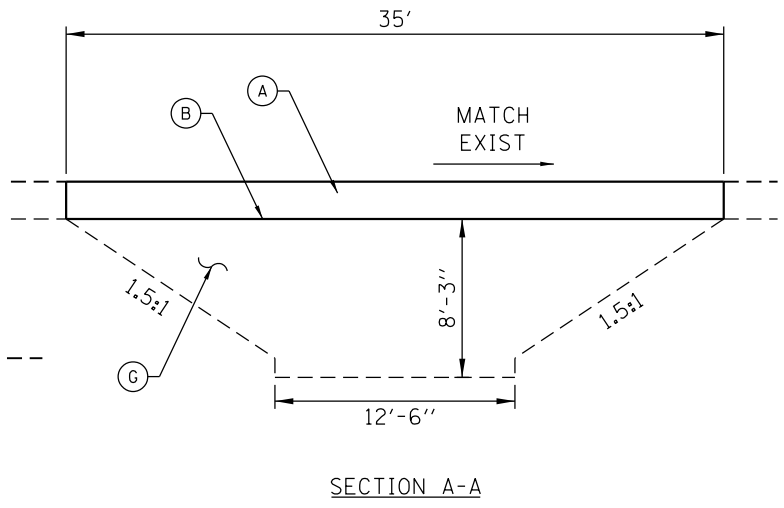
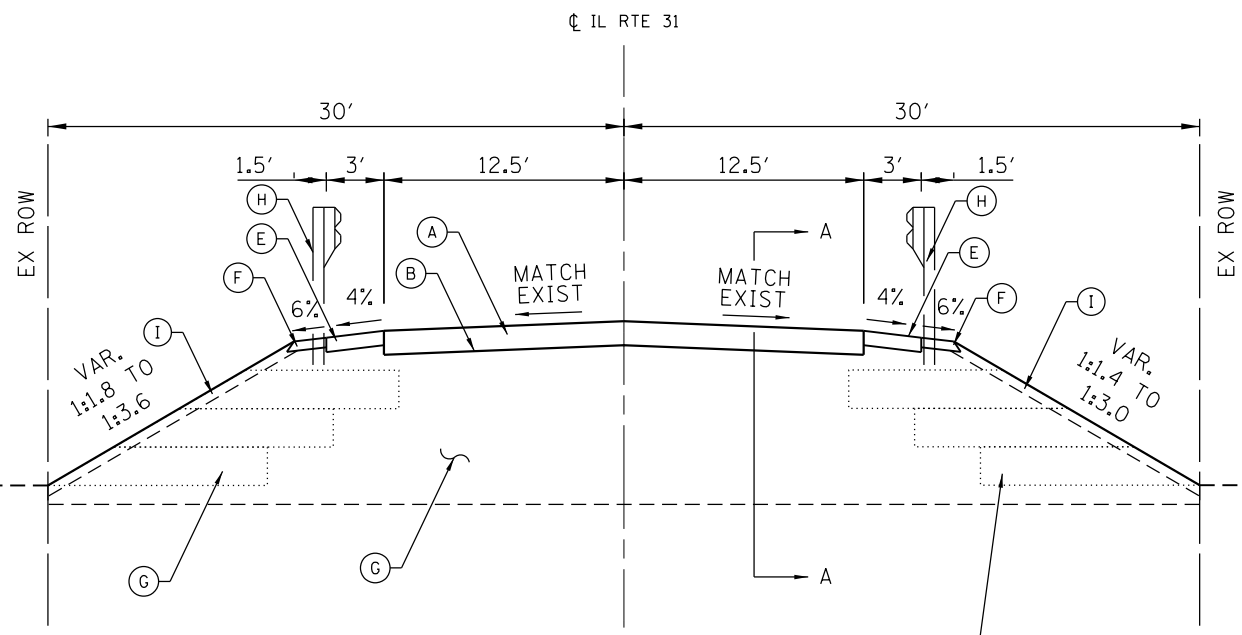
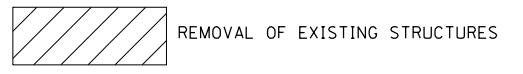

SEE BENCHING DETAIL (D1 STANDARD BD-51) FOR SLOPES STEEPER THAN 4:1 AND GREATER THAN 5' (TYP.)

IL ROUTE 31 OVER ANIMAL CROSSING
(1.4 MILES SOUTH OF IL ROUTE 62)
PROPOSED SECTION

- PROPOSED LEGEND**
- Ⓐ CLASS D PATCHES, TYPE IV, 15"
 - Ⓑ BITUMINOUS MATERIALS (PRIME COAT)
 - Ⓒ HOT-MIX ASPHALT SHOULDERS, 9"
 - Ⓓ AGGREGATE SHOULDERS, TYPE B 6"
 - Ⓔ EARTH EXCAVATION / FURNISHED EXCAVATION
 - Ⓕ STEEL PLATE BEAM GUARDRAIL, TYPE B, 9 FT POSTS
 - Ⓖ TOPSOIL EXCAVATION AND PLACEMENT / TOPSOIL FURNISH AND PLACE, 6"

HOT-MIX ASPHALT REQUIREMENTS

APPLICATION	MIXTURE TYPE	AC TYPE	AIR VOIDS @ NDES	RAP %
CLASS D PATCHES, TYPE IV, 15 INCH	2" HMA SURFACE COURSE, MIX D, N70	PG 64-22	4% @ 70 GYR	15
	13" HMA BINDER IL-19 MM	PG 58-22	4% @ 70 GYR	25
HOT-MIX ASPHALT SHOULDERS, 9 INCH	2" HMA SURFACE COURSE, MIX D, N70	PG 64-22	4% @ 70 GYR	15
	7" HMA BINDER IL-19 MM	PG 58-22	4% @ 70 GYR	25

NOTES:

1. THE UNIT WEIGHT USED TO CALCULATE ALL HMA MIXTURE QUANTITIES IS 112 LBS/SOYD/IN.
2. FOR NON-POLYMERIZED HMA THE "AC TYPE" SHALL BE "PG 64 -22" UNLESS MODIFIED BY DISTRICT ONE SPECIAL PROVISIONS.
3. FOR USE OF RECYCLED MATERIALS SEE DISTRICT ONE SPECIAL PROVISIONS.
4. QUALITY MANAGEMENT PROGRAM (QMP) IDENTIFIES THE PARTICULAR QUALITY CONTROL SPECIFICATION THAT APPLIES TO THE HMA MIXTURE.

M:\IL_31 and US 14 Culvert Removals (12-154-005)\Design\Civil\CADD Sheets\DL31US14-shr-typical.31.dgn



USER NAME = KJieC	DESIGNED - KJC	REVISED -
PLOT SCALE = NTS	DRAWN - KJC	REVISED -
PLOT DATE = 2/17/2015	CHECKED - LVA	REVISED -
	DATE - 02/17/15	REVISED -

**STATE OF ILLINOIS
DEPARTMENT OF TRANSPORTATION**

IL 31 OVER ANIMAL CROSSING CULVERT REMOVAL	
TYPICAL SECTIONS	
SCALE: NTS	SHEET 1 OF 1 SHEETS STA. TO STA.

F.A.U. RTE.	SECTION	COUNTY	TOTAL SHEETS	SHEET NO.
3887	2014-0821	KANE	18	5
CONTRACT NO. 62A30				
ILLINOIS FED. AID PROJECT				

ILLINOIS ROUTE 31 EARTHWORK SCHEDULE

A	B	C	D	E	F	G
FROM STA	TO STA	EARTH EXCAVATION (CU YD)	UNSUITABLE MATERIAL (CU YD)	15% ADJUSTMENT FOR SHRINKAGE (CU YD)	FILL EMBANKMENT (CU YD)	EARTHWORK BALANCE WASTE(+) SHORTAGE(-) (CU YD)
2002+00.00	2002+32.19	80.36	8.04	61.47	87.69	-26.22
2002+32.19	2002+43.64	169.33	16.93	129.54	113.14	16.40
2002+43.64	2002+45.67	37.95	3.79	29.03	28.97	0.06
2002+45.67	2002+50.00	27.80	2.78	21.27	60.09	-38.82
2002+50.00	2002+54.33	30.39	3.04	23.25	60.10	-36.85
2002+54.33	2002+56.36	39.31	3.93	30.08	27.95	2.13
2002+56.36	2002+67.81	142.00	14.20	108.63	76.18	32.45
2002+67.81	2003+00.00	1.13	0.11	0.87		0.87
TOTAL		528	53	404	454	-50

LEGEND

COLUMNS A AND B: LOCATION ON PLANS

COLUMN C: CUT QUANTITIES FROM CROSS SECTIONS

COLUMN D: = C X 0.1
 CUT MATERIAL THAT IS DETERMINED TO BE EITHER UNSTABLE OR UNSUITABLE FOR USE IN EMBANKMENT.
 ASSUME 10% OF EARTH EXCAVATION.

COLUMN E: = (C - D) X 0.85
 EARTH EXCAVATION THAT IS TO BE USED AS FILL MATERIAL IN THE EMBANKMENT.
 A SHRINKAGE FACTOR OF 15% IS USED.

COLUMN F: FILL QUANTITIES FROM CROSS SECTIONS

COLUMN G: = E - F
 POSITIVE QUANTITY = EXTRA EXCAVATION.
 NEGATIVE QUANTITY = FURNISHED EXCAVATION NEEDED.

M:\IL_31 and US 14 Culvert Removals (12-154-005)\Design\Civil\CADD Sheets\ILL31US14-sht-schedule_31.dgn



USER NAME = KjeC	DESIGNED - KJC	REVISED -
	DRAWN - KJC	REVISED -
PLOT SCALE = NTS	CHECKED - LVA	REVISED -
PLOT DATE = 2/17/2015	DATE - 02/17/15	REVISED -

**STATE OF ILLINOIS
DEPARTMENT OF TRANSPORTATION**

**IL 31 OVER ANIMAL CROSSING CULVERT REMOVAL
SCHEDULE OF QUANTITIES**

SCALE: NTS SHEET 1 OF 1 SHEETS STA. TO STA.

F.A.U. RTE.	SECTION	COUNTY	TOTAL SHEETS	SHEET NO.
3887	2014-0821	KANE	18	6
CONTRACT NO. 62A30			ILLINOIS FED. AID PROJECT	

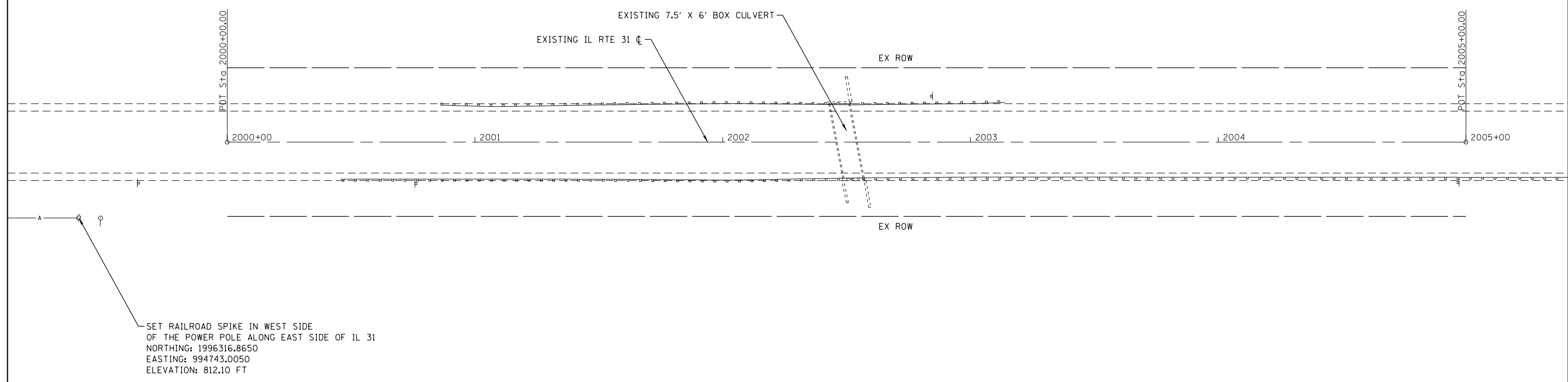
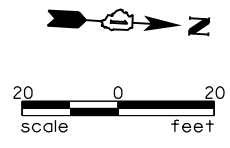

IL RTE 31 ALIGNMENT DATA

DESCRIPTION	NORTHING	EASTING	STATION
POINT OF TANGENT	1996375.0241	994709.2090	2000+00.00
POINT OF TANGENT	1996874.2911	994682.1460	2005+00.00

M:\IL_31 and US 14 Culvert Removals (12-154-005)\Design\Civil\CADD Sheets\01\31US14-shr-align_31.dgn



USER NAME = KyieC	DESIGNED - KJC	REVISED -
PLOT SCALE = 1"=20'	DRAWN - KJC	REVISED -
PLOT DATE = 2/17/2015	CHECKED - LVA	REVISED -
	DATE - 02/17/15	REVISED -

**STATE OF ILLINOIS
DEPARTMENT OF TRANSPORTATION**

**IL 31 OVER ANIMAL CROSSING CULVERT REMOVAL
ALIGNMENT, TIES AND BENCHMARKS**

SCALE: 1"=20' SHEET 1 OF 1 SHEETS STA. TO STA.

F.A.U. RTE. 3887	SECTION 2014-0821	COUNTY KANE	TOTAL SHEETS 18	SHEET NO. 7
ILLINOIS FED. AID PROJECT			CONTRACT NO. 62A30	

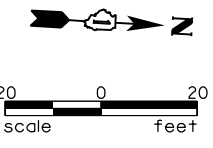

PLAN	SURVEYED	DATE
	PLOTTED	
	NOTE BOOK	
	NO.	
	CHECKED	
	FILE NAME	

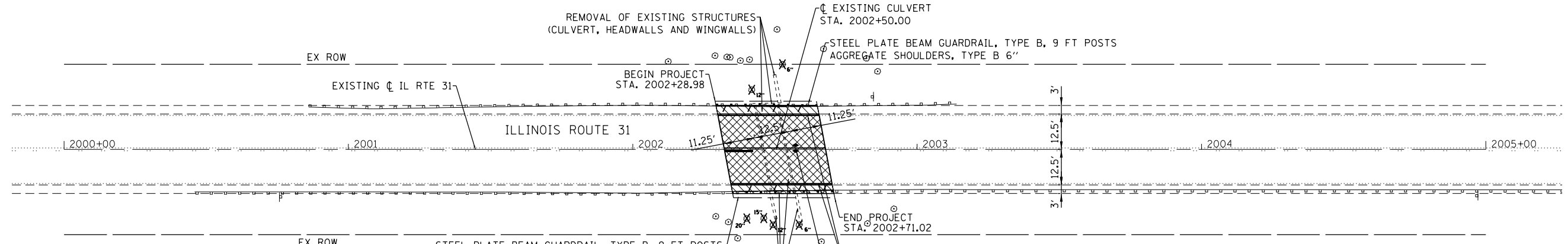

LEGEND

- EARTH EXCAVATION / FURNISHED EXCAVATION
CLASS D PATCHES, TYPE IV, 15 INCH
BITUMINOUS MATERIALS (PRIME COAT)
- PAVED SHOULDER REMOVAL
EARTH EXCAVATION / FURNISHED EXCAVATION
HOT-MIX ASPHALT SHOULDERS, 9"
- TREE REMOVAL (WITH SIZE)
- GUARDRAIL REMOVAL

PROFILE	SURVEYED	DATE
	PLOTTED	
	GRADES CHECKED	
	NOTE BOOK	
	NO.	
	CHECKED	
	FILE NAME	

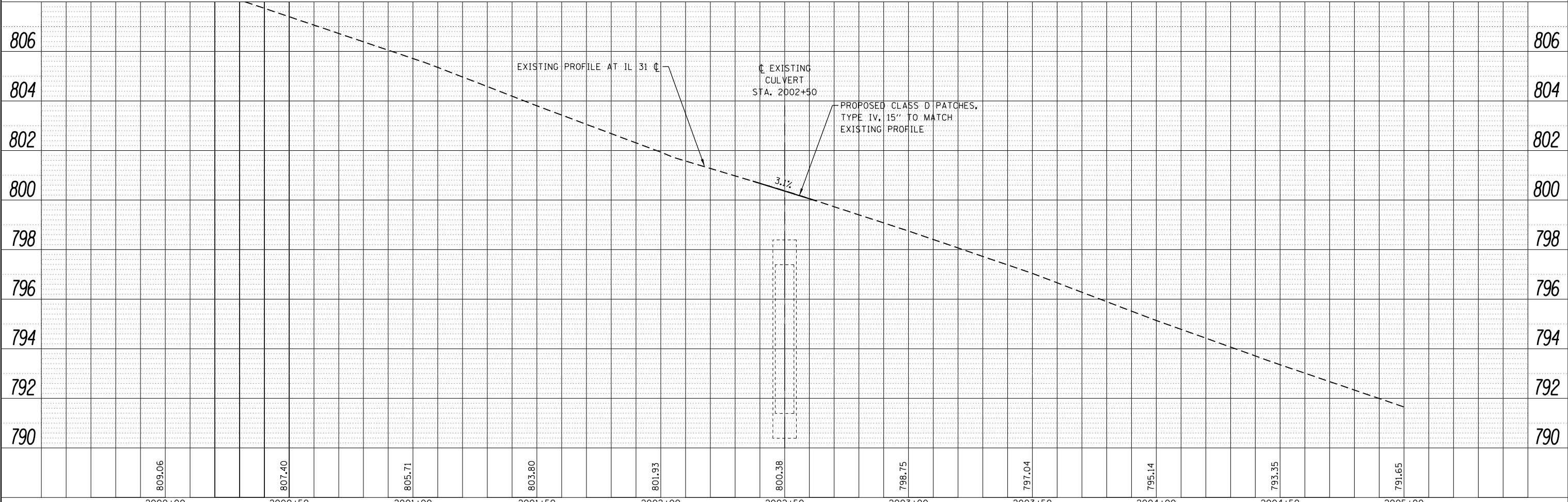

M:\IL_31 and US 14 Culvert Removals (12-154-0028)\Design\Civil\CADD Sheets\Profile\31\31.DWG
 Default

	USER NAME = Kjeic PLOT SCALE = 1"=20' PLOT DATE = 2/17/2015	DESIGNED - KJC DRAWN - KJC CHECKED - LVA DATE - 02/17/15	REVISED - REVISED - REVISED - REVISED -	STATE OF ILLINOIS DEPARTMENT OF TRANSPORTATION	IL 31 OVER ANIMAL CROSSING CULVERT REMOVAL PLAN AND PROFILE & PAVEMENT MARKINGS	F.A.U. RTE. 3887 SECTION 2014-0821 COUNTY KANE CONTRACT NO. 62A30	TOTAL SHEETS 18 SHEET NO. 8 ILLINOIS FED. AID PROJECT
--	---	---	--	---	--	--	---

SCALE: 1"=20' SHEET 1 OF 1 SHEETS STA. TO STA.

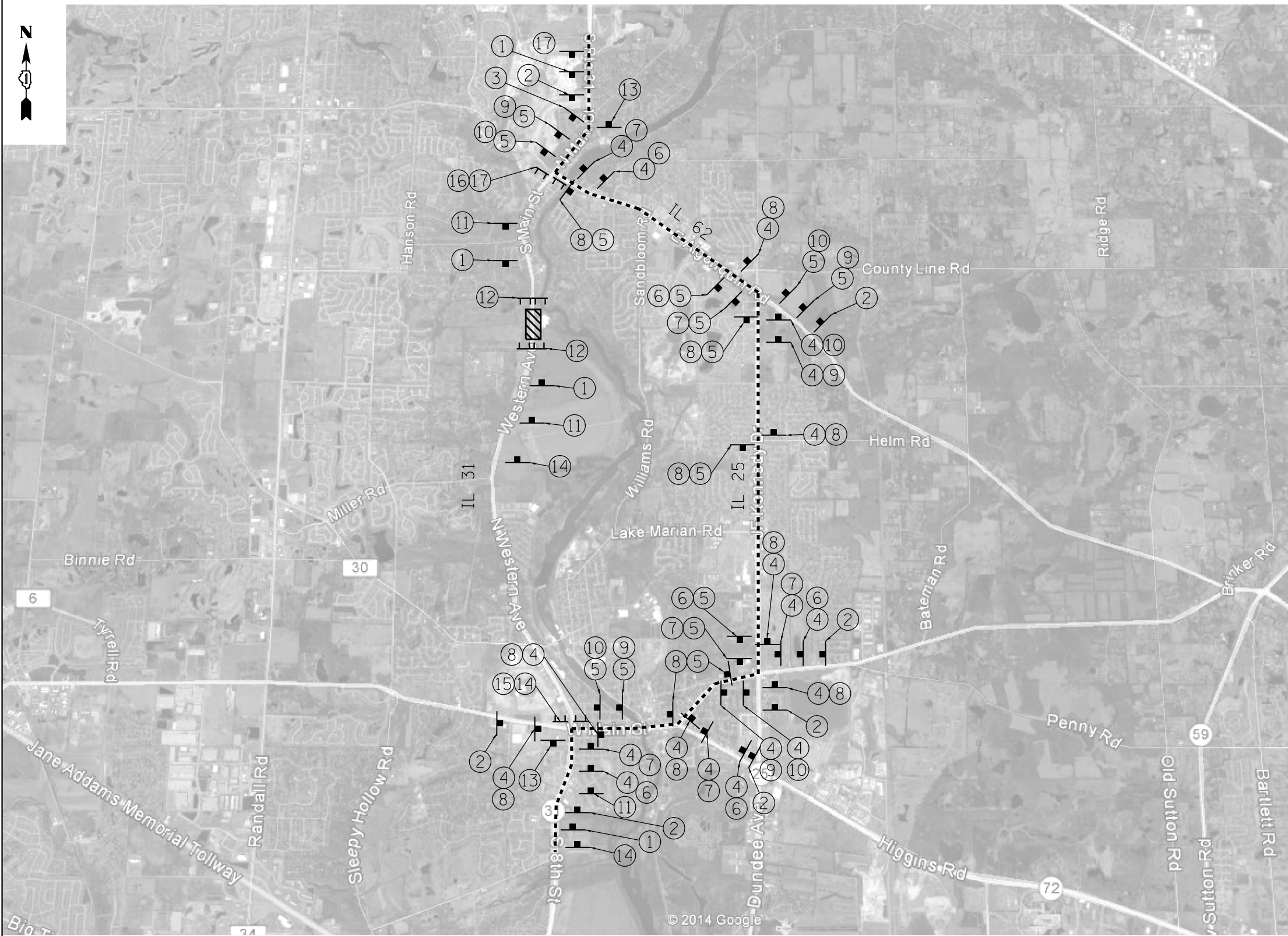

①	 ROAD CLOSED AHEAD W20-3-4848	②	 DETOUR AHEAD W20-2-4848	③	 ROAD CLOSED 500 FT W20-3-4848
④	 DETOUR NORTH ILL 31 M4-8-2412 M3-4-2412 M1-50-2424	⑤	 DETOUR SOUTH ILL 31 M4-8-2412 M3-2-2412 M1-50-2424		
⑥	 M5-1R-2115	⑦	 M6-1-2115	⑧	 M6-3-2115
⑨	 M5-1L-2115	⑩	 M6-1-2115		
⑪	 ROAD CLOSED 500 FT W20-3-4848	⑫	 ROAD CLOSED R11-2-4830	⑬	 END DETOUR M4-8A
⑭	 ROAD CLOSED 4 MILES AHEAD LOCAL TRAFFIC ONLY R11-3a-6030	⑮	 DETOUR M4-10R-4818	⑯	 DETOUR M4-10L-4818
⑰	 ROAD CLOSED 2 MILES AHEAD LOCAL TRAFFIC ONLY R11-3a-6030				

LEGEND

----- DETOUR ROUTE

CONSTRUCTION ZONE

TYPE III BARRICADE WITH TWO FLASHING LIGHTS

NOTES

1. PLACEMENT AND SPACING OF SIGNS AND BARRICADES SHALL BE IN ACCORDANCE WITH TC-21 (DETOUR SIGNING FOR CLOSING STATE HIGHWAYS).
2. THE COST OF SUPPLYING, ERECTING AND MAINTAINING BARRICADES, WARNING LIGHTS AND ALL SIGNS, INCLUDING SIGN PANEL OVERLAYS, SHALL BE INCLUDED IN THE CONTRACT COST OF TRAFFIC CONTROL AND PROTECTION (SPECIAL).
3. ACCESS TO ALL PRIVATE ENTRANCES SHALL BE MAINTAINED.
4. ALL SIGNALIZED INTERSECTIONS ALONG THE DETOUR ROUTE SHALL IMPLEMENT TEMPORARY TRAFFIC SIGNAL TIMING.
5. THE FOLLOWING INTERSECTION WILL REQUIRE MAINTENANCE OF EXISTING TRAFFIC SIGNAL INSTALLATION:
- IL RTE 25 AND IL RTE 68

M:\IL_31 and US 14 Culvert Removals (12-154-0025)\Design\Civil\CADD Sheets\IL31US14-shr-detour-31.dgn



USER NAME = KjeC	DESIGNED - KJC	REVISED -
PLOT SCALE = NTS	DRAWN - KJC	REVISED -
PLOT DATE = 2/17/2015	CHECKED - LVA	REVISED -
	DATE - 02/17/15	REVISED -

**STATE OF ILLINOIS
DEPARTMENT OF TRANSPORTATION**

**IL 31 OVER ANIMAL CROSSING CULVERT REMOVAL
TRAFFIC CONTROL DETOUR PLAN**

SCALE: NTS SHEET 1 OF 1 SHEETS STA. TO STA.

F.A.U. RTE.	SECTION	COUNTY	TOTAL SHEETS	SHEET NO.
3887	2014-0821	KANE	18	9
CONTRACT NO. 62A30				
ILLINOIS FED. AID PROJECT				

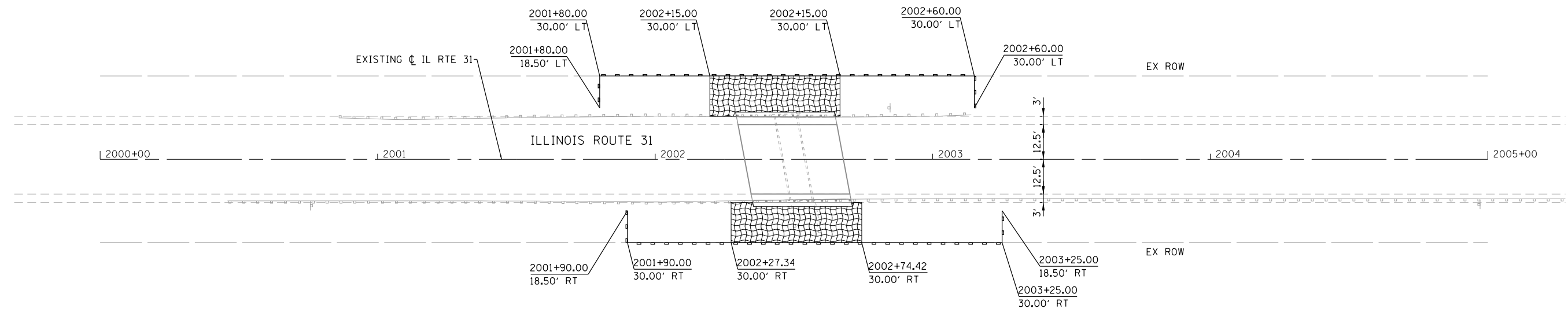
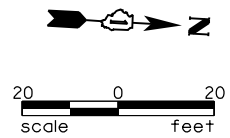

TEMPORARY EROSION CONTROL NOTES

1. THE CONTRACTOR SHALL INSTALL PERIMETER EROSION BARRIER PRIOR TO STRIPPING OF VEGETATION.
2. RUNOFF FROM EXCAVATION AREAS SHALL LEAVE THE SITE THROUGH SEDIMENT CONTROL DEVICES. THE CONTRACTOR SHALL ADJUST HIS OPERATION AND IMPLEMENT EROSION CONTROL MEASURES ACCORDINGLY.
3. THE CONTRACTOR SHALL SURROUND ANY NECESSARY EARTH STOCKPILES WITH PERIMETER EROSION BARRIER. THIS WILL BE INCLUDED IN THE COST OF EARTH EXCAVATION.
4. THE CONTRACTOR SHALL MAINTAIN ALL EROSION CONTROL DEVICES AT ALL TIMES. EROSION CONTROL DEVICES SHALL BE INSPECTED EVERY SEVEN CALENDAR DAYS OR WITHIN 24 HOURS AFTER A 1/2 INCH RAINFALL OR SNOWFALL.
5. THE CONTRACTOR SHALL SEED ALL DISTURBED AREAS AS SOON AS PRACTICAL AFTER CONSTRUCTION ACTIVITIES IN THAT AREA HAVE BEEN CONCLUDED. AREAS THAT HAVE STEEP SLOPES OR WILL NOT RECEIVE PERMANENT LANDSCAPING SHALL BE TEMPORARILY SEEDED. ALL FLATTER AREAS OR AREAS WHERE NO FURTHER WORK IS TO OCCUR FOR ONE MONTH OR MORE SHALL BE SEEDED AND COVERED WITH AN EROSION CONTROL BLANKET WITHIN SEVEN (7) CALENDAR DAYS.

LEGEND

- CLEARING
- TEMPORARY EROSION CONTROL SEEDING
- TOPSOIL FURNISH AND PLACE, 6"
- SEEDING, CLASS 3 (MODIFIED)
- HEAVY DUTY EROSION CONTROL BLANKET
- PERIMETER EROSION BARRIER

M:\IL_31 and US 14 Culvert Removals (12-154-005)\Design\Civil\CADD Sheets\DL31US14-shr-eros.31.dgn



USER NAME = KyeC	DESIGNED - KJC	REVISED -
PLOT SCALE = 1"=20'	DRAWN - KJC	REVISED -
PLOT DATE = 2/17/2015	CHECKED - LVA	REVISED -
	DATE - 02/17/15	REVISED -

**STATE OF ILLINOIS
DEPARTMENT OF TRANSPORTATION**

**IL 31 OVER ANIMAL CROSSING CULVERT REMOVAL
EROSION AND SEDIMENT CONTROL PLAN**

SCALE: 1"=20' SHEET 1 OF 1 SHEETS STA. TO STA.

F.A.U. RTE.	SECTION	COUNTY	TOTAL SHEETS	SHEET NO.
3887	2014-0821	KANE	18	10
CONTRACT NO. 62A30			ILLINOIS FED. AID PROJECT	

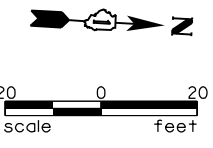

PLAN	SURVEYED	BY	DATE
	PLOTTED		
	GRADES CHECKED		
	ALIGNED		
	FILE NAME		
	NO.		

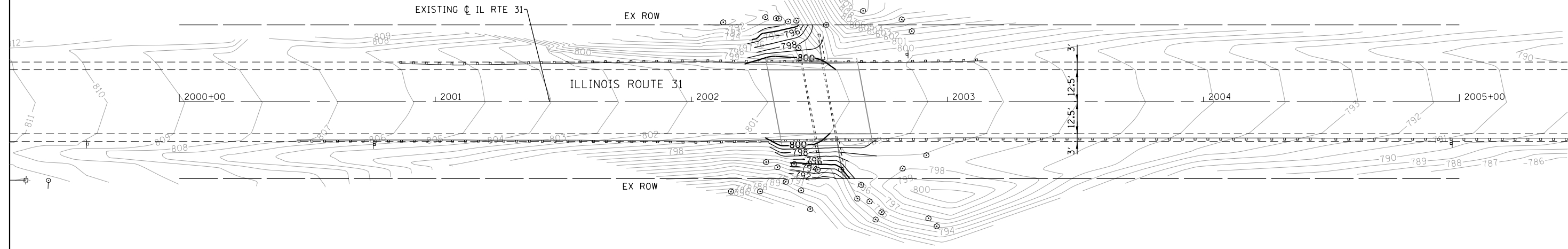

PROFILE	SURVEYED	BY	DATE
	PLOTTED		
	GRADES CHECKED		
	FILE NAME		
	NO.		

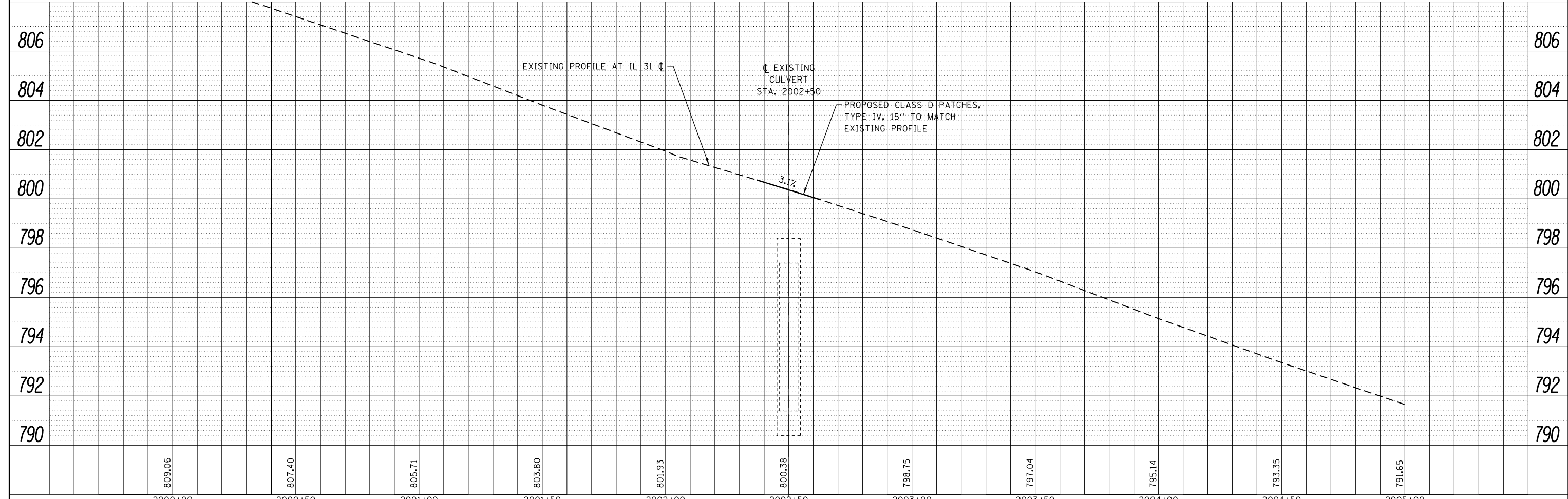

809.06	807.40	805.71	803.80	801.93	800.38	798.75	797.04	795.14	793.35	791.65
2000+00	2000+50	2001+00	2001+50	2002+00	2002+50	2003+00	2003+50	2004+00	2004+50	2005+00



USER NAME = Kjeic	DESIGNED - KJC	REVISED -
	DRAWN - KJC	REVISED -
PLOT SCALE = 1"=20'	CHECKED - LVA	REVISED -
PLOT DATE = 2/17/2015	DATE - 02/17/15	REVISED -

**STATE OF ILLINOIS
DEPARTMENT OF TRANSPORTATION**

**IL 31 OVER ANIMAL CROSSING CULVERT REMOVAL
DRAINAGE AND UTILITY PLAN**

F.A.U. RTE.	SECTION	COUNTY	TOTAL SHEETS	SHEET NO.
3887	2014-0821	KANE	18	11
CONTRACT NO. 62A30				
ILLINOIS FED. AID PROJECT				

SCALE: 1"=20' SHEET 1 OF 1 SHEETS STA. TO STA.

M:\IL_31 and US 14 Culvert Removals\12-154-0023\Design\Civil\CADD Sheets\Profile\3887-1111-1111.dwg

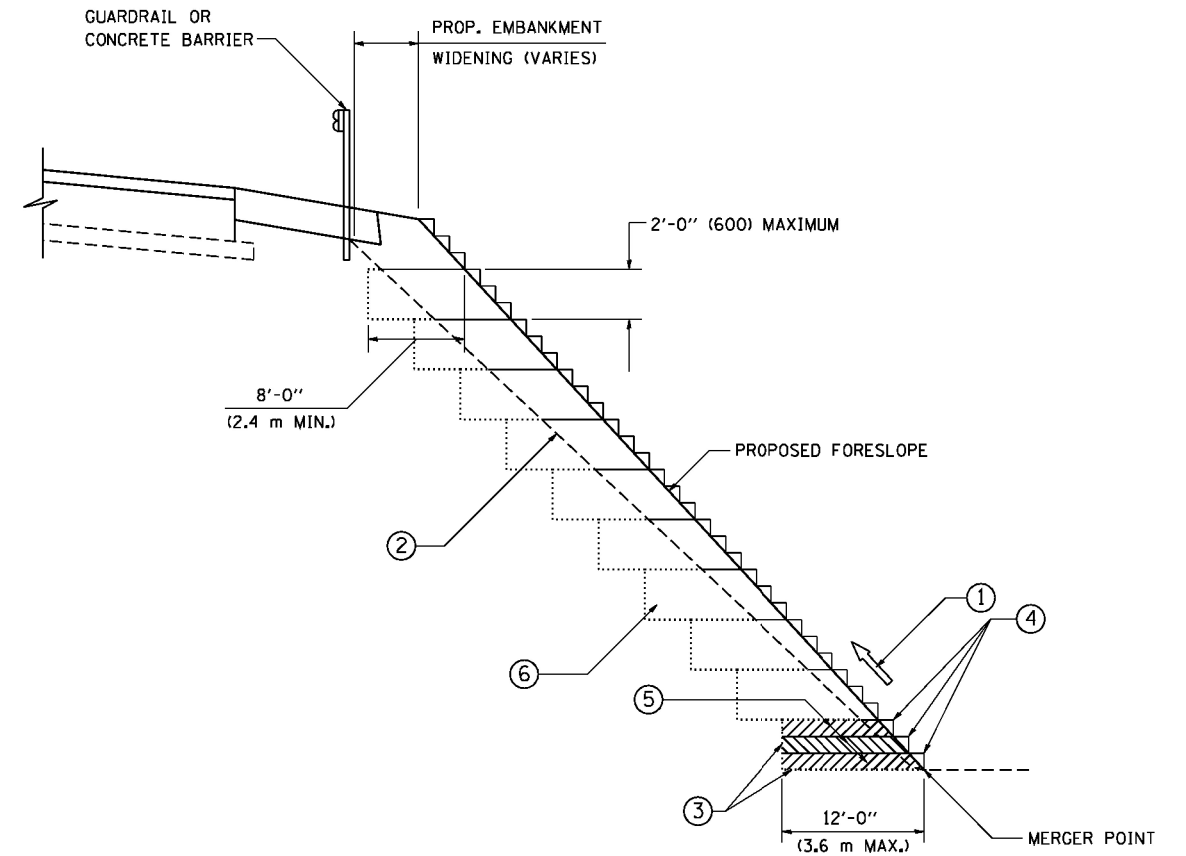

**TYPICAL BENCHING DETAIL
FOR EMBANKMENT**

NOTES:

- ① CONSTRUCT SUCCEEDING BENCH CUTS AND EMBANKMENT PLACEMENT AND COMPACTION FROM BOTTOM TO TOP IN STAIRSTEP FASHION.
- ② EXISTING FORESLOPE PREPARED IN ACCORDANCE WITH ARTICLE 205.03 OF THE STANDARD SPECIFICATIONS.
- ③ BENCH CUT EXISTING SLOPE TYPICAL FOR EACH STEP.
- ④ TRIM TO FINAL SLOPE.
- ⑤ EQUAL 8-INCH (200) LIFTS OF EMBANKMENT COMPACTED IN ACCORDANCE WITH ARTICLE 205.05 OF THE STANDARD SPECIFICATIONS.
- ⑥ EXCAVATION OF BENCH CUTS WITHIN EXISTING EMBANKMENT WILL BE PAID FOR AT THE CONTRACT UNIT PRICE PER CUBIC METER OR CUBIC YARD FOR "EARTH EXCAVATION". THIS PRICE WILL INCLUDE ALL LABOR AND MATERIAL, NO ADDITIONAL COMPENSATION WILL BE ALLOWED.
- ⑦ SLOPES SHALL BE BENCHED ACCORDING TO THIS DETAIL WHEN THE SLOPE IS STEEPER THAN 4:1 AND THE HEIGHT IS GREATER THAN 5' (1.5 m).

ALL DIMENSIONS ARE IN INCHES (MILLIMETERS)
UNLESS OTHERWISE SHOWN.

FILE NAME = W:\diststd\22x34\bd51.dgn	USER NAME = geglanoht	DESIGNED -	REVISED -	STATE OF ILLINOIS DEPARTMENT OF TRANSPORTATION	BENCHING DETAIL FOR EMBANKMENT WIDENING			F.A.U. RTE.	SECTION	COUNTY	TOTAL SHEETS	SHEET NO.
	PLOT SCALE = 50.0000' / IN.	DRAWN - CADD	REVISED -		3887	2014-0821	KANE	18	12			
PLOT DATE = 1/4/2008	CHECKED - S.E.B.	REVISED -	SCALE: NONE		SHEET NO. 1 OF 1 SHEETS	STA.	TO STA.	BD-51 (MODIFIED) CONTRACT NO. 62A30				
	DATE - 06-16-04	REVISED -	FED. ROAD DIST. NO. 1 ILLINOIS FED. AID PROJECT									

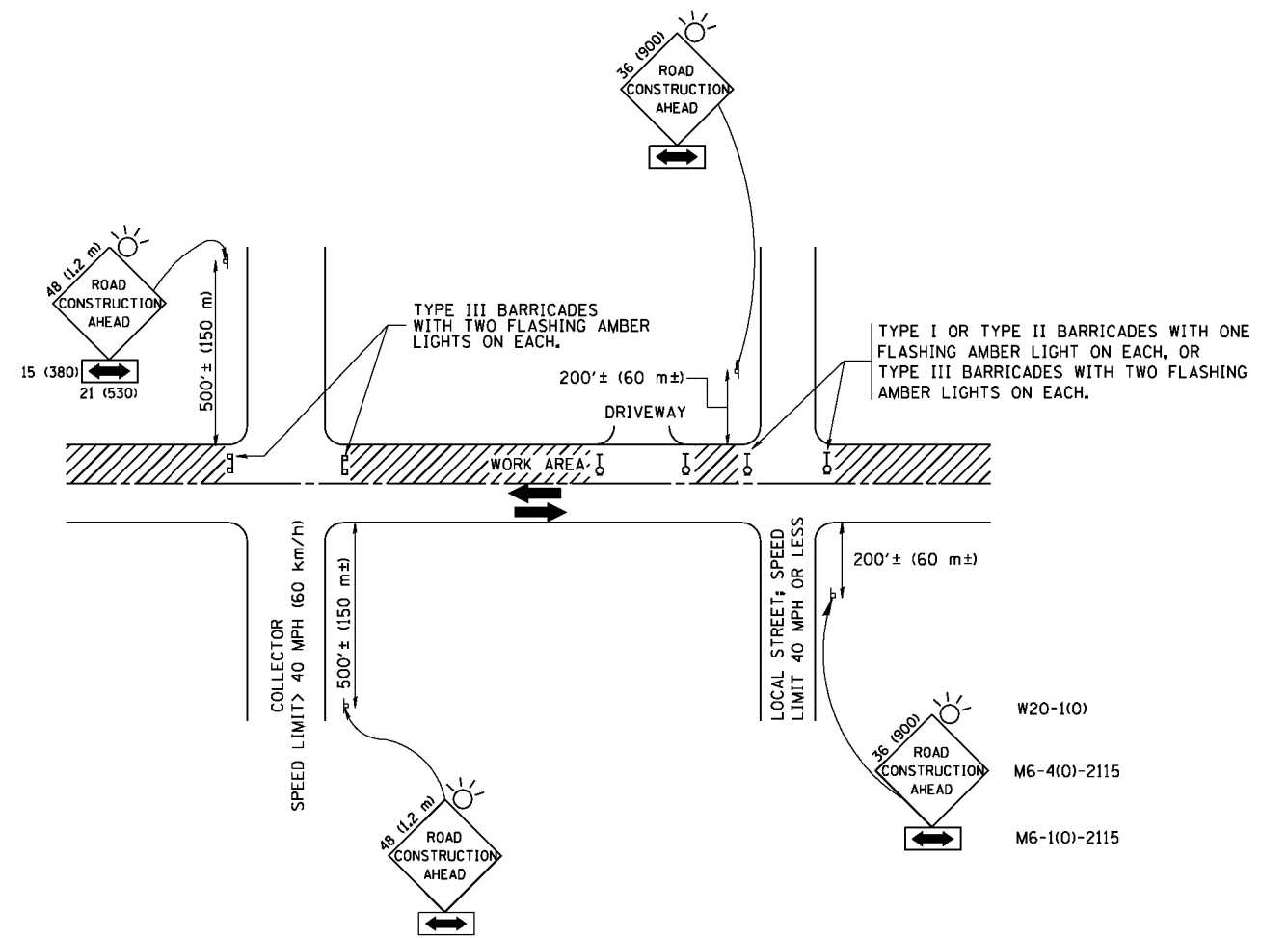

TRAFFIC CONTROL AND PROTECTION FOR SIDE ROADS, INTERSECTIONS, AND DRIVEWAYS

NOTES:

A. FOR NO LANE RESTRICTION ON THE SIDE ROAD OR DRIVEWAYS

1. SIDE ROAD WITH A SPEED LIMIT OF 40 MPH (60 km/h) OR LESS AS SHOWN ON THE DRAWING AND AS DIRECTED BY THE ENGINEER:
 - a) ONE ROAD CONSTRUCTION AHEAD SIGN 36 x 36 (900x900) WITH A FLASHER AND FLAG MOUNTED ON IT APPROXIMATELY 200' (60 m) IN ADVANCE OF THE MAIN ROUTE.
 - b) THE CLOSED PORTION OF THE MAIN ROUTE SHALL BE PROTECTED BY BLOCKING WITH TYPE I, TYPE II OR TYPE III BARRICADES, 1/3 OF THE CROSS SECTION OF THE CLOSED PORTION.
2. SIDE ROAD WITH A SPEED LIMIT GREATER THAN 40 MPH (60 km/h) AS SHOWN ON THE DRAWING AND AS DIRECTED BY THE ENGINEER:
 - a) ONE ROAD CONSTRUCTION AHEAD SIGN 48 x 48 (1.2 m x 1.2 m) WITH A FLASHER MOUNTED ON IT APPROXIMATELY 500' (150 m) IN ADVANCE OF THE MAIN ROUTE.
 - b) THE CLOSED PORTION OF THE MAIN ROUTE SHALL BE PROTECTED BY BLOCKING WITH TYPE III BARRICADES, 1/2 OF THE CROSS SECTION OF THE CLOSED PORTION.
3. WHEN THE SIDE ROAD LIES BETWEEN THE BEGINNING OF THE MAINLINE SIGNING AND THE WORK ZONE, A SINGLE HEADED ARROW (M6-1) SHALL BE USED IN LIEU OF THE DOUBLE HEADED ARROW (M6-4).

B. FOR A LANE CLOSURE ON A SIDE ROAD OR DRIVEWAY:

- USE APPLICABLE PORTIONS OF THE TYPICAL APPLICATION OF TRAFFIC CONTROL DEVICES (STD. 701501, STD. 701606 OR THE APPROPRIATE STANDARD). THE SPACING OF SIGNS AND BARRICADES SHALL BE ADJUSTED FOR FIELD CONDITIONS AS DIRECTED BY THE ENGINEER. THE DIRECTIONAL ARROW SHALL BE COVERED OR REMOVED WHEN NO LONGER CONSISTENT WITH THE SIDE ROAD LANE CLOSURE.
- C. ADVANCE WARNING SIGNS ARE TO BE OMITTED ON DRIVEWAY UNLESS OTHERWISE NOTED.
- D. THE TRAFFIC CONTROL AND PROTECTION FOR SIDE ROADS, INTERSECTIONS, AND DRIVEWAYS SHALL BE INCIDENTAL TO THE COST OF SPECIFIED TRAFFIC CONTROL STANDARDS OR ITEMS.

All dimensions are in millimeters (inches) unless otherwise shown.

FILE NAME =	USER NAME = geglano	DESIGNED - LHA	REVISED - J. OBERLE 10-16-95
W:\distatd\22x34\c10.dgn		DRAWN -	REVISED - A. HOUSEH 03-06-96
	PLOT SCALE = 50.000' / IN.	CHECKED -	REVISED - A. HOUSEH 10-15-96
	PLOT DATE = 1/4/2008	DATE - 06-89	REVISED - T. RAMMACHER 01-06-00

STATE OF ILLINOIS
DEPARTMENT OF TRANSPORTATION

TRAFFIC CONTROL AND PROTECTION FOR
SIDE ROADS, INTERSECTIONS, AND DRIVEWAYS

SCALE: NONE SHEET NO. 1 OF 1 SHEETS STA. TO STA.

F.A.U. RTE.	SECTION	COUNTY	TOTAL SHEETS	SHEET NO.
3887	2014-0821	KANE	18	13
TC-10			CONTRACT NO. 62A30	
FED. ROAD DIST. NO. 1 ILLINOIS FED. AID PROJECT				

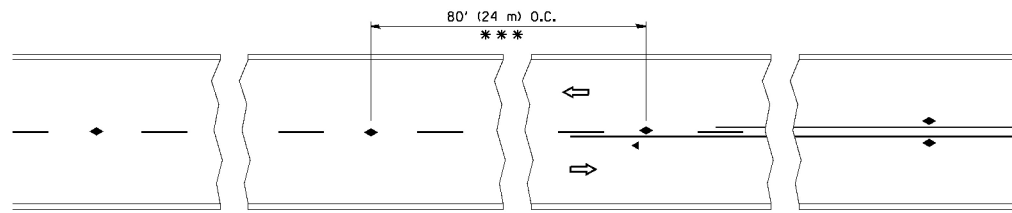

*** REDUCE TO 40' (12 m) O.C. ON CURVES WITH POSTED OR ADVISORY SPEED 45 M.P.H. (70 km/h) OR LESS.

TWO-LANE/TWO-WAY

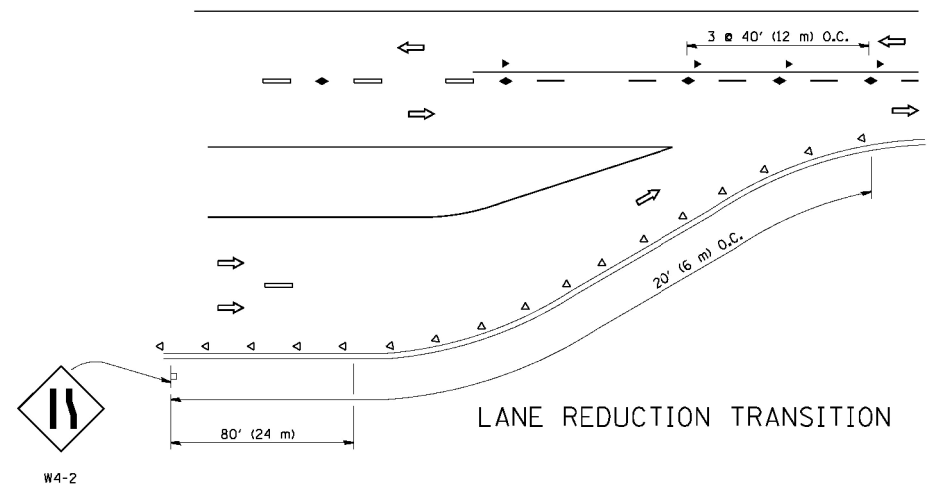

LANE REDUCTION TRANSITION

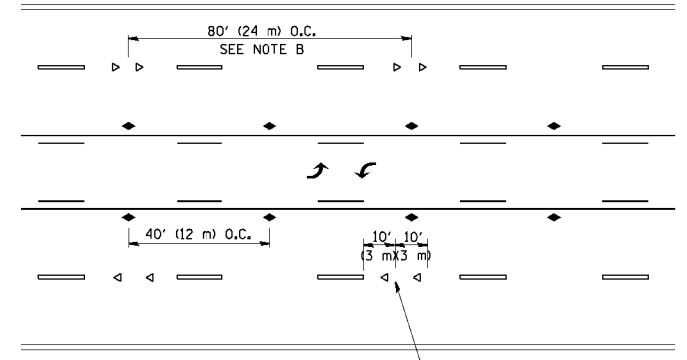

TWO-WAY LEFT TURN

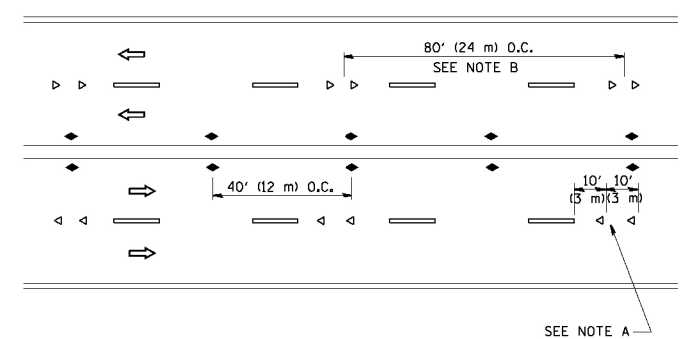

MULTI-LANE/UNDIVIDED

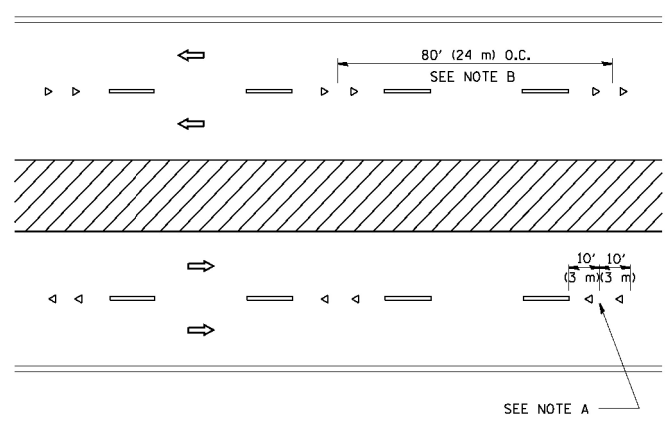

MULTI-LANE/DIVIDED

GENERAL NOTES

1. MARKERS USED WITH DASHED LINES SHALL BE CENTERED IN THE GAP BETWEEN SEGMENTS.
2. MARKERS USED ADJACENT TO SOLID LINES SHALL BE OFFSET 2 TO 3 (50 TO 75) TOWARD TRAFFIC AS SHOWN.
3. MARKERS THROUGH TANGENTS LESS THAN 500' (150 m) IN LENGTH BETWEEN CURVES SHALL BE INSTALLED AT THE LESSER OF THE TWO CURVE SPACINGS.

SYMBOLS

- YELLOW STRIPE
- WHITE STRIPE
- ◀ ONE-WAY AMBER MARKER
- ◁ ONE-WAY CRYSTAL MARKER (W/O)
- ◆ TWO-WAY AMBER MARKER

LANE MARKER NOTES

- A. USE DOUBLE LANE LINE MARKERS SPACED AS SHOWN.
- B. REDUCE TO 40' (12 m) O.C. ON CURVES WHERE ADVISORY SPEEDS ARE 10 M.P.H. (20 km/h) LOWER THAN POSTED SPEEDS.

DESIGN NOTES

1. DOUBLE LANE LINE MARKERS SHALL BE USED UNLESS SPECIFIED OTHERWISE.
2. EXCEPT AS SHOWN ON THE LANE REDUCTION TRANSITION AND FREEWAY EXIT RAMP DETAIL, MARKERS ARE NOT TO BE SPECIFIED ON RIGHT EDGE LINES.
3. THE EXACT MARKER LIMITS, SPACING, AND COLOR SHALL BE INCLUDED IN THE PLANS WHEN STANDARD SPECIFICATIONS ARE NOT BEING USED.
4. MARKERS SHOULD NOT BE USED ALONGSIDE CURBS EXCEPT FOR EXTREMELY SHORT SECTIONS OF CURBS WHERE NOT MORE THAN TWO MARKERS WOULD BE INVOLVED.

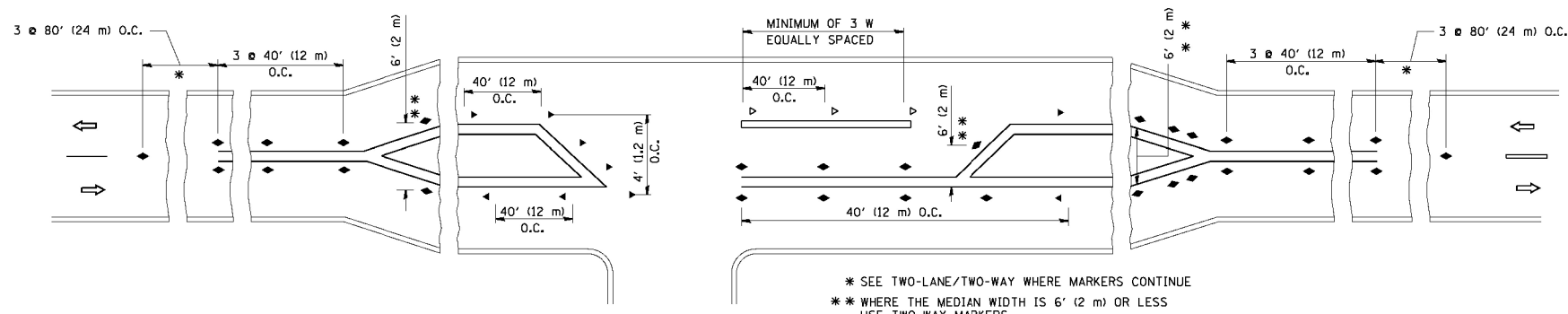

* SEE TWO-LANE/TWO-WAY WHERE MARKERS CONTINUE
 ** WHERE THE MEDIAN WIDTH IS 6' (2 m) OR LESS USE TWO-WAY MARKERS.

LEFT TURN

All dimensions are in inches (millimeters) unless otherwise shown.

FILE NAME =	USER NAME = lejss	DESIGNED -	REVISED - T. RAMMACHER 09-19-94	STATE OF ILLINOIS DEPARTMENT OF TRANSPORTATION	TYPICAL APPLICATIONS			F.A.U. RTE.	SECTION	COUNTY	TOTAL SHEETS	SHEET NO.
0:\p\work\pwi\dot\lejss\0108315\tcl1.dgn		DRAWN -	REVISED - T. RAMMACHER 03-12-99		RAISED REFLECTIVE PAVEMENT MARKERS (SNOW-PLOW RESISTANT)			3887	2014-0821	KANE	18	14
		CHECKED -	REVISED - T. RAMMACHER 01-06-00		SCALE: NONE	SHEET NO. 1 OF 1 SHEETS	STA. TO STA.	TC-11		CONTRACT NO. 62A30		
		DATE -	REVISED - C. JUCIUS 09-09-09		FED. ROAD DIST. NO. 1 ILLINOIS FED. AID PROJECT							

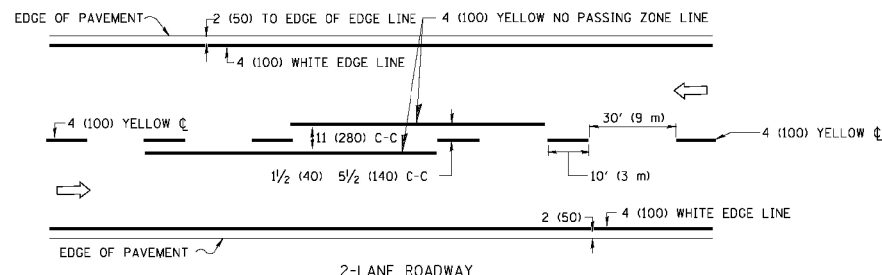

2-LANE ROADWAY

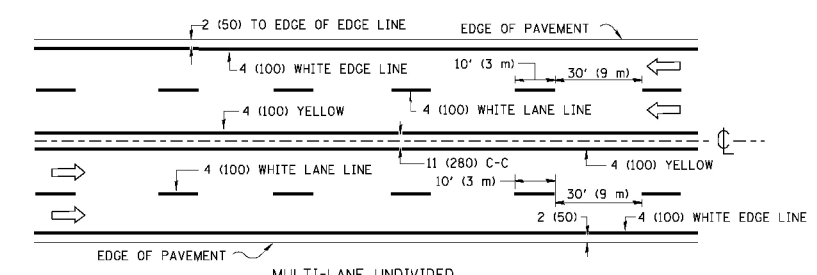

MULTI-LANE UNDIVIDED

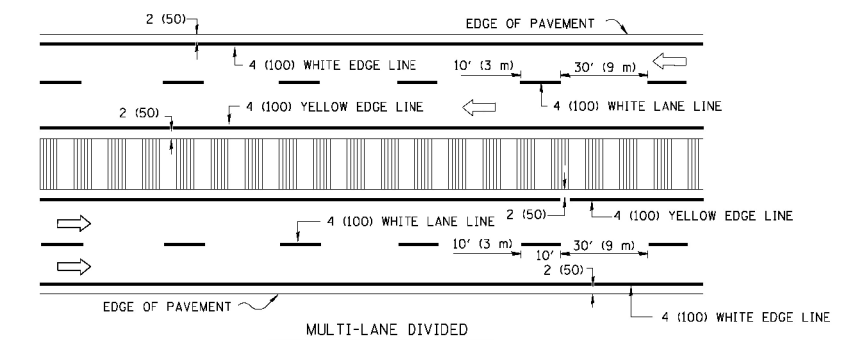

MULTI-LANE DIVIDED WITH MOUNTABLE MEDIAN

NOTE: MEDIANS WITH BARRIER CURB DO NOT REQUIRE AN EDGE LINE

TYPICAL LANE AND EDGE LINE MARKING

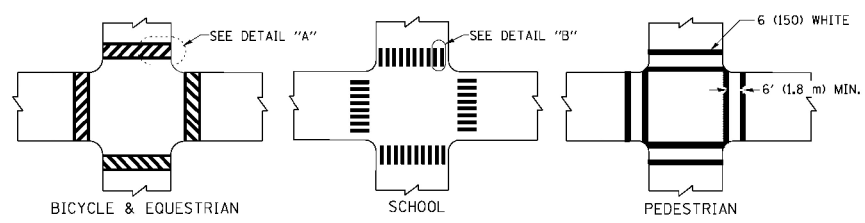

TYPICAL CROSSWALK MARKING

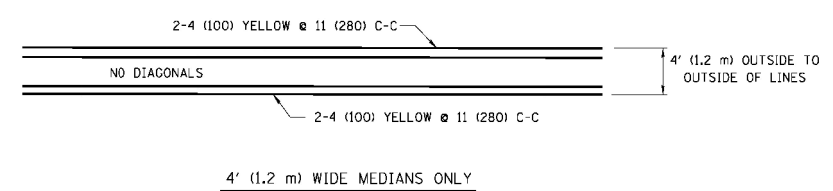

4' (1.2 m) WIDE MEDIANS ONLY

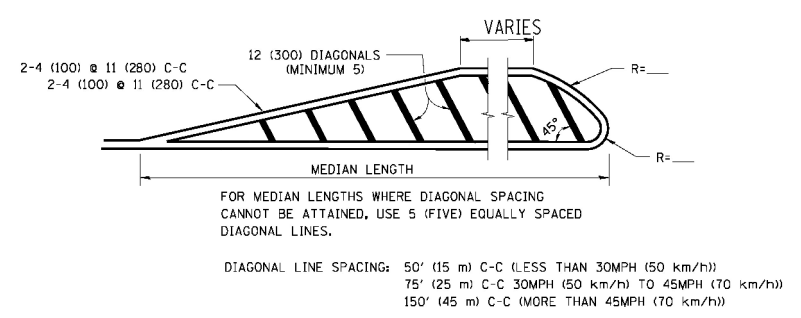

MEDIANS OVER 4' (1.2 m) WIDE

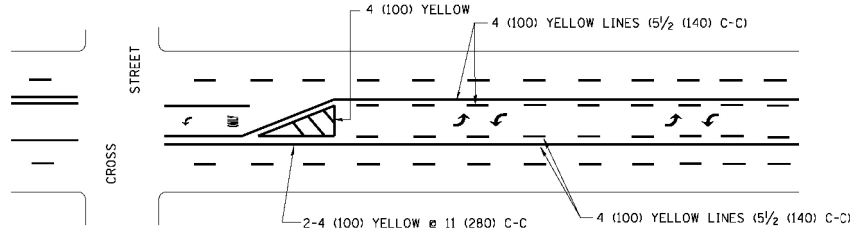

A MINIMUM OF TWO PAIRS OF TURN ARROWS SHALL BE USED, WHITE IN COLOR. ADDITIONAL PAIRS SHALL BE PLACED AT 200' (60 m) TO 300' (90 m) INTERVALS.

MEDIAN WITH TWO-WAY LEFT TURN LANE

TYPICAL PAINTED MEDIAN MARKING

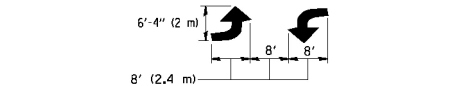

TYPICAL LEFT (OR RIGHT) TURN LANE

TYPICAL TURN LANE MARKING

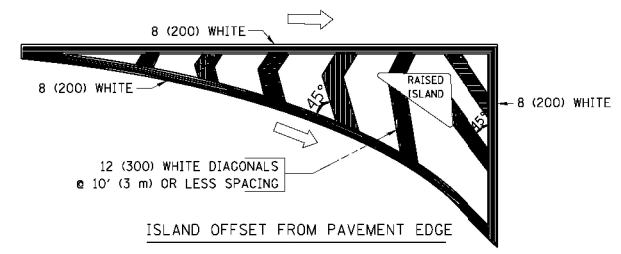

ISLAND OFFSET FROM PAVEMENT EDGE

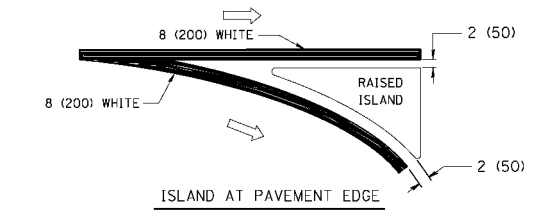

ISLAND AT PAVEMENT EDGE

TYPICAL ISLAND MARKING

TYPE OF MARKING	WIDTH OF LINE	PATTERN	COLOR	SPACING / REMARKS
CENTERLINE ON 2 LANE PAVEMENT	4 (100)	SKIP-DASH	YELLOW	10' (3 m) LINE WITH 30' (9 m) SPACE
CENTERLINE ON MULTI-LANE UNDIVIDED PAVEMENT	2 @ 4 (100)	SOLID	YELLOW	11 (280) C-C
NO PASSING ZONE LINES: FOR ONE DIRECTION	4 (100)	SOLID	YELLOW	5/2 (140) C-C FROM SKIP-DASH CENTERLINE
NO PASSING ZONE LINES: FOR BOTH DIRECTIONS	2 @ 4 (100)	SOLID	YELLOW	11 (280) C-C OMIT SKIP-DASH CENTERLINE BETWEEN
LANE LINES	4 (100)	SKIP-DASH	WHITE	10' (3 m) LINE WITH 30' (9 m) SPACE
LANE LINES (EXTENSIONS OF CENTER, LANE OR TURN LANE MARKINGS)	5 (125) ON FREEWAYS	SKIP-DASH	WHITE	10' (3 m) LINE WITH 30' (9 m) SPACE
DOTTED LINES (EXTENSIONS OF CENTER, LANE OR TURN LANE MARKINGS)	SAME AS LINE BEING EXTENDED	SKIP-DASH	SAME AS LINE BEING EXTENDED	2' (600) LINE WITH 6' (1.8 m) SPACE
EDGE LINES	4 (100)	SOLID	YELLOW-LEFT WHITE-RIGHT	OUTLINE MOUNTABLE MEDIANS IN YELLOW; EDGE LINES ARE NOT USED NEXT TO BARRIER CURB
TURN LANE MARKINGS	6 (150) LINE; FULL SIZE LETTERS & SYMBOLS (8' (2.4m))	SOLID	WHITE	SEE TYPICAL TURN LANE MARKING DETAIL
TWO WAY LEFT TURN MARKING	2 @ 4 (100) EACH DIRECTION	SKIP-DASH AND SOLID	YELLOW	10' (3 m) LINE WITH 30' (9 m) SPACE FOR SKIP-DASH; 5/2 (140) C-C BETWEEN SOLID LINE AND SKIP-DASH LINE
TWO WAY LEFT TURN MARKING	8' (2.4m) LEFT ARROW	IN PAIRS	WHITE	SEE TYPICAL TWO-WAY LEFT TURN MARKING DETAIL
CROSSWALK LINES (PEDESTRIAN)	2 @ 6 (150)	SOLID	WHITE	NOT LESS THAN 6' (1.8 m) APART
CROSSWALK LINES (BIKE & EQUESTRIAN)	12 (300) @ 45°	SOLID	WHITE	2' (600) APART
CROSSWALK LINES (LONGITUDINAL BARS (SCHOOL))	12 (300) @ 90°	SOLID	WHITE	2' (600) APART SEE TYPICAL CROSSWALK MARKING DETAILS.
STOP LINES	24 (600)	SOLID	WHITE	PLACE 4' (1.2 m) IN ADVANCE OF AND PARALLEL TO CROSSWALK, IF PRESENT. OTHERWISE, PLACE AT DESIRED STOPPING POINT, PARALLEL TO CROSSROAD CENTERLINE, WHERE POSSIBLE
PAINTED MEDIANS	2 @ 4 (100) WITH 12 (300) DIAGONALS @ 45°	SOLID	YELLOW; TWO WAY TRAFFIC WHITE; ONE WAY TRAFFIC	11 (280) C-C FOR THE DOUBLE LINE SEE TYPICAL PAINTED MEDIAN MARKING.
NO DIAGONALS USED FOR 4' (1.2 m) WIDE MEDIANS				
GORE MARKING AND CHANNELIZING LINES	8 (200) WITH 12 (300) DIAGONALS @ 45°	SOLID	WHITE	DIAGONALS: 15' (4.5 m) C-C (LESS THAN 30MPH (50 km/h)) 20' (6 m) C-C 30MPH (50 km/h) TO 45MPH (70 km/h) 30' (9 m) C-C (OVER 45MPH (70 km/h))
RAILROAD CROSSING	24 (600) TRANSVERSE LINES; "RR" 15' (4.5 m) LETTERS; 16 (400) LINE FOR "X"	SOLID	WHITE	SEE STATE STANDARD 780001 AREA OF: "RR"=3.6 SQ. FT. (0.33 m ²) EACH "X"=54.0 SQ. FT. (5.0 m ²)
SHOULDER DIAGONALS	12 (300) @ 45°	SOLID	WHITE - RIGHT YELLOW - LEFT	50' (15 m) C-C (LESS THAN 30MPH (50 km/h)) 75' (25 m) C-C (30 MPH (50 km/h) TO 45MPH (70 km/h)) 150' (45 m) C-C (OVER 45MPH (70 km/h))

FOR FURTHER DETAILS ON PAVEMENT MARKING REFER TO STANDARD SPECIFICATIONS FOR ROAD AND BRIDGE CONSTRUCTION AND STATE STANDARD 780001.

All dimensions are in inches (millimeters) unless otherwise shown.

FILE NAME =	USER NAME = drivakosgn	DESIGNED - EVERS	REVISED - T. RAMMACHER 10-27-94
es:\pwork\pwork\drivakosgn\d0108315\tp3.dgn		DRAWN -	REVISED - C. JUCIUS 09-09-09
	PLOT SCALE = 50.000' / IN.	CHECKED -	REVISED -
	PLOT DATE = 9/9/2009	DATE - 03-19-90	REVISED -

STATE OF ILLINOIS DEPARTMENT OF TRANSPORTATION

DISTRICT ONE		F.A.U. RTE.	SECTION	COUNTY	TOTAL SHEETS	SHEET NO.
TYPICAL PAVEMENT MARKINGS		3887	2014-0821	KANE	18	15
SCALE: NONE		SHEET NO. 1 OF 1 SHEETS		STA.	TO STA.	
		TC-13		CONTRACT NO. 62A30		
FED. ROAD DIST. NO. 1 ILLINOIS FED. AID PROJECT						



ROUTE MARKERS

 FOR U.S. ROUTES
M1-40-2424

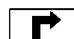
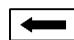
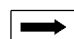

 FOR ILLINOIS ROUTES
M1-50-2424

 R.R., UNMARKED ROUTES
SPECIAL 24" x 18" VARIABLE
4" BLACK LETTERS ON WHITE
REFLECTIVE BACKGROUND

ARROWS SIGNS

-  M5-1L-2115
-  M5-1R-2115
-  M6-1-2115
-  M6-1-2115
-  M6-3-2115

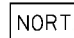
CARDINAL DIRECTION & DETOUR SIGNS

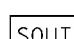
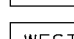
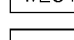
-  NORTH M3-1-2412
-  EAST M3-2-2412
-  SOUTH M3-3-2412
-  WEST M3-4-2412
-  DETOUR M4-8-2412

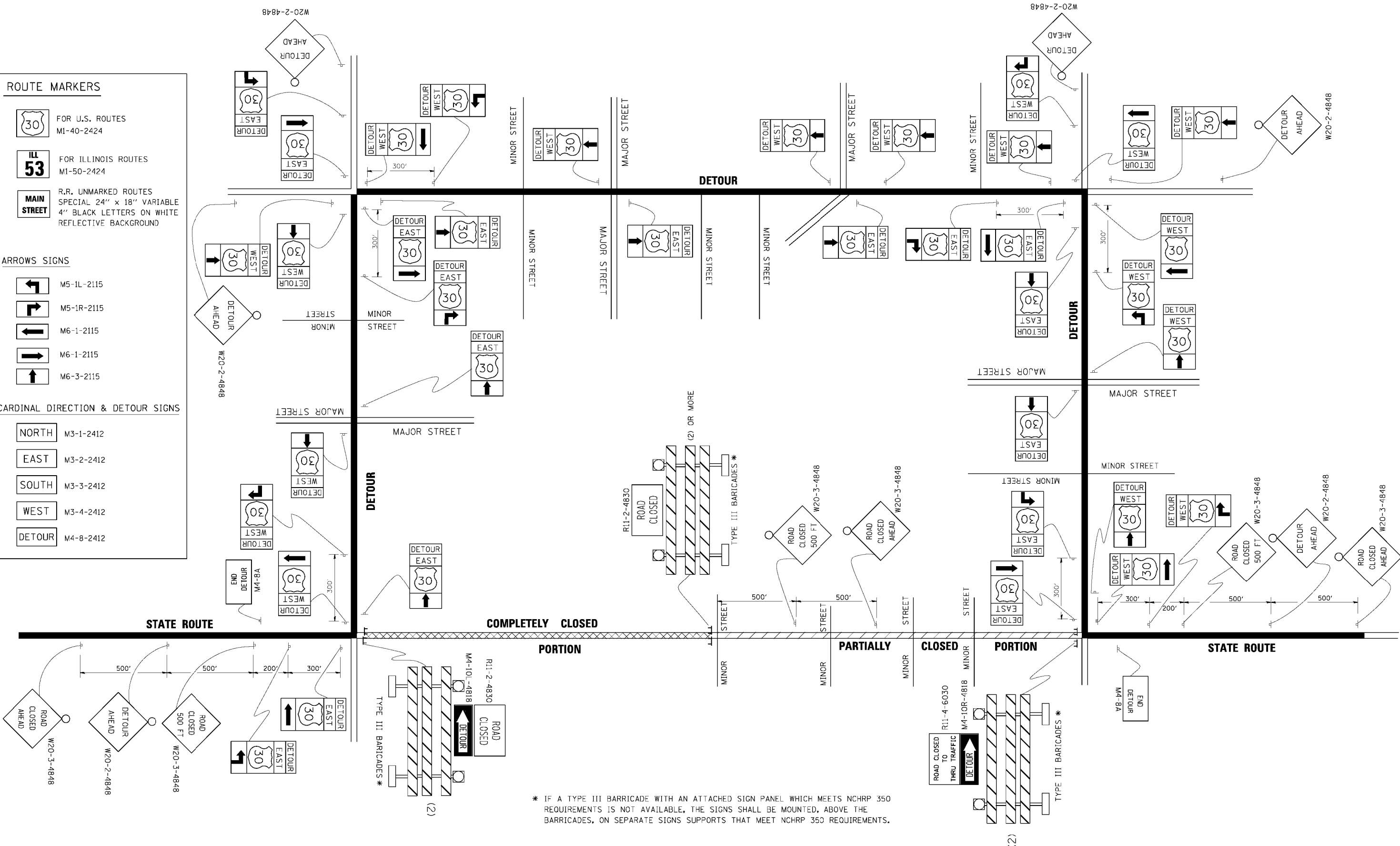

* IF A TYPE III BARRICADE WITH AN ATTACHED SIGN PANEL WHICH MEETS NCHRP 350 REQUIREMENTS IS NOT AVAILABLE, THE SIGNS SHALL BE MOUNTED, ABOVE THE BARRICADES, ON SEPARATE SIGNS SUPPORTS THAT MEET NCHRP 350 REQUIREMENTS.

FILE NAME =	USER NAME =
es:\pwwork\pwwork\DRIVAK\SGN\108315\1221.dgn	drivakosgn
PLOT SCALE = 49.9999' / IN.	PLOT DATE = 9/14/2009

DESIGNED -	REVISED - 10-18-02
DRAWN -	REVISED - R. BORO 09-14-09
CHECKED -	REVISED -
DATE -	REVISED -

**STATE OF ILLINOIS
DEPARTMENT OF TRANSPORTATION**

DETOUR SIGNING FOR CLOSING STATE HIGHWAYS			
SCALE: NONE	SHEET NO. 1 OF 1 SHEETS	STA.	TO STA.

F.A.U. RTE.	SECTION	COUNTY	TOTAL SHEETS	SHEET NO.
3887	2014-0821	KANE	18	16
TC-21		CONTRACT NO. 62A30		
FED. ROAD DIST. NO. 1 ILLINOIS FED. AID PROJECT				

FINAL SURVEY	SURVEYED	BY	DATE
NO.	PLOTTED		
	TEMPLATE		
	AREAS CHECKED		

ORIGINAL SURVEY	SURVEYED	BY	DATE
NO.	PLOTTED		
	TEMPLATE		
	AREAS CHECKED		

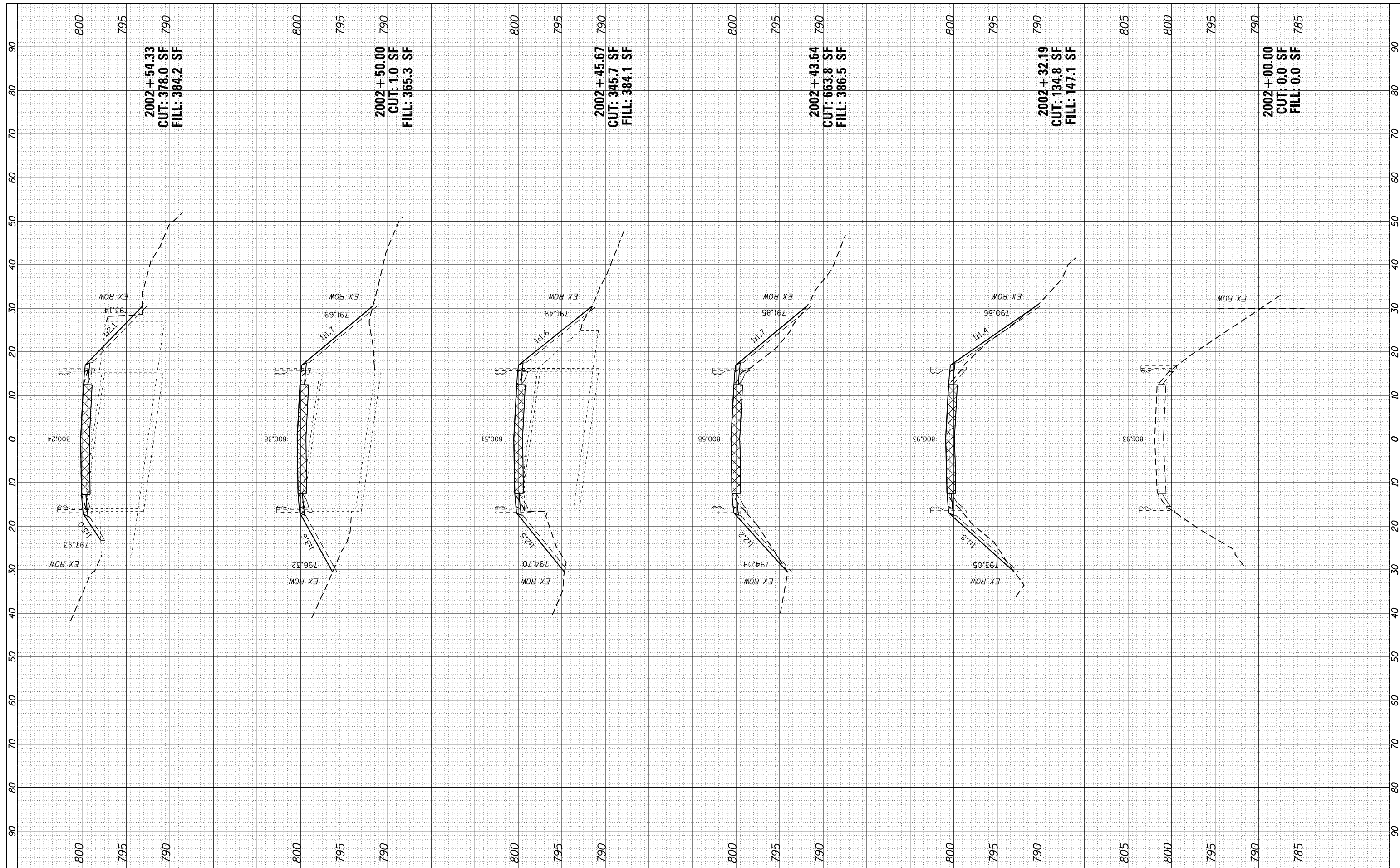

USER NAME = Kytoc
 DESIGNED - KJC
 DRAWN - KJC
 CHECKED - LVA
 DATE - 02/17/15

REVISED -
 REVISED -
 REVISED -
 REVISED -

STATE OF ILLINOIS
 DEPARTMENT OF TRANSPORTATION

IL 31 OVER ANIMAL CROSSING CULVERT REMOVAL
 CROSS SECTIONS

SCALE: 1"=10' SHEET 1 OF 2 SHEETS STA. 2002+00.00 TO STA. 2002+54.33

F.A.U. RTE. 3887	SECTION 2014-0821	COUNTY KANE	TOTAL SHEETS 18	SHEET NO. 17
CONTRACT NO. 62A30			ILLINOIS FED. AID PROJECT	

