

STATE OF ILLINOIS  
DEPARTMENT OF TRANSPORTATION  
DIVISION OF HIGHWAYS

**PROPOSED  
HIGHWAY PLANS**

VARIOUS ROUTES  
SECTION D7 WEED CONTROL SPRAYING 2015

WEED CONTROL SPRAYING  
VARIOUS COUNTIES

C-97-009-15

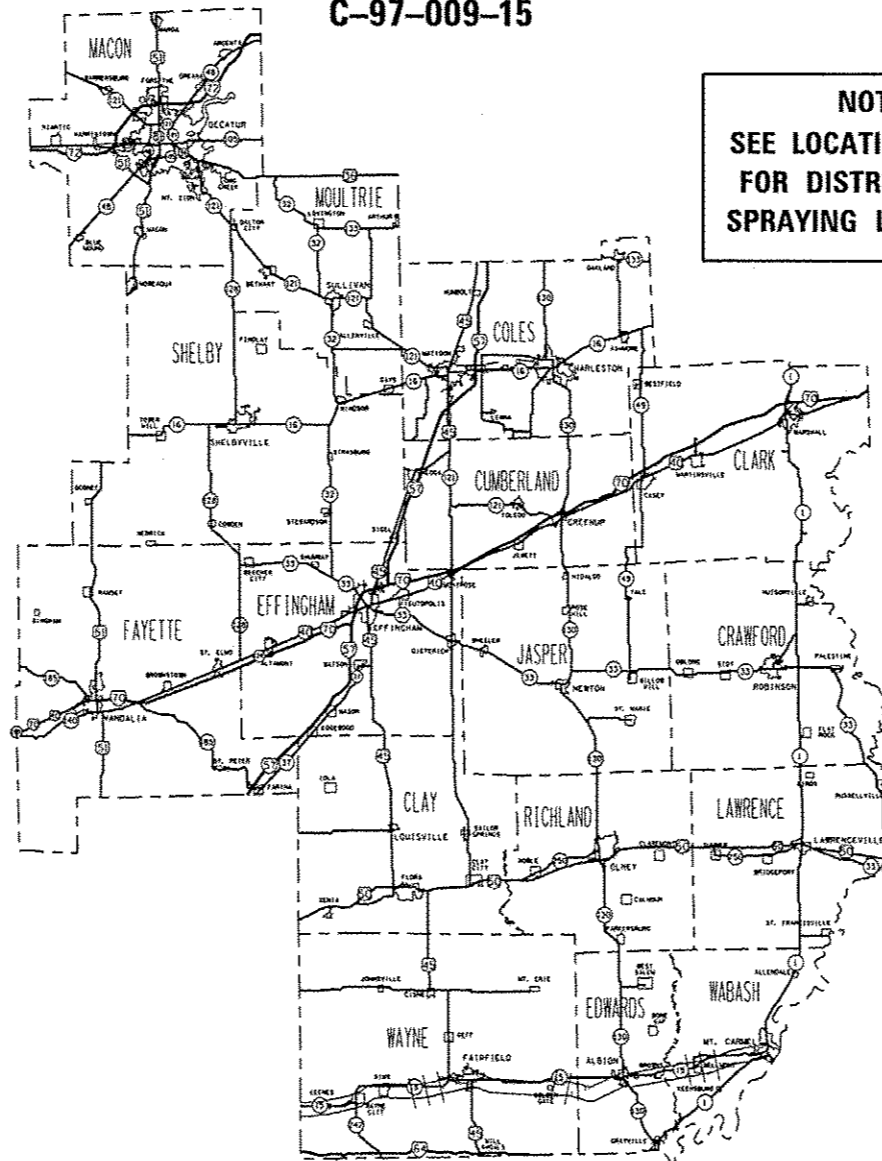

**NOTE:  
SEE LOCATION MAPS  
FOR DISTRICT WIDE  
SPRAYING LOCATIONS**

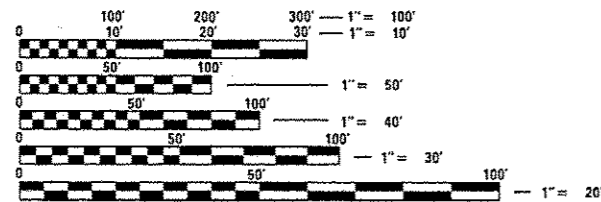

FULL SIZE PLANS HAVE BEEN PREPARED USING STANDARD ENGINEERING SCALES. REDUCED SIZED PLANS WILL NOT CONFORM TO STANDARD SCALES. IN MAKING MEASUREMENTS ON REDUCED PLANS, THE ABOVE SCALES MAY BE USED.

J.U.L.I.E.  
JOINT UTILITY LOCATION INFORMATION FOR EXCAVATION  
1-800-892-0123  
OR 811

PROJECT ENGINEER: TOM RONAN  
PROJECT MANAGER: TOM RONAN  
PHONE: (217)-342-8320  
CONTRACT NO. 74695

F.A. RTE.	SECTION	COUNTY	TOTAL SHEETS	SHEET NO.
VAR		VARIOUS	7	1
		ILLINOIS	CONTRACT NO. 74695	

\*D7 WEED CONTROL SPRAYING 2015

D-97-007-15



LOCATION OF SECTION INDICATED THUS: —

STATE OF ILLINOIS  
DEPARTMENT OF TRANSPORTATION  
DIVISION OF HIGHWAYS

SUBMITTED OCTOBER 22 20 14  
*Roger L. Daishell*  
DEPUTY DIRECTOR OF HIGHWAYS, REGION ENGINEER

MAR 20 20 15  
*John D. Baranzelli* P.E.  
ENGINEER OF DESIGN AND ENVIRONMENT

MAR 20 20 15  
*Amor Esman* P.E.  
DIRECTOR OF HIGHWAYS, CHIEF ENGINEER

PRINTED BY THE AUTHORITY  
OF THE STATE OF ILLINOIS

## INDEX OF SHEETS

SHEET NO.	TITLE
1	COVER SHEET
2	INDEX OF SHEETS, HIGHWAY STANDARDS, SPRAY LIMITS
3	SUMMARY OF QUANTITIES
4-7	LOCATION MAPS

THE FOLLOWING STANDARDS ARE A PART OF THESE PLANS AND ARE INCLUDED AFTER SHEET NO. 7:

- TO1426-07 LANE CLOSURE, MULTILANE, INTERMITTENT OR MOVING OPER., FOR SPEEDS >= 45 MPH
- TO1901-04 TRAFFIC CONTROL DEVICES

## SPRAY LIMITS

ROUTE	COUNTIES	MILE POST	DESCRIPTION	MILES
I-57	FAYETTE/CLAY/EFF/SHELBY/CUMB/COLES	137 TO 201	FAYETTE/MARION CO. LINE TO COLES/DOUGLAS CO. LINE	64
I-64	WAYNE	91 TO 116	JEFFERSON/WAYNE CO. LINE TO WAYNE/WHITE CO. LINE	25
I-70	FAYETTE/EFF/CUMB/CLARK	53 TO 155	FAYETTE/BOND CO. LINE TO INDIANA STATE LINE	102
TOTALS:				191

**NOTES:**

WEED SPRAY SHALL BE APPLIED ON SELECTED AREAS ALONG I-57, I-64, & I-70 AS DIRECTED BY THE ENGINEER. IT IS THE INTENT TO USE THE ENTIRE QUANTITY WITHIN THE MILEPOSTS SHOWN.

APPLICATION SHALL BE IN THE MEDIAN AND FROM EDGE OF SHOULDER TO THE RIGHT-OF-WAY LINE.

STATE OF ILLINOIS DEPARTMENT OF TRANSPORTATION				INDEX OF SHEETS AND SPRAY LIMITS				*07 WEED CONTROL SPRAYING 2015					
FILE NAME =	USER NAME =	DESIGNED -	REVISED -	SCALE: N/A		SHEET 1 OF 1 SHEETS		STA. TO STA.					
o:\pwork\pwork\stetfennk\0409649\0	74695-ent-index.dgn	DRAWN -	REVISED -										
	PLOT SCALE = 100.0000' / 1" =	CHECKED -	REVISED -										
Default	PLOT DATE = 10/22/2014	DATE -	REVISED -										
								F.A. RTE.	SECTION	COUNTY	TOTAL SHEETS	SHEET NO.	
								VAR	*	VARIOUS	7	2	
										CONTRACT NO. 74695			
								ILLINOIS FED. AID PROJECT					





FAYETTE COUNTY LOCATION MAP

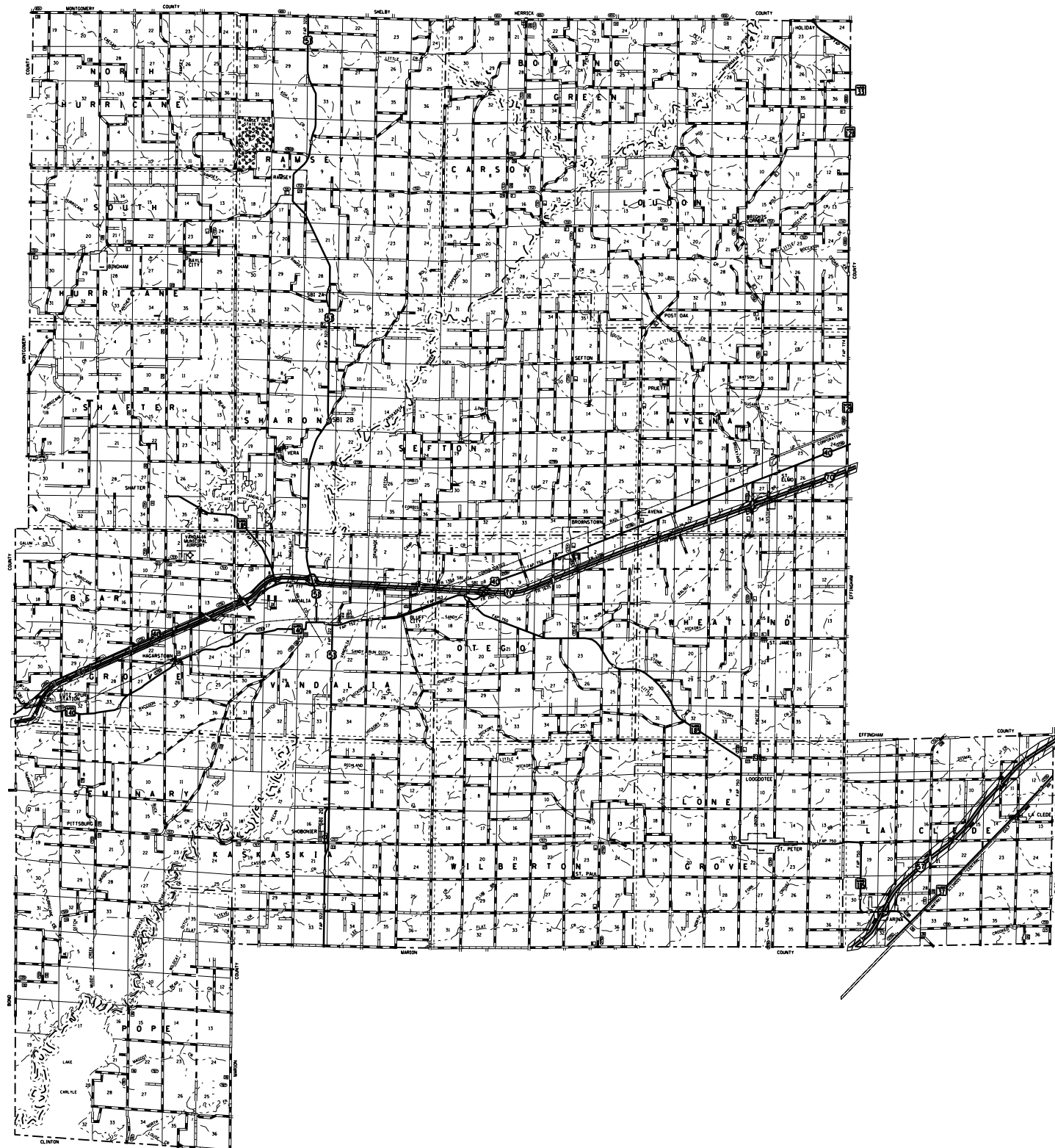

EFFINGHAM COUNTY LOCATION MAP

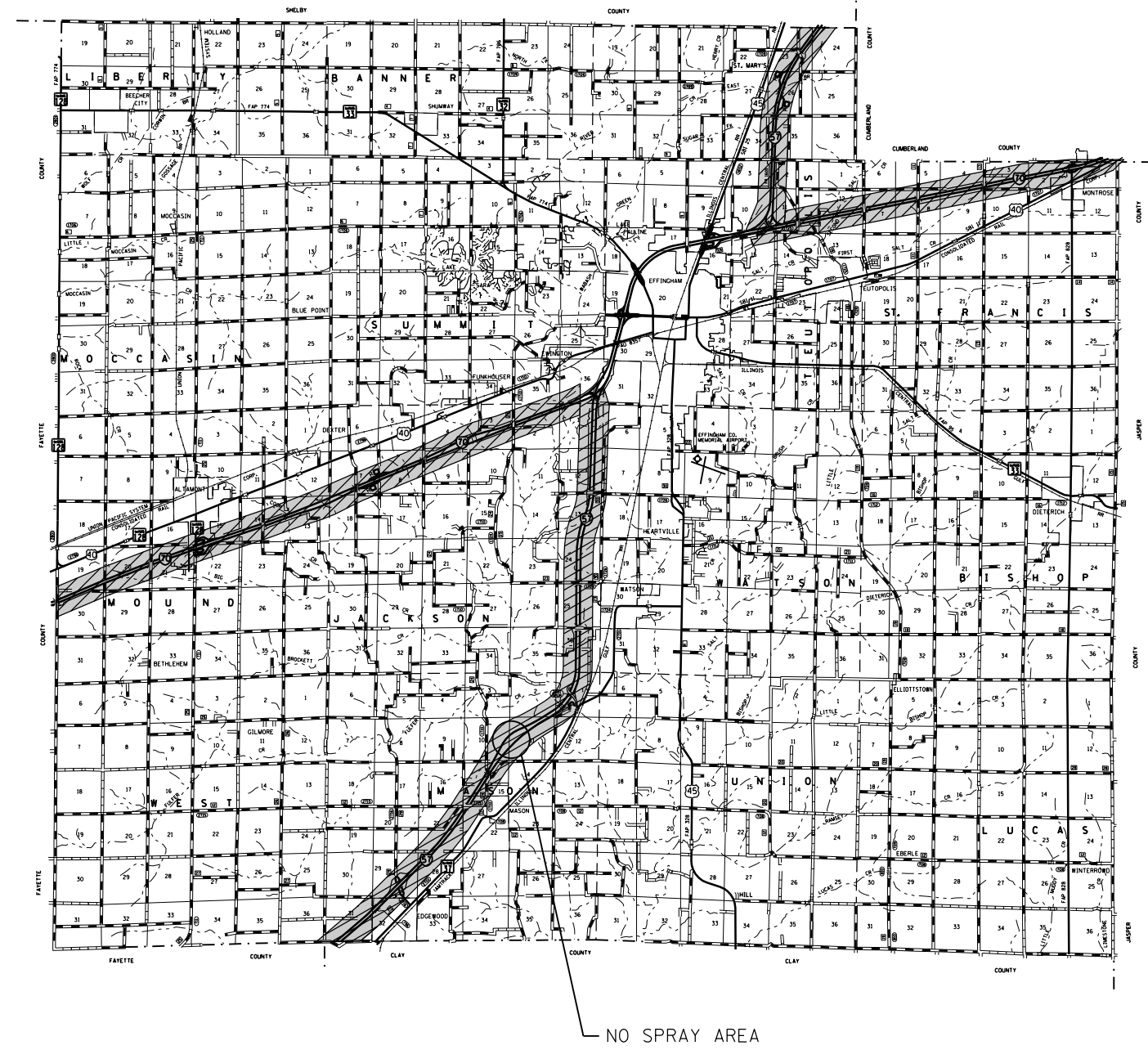

FILE NAME =	USER NAME = steffennk	DESIGNED -	REVISED -
c:\pw_work\p\dot\stefennk\d0409649\074695-sht-locations.dgn		DRAWN -	REVISED -
Default	PLOT SCALE = 100.0000' / in.	CHECKED -	REVISED -
	PLOT DATE = 10/22/2014	DATE -	REVISED -

STATE OF ILLINOIS  
DEPARTMENT OF TRANSPORTATION

SCALE: N/A		SHEET 1 OF 4 SHEETS		STA.	TO STA.
<b>FAYETTE AND EFFINGHAM COUNTIES LOCATIONS MAPS</b>					
*07 WEED CONTROL SPRAYING 2015					
F.A. RTE.	SECTION	COUNTY	TOTAL SHEETS	SHEET NO.	
VAR	.	VARIOUS	7	4	
CONTRACT NO. 74695					
ILLINOIS FED. AID PROJECT					

SHELBY COUNTY LOCATION MAP

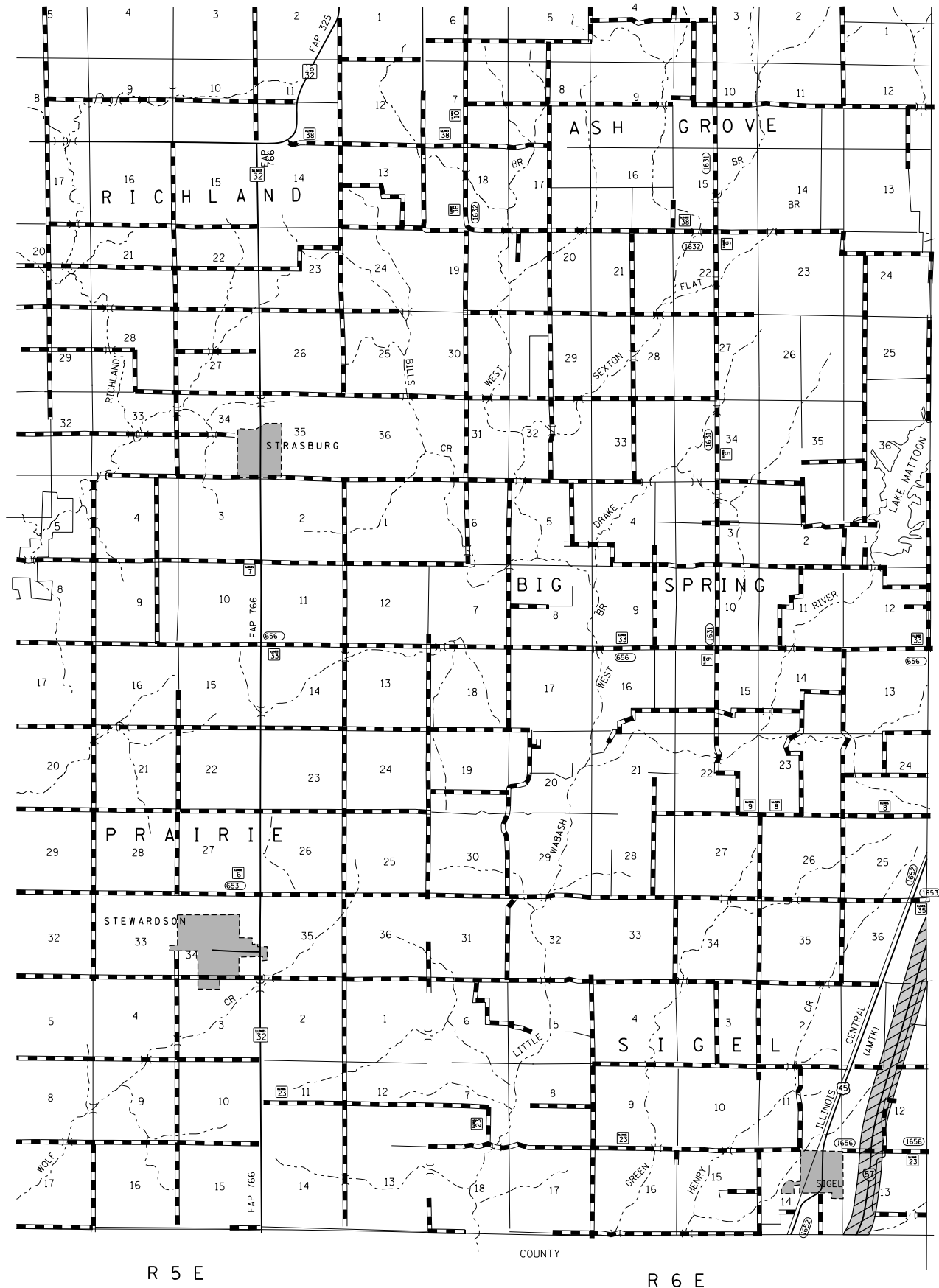

CUMBERLAND COUNTY LOCATION MAP

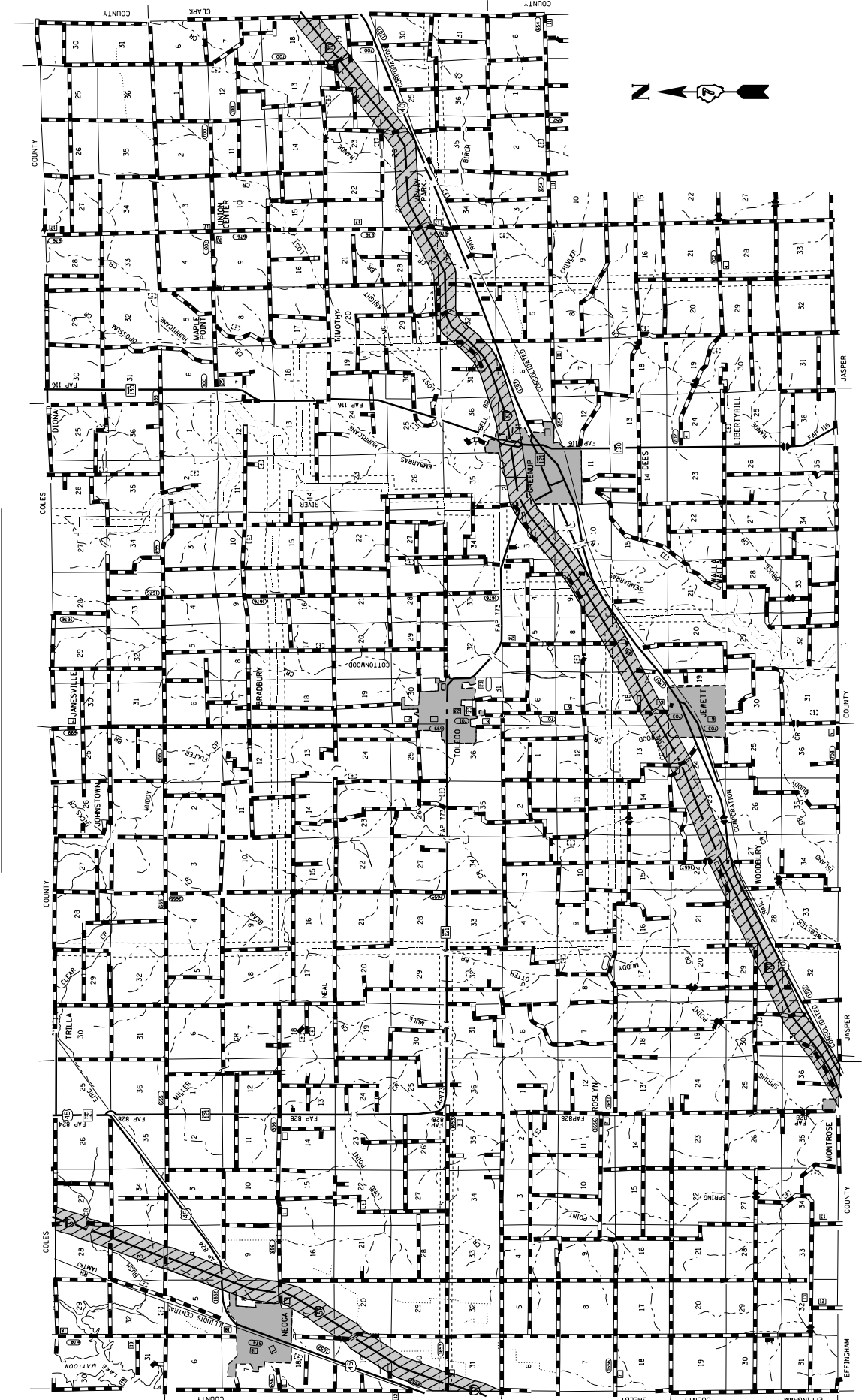

FILE NAME =	USER NAME = steffenk	DESIGNED -	REVISED -
ei:\pw\work\puidot\stefenk\d0409649\074695-sht-locations.dgn		DRAWN -	REVISED -
Default	PLOT SCALE = 100.0000' / in.	CHECKED -	REVISED -
	PLOT DATE = 10/22/2014	DATE -	REVISED -

STATE OF ILLINOIS  
DEPARTMENT OF TRANSPORTATION

SCALE: N/A		SHEET 2 OF 4 SHEETS		STA.	TO STA.
SHELBY AND CUMBERLAND COUNTIES LOCATIONS MAPS		F.A. RTE.	SECTION	COUNTY	TOTAL SHEETS
		VAR	•	VARIETY	7
				CONTRACT NO.	74695
ILLINOIS FED. AID PROJECT					

COLES COUNTY LOCATION MAP

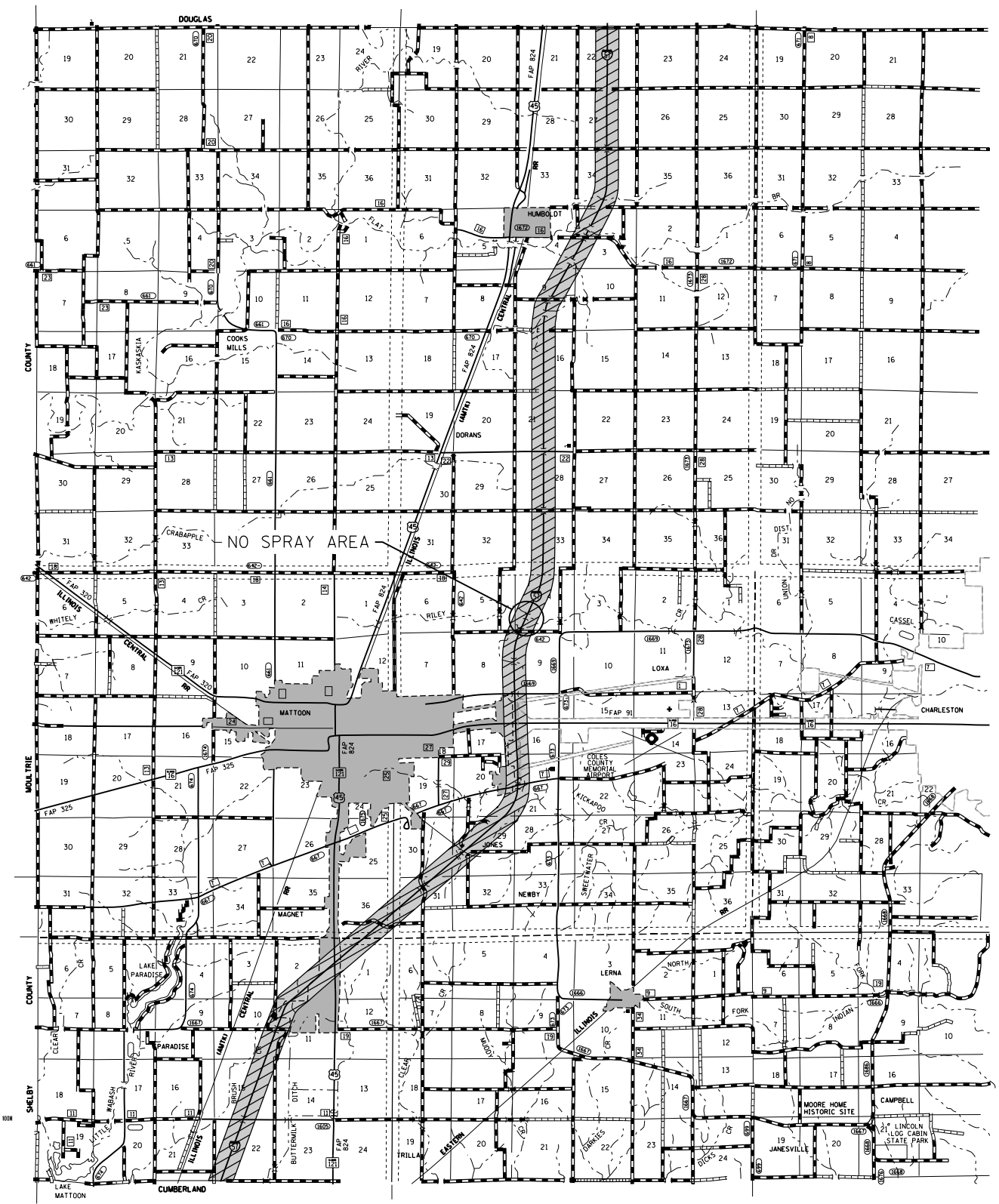

CLARK COUNTY LOCATION MAP

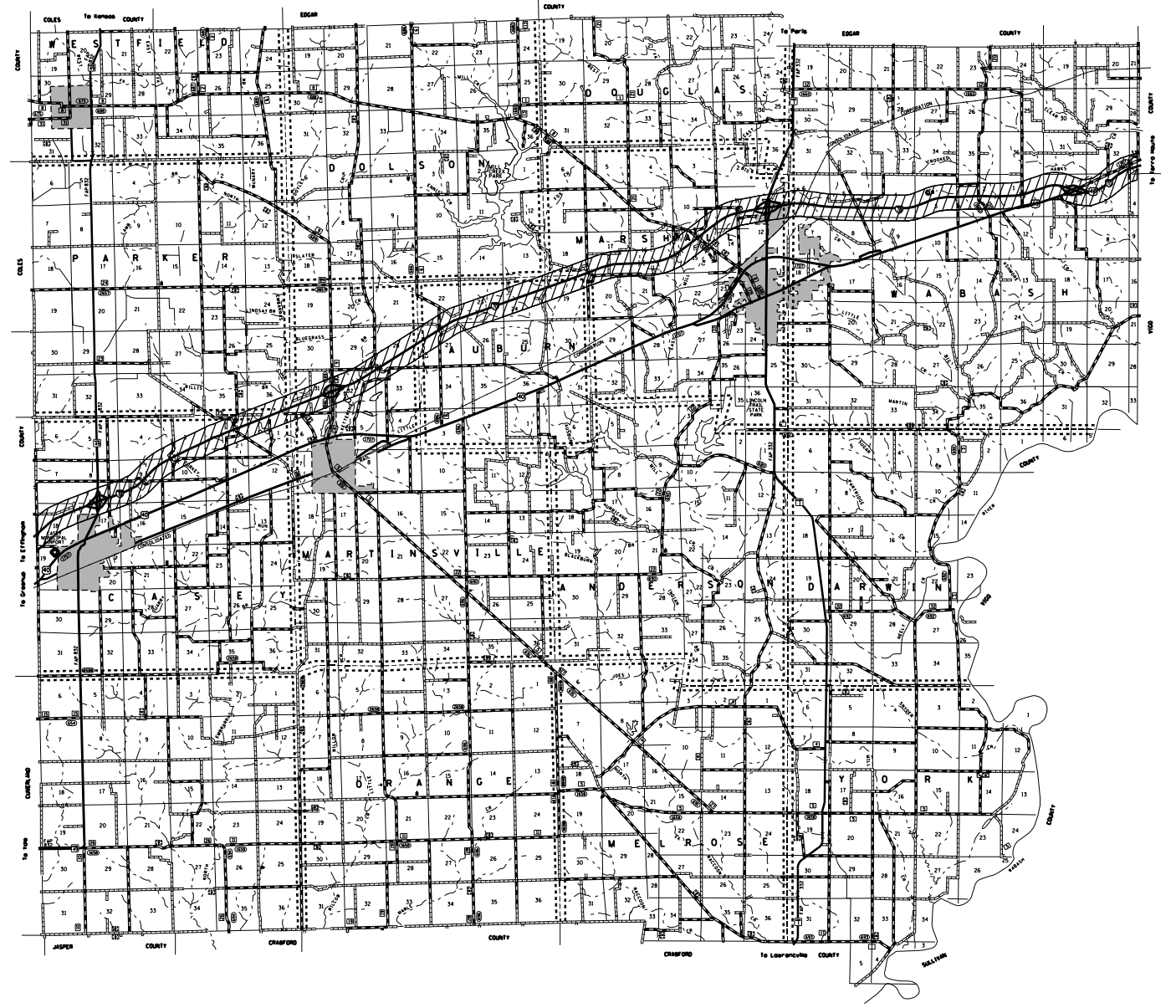

FILE NAME =	USER NAME = steffennk	DESIGNED -	REVISED -
c:\pw_work\pwidot\steffennk\d0409649\074695-sht-locations.dgn		DRAWN -	REVISED -
Default	PLOT SCALE = 100.0000' / in.	CHECKED -	REVISED -
	PLOT DATE = 10/22/2014	DATE -	REVISED -

STATE OF ILLINOIS  
DEPARTMENT OF TRANSPORTATION

COLES AND CLARK COUNTIES LOCATIONS MAPS				*07 WEED CONTROL SPRAYING 2015	
F.A. RTE.	SECTION	COUNTY	TOTAL SHEETS	SHEET NO.	
VAR	.	VARIOUS	7	6	
			CONTRACT NO. 74695		
SCALE: N/A	SHEET 3	OF 4 SHEETS	STA.	TO STA.	
ILLINOIS FED. AID PROJECT					

WAYNE COUNTY LOCATION MAP

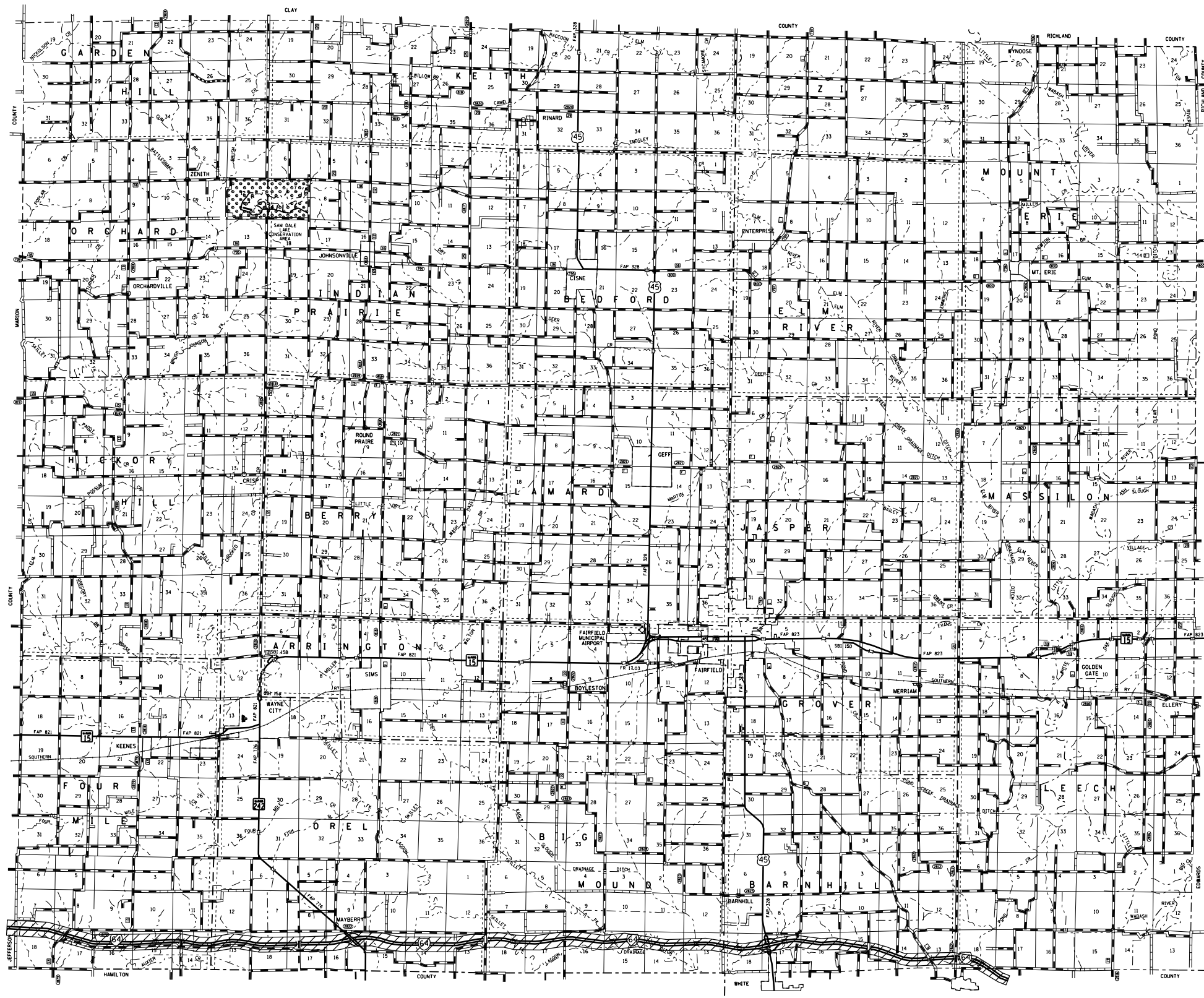

FILE NAME =	USER NAME = steffenk	DESIGNED -	REVISED -
c:\pw_work\pwork\steffenk\d0409649\074695-sht-locations.dgn		DRAWN -	REVISED -
Default	PLOT SCALE = 100.0000' / in.	CHECKED -	REVISED -
	PLOT DATE = 10/22/2014	DATE -	REVISED -

STATE OF ILLINOIS  
DEPARTMENT OF TRANSPORTATION

SCALE: N/A SHEET 4 OF 4 SHEETS STA. TO STA.

WAYNE COUNTY  
LOCATIONS MAPS

•07 WEED CONTROL SPRAYING 2015

F.A. RTE.	SECTION	COUNTY	TOTAL SHEETS	SHEET NO.
VAR	•	WAYNE	7	7
			CONTRACT NO. 74695	
ILLINOIS FED. AID PROJECT				