

STATE OF ILLINOIS
DEPARTMENT OF TRANSPORTATION

FA RTE.	SECTION	COUNTY	TOTAL SHEETS	SHEET NO.
VAR	D5 SWZT 2020-1	VARIOUS	4	1
		BLUMSB	CONTRACT NO. 70E60	

FOR INDEX OF SHEETS, SEE SHEET NO. 2

PROPOSED HIGHWAY PLANS

VARIOUS ROUTES
SECTION D5 SWZT 2020-1
SMART TRAFFIC MONITORING
SYSTEM PROJECT: HSIP-AQ6T(564)
VARIOUS COUNTIES

C-95-072-20

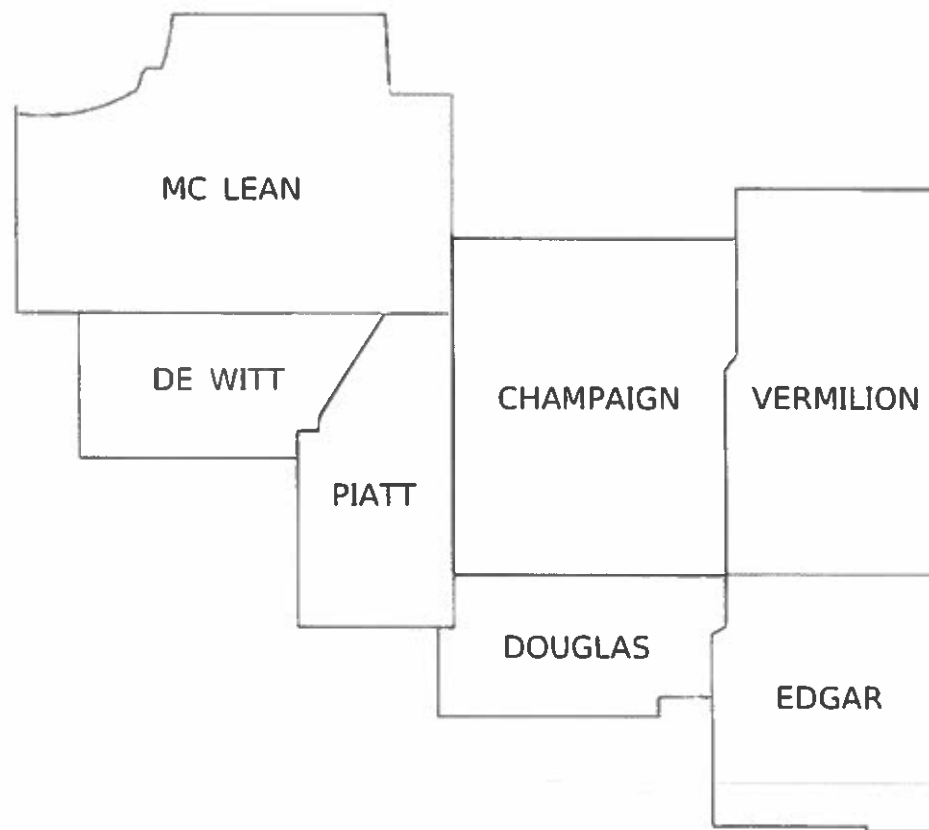

FULL SIZE PLANS HAVE BEEN PREPARED USING STANDARD ENGINEERING SCALES. REDUCED SIZED PLANS WILL NOT CONFORM TO STANDARD SCALES. IN MAKING MEASUREMENTS ON REDUCED PLANS, THE ABOVE SCALES MAY BE USED.

J.U.L.I.E.
JOINT UTILITY LOCATION INFORMATION FOR EXCAVATORS
1-800-892-0123
OR 811

PROJECT ENGINEER: JASON W. STULTS
DESIGN SQUAD LEADER: CLARE CURTIN
DESIGNER: ABIMBOLA OLAJOYEGBE
PHONE: (217) 465-4181
CONTRACT NO. 70E60

STATE OF ILLINOIS
DEPARTMENT OF TRANSPORTATION

SUBMITTED 01/29 2020
Kenila Banatswa
REGIONAL ENGINEER

March 20 2020
[Signature]
ENGINEER IN CHARGE DESIGN AND ENVIRONMENT

March 20 2020
[Signature]
DIRECTOR OF HIGHWAYS PROJECT IMPLEMENTATION

PRINTED BY THE AUTHORITY
OF THE STATE OF ILLINOIS

TYPICAL SMART TRAFFIC MONITORING SYSTEM

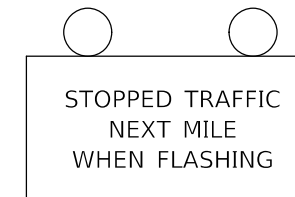
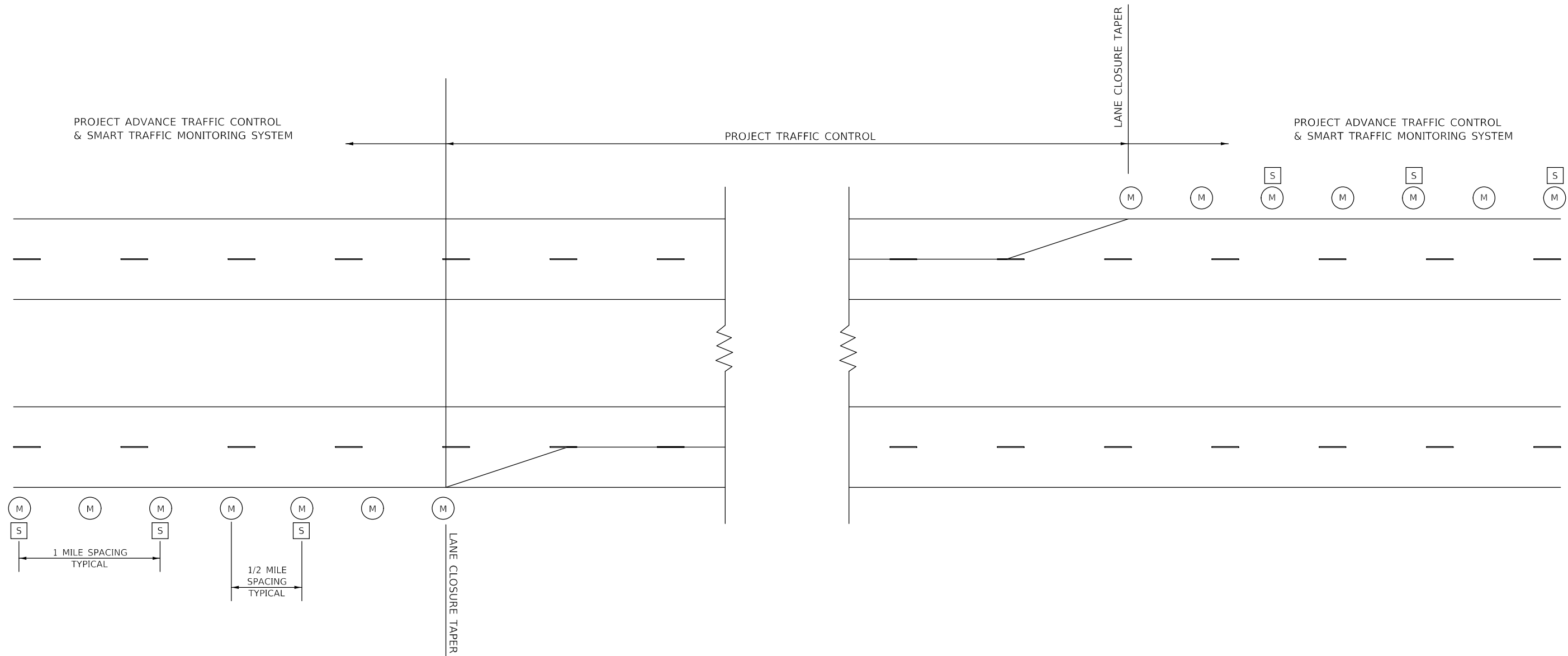

PAID FOR AS REAL-TIME TRAFFIC CONTROL WARNING SIGN

96" X 48" WITH MIN. 12" BEACONS

- (M) SMART TRAFFIC MONITORING DEVICE
- (S) CHANGEABLE MESSAGE SIGN, SPECIAL OR REAL-TIME TRAFFIC CONTROL WARNING SIGN - AS DIRECTED BY THE ENGINEER

ACTUAL QUANTITIES OF DEVICES MAY BE CHANGED AS DIRECTED BY ENGINEER

MODEL: 4100ELM1MFE
FILE NAME: P:\pub\mcom\ad\illinois\pwr\DOT\Documents\DOT Office\District 5\Projects\D570E60\CADD\data\CAD\raw\pwr\summary_of_quantity.dgn

USER NAME = CurtinCB	DESIGNED -	REVISED -
	DRAWN -	REVISED -
PLOT SCALE = 40,0000 ' / in.	CHECKED -	REVISED -
PLOT DATE = 1/29/2020	DATE -	REVISED -

**STATE OF ILLINOIS
DEPARTMENT OF TRANSPORTATION**

TYPICAL SMART TRAFFIC MONITORING SYSTEM

SCALE: SHEET 1 OF 1 SHEETS STA. TO STA.

F.A. RTE.	SECTION	COUNTY	TOTAL SHEETS	SHEET NO.
VAR.	D5 SWZT 2020-1	VARIOUS	4	4
			CONTRACT NO. 70E60	
		ILLINOIS	FED. AID PROJECT	