

INDEX OF SHEETS 04-24-2020 LETTING ITEM 188

1. COVER SHEET
2. QUANTITY SUMMARY AND GENERAL NOTES
3. QUANTITY TABULATIONS
4. TYPICAL SECTIONS
5. TYPICAL DETAILS
6. REMOVAL PLAN
7. McARTHUR SCHOOL SIDEWALK P & P
8. GRANT STREET SIDEWALK PLAN
9. McARTHUR SCHOOL SIDEWALK X-SECTIONS
10. McARTHUR SCHOOL AND GRANT ST. SIDEWALK X-SECTIONS

Highway Standards

- 000001-07 Standard Symbols, Abbreviations and Patterns
- 001001-02 Areas of Reinforcement Bars
- 001006 Decimal of an Inch and of a Foot
- 280001-07 Temporary Erosion Control Systems
- 424016-05 Mid-Block Curb Ramps for Sidewalks
- 424026-03 Entrance / Alley Pedestrian Crossings
- 424031-02 Median Pedestrian Crossings
- 606001-07 Concrete Curb Type B and Combination Concrete Curb and Gutter
- 664001-02 Chain Link Fence
- 665001-02 Woven Wire Fence
- 701301-04 Lane Closure, 2L, 2W, Short Time Operations
- 701801-06 Sidewalk, Corner or Crosswalk Closure
- 701901-08 Traffic Control Devices
- 780001-05 Typical Pavement Markings
- BLR 17-4 Traffic Control Devices - Day Labor Construction
- BLR 18-6 Traffic Control Devices - Day Labor Maintenance

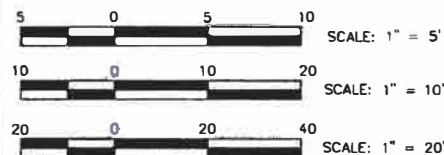

FULL SIZE PLANS HAVE BEEN PREPARED USING STANDARD ENGINEERING SCALES. REDUCED SIZED PLANS WILL NOT CONFORM TO STANDARD SCALES. IN MAKING MEASUREMENTS ON REDUCED PLANS, THE ABOVE SCALES MAY BE USED

JULIE.
JOINT UTILITY LOCATION INFORMATION FOR EXCAVATION
1-800-892-0123 OR 811

UTILITY NOTE

THE locations of those buried and above ground utilities shown are approximate, are shown for contractor informational use only, and are not to be referenced for construction purposes. The implied presence or absence of utilities is not to be construed by the owner, engineer, contractor, or subcontractors to be an accurate and complete representation of utilities that may or may not exist on the construction site. Buried and above ground utility location, identification, and marking are the sole responsibility of the contractor. Rerouting, disconnection, protection, etc. of any utility must be coordinated between the contractor, utility company and owner. Site safety, including the avoidance of hazards associated with buried and aboveground utilities, remains the sole responsibility of the contractor.

CONTRACT NO. 89771 CATALOG NO. 035841-00

UTILITIES

WATER:
CITY OF MACOMB
(309) 836-3916

SANITARY SEWER:
CITY OF MACOMB
(309) 833-2088

TELEPHONE:
FRONTIER
COMMUNICATIONS
(217) 243-0299

GAS
AMEREN
(888) 659-4540

TELEPHONE /
FIBER:
McDONOUGH
TELEPHONE
(309) 778-3211

ELECTRIC:
AMEREN
(888) 789-2477

CABLE
TELEVISION:
COMCAST
(309) 833-4539

STATE OF ILLINOIS
DEPARTMENT OF TRANSPORTATION
**PROPOSED
HIGHWAY PLANS**
GRANT STREET
SECTION 19-00157-00-SW
PROJECT #KQ0U(544)
**SAFE ROUTES TO SCHOOL
MACOMB, ILLINOIS**

McDONOUGH COUNTY --- C-94-009-20
CITY OF MACOMB PROJECT #508-2018

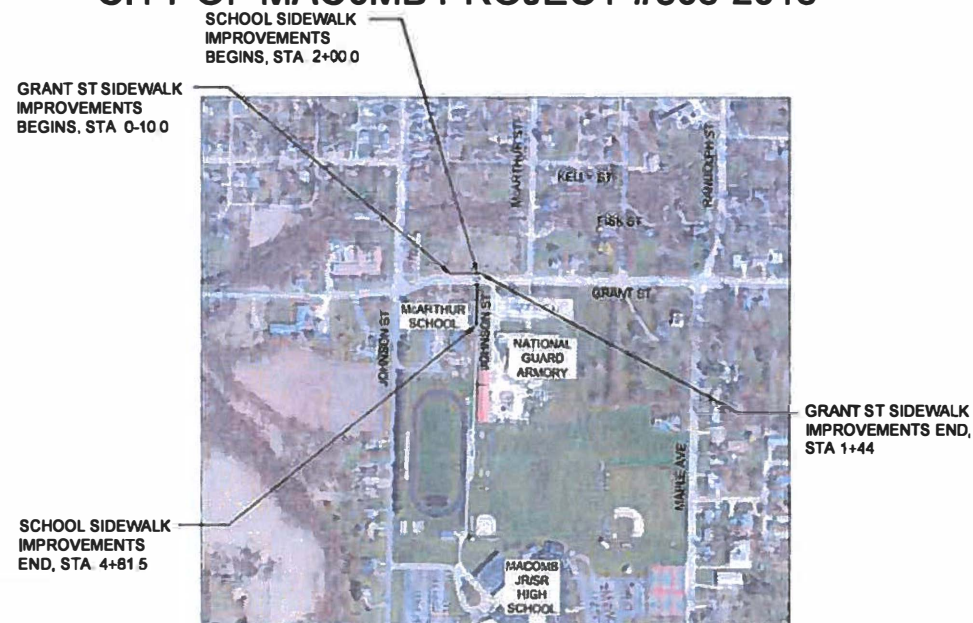

LOCATION MAP

(NOT TO SCALE)
GROSS LENGTH OF PROJECT = 435.5 FT = 0.082 MILE
NET LENGTH OF PROJECT = 435.5 FT = 0.082 MILE



Signature: *[Signature]*
Date: 10/24/19
Exp. Date: 11/30/20



Signature: *[Signature]*
Date: 3-9-2020
Exp. Date: 11-30-2021

RETAINING WALL COVERED BY THIS SEAL

TR	SECTION	COUNTY	TOTAL SHEETS	SHEET NO.
	19-00157-00-SW	McDONOUGH	10	1
McARTHUR ST & GRANT ST		CONTRACT NO 89771		
ILLINOIS				

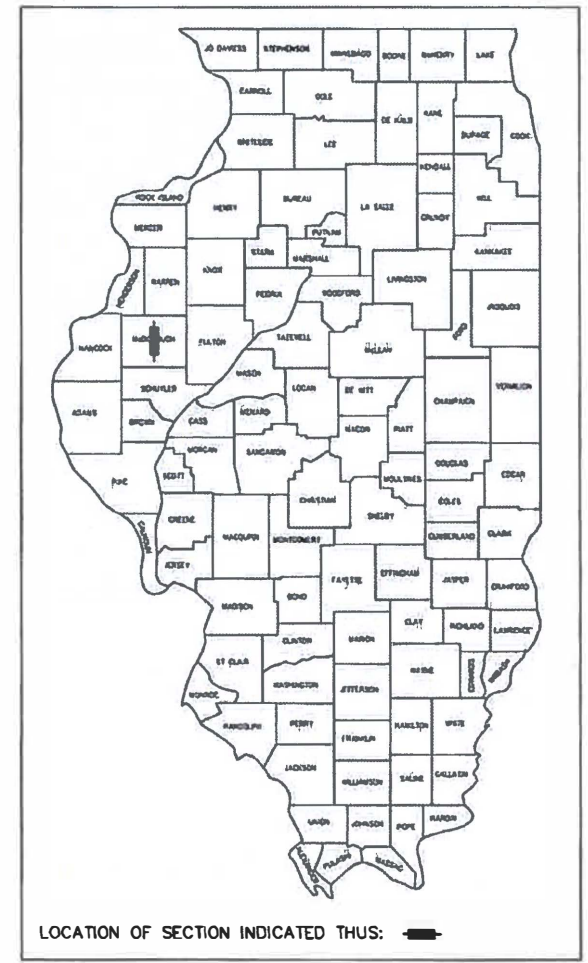

LOCATION OF SECTION INDICATED THIS:

APPROVED 3/9 2020
[Signature]
LOCAL AGENCY/ CITY OF MACOMB

PASSED 03-12 2020
[Signature]
DISTRICT 4 ENGINEER OF LOCAL ROADS AND STREETS
RELEASED FOR BID BASED ON LIMITED REVIEW March 13 2020
[Signature]
REGION 3 ENGINEER

STATE OF ILLINOIS
DEPARTMENT OF TRANSPORTATION

**PRINTED BY THE AUTHORITY
OF THE STATE OF ILLINOIS**

IMEG CORP. has adopted safety procedures for its employees who provide professional engineering and surveying services. A copy of these procedures is available from the safety officer. IMEG CORP. personnel are not trained in contractor (construction) safety and compliance procedures. The methods and means to comply with construction site safety are the sole responsibility of the contractor.

714 E. Jackson Street
Macomb, Illinois 61455
PH. (309) 833-4594
www.imegcorp.com

SUMMARY OF QUANTITIES

IDOT PAY ITEM NUMBER	PAY ITEM NAME	UNIT	QUANTITY
20200100	EARTH EXCAVATION	CU YD	1154
20201200	REMOVAL AND DISPOSAL OF UNSUITABLE MATERIAL	CU YD	1154
21101505	TOPSOIL EXCAVATION AND PLACEMENT	CU YD	260
25000110	SEEDING, CLASS 1A	ACRE	0.5
25000400	NITROGEN FERTILIZER NUTRIENT	POUND	41
25000500	PHOSPHORUS FERTILIZER NUTRIENT	POUND	41
25000600	POTASSIUM FERTILIZER NUTRIENT	POUND	41
25100125	MULCH, METHOD 3	ACRE	0.5
28000400	PERIMETER EROSION BARRIER	FOOT	455
42400100	PORTLAND CEMENT CONCRETE SIDEWALK 4 INCH	SQ FT	3460
44000100	PAVEMENT REMOVAL	SQ YD	32
44000500	COMBINATION CURB AND GUTTER REMOVAL	FOOT	73
44000600	SIDEWALK REMOVAL	SQ FT	2562
52200800	SEGMENTAL CONCRETE BLOCK WALL	SQ FT	689
60255500	MANHOLES TO BE ADJUSTED	EACH	1
60600605	CONCRETE CURB, TYPE B	FOOT	74
60604400	COMBINATION CONCRETE CURB AND GUTTER, TYPE B-6.18	FOOT	73
60625610	ISLAND PAVEMENT 8"	SQ YD	30
△ 66400305	CHAIN LINK FENCE 6'	FOOT	165
△ 66900200	NON-SPECIAL WASTE DISPOSAL	CU YD	274
△ 66900530	SOIL DISPOSAL ANALYSIS	EACH	4
△ 66901001	REGULATED SUBSTANCES PRE-CONSTRUCTION PLAN	L SUM	1
△ 66901003	REGULATED SUBSTANCES FINAL CONSTRUCTION REPORT	L SUM	1
△ 69901006	REGULATED SUBSTANCES MONITORING	CAL DA	3
67100100	MOBILIZATION	L SUM	1
△ 78009004	MODIFIED URETHANE PAVEMENT MARKING - LINE 4"	FOOT	712
△ 78009006	MODIFIED URETHANE PAVEMENT MARKING - LINE 6"	FOOT	56
△ 78009012	MODIFIED URETHANE PAVEMENT MARKING - LINE 12"	FOOT	128
X0327980	PAVEMENT MARKING REMOVAL - WATER BLASTING	SQ FT	160
X0800003	COARSE AGGREGATE BACKFILL (SPECIAL)	CU YD	4
△ X2200020	FENCE REMOVAL AND REINSTALLATION	FOOT	223
X4240800	DETECTABLE WARNINGS (SPECIAL)	SQ FT	52
X7010216	TRAFFIC CONTROL AND PROTECTION (SPECIAL)	L SUM	1
Z0012455	CONCRETE STEP REMOVAL	EACH	1
Z0013798	CONSTRUCTION LAYOUT	L SUM	1
Z0022800	FENCE REMOVAL	FOOT	165

△ SPECIALTY ITEMS

GENERAL NOTES

1. ALL WORK SHALL BE IN CONFORMANCE WITH APPLICABLE SECTIONS OF THE ILLINOIS DEPARTMENT OF TRANSPORTATION'S STANDARD SPECIFICATIONS FOR ROAD AND BRIDGE CONSTRUCTION ADOPTED APRIL 1, 2016 AND SUPPLEMENTAL SPECIFICATIONS AND RECURRING SPECIAL PROVISIONS ADOPTED JANUARY 1, 2020.
2. THE LOCATIONS OF EXISTING AND PROPOSED UTILITIES AS SHOWN ON THE PLANS ARE BASED UPON CAREFUL FIELD INVESTIGATION AND THE BEST INFORMATION AVAILABLE BUT THEY ARE NOT GUARANTEED. ALL UTILITY LOCATIONS SHOWN ON THE CROSS SECTIONS ARE BASED ON APPROXIMATE DEPTH SUPPLIED BY THE UTILITY COMPANY. IT IS THE CONTRACTORS RESPONSIBILITY TO ASCERTAIN THE EXACT LOCATIONS FROM THE UTILITY COMPANY AND BY FIELD INVESTIGATION PRIOR TO EXCAVATION FOR ROADWAY, CURB AND GUTTER, SIDEWALKS, AND OTHER ITEMS. THE CONTRACTOR SHALL BE RESPONSIBLE FOR LOCATING AND PROTECTING UTILITY PROPERTY DURING CONSTRUCTION OPERATIONS AS OUTLINED IN ARTICLE 107.31 OF THE STANDARD SPECIFICATIONS. THE J.U.L.I.E. NUMBER IS 1-800-892-0123. ALL EXISTING PUBLICLY AND PRIVATELY OWNED UTILITIES REQUIRING ADJUSTMENT WILL BE MADE BY THE UTILITY COMPANY INVOLVED. WHERE NO PROVISIONS HAVE BEEN MADE FOR ADJUSTMENTS ON THE PLANS, NO ADDITIONAL COMPENSATION WILL BE ALLOWED DUE TO DELAYS OR INCONVENIENCE CAUSED BY SAID UTILITY ADJUSTMENTS.
3. ACCESS MUST BE MAINTAINED TO ALL EXISTING PROPERTIES DURING CONSTRUCTION PER ARTICLE 107.09 UNLESS ARRANGEMENTS ARE MADE IN WRITING BY THE CONTRACTOR WITH THE PROPERTY OWNERS WITH A COPY TO THE ENGINEER FOR SHORT TERM CLOSURES.
4. WHERE SURVEY MONUMENTS ARE ENCOUNTERED, THE ENGINEER SHALL BE NOTIFIED BEFORE SUCH MONUMENTS ARE REMOVED. THE CONTRACTOR SHALL PROTECT AND PRESERVE PROPERTY MARKERS AND MONUMENTS UNTIL THE OWNER, AN AUTHORIZED SURVEYOR OR AGENT HAS WITNESSED OR OTHERWISE REFERENCED THEIR LOCATION.
5. SUFFICIENT QUANTITY OF STRIPPED MATERIAL MEETING THE TOPSOIL REQUIREMENTS OF ART 1081.05 SHALL BE SALVAGED AND STOCKPILED ON SITE FOR PLACEMENT ON GRADED SLOPES AND SHALL BE PAID FOR AT THE CONTRACT UNIT PRICE FOR TOPSOIL EXCAVATION AND PLACEMENT. EXCESS MATERIAL FROM STRIPPING OPERATIONS SHALL BE DISPOSED OF AS DIRECTED IN THE SPECIAL PROVISIONS FOR THIS PROJECT AND SHALL BE PAID FOR AT THE CONTRACT PRICE FOR REMOVAL AND DISPOSAL OF UNSUITABLE MATERIAL.
6. THE CONTRACTOR MAY BE REQUIRED TO CONDUCT SOME OF HIS GRADING OPERATIONS AROUND TRANSMISSION POLES AND UNDER TRANSMISSION LINES. THE ADDED COST OF SO DOING SHALL BE CONSIDERED INCLUDED IN THE COST OF THE VARIOUS BID ITEMS BEING CONSTRUCTED.
7. ALL ELEVATIONS SHOWN ON THE PLANS ARE ESTABLISHED FROM U.S.G.S. MEAN SEA LEVEL DATUM.
8. THE CONTRACTOR SHALL SUBMIT TO THE ENGINEER A SATISFACTORY PROGRESS SCHEDULE AND CRITICAL PATH SCHEDULE WHICH SHALL SHOW THE PROPOSED SEQUENCE OF WORK AT THE TIME OF THE PRE-CONSTRUCTION MEETING.

ENVIRONMENTAL REVIEWS

PRIOR TO THE USE OF ANY PROPOSED BORROW AREAS, USE AREAS (TEMPORARY ACCESS ROADS, DETOURS, RUN-AROUNDS, ETC.) AND/OR WASTE AREAS, THE CONTRACTOR SHALL FILE THE REQUIRED ENVIRONMENTAL RESOURCE REQUEST SURVEYS ACCORDING TO SECTION 107.22 OF THE STANDARD SPECIFICATIONS. THESE SURVEYS ARE REQUIRED IN ORDER FOR THE DEPARTMENT TO CONDUCT CULTURAL AND BIOLOGICAL RESOURCE SURVEYS FOR THE PROPOSED SITE.

THE REQUIRED ENVIRONMENTAL RESOURCE DOCUMENTATION SHALL INCLUDE THE FOLLOWING:

- BDE FORM 2289 (CULTURAL AND NATURAL RESOURCE REVIEW OF BORROW AREA)
- BDE FORM 2290 (WASTE/USE AREA REVIEW)
- A LOCATION MAP SHOWING THE SIZE LIMITS AND LOCATION OF THE USE AREA
- COLOR PHOTOGRAPHS DEPICTING THE USE AREA
- BORROW AREA ENTRY AGREEMENT FORM -D4 PI0101

PRIOR TO ANY WASTE MATERIALS BEING REMOVED FROM THE CONSTRUCTION SITE THE REQUIRED ENVIRONMENTAL RESOURCE SURVEYS WILL NEED TO BE OBTAINED AND FILED BY THE CONTRACTOR. EXCESS WASTE PRODUCTS REMOVED FROM THE CONSTRUCTION SITE SHALL BE DISPOSED OF AS REQUIRED IN SECTION 202.03 OF THE STANDARD SPECIFICATIONS.

ANY PROTRUDING METAL BARS SHALL BE REMOVED PRIOR TO THE DISPOSAL OF BROKEN CONCRETE AT APPROVED DISPOSAL SITES.

PLEASE NOTE THAT A MINIMUM OF FOUR WEEKS SHALL BE ALLOWED FOR THE DISTRICT TO OBTAIN THE REQUIRED WASTE SITE ENVIRONMENTAL CLEARANCES AND SIX WEEKS FOR THE REQUIRED BORROW SITE ENVIRONMENTAL CLEARANCES.

BENCH MARKS:

1) CAP BOLT BETWEEN "VILLE" & "ALA" ON FIRE HYDRANT AT NE CORNER OF GRANT AND McARTHUR ELEVATION = 674.60

2) SOUTH CAP BOLT MARKED "X" ON FIRE HYDRANT AT NE CORNER OF McARTHUR AND KELLY ELEVATION = 668.02

FILE NAME = 18003403-MA-SRTS-PL0T.dwg



DESIGNED -- MJC	REVISED -- 03-06-20
DRAWN -- MPS/TAB	REVISED -- 03-23-20
CHECKED -- MJC	REVISED --
DATE -- 01-03-20	REVISED --

STATE OF ILLINOIS
DEPARTMENT OF TRANSPORTATION

QUANTITY SUMMARY AND
GENERAL NOTES

TR	SECTION	COUNTY	TOTAL SHEETS	SHEET NO.
--	19-00157-00-SW	McDONOUGH	10	2
McARTHUR ST & GRANT ST		CONTRACT NO. 89771		
ILLINOIS				

EARTHWORK TABULATION						
	EARTH EXC.	EMBANKMENT	TOPSOIL EXC. & PLACE	TOPSOIL STRIPPING	EARTH EXC. TOTAL	WASTE
LOCATION	CU YD	CU YD	CU YD	CU YD	CU YD	CU YD
McARTHUR SCHOOL SIDEWALK	1036		212	320	1145	1145
GRANT STREET SIDEWALK	18	0	48	39	9	9
TOTAL	1054	0	260	359	1154	1154

WASTE WAS CALCULATED BY SUBTRACTING THE EMBANKMENT CU. YD. QUANTITY x 1.25 FROM THE EARTH EXCAVATION CU. YD. QUANTITY. WASTE EXCAVATION SHALL BE PAID FOR AT THE CONTRACT PRICE PER CU. YD. FOR REMOVAL AND DISPOSAL OF UNSUITABLE MATERIAL. EMBANKMENT WILL NOT BE MEASURED FOR PAYMENT.

SEEDING SUMMARY					
	SEEDING CL 1A	NITROGEN FERT NUTRIENT	PHOSPORUS FERT NUTRIENT	POTASSIUM FERT NUTRIENT	MULCH METHOD 3
LOCATION	ACRES	POUND	POUND	POUND	ACRE
McARTHUR SCHOOL SIDEWALK					
LT STA 2+56.5 TO STA 4+85	0.3	27	27	27	0.3
RT STA 2+56.5 TO STA 3+36	0.05	4.5	4.5	4.5	0.05
RT STA 3+36 TO STA 4+85	0.08	7.2	7.2	7.2	0.08
GRANT STREET SIDEWALK					
STA 0-10 TO STA 1+50	0.03	2.7	2.7	2.7	0.03
TOTAL	0.5	41	41	41	0.5

PERIMETER EROSION BARRIER	
LOCATION	FEET
McARTHUR SCHOOL SIDEWALK	
LT STA 2+57 TO LT STA 4+86	280
GRANT STREET SIDEWALK	
LT STA 0-10 TO LT STA 1+65	175
TOTAL	455

PAVEMENT RELATED ITEMS				
	CONCRETE CURB TY B, 6"	CCC&G TY B-6.18	ISLAND PAVEMENT 8"	COARSE AGGREGATE BACKFILL (SPL)
LOCATION	FT	FT	SQ YD	CU YD
McARTHUR SCHOOL SIDEWALK				
STA 2+24.7 TO STA 2+35.7	74		29.5	4
12.5' RT TO 10.5' RT STA 2+50		23		
GRANT STREET SIDEWALK				
STA 0-10 TO STA 0+01		11		
38' RT STA 0-16 TO STA 0+02		18		
STA 1+23 TO STA 1+44		21		
TOTAL	74	73	30	4

PC CONCRETE SIDEWALK		
	PC CONC SIDEWALK 4"	DETECTABLE WARN (SPL)
LOCATION	SQ FT	SQ FT
McARTHUR SCHOOL SIDEWALK		
STA 2+25 TO STA 2+35		24
STA 2+50.4 TO STA 2+56.4	138	16
STA 2+56.4 TO STA 4+81.5	1801	
27.5' RT STA 3+36 TO STA 4+38.2	667	
GRANT STREET SIDEWALK		
STA 0-10 TO 0+07.4	70	
24' RT STA 0-10.4 TO STA 0+04.4	70	
STA 0+07.4 TO STA 1+23	582	
STA 1+23 TO STA 1+44	132	12
TOTAL	3460	52

PAVEMENT REMOVAL	
LOCATION	SQ YD
McARTHUR SCHOOL SIDEWALK	
STA 2+24.7 TO STA 2+35.7	31.8
TOTAL	32

COMBINATION CURB AND GUTTER REMOVAL	
LOCATION	FT
McARTHUR SCHOOL SIDEWALK	
12.5' RT TO 10.5' LT STA. 2+49	23
GRANT STREET SIDEWALK	
RT STA 0-10 TO STA 0+01	11
38' RT STA 0-16 TO STA 0+02	18
RT STA 1+23 TO STA 1+44	21
TOTAL	73

SIDEWALK REMOVAL	
LOCATION	SQ FT
McARTHUR SCHOOL SIDEWALK	
STA 2+50.4 TO STA 2+59.3	162
STA 2+80.0 TO STA 4+81.5	1612
27.5' RT STA 3+36.1 TO 8' RT STA 4+38.2	674
GRANT STREET SIDEWALK	
40' RT STA 0-10.4 TO STA 0+04.4	70
STA 0-10 TO STA 0+01	44
TOTAL	2562

SEGMENTAL CONCRETE BLOCK WALL	
LOCATION	SQ FT
McARTHUR SCHOOL SIDEWALK	
4' RT TO 30' RT STA 3+29	125
4' RT STA 3+29 TO STA 4+53	564
TOTAL	689

CHAIN LINK FENCE		
	CHAIN LINK FENCE 6'	FENCE REMOVAL
LOCATION	FT	FT
McARTHUR SCHOOL SIDEWALK		
7.3' RT TO 35.8' RT STA 3+31.5	28.5	28.5
7.3' RT STA 3+31.5 TO STA 4+66.5	136.5	136.5
TOTAL	165	165

PAVEMENT MARKING REMOVAL (WATERBLASTING)	
LOCATION	SQ FT
GRANT STREET SIDEWALK	
RT STA 0-05	160
TOTAL	160

MODIFIED URETHANE PAVEMENT MARKING LINE				
	4" LINE YELLOW	6" LINE WHITE	12" LINE YELLOW	12" LINE WHITE
LOCATION	FT	FT	FT	FT
McARTHUR SCHOOL SIDEWALK				
STA 2+10.6 TO STA 2+49.8		56		48
GRANT STREET SIDEWALK				
RT STA 0-10 TO STA 1+21.6	511		39	
RT STA 1+47.5 TO STA 1+92.6	201		41	
SUB-TOTAL	712	56	80	48
TOTAL	712	56	128	

FENCE REMOVAL AND REINSTALLATION	
LOCATION	FT
McARTHUR SCHOOL SIDEWALK	
8.3' LT STA 2+58.5 TO 7.2' LT STA 4+81.5	223
TOTAL	223

CONCRETE STEP REMOVAL	
LOCATION	EACH
McARTHUR SCHOOL SIDEWALK	
STA 2+59.3 TO STA 2+88	1
TOTAL	1

MANHOLES TO BE ADJUSTED	
LOCATION	EACH
McARTHUR STREET SIDEWALK	
20' LT STA 21+92	1
TOTAL	1

SPECIAL WASTE QUANTITIES					
	NON SPECIAL WASTE DISPOSAL	SOIL DISPOSAL ANALYSIS	REG. SUB. PRE-CON PLAN	REG. SUB. FINAL CONST. REPORT	REG. SUB. MONITORING
LOCATION	CU YD	EACH	L. SUM	L. SUM	CAL DAY
S. SIDE GRANT ST.	274	4	1	1	3

MISC. PROJECT QUANTITIES			
	MOBILIZATION	TRAF. CONTR. & PROT. (SPL)	CONSTRUCTION LAYOUT
LOCATION	L. SUM	L. SUM	L. SUM
TOTAL PROJECT	1	1	1

FILE NAME = 18003403-MA-SRTS-PL0T.dwg



DESIGNED — MJC	REVISED — 03-06-20
DRAWN — MPS/TAB	REVISED — 03-23-20
CHECKED — MJC	REVISED —
DATE — 01-03-20	REVISED —

STATE OF ILLINOIS
DEPARTMENT OF TRANSPORTATION

QUANTITY TABULATIONS

TR	SECTION	COUNTY	TOTAL SHEETS	SHEET NO.
--	19-00157-00-SW	McDONOUGH	10	3
McARTHUR ST & GRANT ST		CONTRACT NO. 89771		
ILLINOIS				

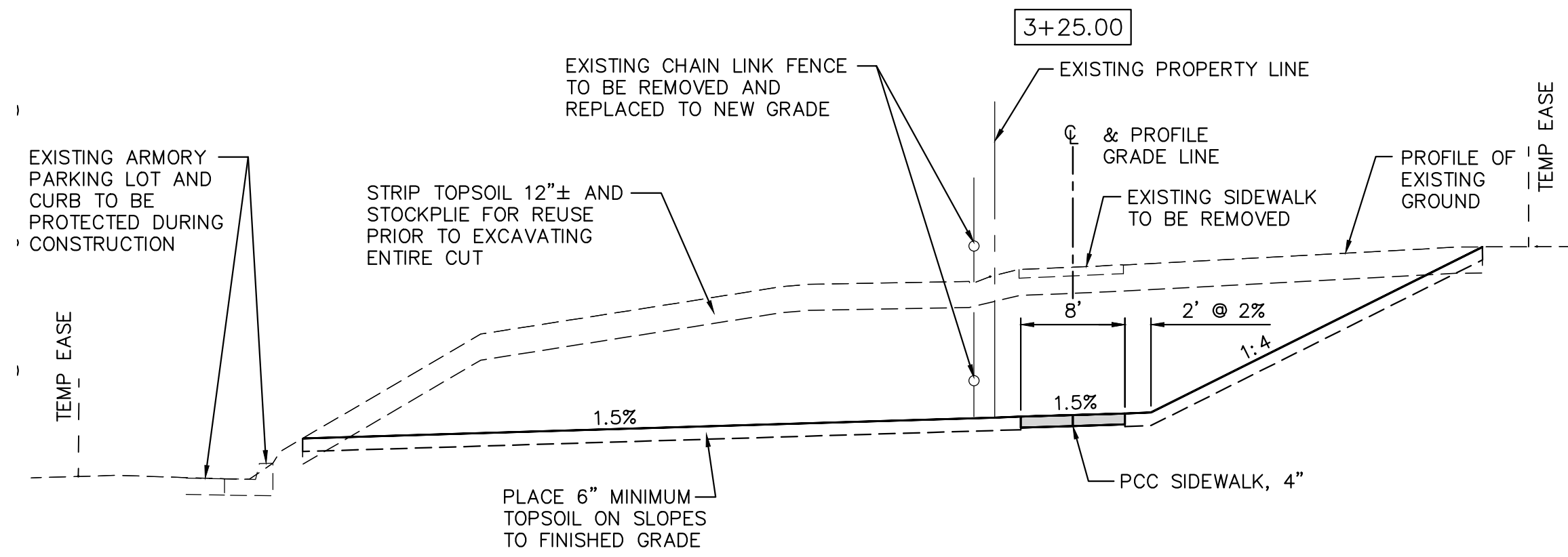

**TYPICAL SECTION - McARTHUR SCHOOL
SIDEWALK - (LOOKING SOUTH)**
STA. 2+56.45 TO STA. 3+27.0
STA. 4+55.0 TO STA. 4+81.4

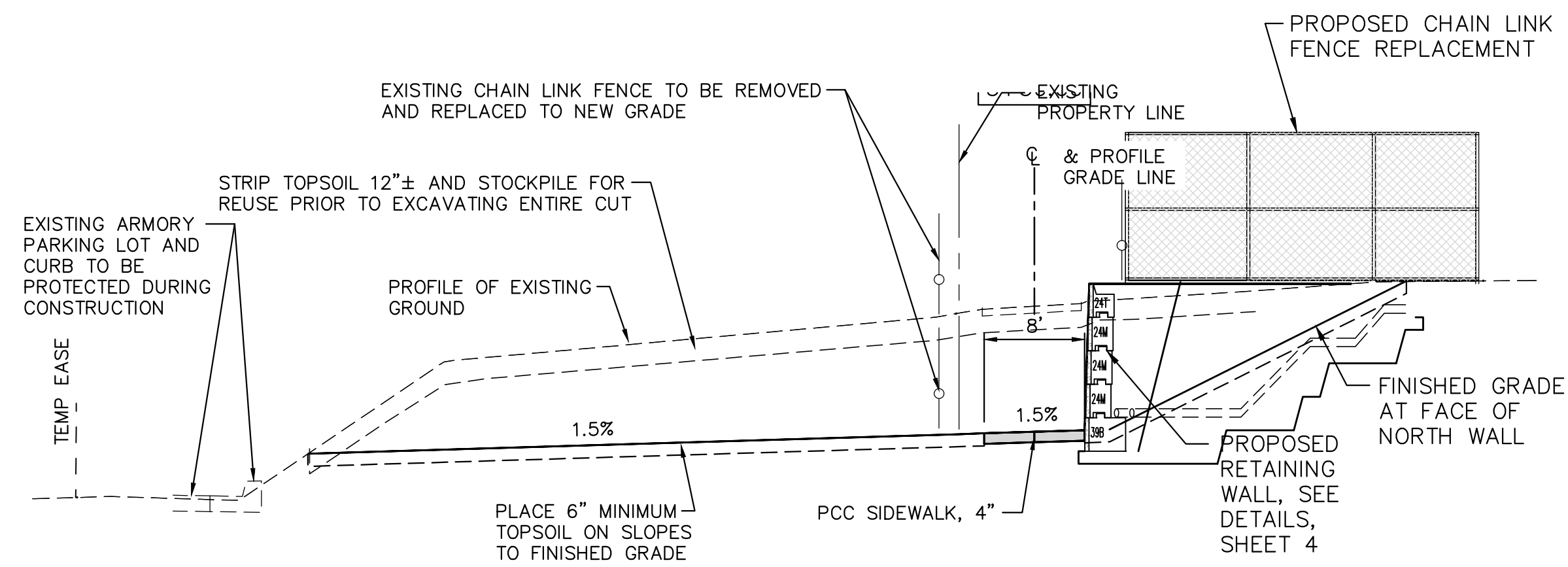

**TYPICAL SECTION - McARTHUR SCHOOL
SIDEWALK - (LOOKING SOUTH)**
STA. 3+27.0 TO STA. 4+55.0

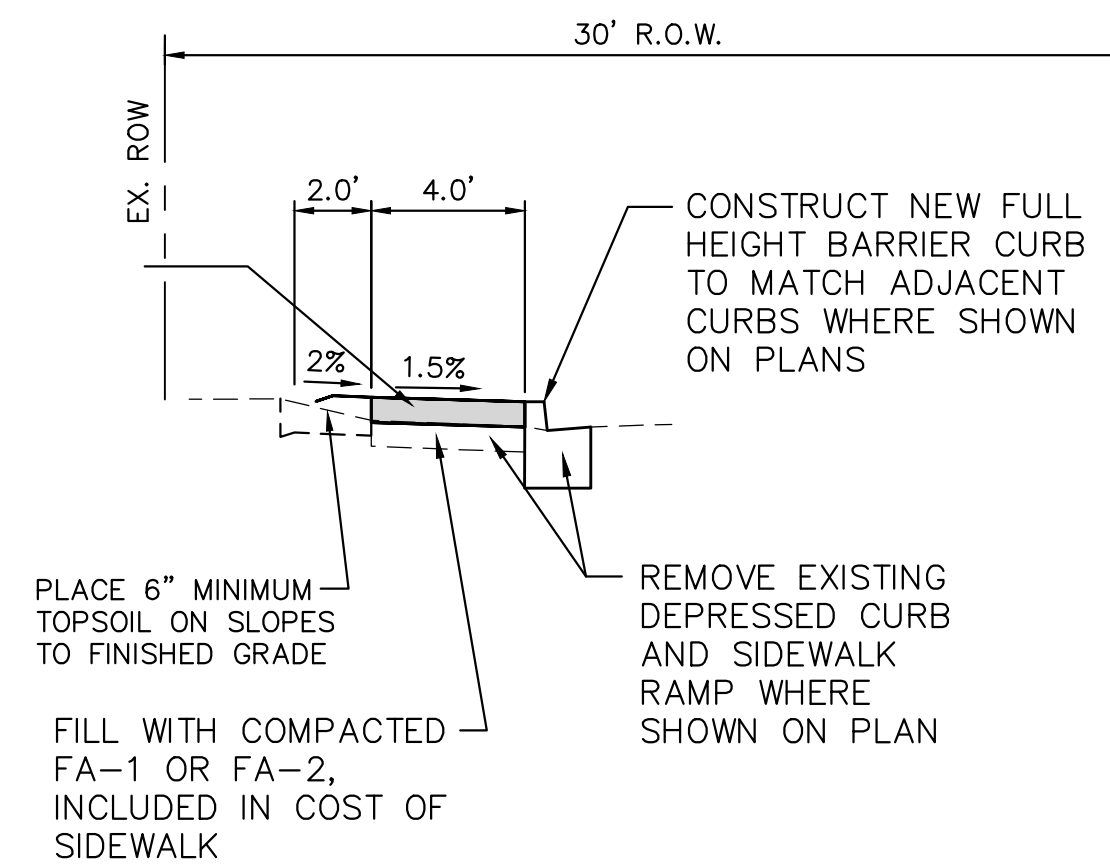

**TYPICAL SECTION - GRANT ST.
SIDEWALK - (LOOKING EAST)**
STA. 0-10.0 TO STA. 0+09.0

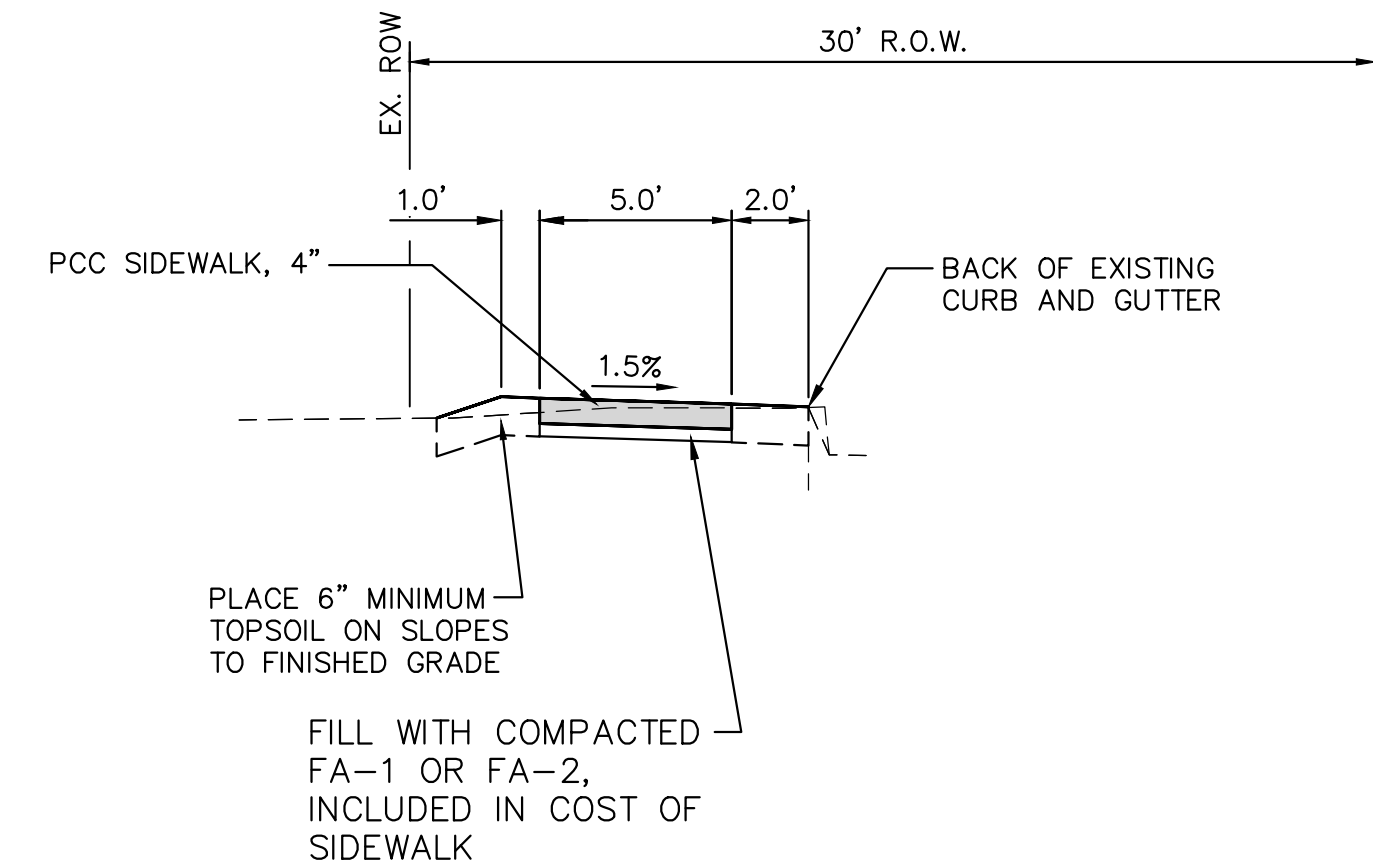

**TYPICAL SECTION - GRANT ST.
SIDEWALK - (LOOKING EAST)**
STA. 0+09.0 TO STA. 1+44

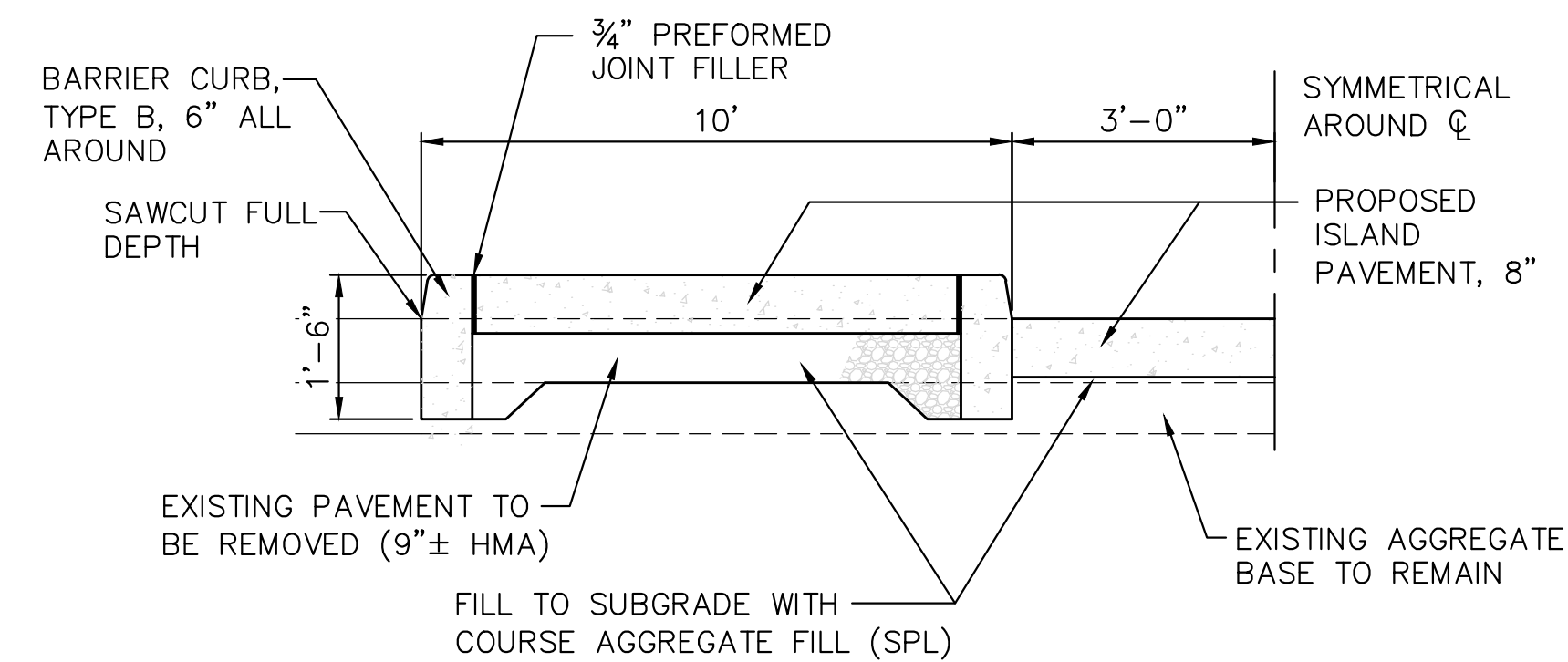

**TYPICAL SECTION - REFUGE ISLAND
(LOOKING NORTH)**
STA. 2+24.66 TO STA. 2+35.66

FILE NAME = 18003403-MA-SRTS-PLOT.dwg



DESIGNED	MJC	REVISED	03-06-20
DRAWN	MPS/TAB	REVISED	-
CHECKED	MJC	REVISED	-
DATE	11-04-19	REVISED	-

STATE OF ILLINOIS
DEPARTMENT OF TRANSPORTATION

TYPICAL SECTIONS

TR	SECTION	COUNTY	TOTAL SHEETS	SHEET NO.
--	19-00157-00-SW	McDONOUGH	10	4
	McARTHUR ST & GRANT ST		CONTRACT NO. 89771	
	ILLINOIS			

PCC SIDEWALK NOTES:

1. PORTLAND CEMENT CONCRETE SIDEWALK SHALL BE CONSTRUCTED IN ACCORDANCE WITH SECTION 424 OF THE STANDARD SPECIFICATIONS FOR ROAD AND BRIDGE CONSTRUCTION AND THE NOTES LISTED HERE.

2. IF CONSTRUCTED AS A REPLACEMENT FOR AN EXISTING SIDEWALK, EXISTING SIDEWALK SHALL BE SAWCUT FULL DEPTH PERPENDICULAR TO THE CENTERLINE PRIOR TO CONSTRUCTING NEW ADJACENT SIDEWALK.

PCC SIDEWALK SPECS

- CONCRETE SHALL BE IDOT CLASS SI
- AIR ENTRAINED - 5% TO 8%
- MINIMUM COMPRESSIVE STRENGTH - 3500 PSI @ 14 DAYS
- SLUMP - 2" TO 4"
- APPROVED CURING METHOD PER ARTICLE 1022.01 (C)
- TOOLED OR SAWED JOINTS AT 4'-0" MIN TO 6'-0" MAXIMUM CENTERS PERPENDICULAR TO THE CENTERLINE. JOINTS SHALL BE 1/4 THE DEPTH OF THE SLAB AND EDGED WITH 1/4" RADIUS TOOL. 1/2" EXPANSION JOINTS SHALL BE PLACE AT 100' MAX. SPACING PER ARTICLE 424.07 OF THE STANDARD SPECS.
- PROVIDE A BRUSHED FINISH IN ACCORDANCE WITH ART. 424.06 OF THE STANDARD SPECIFICATIONS.
- THE SIDEWALK SHALL BE THICKENED TO 6" WHEN THROUGH A RESIDENTIAL DRIVEWAY OR TO 7" THROUGH A COMMERCIAL DRIVEWAY. THE THICKENED SIDEWALK SHALL THEN TAPER FROM DRIVEWAY PAVEMENT DEPTH TO SIDEWALK DEPTH IN 6'.

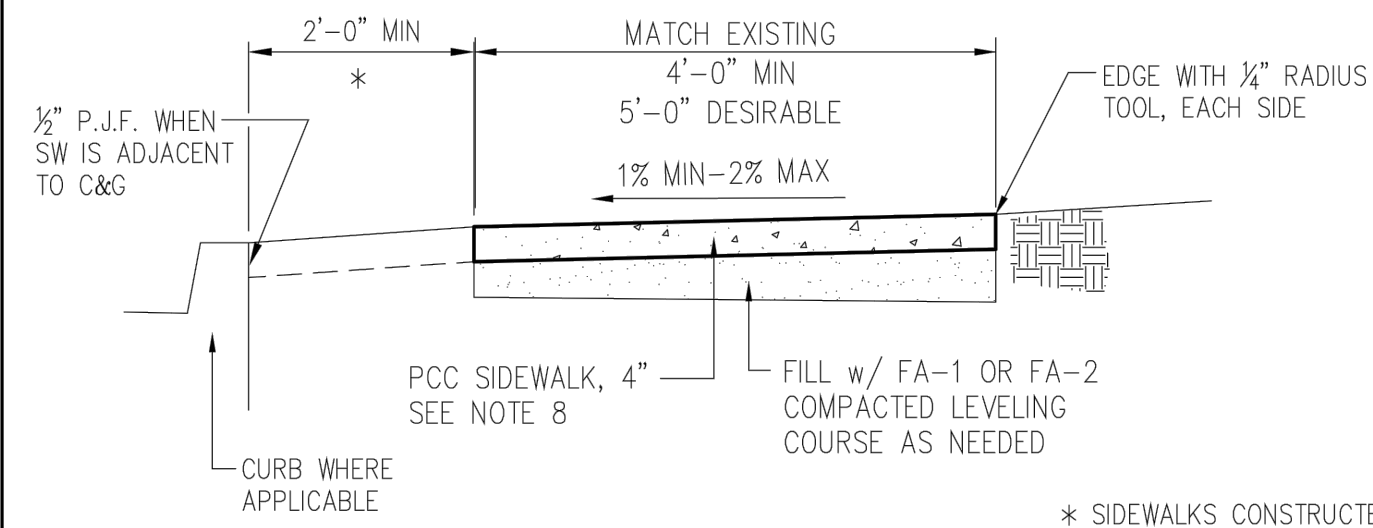

TYPICAL SECTION

* SIDEWALKS CONSTRUCTED ADJACENT TO BACK OF CURB SHALL HAVE A MINIMUM WIDTH OF 6'-0"

<p>CITY OF MACOMB, ILLINOIS PUBLIC WORKS DEPARTMENT 233 CENTER STREET MACOMB, ILLINOIS 61455 (309) 833-2821</p>	STANDARD DETAILS	DATE: 3-1-18 CHECKED: SC/MC
	SIDEWALK DETAIL	SHEET NO.
		202

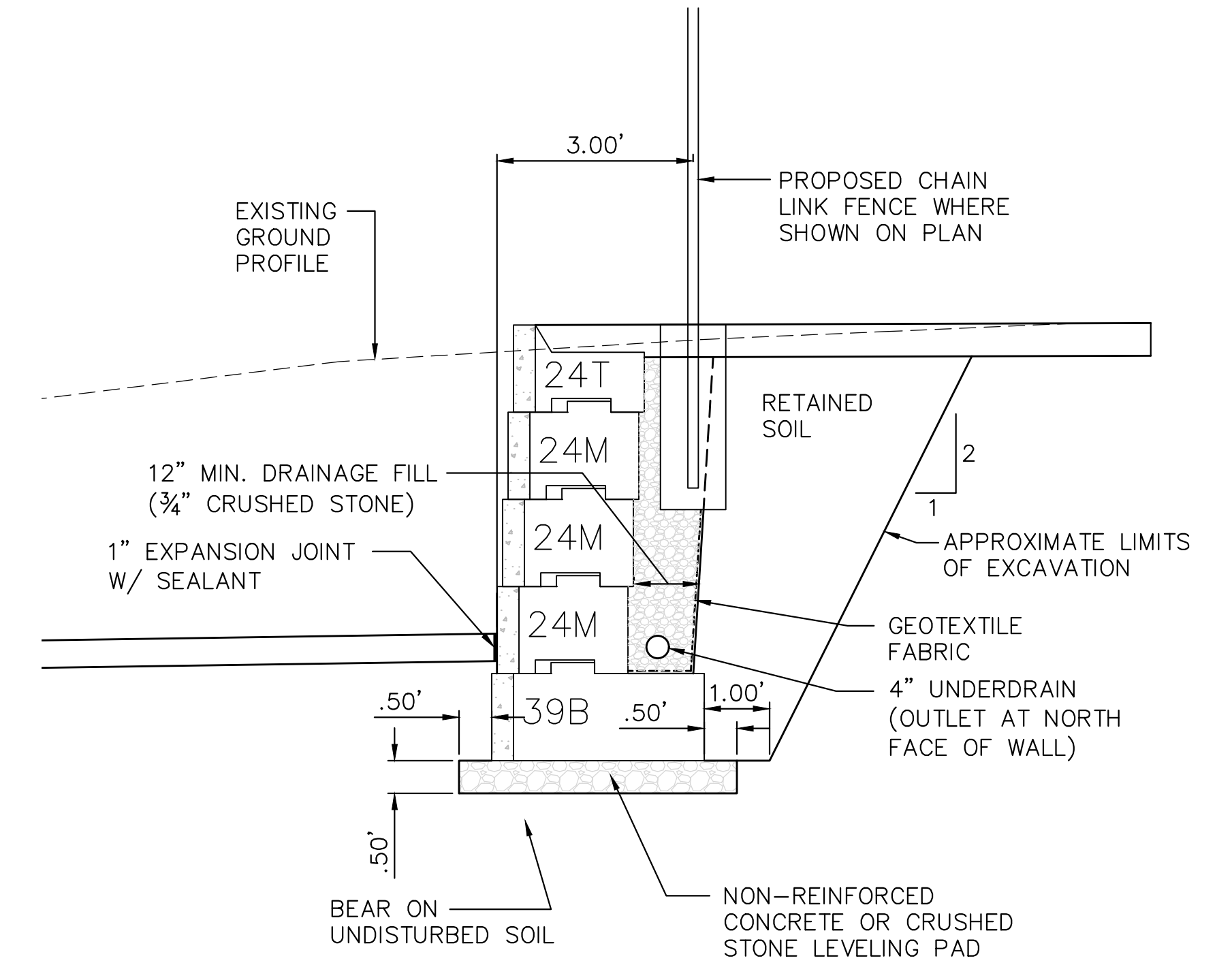

TYPICAL WALL SECTION

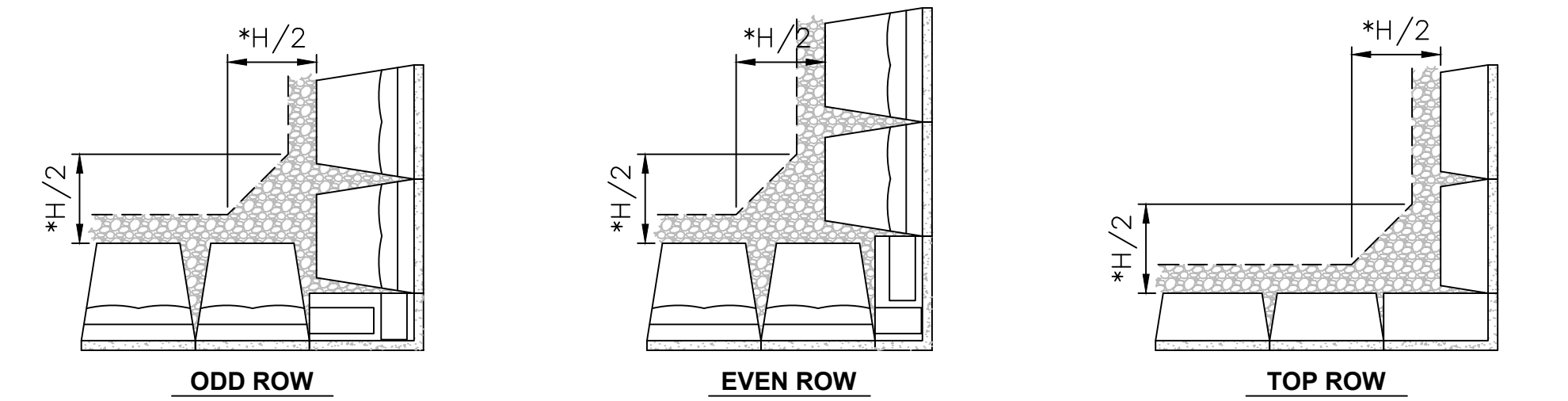

*NOTE: IT IS RECOMMENDED THAT THE DRAINAGE STONE ZONE BE EXPANDED IN THE CORNER TO A MINIMUM H/2 (OR GREATER AS SPECIFIED PER THE ENGINEER), WHERE 'h' IS EQUAL TO THE TOTAL WALL HEIGHT AT THE CORNER.

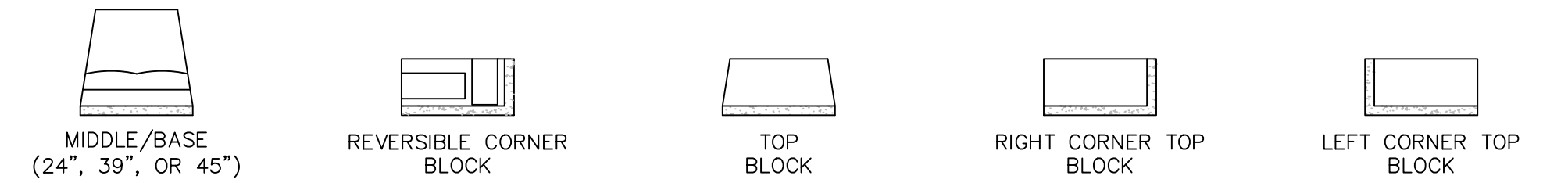

TYPICAL WALL CORNER DETAIL

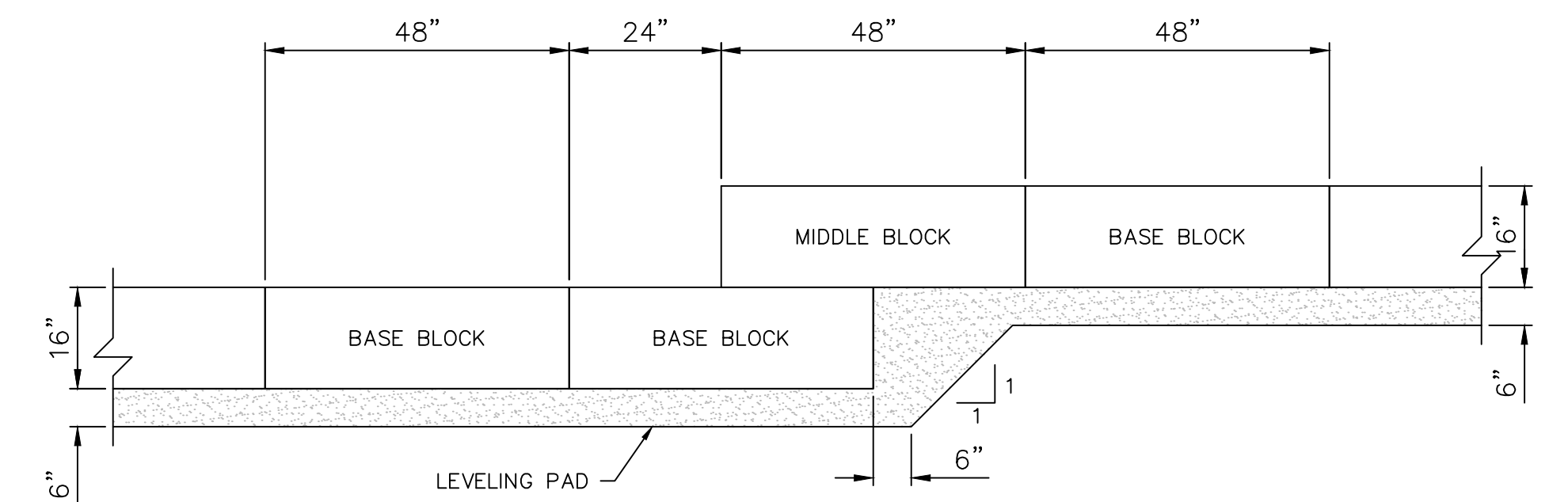

TYPICAL BASE ROW SETUP SHEET TITLE

FILE NAME = 18003403-MA-SRTS-PLOT.dwg



DESIGNED - MJC	REVISED - 03-06-20
DRAWN - MPS/TAB	REVISED -
CHECKED - MJC	REVISED -
DATE - 11-04-19	REVISED -

STATE OF ILLINOIS
DEPARTMENT OF TRANSPORTATION

TYPICAL DETAILS

TR	SECTION	COUNTY	TOTAL SHEETS	SHEET NO.
--	19-00157-00-SW	McDONOUGH	10	5
	McARTHUR ST & GRANT ST	CONTRACT NO. 89771		
	ILLINOIS			

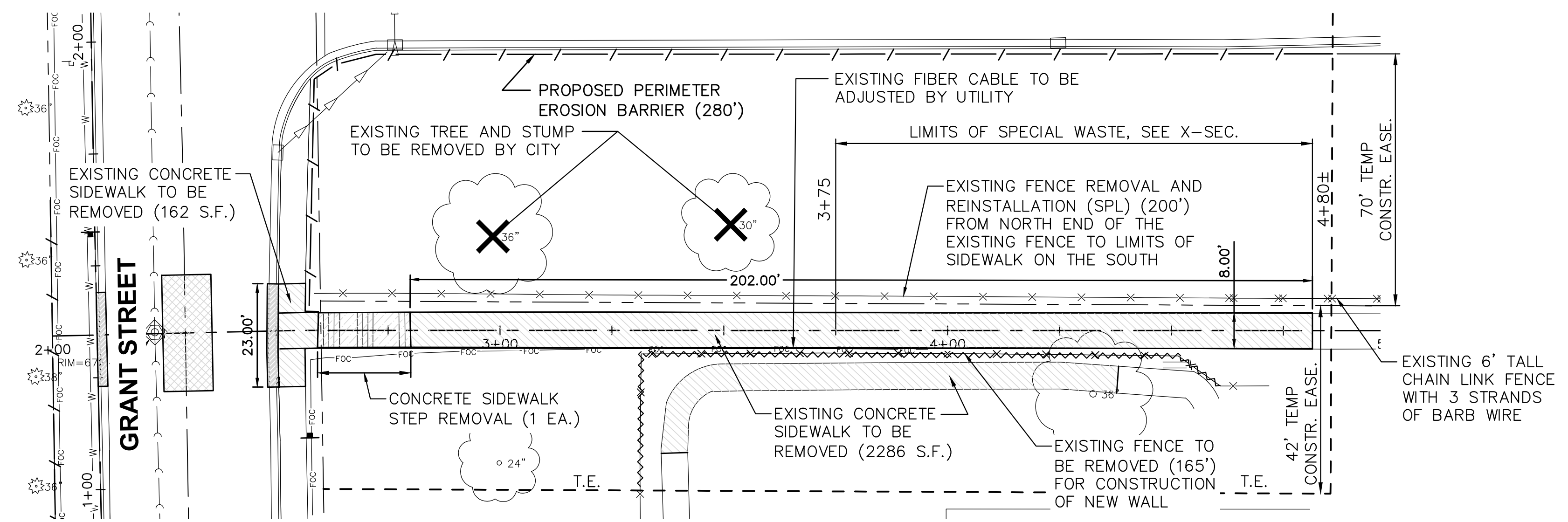
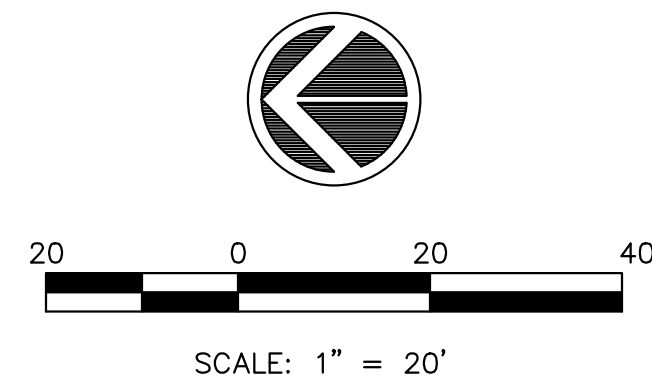

NOTE:
PRIOR TO REMOVAL OF ANY PAVEMENT, CURBS, CURB & GUTTERS, OR SIDEWALKS, THE REMOVAL LIMITS SHALL BE SAW CUT FULL DEPTH. THIS SHALL INCLUDE THE JOINT BETWEEN THE EXISTING PAVEMENT AND EXISTING CURB & GUTTERS. THE COST OF SAW CUTTING SHALL BE CONSIDERED INCIDENTAL TO THE VARIOUS REMOVAL ITEMS.

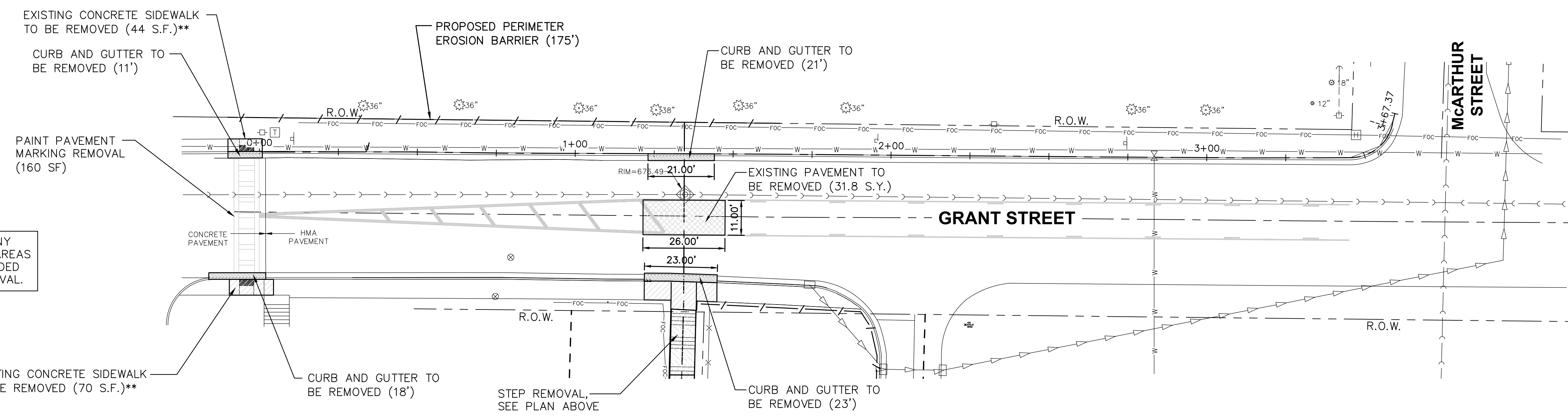
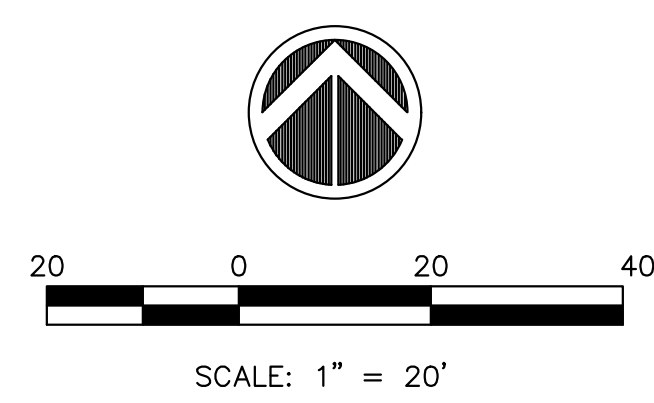

FILE NAME = 18003403-MA-SRTS-PL0T.dwg



DESIGNED	MJC	REVISED	03-06-20
DRAWN	MPS/TAB	REVISED	-
CHECKED	MJC	REVISED	-
DATE	01-03-20	REVISED	-

STATE OF ILLINOIS
DEPARTMENT OF TRANSPORTATION

REMOVAL PLAN

TR	SECTION	COUNTY	TOTAL SHEETS	SHEET NO.
--	19-00157-00-SW	McDONOUGH	10	6
	McARTHUR ST & GRANT ST		CONTRACT NO. 89771	
	ILLINOIS			

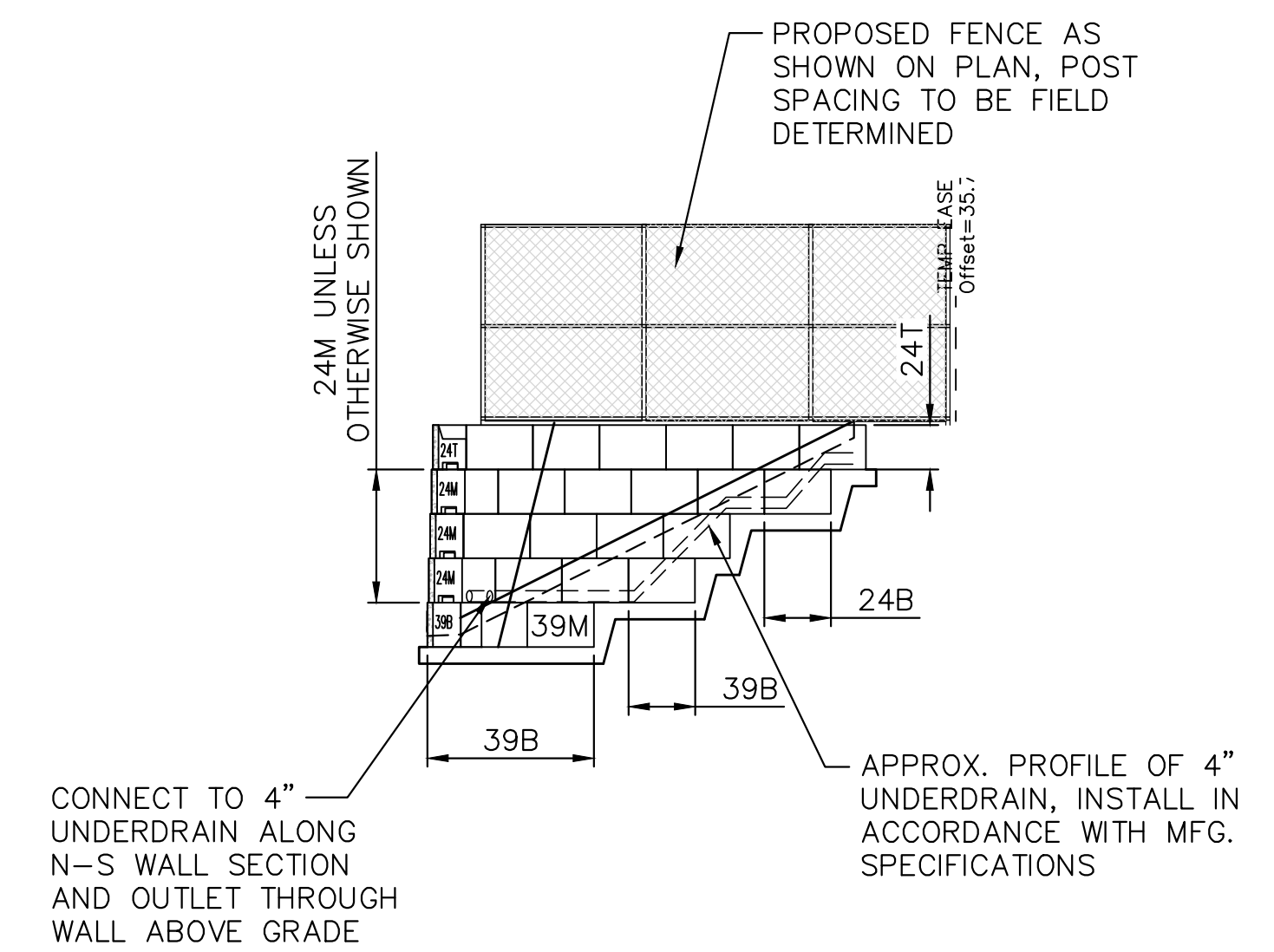
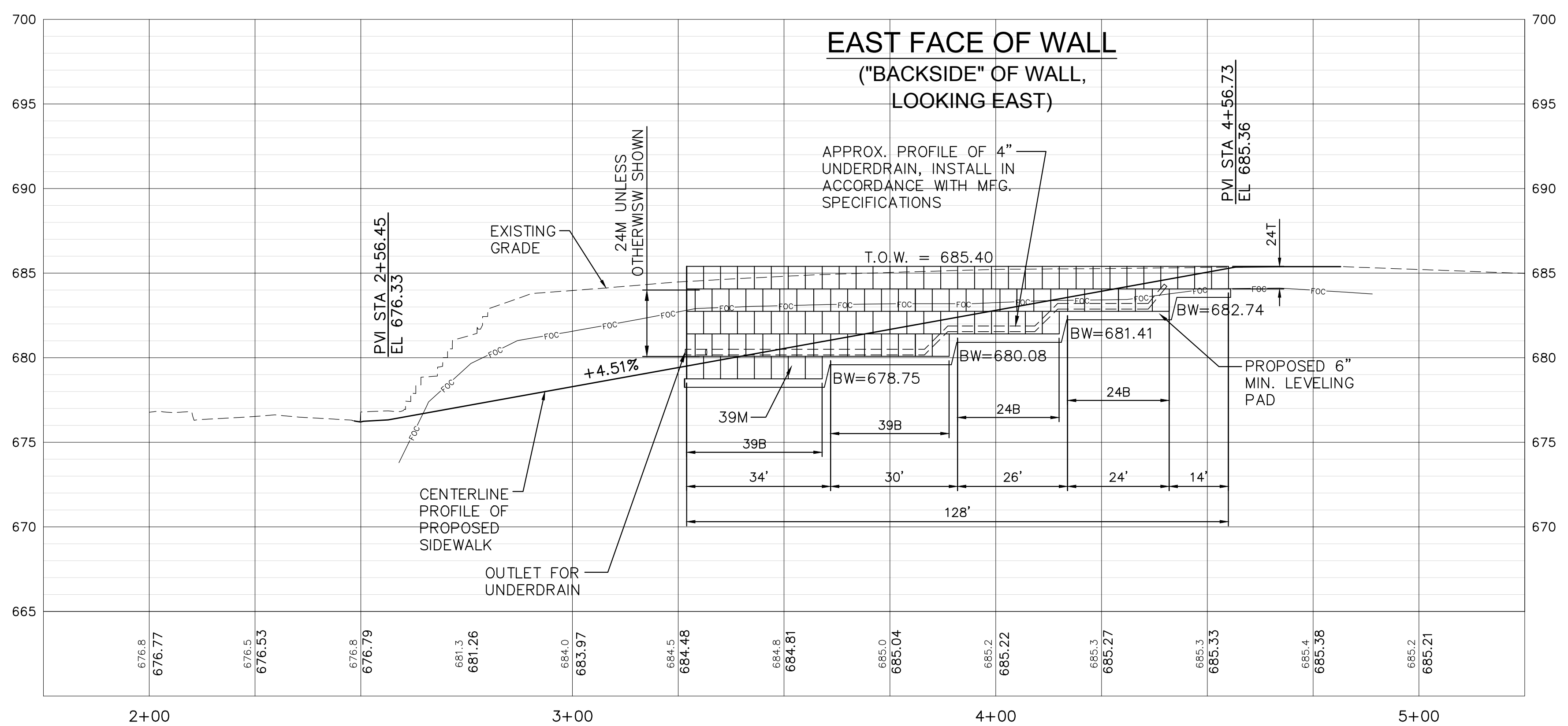
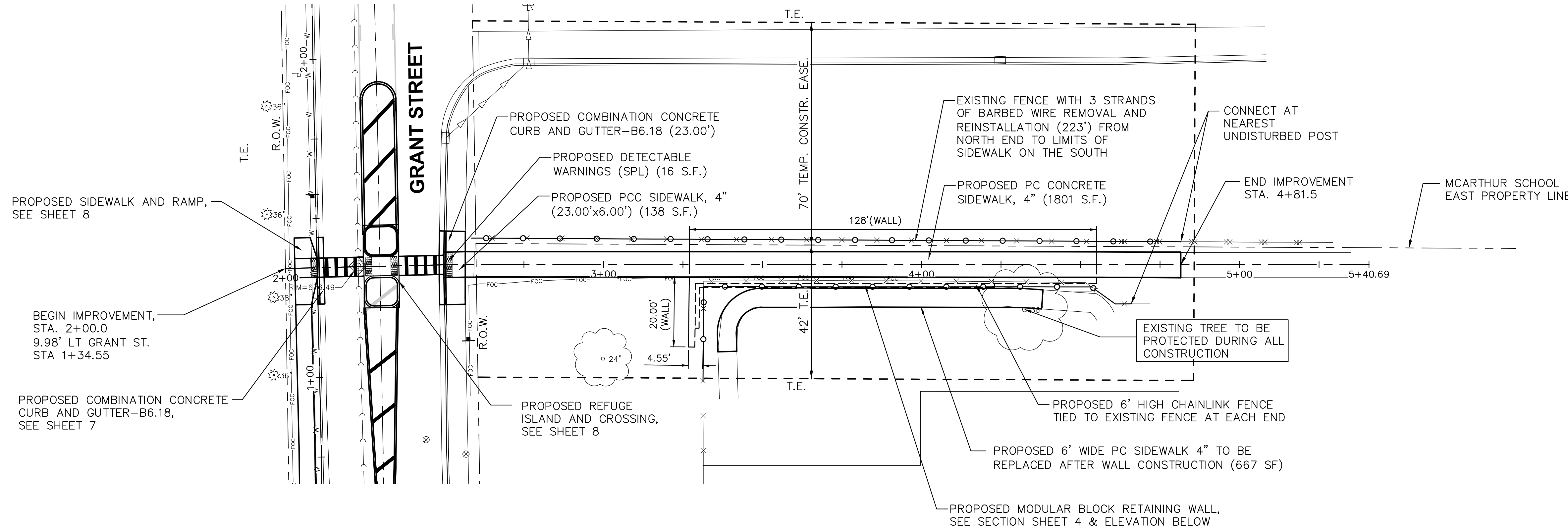

FILE NAME = 18003403-MA-SRTS-PLOT.dwg



DESIGNED	MJC	REVISED	03-06-20
DRAWN	MPS/TAB	REVISED	-
CHECKED	MJC	REVISED	-
DATE	11-04-19	REVISED	-

STATE OF ILLINOIS
DEPARTMENT OF TRANSPORTATION

McARTHUR SCHOOL SIDEWALK
PLAN & PROFILE

TR	SECTION	COUNTY	TOTAL SHEETS	SHEET NO.
--	19-00157-00-SW	McDONOUGH	10	7
McARTHUR ST & GRANT ST		CONTRACT NO. 89771		
ILLINOIS				

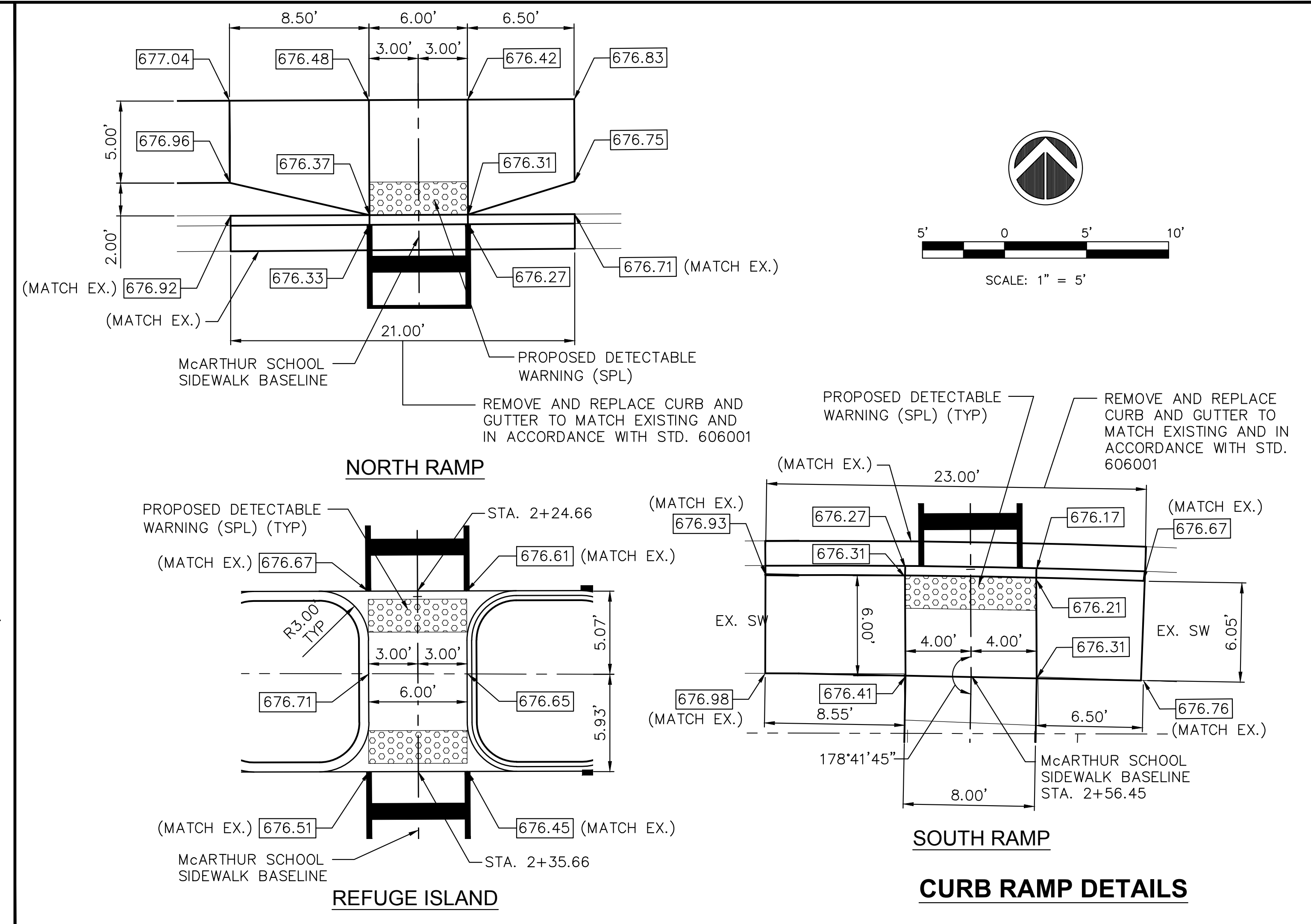
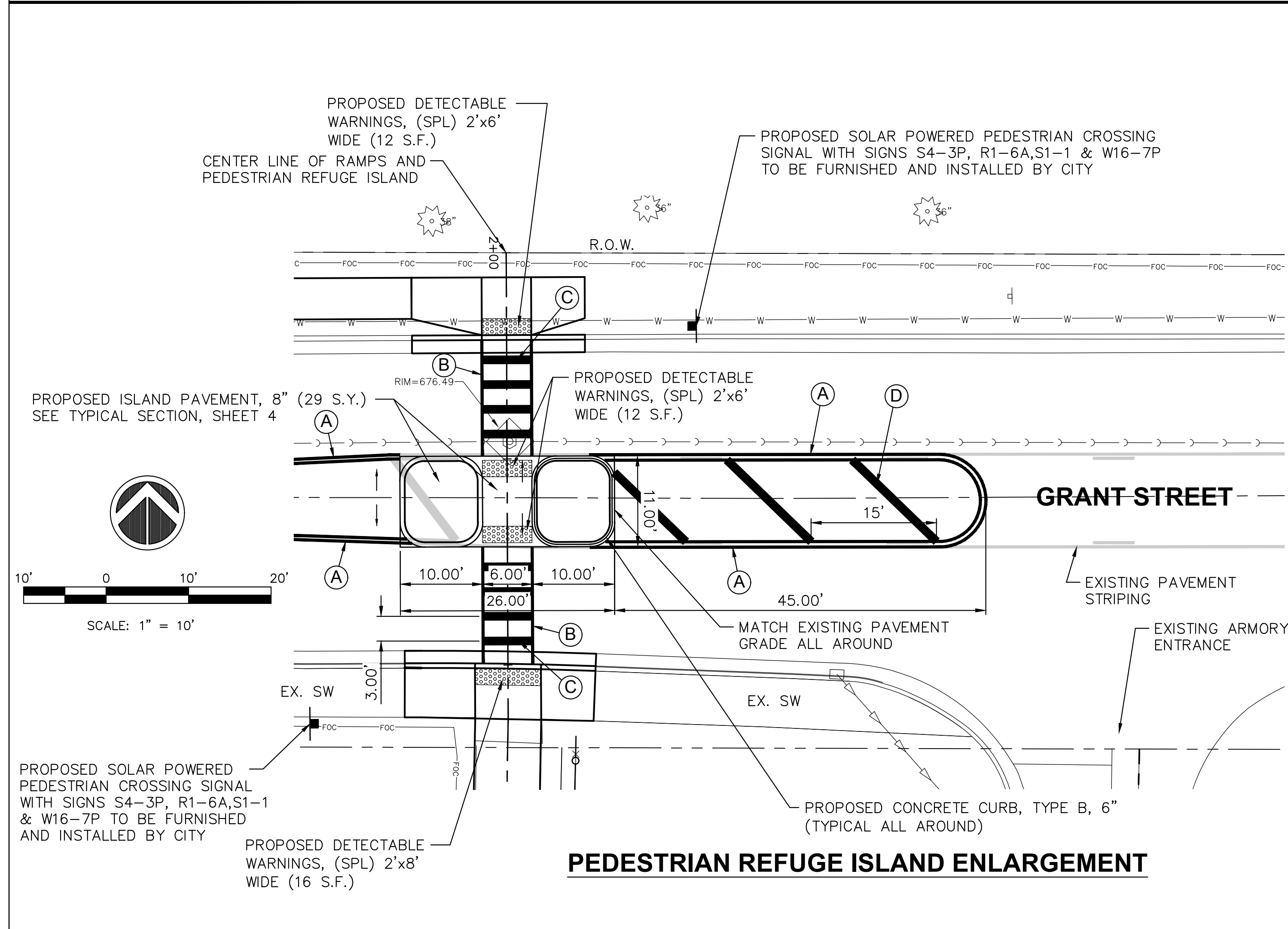
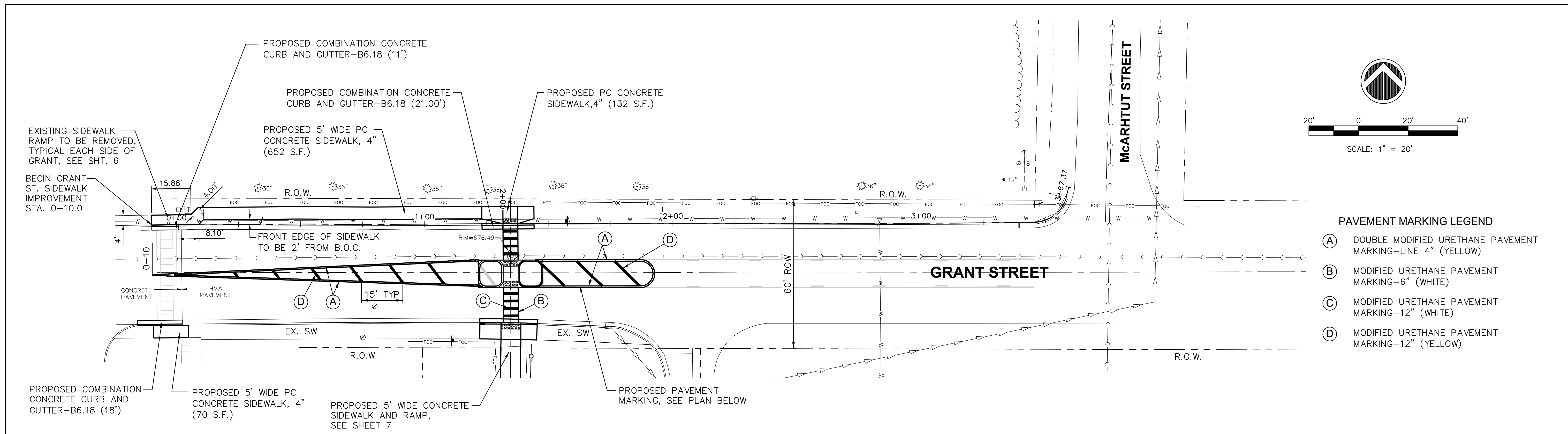

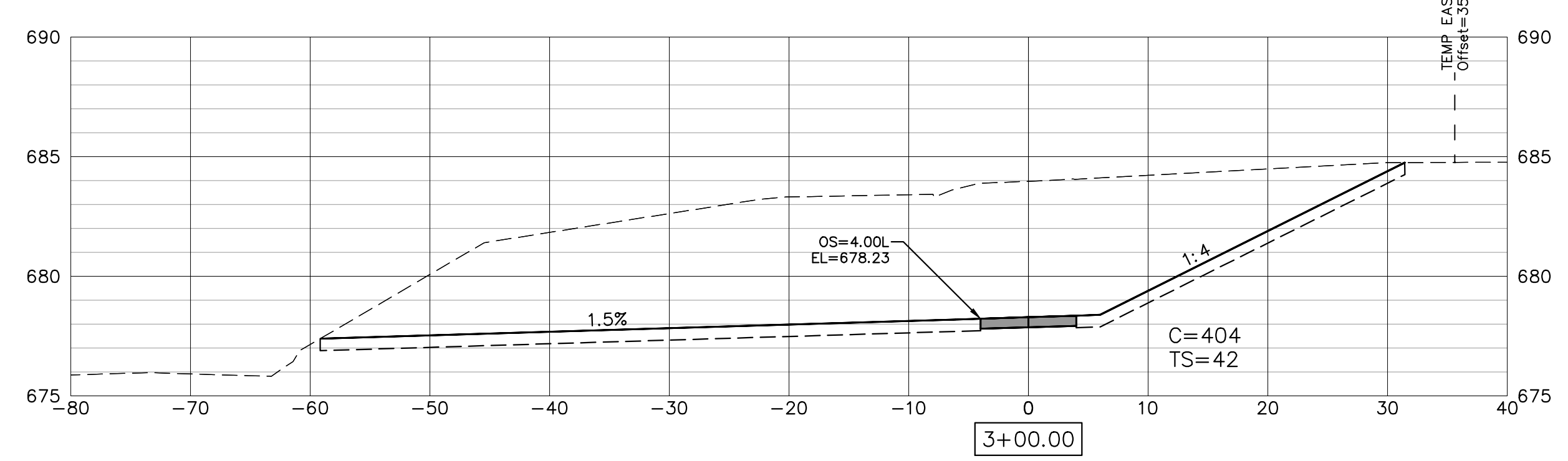
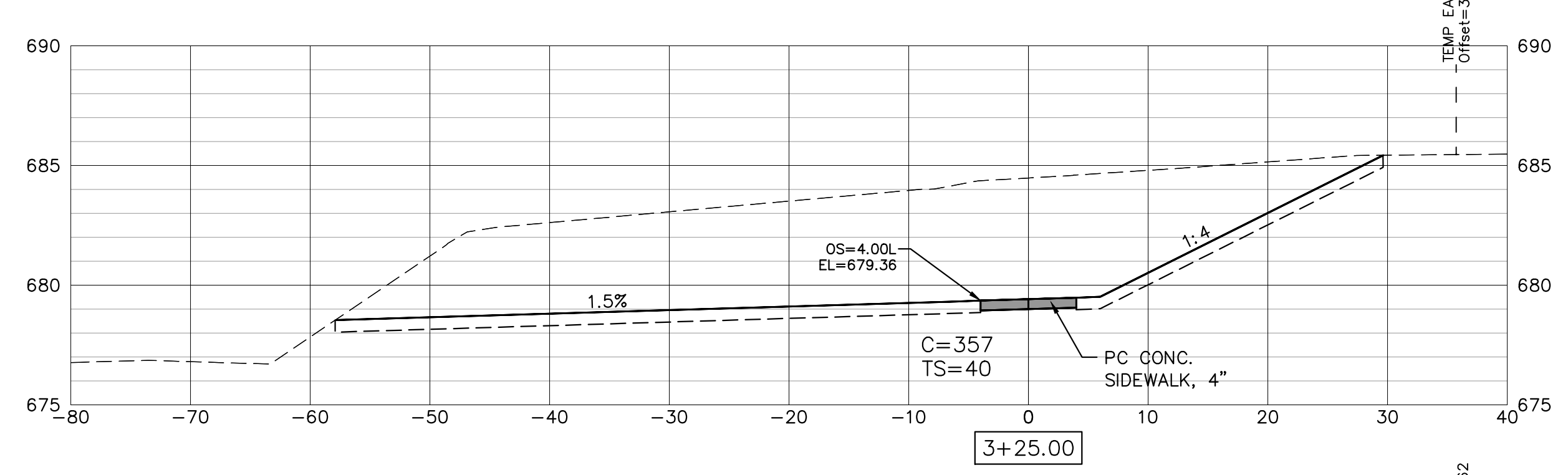
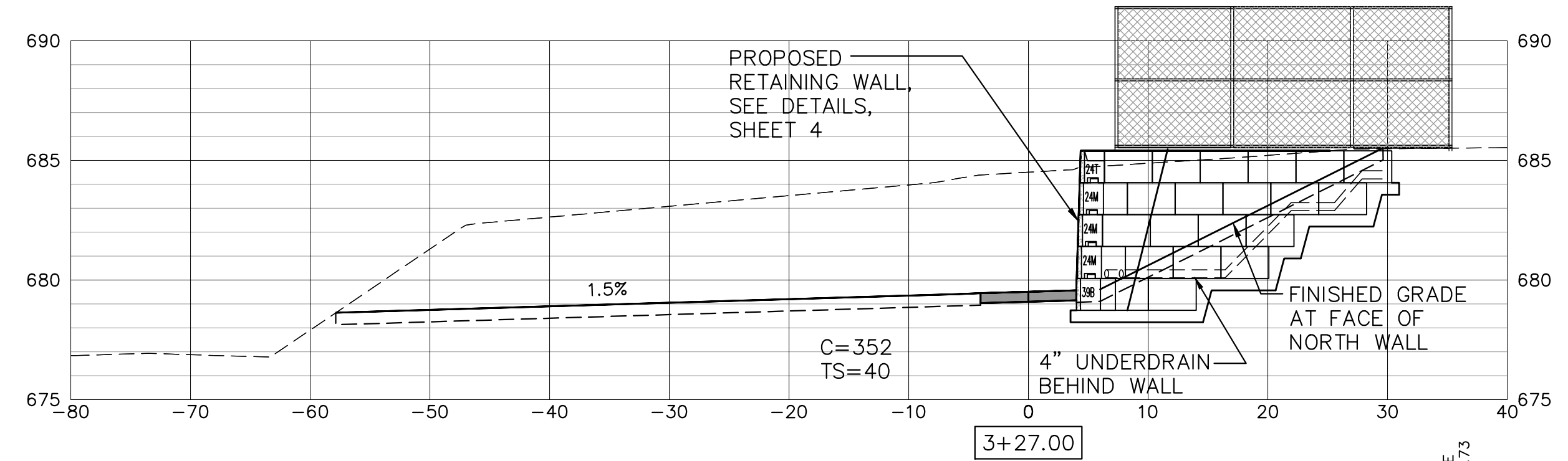
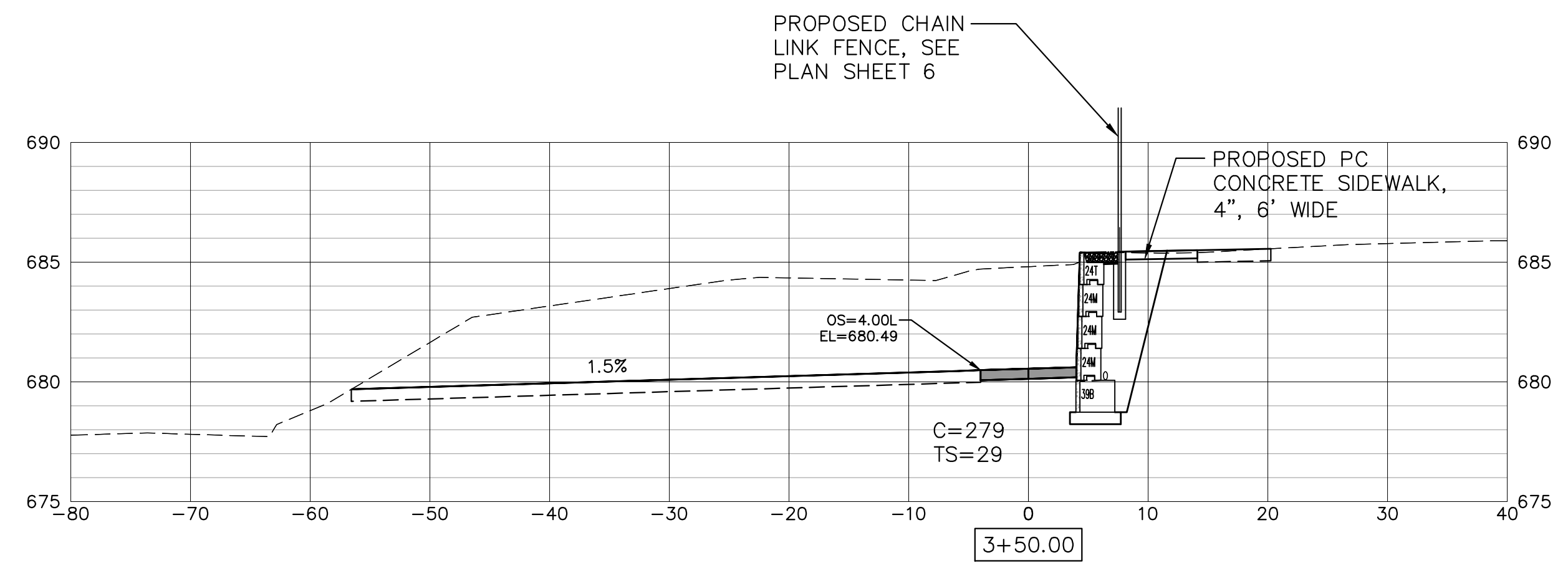
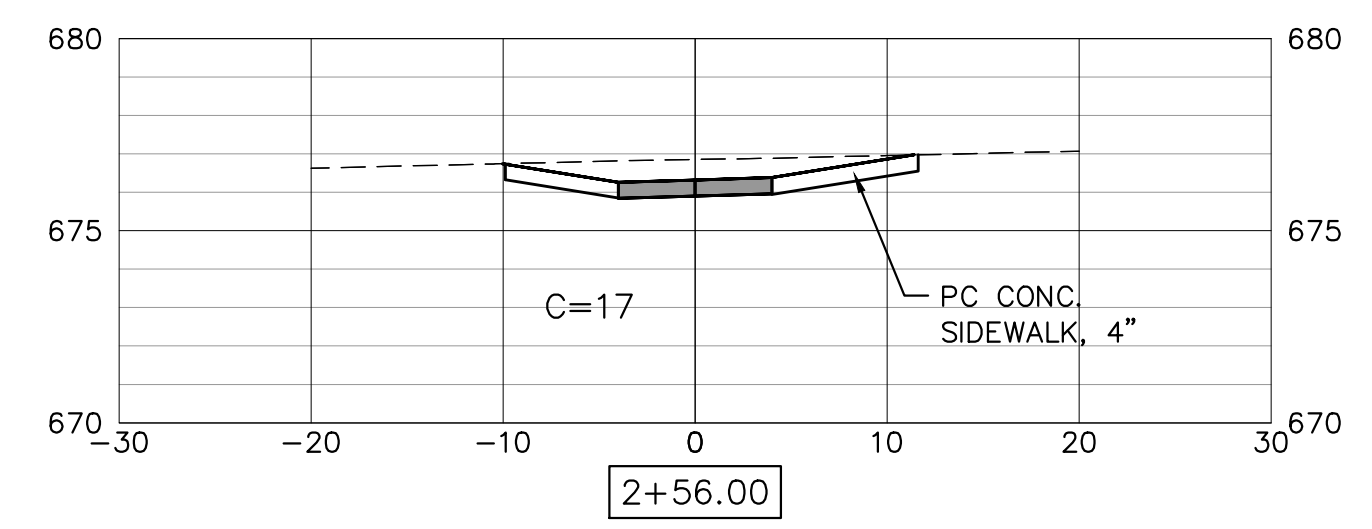
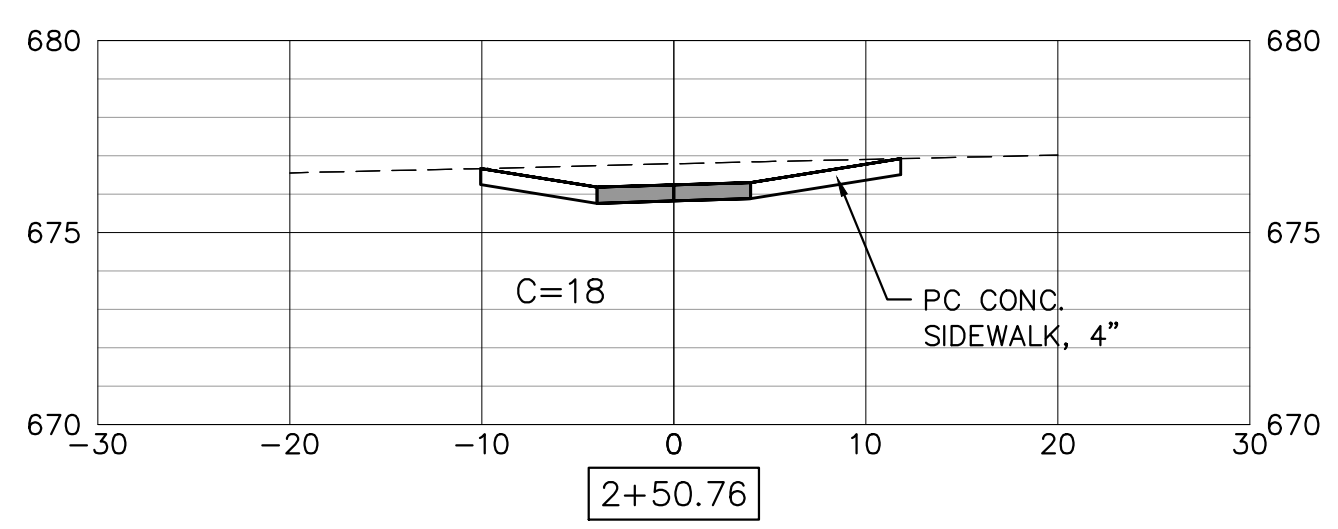
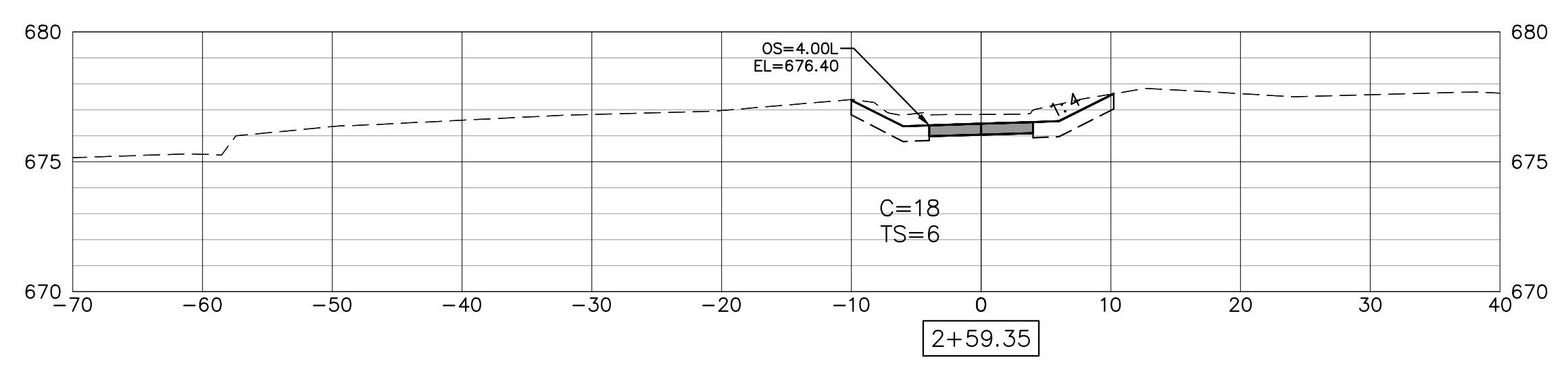
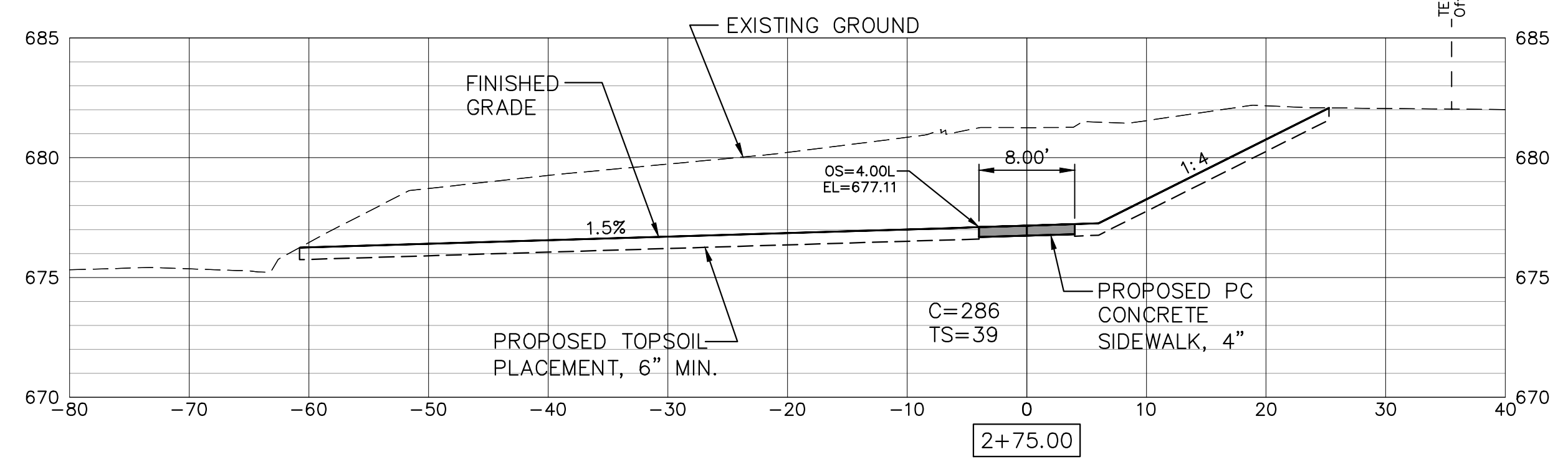
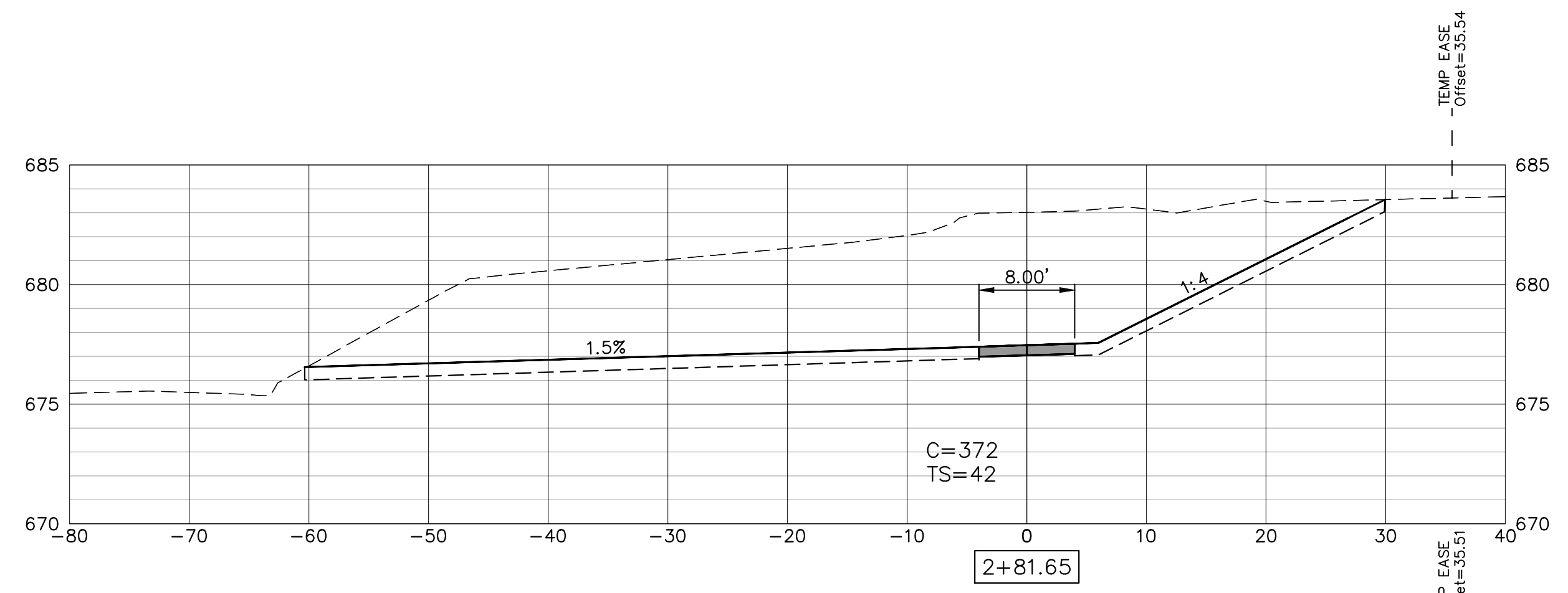

FILE NAME = 18003403-MA-SRTS-PLOT.dwg



DESIGNED	MJC	REVISED	03-06-20
DRAWN	MPS/TAB	REVISED	
CHECKED	MJC	REVISED	
DATE	10-23-19	REVISED	

STATE OF ILLINOIS
DEPARTMENT OF TRANSPORTATION

**McARTHUR SCHOOL SIDEWALK
X-SECTIONS**

TR	SECTION	COUNTY	TOTAL SHEETS	SHEET NO.
--	19-00157-00-SW	McDONOUGH	10	9
McARTHUR ST & GRANT ST		CONTRACT NO. 89771		
ILLINOIS				

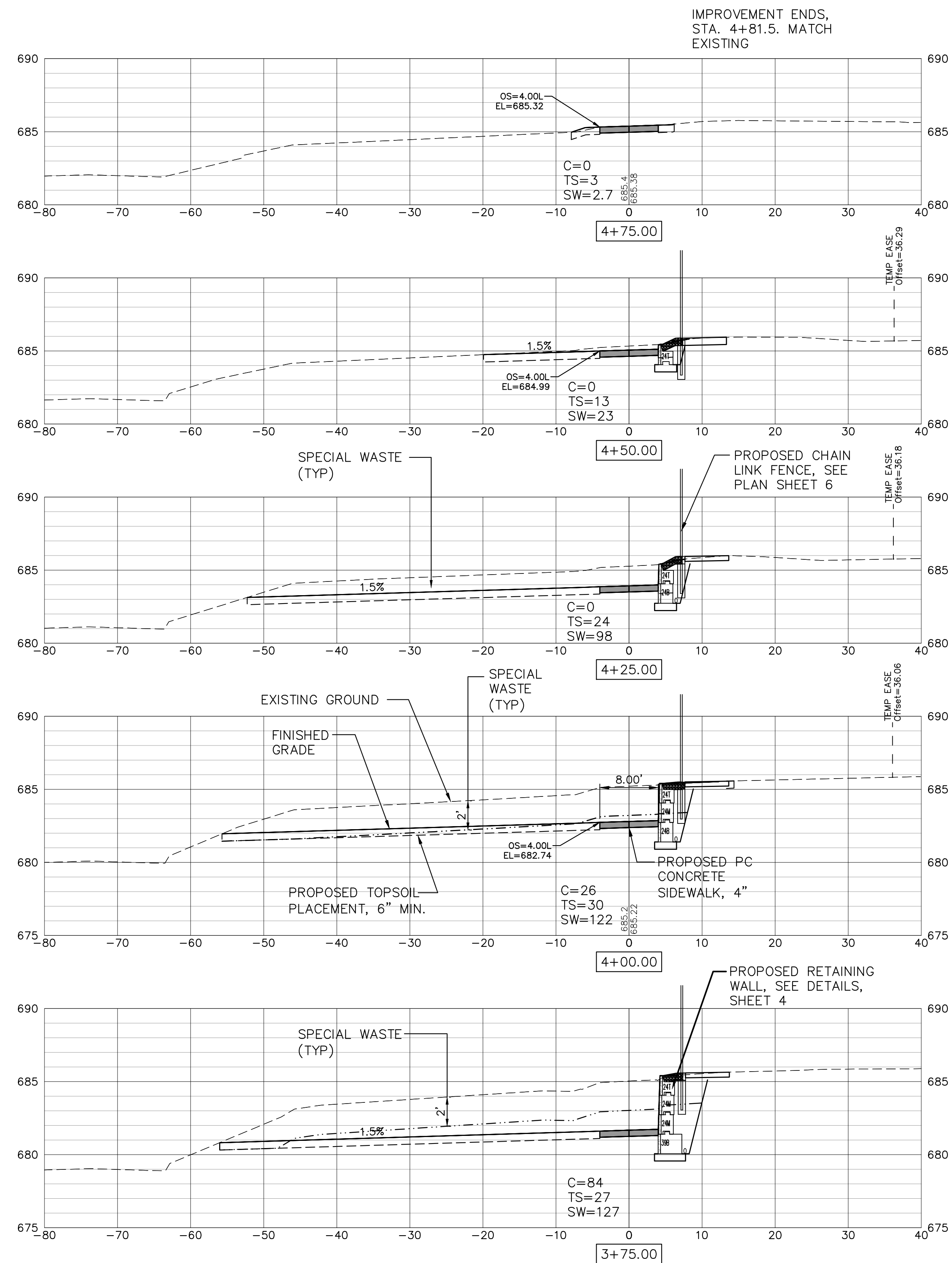

NcARTHUR SCHOOL SIDEWALK X-SECTIONS

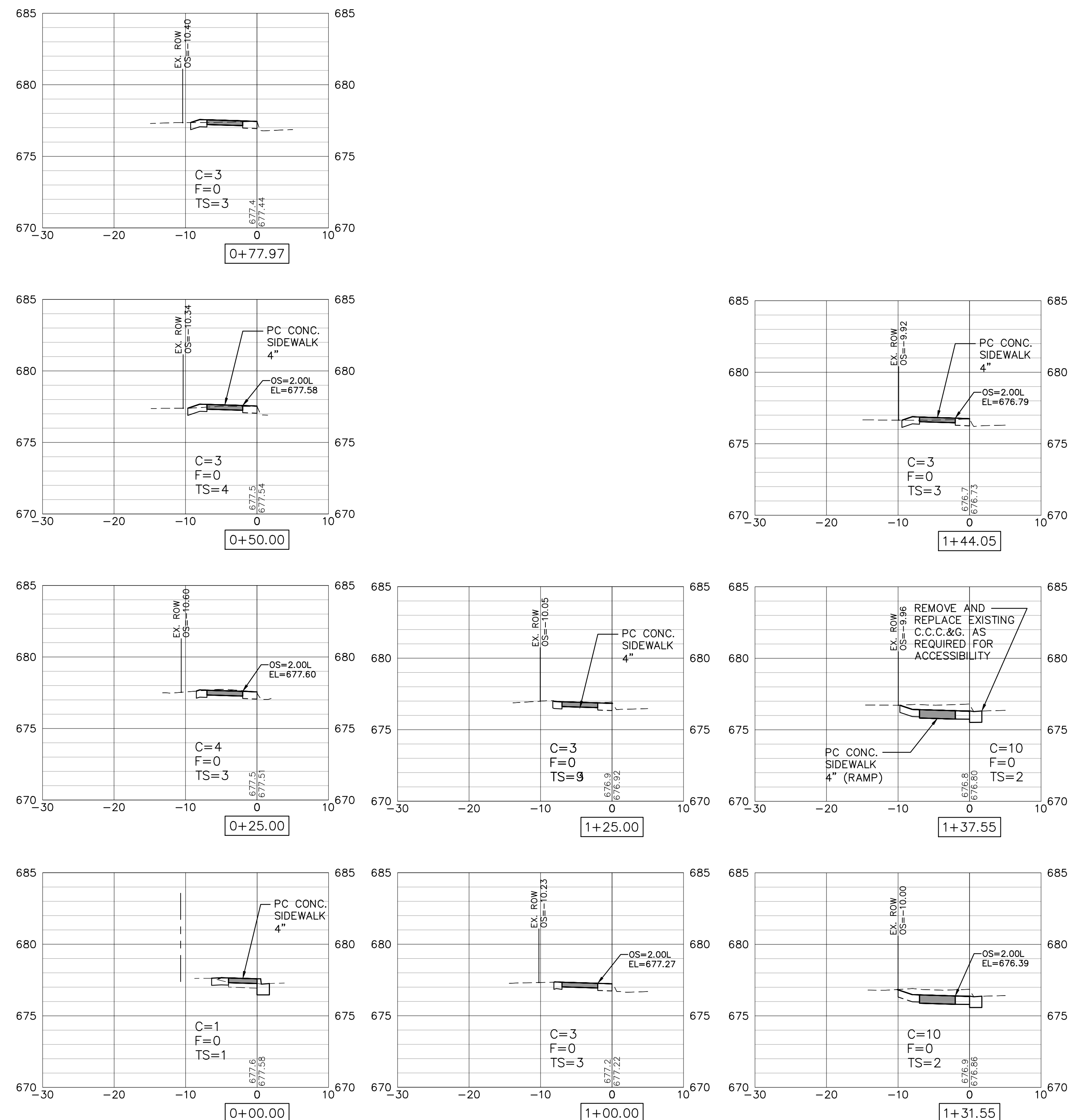

GRANT ST. SIDEWALK X-SECTIONS

FILE NAME =
18003403-MA-SRTS-PL0T.dwg



DESIGNED	MJC	REVISED	03-06-20
DRAWN	MPS/TAB	REVISED	-
CHECKED	MJC	REVISED	-
DATE	01-03-20	REVISED	-

**STATE OF ILLINOIS
DEPARTMENT OF TRANSPORTATION**

**NcARTHUR SCHOOL AND GRANT ST.
SIDEWALK X-SECTIONS**

TR	SECTION	COUNTY	TOTAL SHEETS	SHEET NO.
--	19-00157-00-SW	McDONOUGH	10	10
	McARTHUR ST & GRANT ST		CONTRACT NO. 89771	
	ILLINOIS			