

TRAFFIC SIGNAL LEGEND

	PROPOSED	EXISTING
CONTROLLER CABINET		
RAILROAD CONTROL CABINET		
SERVICE INSTALLATION, (P) POLE OR (G) GROUND MOUNT		
TELEPHONE CONNECTION		
SIGNAL HEAD		
SIGNAL HEAD WITH BACKPLATE		
SIGNAL HEAD OPTICALLY PROGRAMMED		
SIGNAL HEAD PEDESTRIAN		
SIGNAL HEAD PEDESTRIAN WITH COUNT-DOWN		
ILLUMINATED SIGN "NO LEFT TURN"		
ILLUMINATED SIGN "NO RIGHT TURN"		
SIGNAL POST		
WOOD POLE		
STEEL MAST ARM ASSEMBLY AND POLE		
ALUMINUM MAST ARM ASSEMBLY AND POLE		

TRAFFIC SIGNAL LEGEND

	PROPOSED	EXISTING
STEEL COMBINATION MAST ARM ASSEMBLY AND POLE WITH LUMINAIRE		
JUNCTION BOX		
HANDHOLE		
HEAVY DUTY HANDHOLE		
DOUBLE HANDHOLE		
G.S. CONDUIT IN TRENCH OR PUSHED		
COMMON TRENCH	CT	
UNIT DUCT	UD	
PEDESTRIAN PUSHBUTTON DETECTOR		
ACCESSIBLE PEDESTRIAN PUSHBUTTON		
DETECTOR LOOP, TYPE I		
PERFORMED DETECTOR LOOP		
MICROWAVE VEHICLE SENSOR		
VIDEO DETECTOR		
CLOSED CIRCUIT TV		
EMERGENCY VEHICLE SYSTEM DETECTOR		
CONFIRMATION BEACON		
UNINTERRUPTABLE POWER SUPPLY (UPS)		

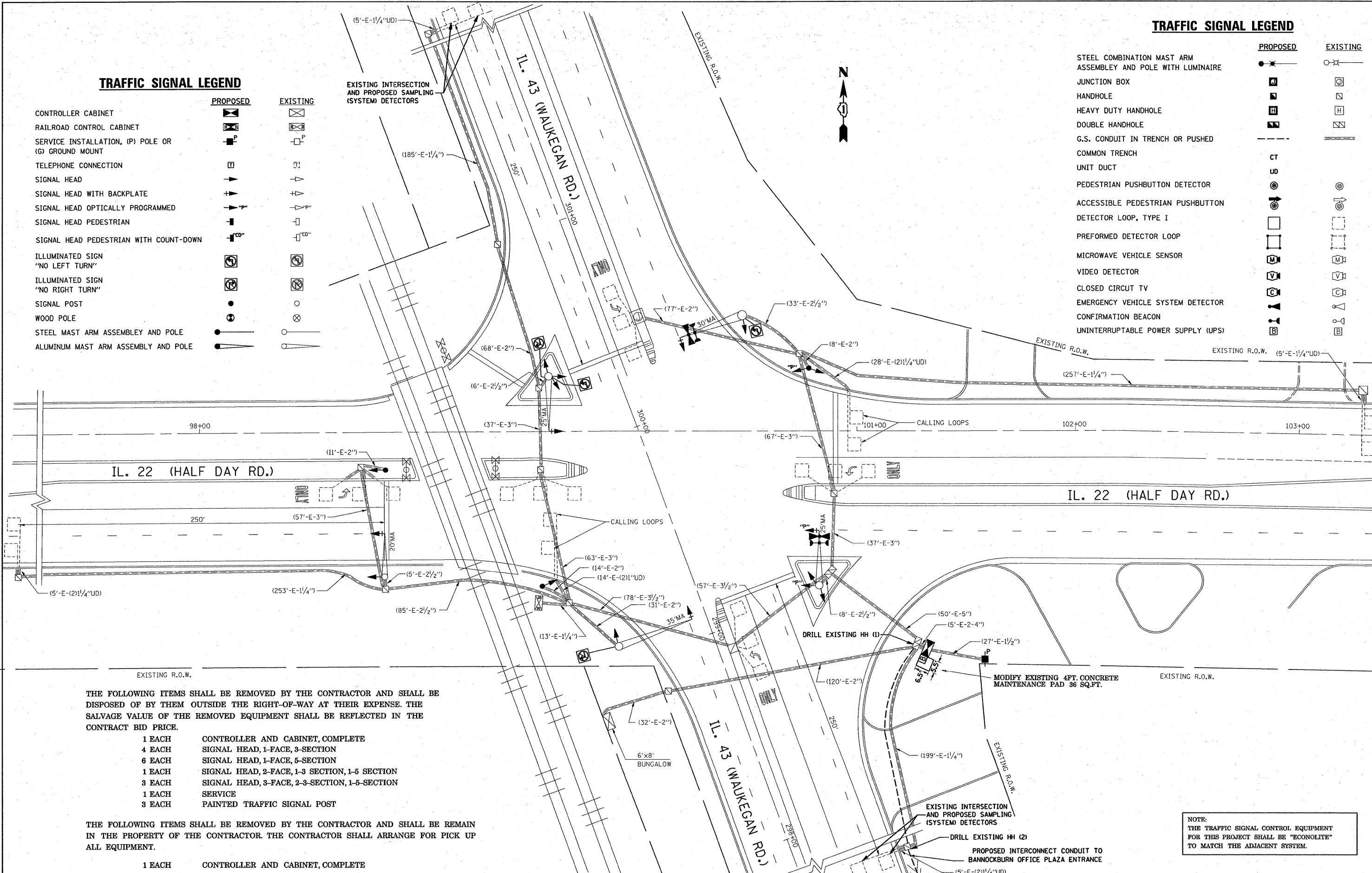

THE FOLLOWING ITEMS SHALL BE REMOVED BY THE CONTRACTOR AND SHALL BE DISPOSED OF BY THEM OUTSIDE THE RIGHT-OF-WAY AT THEIR EXPENSE. THE SALVAGE VALUE OF THE REMOVED EQUIPMENT SHALL BE REFLECTED IN THE CONTRACT BID PRICE.

- 1 EACH CONTROLLER AND CABINET, COMPLETE
- 4 EACH SIGNAL HEAD, 1-FACE, 3-SECTION
- 6 EACH SIGNAL HEAD, 1-FACE, 5-SECTION
- 1 EACH SIGNAL HEAD, 2-FACE, 1-3 SECTION, 1-5 SECTION
- 3 EACH SIGNAL HEAD, 3-FACE, 2-3-SECTION, 1-5-SECTION
- 1 EACH SERVICE
- 3 EACH PAINTED TRAFFIC SIGNAL POST

THE FOLLOWING ITEMS SHALL BE REMOVED BY THE CONTRACTOR AND SHALL BE REMAIN IN THE PROPERTY OF THE CONTRACTOR. THE CONTRACTOR SHALL ARRANGE FOR PICK UP ALL EQUIPMENT.

- 1 EACH CONTROLLER AND CABINET, COMPLETE

NOTE:
THE TRAFFIC SIGNAL CONTROL EQUIPMENT FOR THIS PROJECT SHALL BE "ECONOLITE" TO MATCH THE ADJACENT SYSTEM.

FILE NAME =	USER NAME = nguyenm	DESIGNED - SN	REVISED -	STATE OF ILLINOIS DEPARTMENT OF TRANSPORTATION	TRAFFIC SIGNAL MODIFICATION			F.A.U. RTE.	SECTION	COUNTY	TOTAL SHEETS	SHEET NO.
c:\projects\traffic\060210\1143deer\1122.dgn		DRAWN - SN	REVISED -		IL. 43 (WAUKEGAN RD.) @ IL. 22 (HALF DAY RD.)			2706	2006-020 TS	LAKE	29	20
		CHECKED - DAD	REVISED -		SCALE:	SHEET NO. OF SHEETS	STA. TO STA.	C-91-351-06 CONTRACT NO. 60B48				
		DATE - 1/15/2008	REVISED -		FED. ROAD DIST. NO. 1 ILLINOIS FED. AID PROJECT							

14:06:51 01/23/2008