

F.A.P. RTE.	SECTION	COUNTY	TOTAL SHEETS	SHEET NO.
305	2007-028 RS	COOK	35	7
STA.		TO STA.		
FED. ROAD DIST. NO. 1		ILLINOIS FED. AID PROJECT		

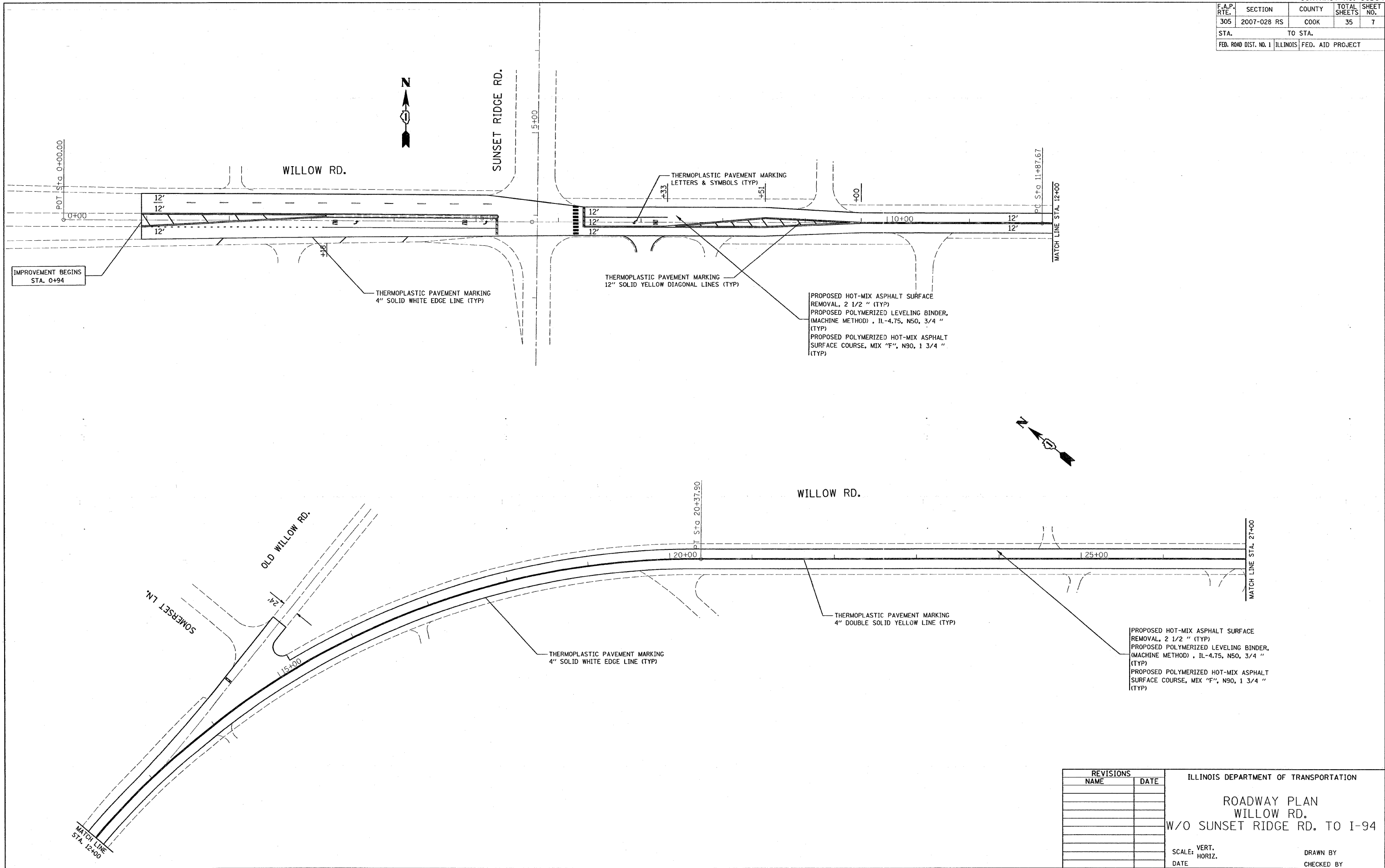

IMPROVEMENT BEGINS STA. 0+94

THERMOPLASTIC PAVEMENT MARKING 4" SOLID WHITE EDGE LINE (TYP)

THERMOPLASTIC PAVEMENT MARKING 12" SOLID YELLOW DIAGONAL LINES (TYP)

PROPOSED HOT-MIX ASPHALT SURFACE REMOVAL, 2 1/2 " (TYP)  
 PROPOSED POLYMERIZED LEVELING BINDER, (MACHINE METHOD), IL-4.75, NS0, 3/4 " (TYP)  
 PROPOSED POLYMERIZED HOT-MIX ASPHALT SURFACE COURSE, MIX "F", N90, 1 3/4 " (TYP)

THERMOPLASTIC PAVEMENT MARKING 4" DOUBLE SOLID YELLOW LINE (TYP)

THERMOPLASTIC PAVEMENT MARKING 4" SOLID WHITE EDGE LINE (TYP)

PROPOSED HOT-MIX ASPHALT SURFACE REMOVAL, 2 1/2 " (TYP)  
 PROPOSED POLYMERIZED LEVELING BINDER, (MACHINE METHOD), IL-4.75, NS0, 3/4 " (TYP)  
 PROPOSED POLYMERIZED HOT-MIX ASPHALT SURFACE COURSE, MIX "F", N90, 1 3/4 " (TYP)

REVISIONS	
NAME	DATE

ILLINOIS DEPARTMENT OF TRANSPORTATION  
**ROADWAY PLAN**  
**WILLOW RD.**  
**W/O SUNSET RIDGE RD. TO I-94**  
 SCALE: VERT. \_\_\_\_\_  
 DATE: \_\_\_\_\_ HORIZ. \_\_\_\_\_  
 DRAWN BY \_\_\_\_\_  
 CHECKED BY \_\_\_\_\_

PLOT DATE = 2/7/2008  
 FILE NAME = c:\projects\dl21287\m\_rbd\p.dgn  
 PLOT SCALE = 50.0000 // IN.  
 USER NAME = gullcme@p