

CONTROL POINT 101 PIPE W/CAP
 N: 1,839,968.43 STA: 100+56.94
 E: 1,109,183.68 O/S: 37.9' RT
 ELEV: 704.550

CONTROL POINT 102 PIPE W/CAP
 N: 1,840,685.89 STA: 107+75.53
 E: 1,109,139.00 O/S: 19.0' RT
 ELEV: 721.880

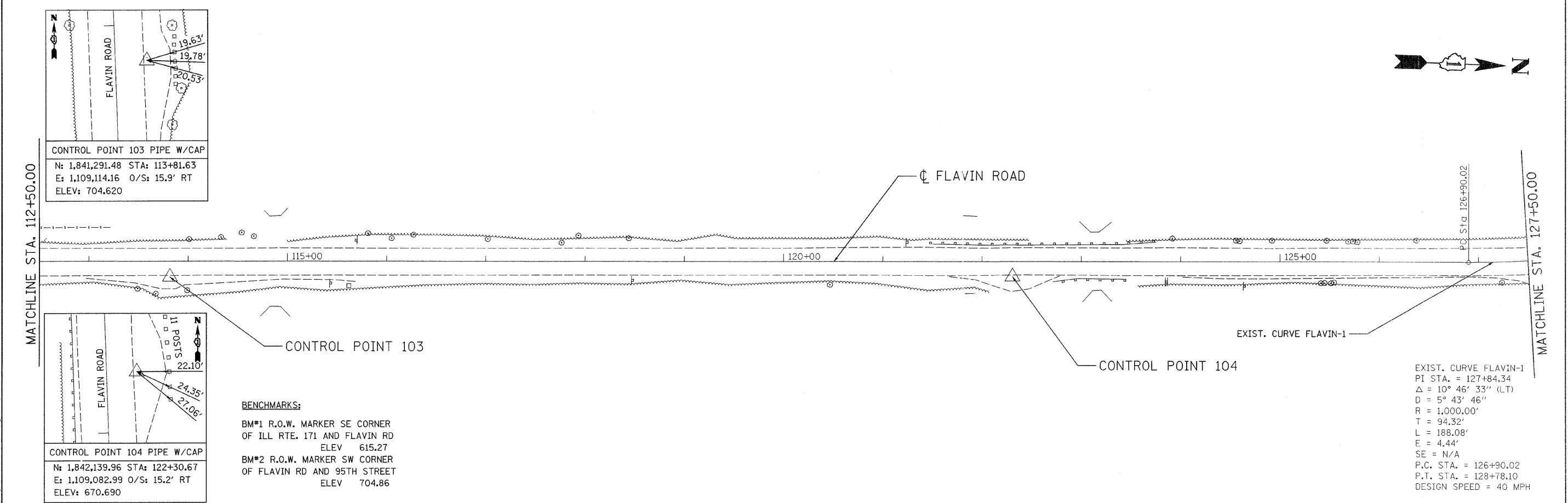

CONTROL POINT 103 PIPE W/CAP
 N: 1,841,291.48 STA: 113+81.63
 E: 1,109,114.16 O/S: 15.9' RT
 ELEV: 704.620

CONTROL POINT 104 PIPE W/CAP
 N: 1,842,139.96 STA: 122+30.67
 E: 1,109,082.99 O/S: 15.2' RT
 ELEV: 670.690

BENCHMARKS:
 BM#1 R.O.W. MARKER SE CORNER
 OF ILL. RTE. 171 AND FLAVIN RD
 ELEV 615.27
 BM#2 R.O.W. MARKER SW CORNER
 OF FLAVIN RD AND 95TH STREET
 ELEV 704.86

EXIST. CURVE FLAVIN-1
 PI STA. = 127+84.34
 $\Delta = 10^\circ 46' 33''$ (LT)
 $D = 5^\circ 43' 46''$
 $R = 1,000.00'$
 $T = 94.32'$
 $L = 188.08'$
 $E = 4.44'$
 $SE = N/A$
 P.C. STA. = 126+90.02
 P.T. STA. = 128+78.10
 DESIGN SPEED = 40 MPH

FILE NAME = m:\pco\3329\3329_20\design\Proposed\lan\3329_26-AL\GN1.dwg

CG Ciorba Group, Inc.
 CONSULTING ENGINEERS
 5507 North Cumberland Avenue, Suite 402
 Chicago, Illinois 60656
 Tel. 773.775.4009 Fax 773.775.4014

USER NAME = wlancoaster	DESIGNED - WBL	REVISED -
	DRAWN - WBL	REVISED -
PLOT SCALE = 50.0000' / IN.	CHECKED - MJL	REVISED -
PLOT DATE = 2/15/2008	DATE = 1/18/2008	REVISED -

**STATE OF ILLINOIS
 DEPARTMENT OF TRANSPORTATION**

**FAU 2679 (FLAVIN ROAD)
 IL 171 (ARCHER AVE.) TO 95TH ST.
 ALIGNMENT AND CONTROL POINTS**

SCALE: SHEET NO. OF SHEETS STA. TO STA.

F.A.P. RTE. 2697	SECTION 2007-051 0	COUNTY COOK	TOTAL SHEETS 29	SHEET NO. 6
FED. ROAD DIST. NO. ILLINOIS FED. AID PROJECT			CONTRACT NO. 60D43	