

F.A.P. RTE.	SECTION	COUNTY	TOTAL SHEETS	SHEET NO.
324	24 B-1	MCHENRY	13	1
FED. ROAD DIST. NO.	ILLINOIS	CONTRACT NO. 60D92		

STATE OF ILLINOIS  
DEPARTMENT OF TRANSPORTATION  
DIVISION OF HIGHWAYS

**PROPOSED  
HIGHWAY PLANS**

F.A.P. ROUTE 324: IL 23  
OVER COON CREEK  
SECTION 24B-1  
PPC DECK BEAM REPLACEMENT  
MCHENRY COUNTY  
C-91-126-08

FOR INDEX OF SHEETS, SEE SHEET NO. 2

IMPROVEMENT LOCATED IN RILEY TOWNSHIP

TRAFFIC DATA

2007 ADT = 2200  
POSTED SPEED LIMIT = 55 MPH

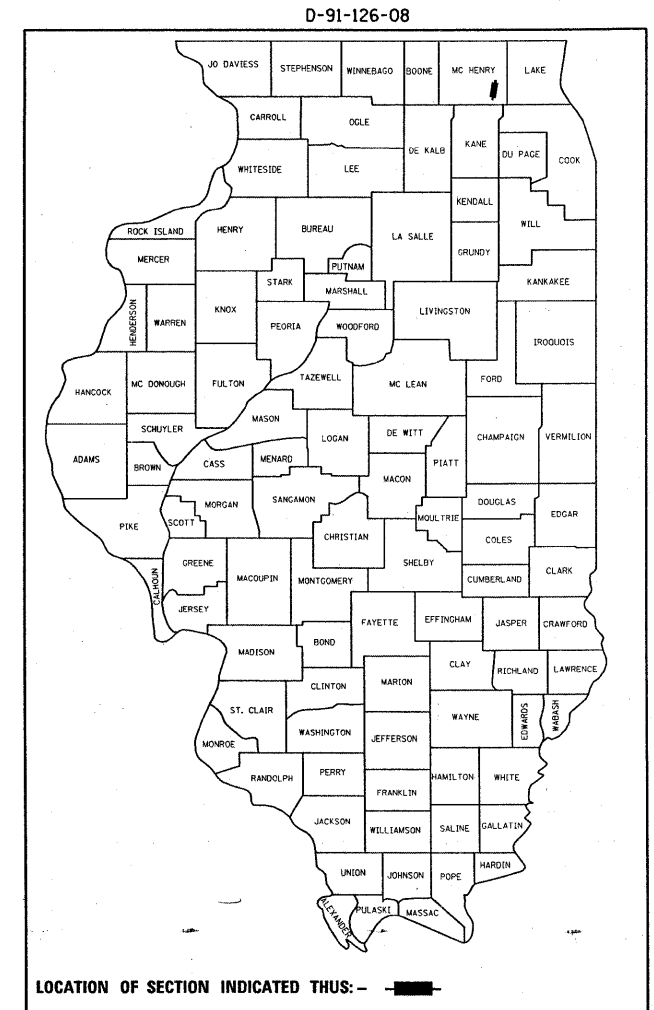

IMPROVEMENT LOCATION  
SN 056-0012

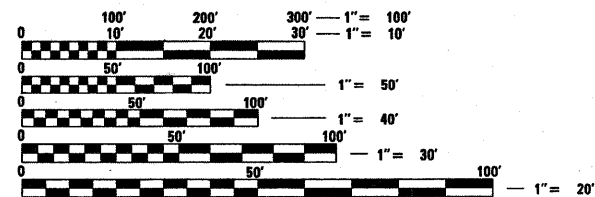

FULL SIZE PLANS HAVE BEEN PREPARED USING STANDARD ENGINEERING SCALES. REDUCED SIZED PLANS WILL NOT CONFORM TO STANDARD SCALES. IN MAKING MEASUREMENTS ON REDUCED PLANS, THE ABOVE SCALES MAY BE USED.

J.U.L.I.E.  
JOINT UTILITY LOCATION INFORMATION FOR EXCAVATION  
1-800-892-0123  
OR 811

PROJECT ENGINEER KEN ENG  
PROJECT MANAGER ROBERT BORO (847) 705-4178

CONTRACT NO. 60D92

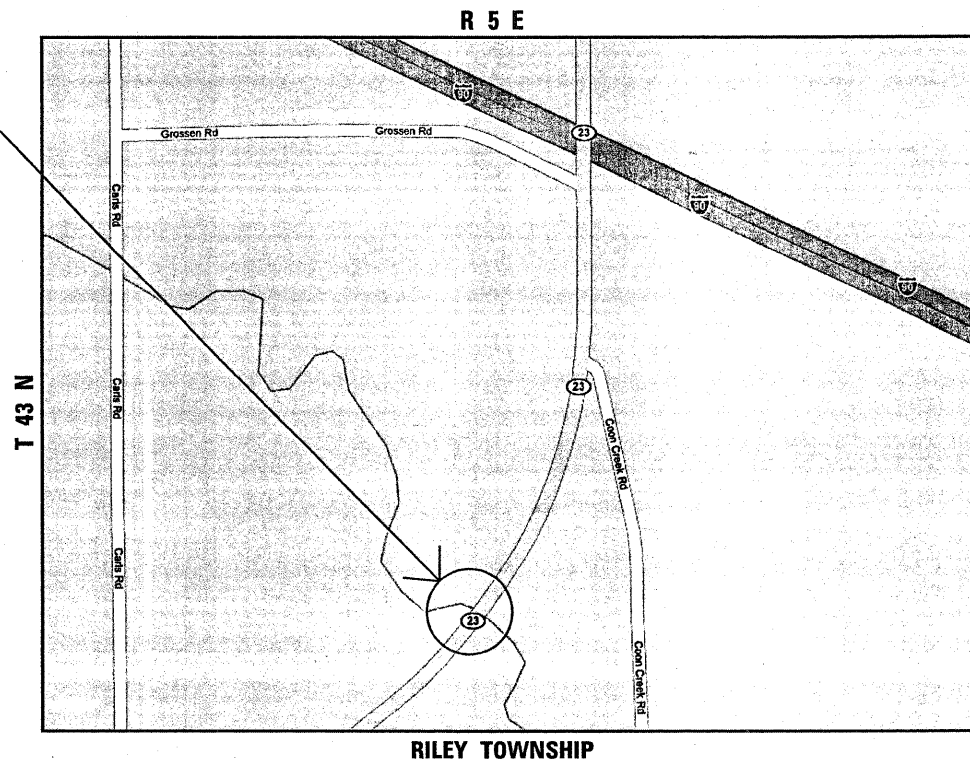

STATE OF ILLINOIS  
DEPARTMENT OF TRANSPORTATION  
DIVISION OF HIGHWAYS

SUBMITTED FEBRUARY 22, 2008

*Diana M. O'Keefe*  
DEPUTY DIRECTOR OF HIGHWAYS, REGION ENGINEER  
March 21, 2008

*Eric E. Heron*  
Interim ENGINEER OF DESIGN AND ENVIRONMENT  
March 21, 2008

*Christine M. Reed*  
DIRECTOR OF HIGHWAYS, CHIEF ENGINEER

PRINTED BY THE AUTHORITY  
OF THE STATE OF ILLINOIS