

F.A.J.L. RTE.	SECTION	COUNTY	TOTAL SHEETS	SHEET NO.
3561	2223 RS-2	COOK	21	7
STA. 24+82		TO STA. 32+59		
FED. ROAD DIST. NO. 1		ILLINOIS	HIGHWAY PROJECT	

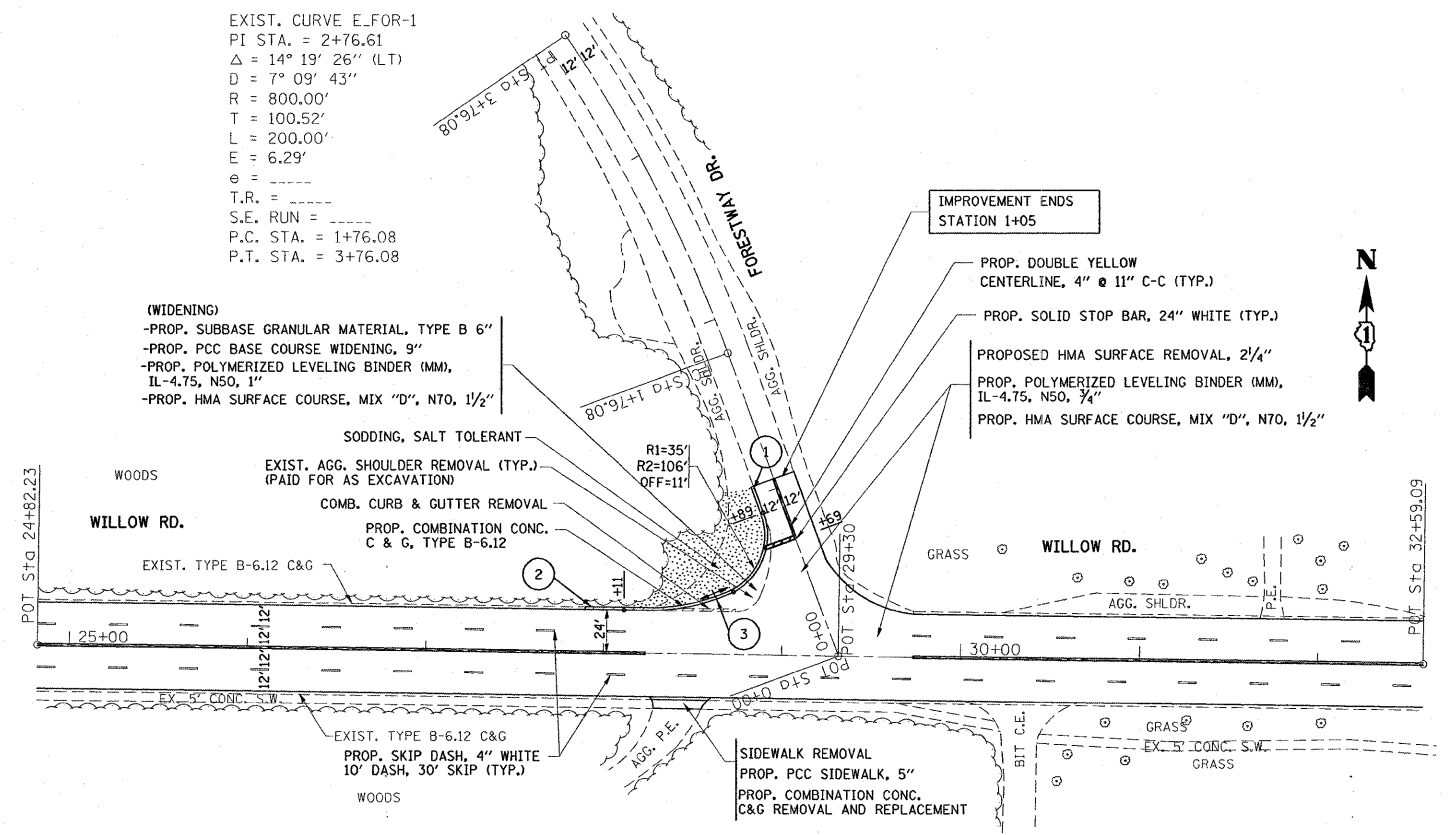

EXIST. CURVE E.FOR-1  
 PI STA. = 2+76.61  
 $\Delta = 14^\circ 19' 26''$  (LT)  
 $D = 7^\circ 09' 43''$   
 $R = 800.00'$   
 $T = 100.52'$   
 $L = 200.00'$   
 $E = 6.29'$   
 $e =$   
 $T.R. =$   
 $S.E. RUN =$   
 $P.C. STA. = 1+76.08$   
 $P.T. STA. = 3+76.08$

(WIDENING)  
 -PROP. SUBBASE GRANULAR MATERIAL, TYPE B 6"  
 -PROP. PCC BASE COURSE WIDENING, 9"  
 -PROP. POLYMERIZED LEVELING BINDER (MM), IL-4.75, N50, 1"  
 -PROP. HMA SURFACE COURSE, MIX "D", N70, 1 1/2"

IMPROVEMENT ENDS STATION 1+05  
 PROP. DOUBLE YELLOW CENTERLINE, 4" @ 11" C-C (TYP.)  
 PROP. SOLID STOP BAR, 24" WHITE (TYP.)  
 PROPOSED HMA SURFACE REMOVAL, 2 1/4"  
 PROP. POLYMERIZED LEVELING BINDER (MM), IL-4.75, N50, 3/4"  
 PROP. HMA SURFACE COURSE, MIX "D", N70, 1 1/2"

EXIST. AND PROP. GRADES			
	STATION	OFFSET	ELEVATION
①*	0+98.5	12'	MATCH EXIST RIM ELEV.
②	27+94	24'	MATCH EXIST RIM ELEV.
③	28+63	31'	100.20 PROP. HIGH POINT @ E.O.P.

\* TEMPORARY BENCH MARK

ROADWAY AND PAVEMENT MARKING PLAN

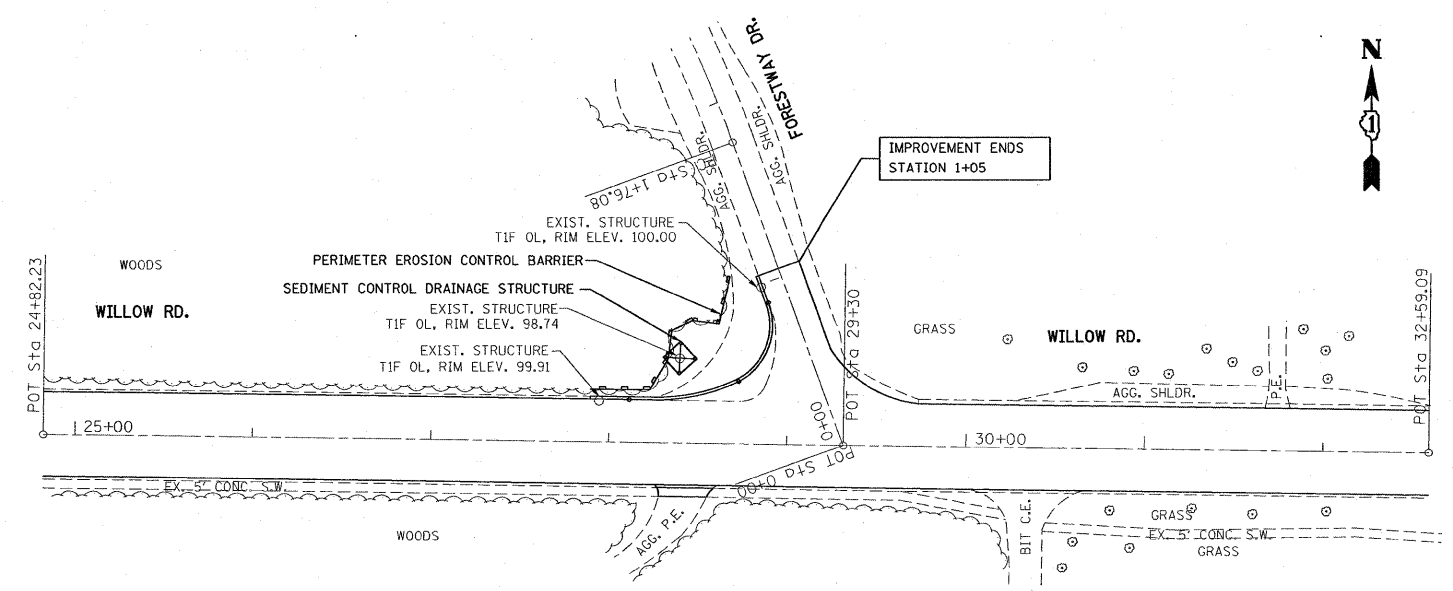

DRAINAGE AND EROSION CONTROL PLAN

REVISIONS	
NAME	DATE

ILLINOIS DEPARTMENT OF TRANSPORTATION  
 WILLOW ROAD  
 I-94 (EDENS EXPY.) TO HIBBARD ROAD  
 ROADWAY AND PAVEMENT MARKING PLAN  
 SCALE: VERT. 1"=50'  
 HORIZ. 1"=50'  
 DATE 1/25/2008  
 DRAWN BY:  
 CHECKED BY: