

F.A.P. RTE.	SECTION	COUNTY	TOTAL SHEETS	SHEET NO.
374	3268F-R-1	COOK	279	38
STA. 174+00.00		TO STA. 200+00.00		
FED. ROAD DIST. NO.	ILLINOIS	FED. AID PROJECT		

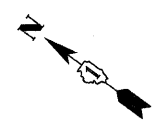
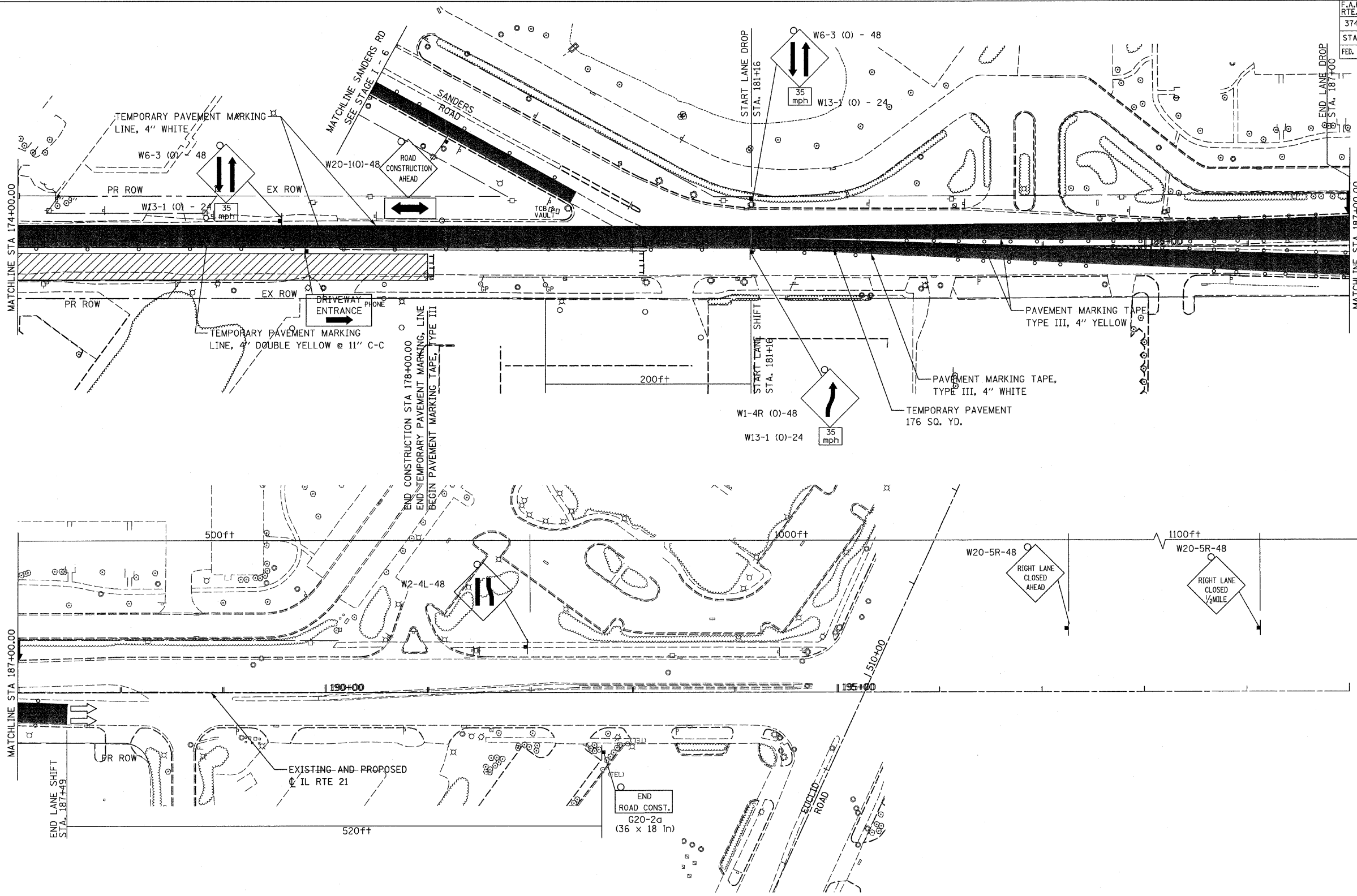

- LEGEND:**
- STAGE I TRAFFIC
  - STAGE I CONSTRUCTION
  - TEMPORARY PAVEMENT
  - DIRECTION OF TRAFFIC
  - DRUM WITH STEADY BURN LIGHT
  - TEMPORARY SIGN
  - ARROW BOARD
  - CONSTRUCTION SPEED LIMIT
  - BARRICADE TYPE III WITH STEADY BURN LIGHTS
  - FLASHING LIGHT

**NOTE:**  
 1. FOR TEMPORARY TRAFFIC SIGNAL LOCATIONS, SEE TEMPORARY TRAFFIC SIGNAL INSTALLATION PLANS.

REVISIONS	
NAME	DATE

ILLINOIS DEPARTMENT OF TRANSPORTATION  
**SUGGESTED STAGES OF CONSTRUCTION AND TRAFFIC CONTROL**  
 STAGE I - 5  
 ILLINOIS ROUTE 21  
 STA 174+00.00 TO STA 200+00.00

DATE: 02/05/08  
 DRAWN BY: RDT  
 CHECKED BY: GC

**STV Incorporated**  
 engineers/architects/scientists/construction managers  
 200 W Monroe - Suite 1650  
 Chicago, Illinois 60606