

F.A.P. RTE.	SECTION	COUNTY	TOTAL SHEETS	SHEET NO.
374	3268F-R-1	COOK	279	44
STA. 174+00.00		TO STA. 200+00.00		
FED. ROAD DIST. NO.		ILLINOIS	FED. AID PROJECT	

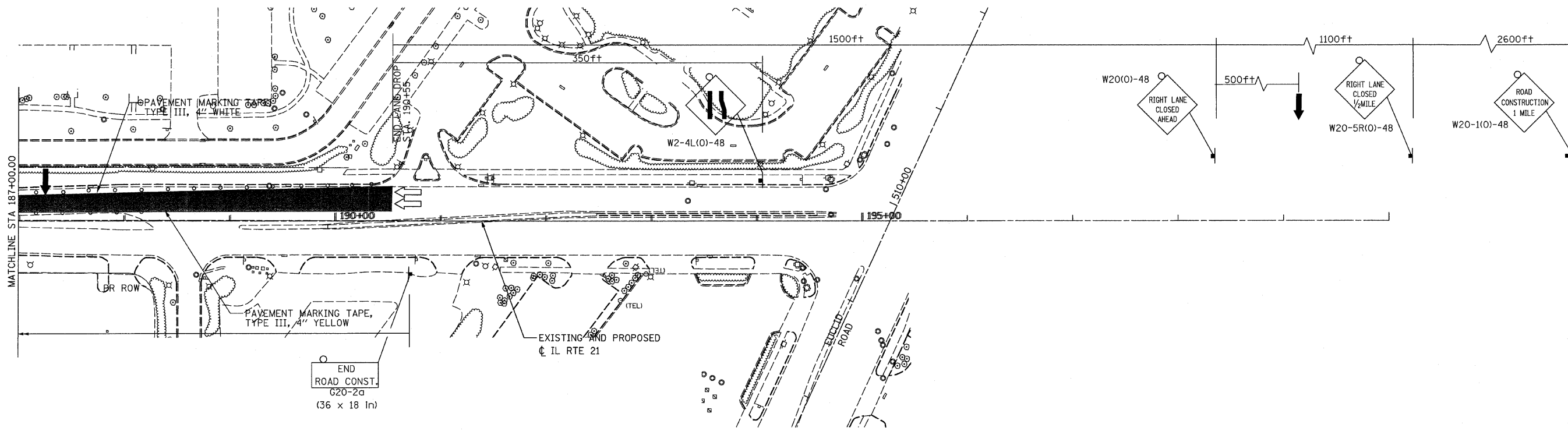
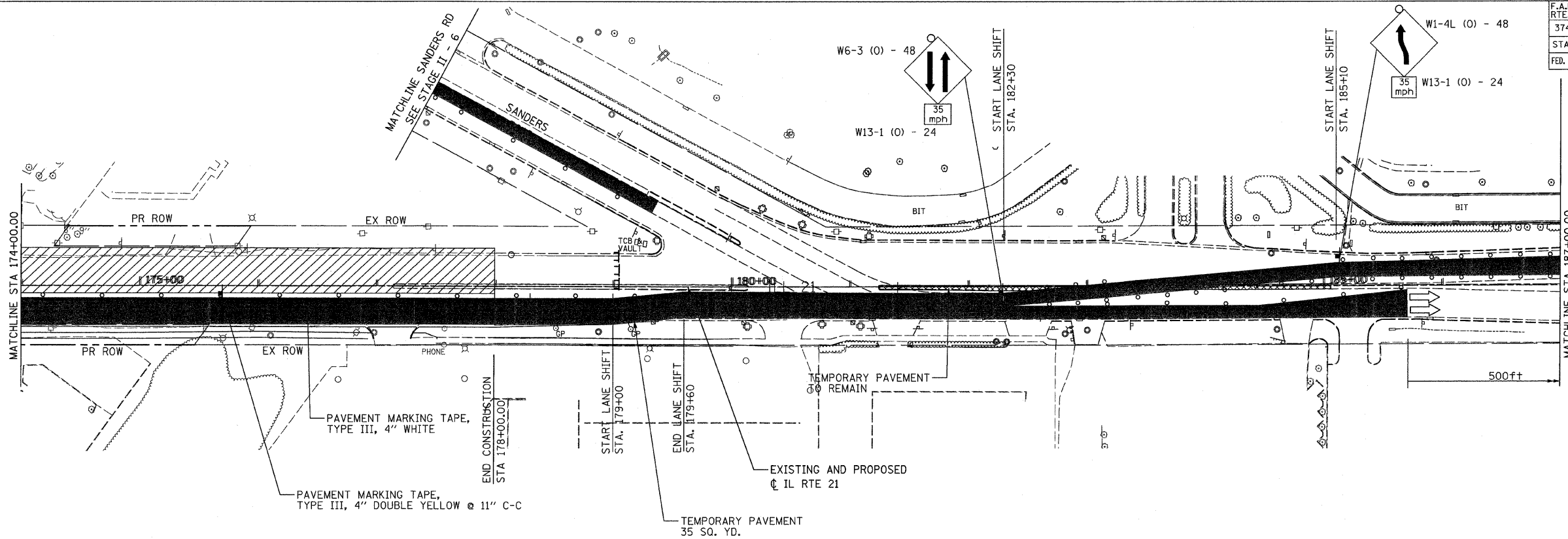

LEGEND:

- STAGE II TRAFFIC
- STAGE II CONSTRUCTION
- TEMPORARY PAVEMENT
- DIRECTION OF TRAFFIC
- DRUM WITH STEADY BURN LIGHT
- TEMPORARY SIGN
- ARROW BOARD
- CONSTRUCTION SPEED LIMIT
- BARRICADE TYPE III WITH STEADY BURN LIGHTS
- FLASHING LIGHT

NOTE:

1. FOR TEMPORARY TRAFFIC SIGNAL LOCATIONS, SEE TEMPORARY TRAFFIC SIGNAL INSTALLATION PLANS.

REVISIONS	
NAME	DATE

ILLINOIS DEPARTMENT OF TRANSPORTATION
SUGGESTED STAGES OF CONSTRUCTION AND TRAFFIC CONTROL
 STAGE II - 5
 ILLINOIS ROUTE 21
 STA 174+00.00 TO STA 200+00.00

DATE: 02/05/08
 DRAWN BY: RDT
 CHECKED BY: GC

0 50' 100'
 1" = 50'

STV Incorporated
 engineers/architects/scientists/construction managers
 200 W Monroe - Suite 1650
 Chicago, Illinois 60606

ILLINOIS DEPARTMENT OF TRANSPORTATION
 STATE OF ILLINOIS
 CONTRACT NO. 3268F-R-1
 SHEET NO. 44 OF 279