

F.A.P. RTE.	SECTION	COUNTY	TOTAL SHEETS	SHEET NO.
374	3268F-R-1	COOK	279	107
STA.	TO STA.			
FED. ROAD DIST. NO.	ILLINOIS	FED. AID PROJECT		
CONTRACT NO. 62387				

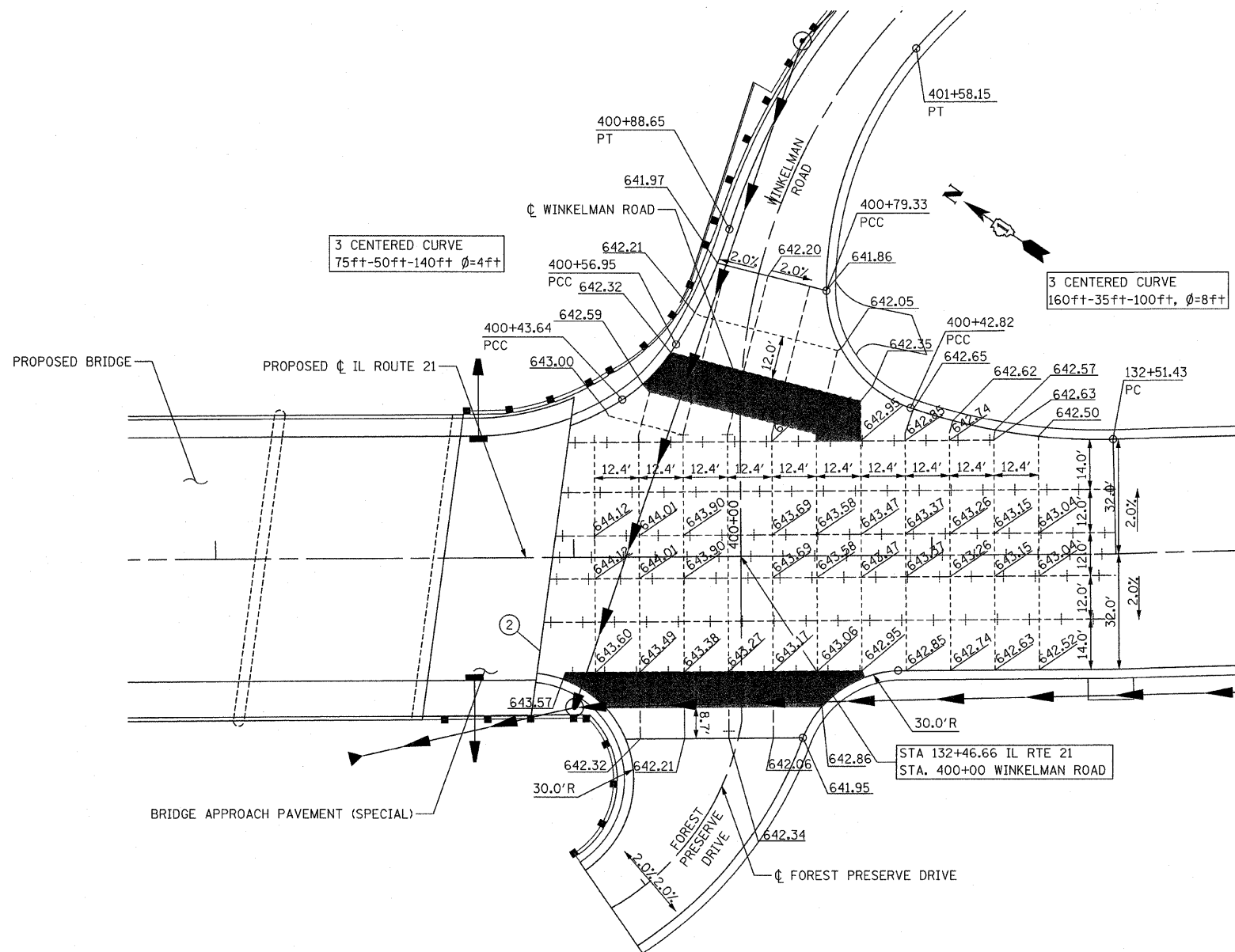

LEGEND

---+---+---	LONGITUDINAL CONSTRUCTION JOINT
-----	SAWED TRANSVERSE JOINT
-----	SAWED LONGITUDINAL JOINT
①	3/4" FULL DEPTH TRANSVERSE JOINT FILL WITH PREFORMED EXPANSION JOINT FILLER.
②	2" TRANSVERSE JOINT
■	TRANSITION PANEL (DOWELS ON ALL SIDES)

- NOTES:**
- FOR MORE INFO, SEE STANDARDS 420001, 420101, AND 606001.
 - ADDITIONAL SAWED CONTRACTION JOINTS MAY BE REQUIRED IN THE FIELD AS DIRECTED BY THE ENGINEER. EXACT LOCATIONS TO BE VERIFIED IN THE FIELD AND APPROVED BY THE ENGINEER.
 - PAVEMENT BLOCK-OUTS FOR MANHOLES, VALVE VAULTS, AND OTHER STRUCTURES SHALL BE CONSTRUCTED IN ACCORDANCE WITH STANDARD 420111.
 - CONTRACTOR TO VERIFY ELEVATION OF EXISTING PAVEMENT PRIOR TO CONSTRUCTION.
 - FOR BRIDGE INFO SEE STRUCTURAL PLANS.
 - FOR BRIDGE APPROACH PAVEMENT SEE STRUCTURAL PLANS.

REVISIONS	
NAME	DATE

ILLINOIS DEPARTMENT OF TRANSPORTATION

INTERSECTION DETAIL
ILLINOIS ROUTE 21
AT WINKELMAN ROAD AND
FOREST PRESERVE DRIVE

0 10 20 40
SCALE IN FEET

DATE: 02/05/08
DRAWN BY: RDT
CHECKED BY: GC

STV Incorporated
engineers/architects/scientists/construction managers
200 W Monroe - Suite 1650
Chicago, Illinois 60606