

F.A.P. RTE.	SECTION	COUNTY	TOTAL SHEETS	SHEET NO.
374	3268F-R-1	COOK	279	112
STA. 109+00.00		TO STA. 122+00.00		
FED. ROAD DIST. NO.		ILLINOIS FED. AID PROJECT		
CONTRACT NO. 62387				

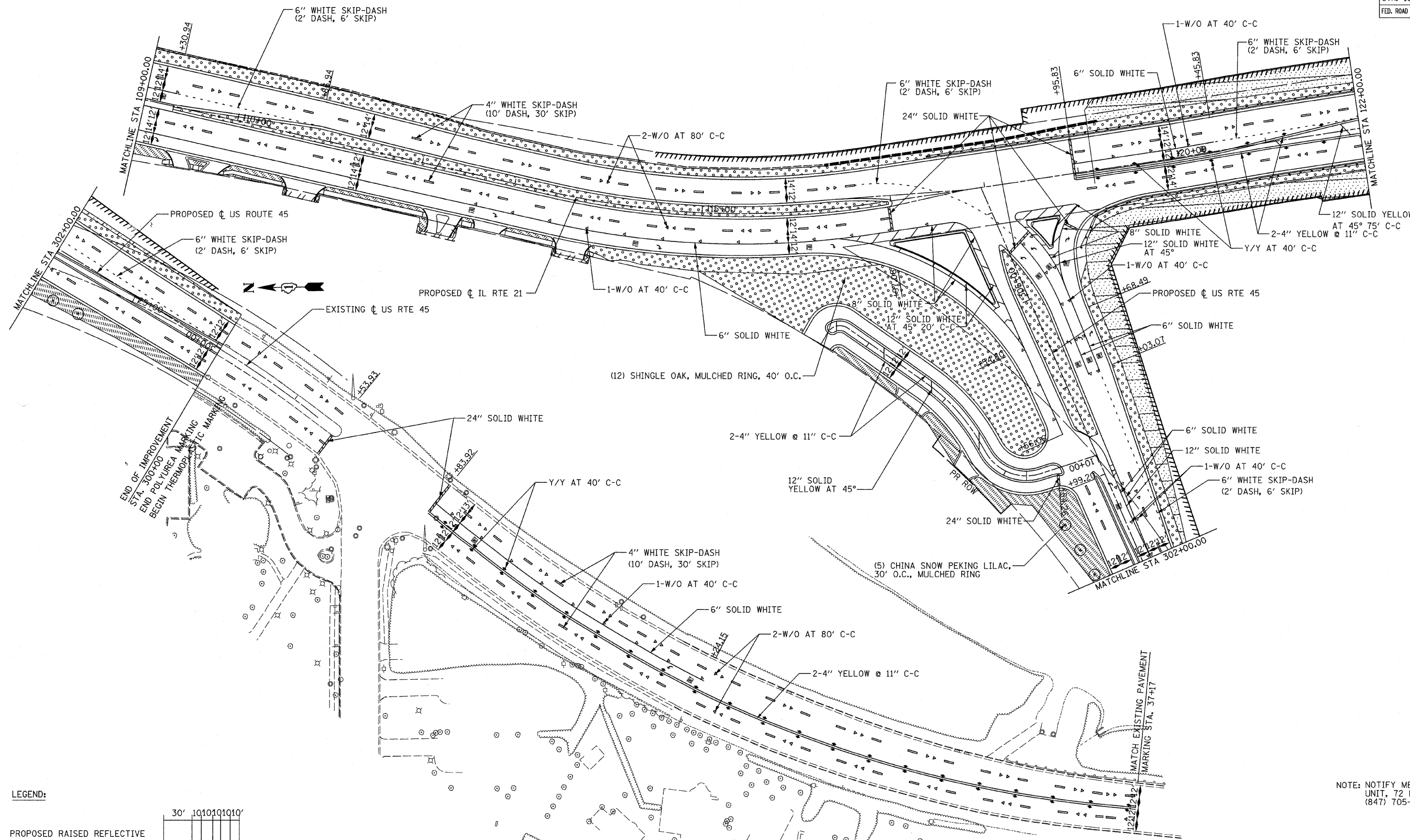

**LEGEND:**

PROPOSED RAISED REFLECTIVE PAVEMENT MARKERS

WHITE / OPAQUE      W/O  
 YELLOW / YELLOW      Y/Y

SODDING, SALT TOLERANT  
 SEEDING, CLASS 2A  
 SEEDING, CLASS 4

30' 1010101010'

NOTE: NOTIFY MELISSA DEL ROSARIO, ROADSIDE UNIT, 72 HOURS PRIOR TO PLANTING AT (847) 705-4171 FOR LAYOUT.

REVISIONS	
NAME	DATE

ILLINOIS DEPARTMENT OF TRANSPORTATION  
**PAVEMENT MARKING AND LANDSCAPING PLAN - 2**

ILLINOIS ROUTE 21  
 STA 109+00.00 TO STA 122+00.00

DATE: 02/05/08  
 DRAWN BY: RDT  
 CHECKED BY: GC

0 50' 100'  
 1" = 50'

**STV Incorporated**  
 engineers/architects/scientists/construction managers  
 200 W Monroe - Suite 1650  
 Chicago, Illinois 60606