

F.A.P. RTE.	SECTION	COUNTY	TOTAL SHEETS	SHEET NO.
374	3268F-R-1	COOK	279	184
STA.		TO STA.		
FED. ROAD DIST. NO.	ILLINOIS	FED. AID PROJECT		
CONTRACT NO. 62387				

TEMPORARY CABLE PLAN LEGEND

- R TEMPORARY TRAFFIC SIGNAL SECTION OR PEDESTRIAN SIGNAL SECTION 12" (300mm)
- 12" (300mm) PEDESTRIAN SIGNAL SECTION
- TEMPORARY CONTROLLER CABINET
- TEMPORARY UNINTERRUPTIBLE POWER SUPPLY
- TEMPORARY SERVICE INSTALLATION
- EMERGENCY VEHICLE LIGHT DETECTOR
- CONFIRMATION BEACON
- PUSH-BUTTON DETECTOR
- VIDEO VEHICLE DETECTOR
- 2 DENOTES NUMBER OF CONDUCTORS ALL CABLE NO. 14 EXCEPT AS INDICATED ALL LOOP DETECTOR CABLE TO BE SHIELDED
- 24 FIBER OPTIC CABLE NO. 62.5/125 MM12F SM12F
- V VIDEO DETECTOR CABLE PER VIDEO SYSTEM MANUFACTURER'S RECOMMENDATION
- GROUND ROD

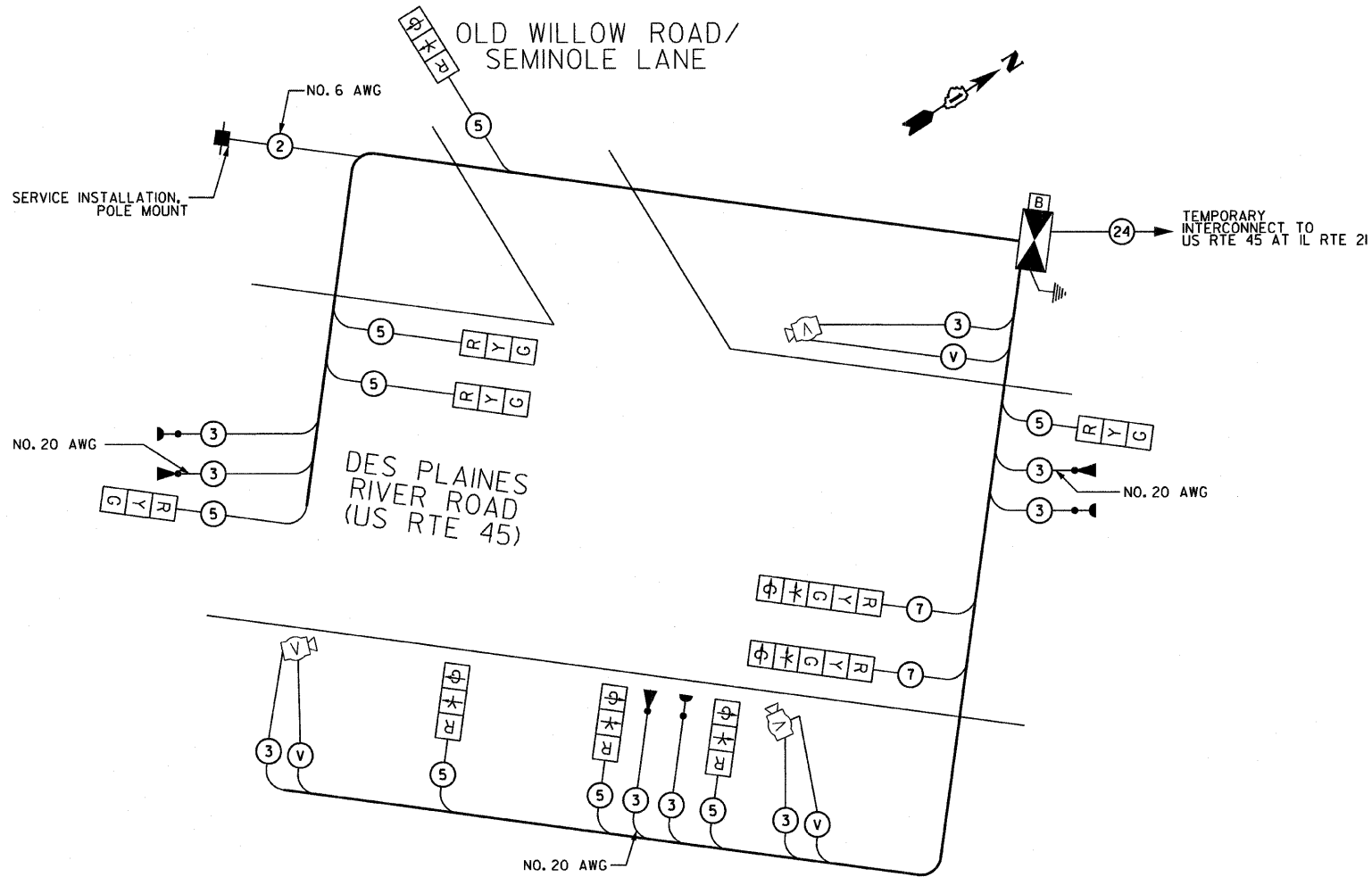

TEMPORARY CABLE PLAN

CONTROLLER SEQUENCE

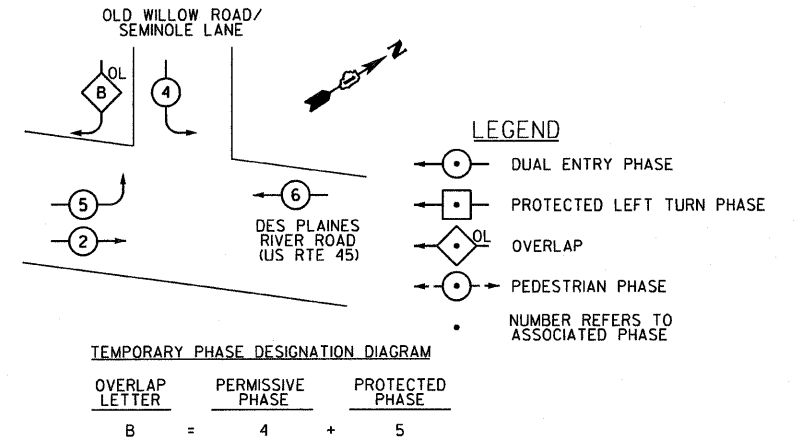

EMERGENCY VEHICLE PRIORITY SEQUENCE

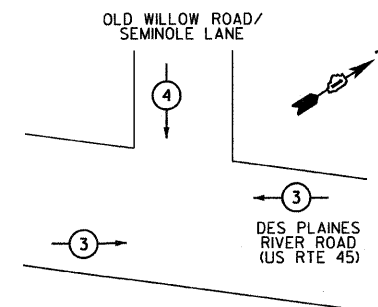

EMERGENCY VEHICLE PREEMPTORS	
EMERGENCY VEHICLE PREEMPTOR	3 4
MOVEMENT	

NOTE: THE POST-CONSTRUCTION STAGE IS THE PERIOD AFTER ALL LANES HAVE BEEN CONSTRUCTED AND OPENED TO TRAFFIC, BUT BEFORE THE NEW PERMANENT TRAFFIC SIGNAL HAS BEEN ACTIVATED.

TS-24 OF 39

I.D.O.T. TRAFFIC SIGNAL INSTALLATION ELECTRICAL SERVICE REQUIREMENTS					TOTAL WATTAGE
TYPE	NO. OF LAMPS	WATTAGE	INCAND. LED % OPERATION		
SIGNAL (RED)	10	135	17	0.50	85
(YELLOW)	10	135	25	0.25	62.5
(GREEN)	10	135	15	0.25	37.5
ARROW	4	135	12	0.10	4.8
PED. SIGNAL		90	25	1.00	
CONTROLLER	1	100	100	1.00	100
ILLUM. SIGN		252		0.05	
FLASHER				0.50	
TOTAL =					289.8

NOTE: THE TEMPORARY TRAFFIC SIGNAL CONTROL EQUIPMENT FOR THIS INTERSECTION SHALL BE "ECONOLITE" BRAND TO MATCH THE EXISTING SYSTEM.

FOUNDATION (DEPTH)	FT. (m)	CABLE SLACK	FT. (m)	VERTICAL	FT. (m)
TYPE A - POST	4 (1.2)	HANDHOLE	6.5 (2.0)	ALL FOUNDATIONS	3.5 (1.0)
D - CONTROLLER	4 (1.2)	DOUBLE HANDHOLE	13 (4.0)	MAST ARM (L) POLE	20'+L-2' = (6m+L-0.6m) =
E - M. ARM POLE		SIGNAL POST	2 (0.6)	BRACKET MOUNTED	13 (4.0)
24" (600 mm)	10 (3.0)	CONTROLLER CAB.	1 (0.5)	PED PUSHBUTTON	4 (1.2)
30" (750 mm)	15 (4.6)	FIBER OPTIC	13 (4.0)	ELECTRIC SERVICE	13.5 (4.1)
		ELECTRIC SERVICE	1 (0.5)	SERVICE TO GROUND	13.5 (4.1)
		GROUND CABLE	1 (0.5)	POST MOUNTED	6 (1.8)

**SPAAN Tech, Inc.**  
 311 S. Wacker Drive, Suite 2400  
 Chicago, Illinois 60606  
 phone: 312.277.8800  
 fax: 312.277.8808  
 web: www.SpaanTech.com

REVISIONS		ILLINOIS DEPARTMENT OF TRANSPORTATION
NAME	DATE	
		TEMPORARY CABLE PLAN AND TEMPORARY PHASE DESIGNATION DIAGRAM DES PLAINES RIVER ROAD (US RTE 45) AT OLD WILLOW ROAD/SEMINOLE LANE PRE-STAGE I, POST STAGE II, AND POST-CONSTRUCTION  SCALE: NONE DATE: 02/05/08 DRAWN BY: RAS DESIGN BY: RAS CHECKED BY: ADD

def:chd  
 07/17/00 - ILL Rte 21 - DOT Dist 1  
 07/17/00 - ILL Rte 21 - DOT Dist 1  
 pa:07167:000 - ILL Rte 21 - Working Files\Working Files\shd\Final\TS-24.dgn  
 20.00000 # / IN.  
 11:52:43 AM  
 1/30/2008

ENERGY COSTS TO:  
 VILLAGE OF MOUNT PROSPECT (50%) 60056  
 50 SOUTH EMERSON STREET/MOUNT PROSPECT, ILLINOIS  
 CITY OF PROSPECT HEIGHTS (50%) 60070  
 8 NORTH ELMHURST ROAD/PROSPECT HEIGHTS, ILLINOIS  
 ENERGY SUPPLY CONTACT: **MS. JUDY SCHOMER**  
 PHONE: (847) 870-2056  
 COMPANY: COMED