













| F.A.P. RTE.        | SECTION   | COUNTY                                        | TOTAL SHEETS | SHEET NO. |
|--------------------|-----------|-----------------------------------------------|--------------|-----------|
| 374                | 326BF-R-1 | COOK                                          | 279          | 186       |
| STA. TO STA.       |           | FED. ROAD DIST. NO. ILLINOIS FED. AID PROJECT |              |           |
| CONTRACT NO. 62387 |           |                                               |              |           |

TEMPORARY CABLE PLAN LEGEND

-  TEMPORARY TRAFFIC SIGNAL SECTION OR PEDESTRIAN SIGNAL SECTION 12" (300mm)
-  12" (300mm) PEDESTRIAN SIGNAL SECTION
-  TEMPORARY CONTROLLER CABINET
-  TEMPORARY UNINTERRUPTIBLE POWER SUPPLY
-  TEMPORARY SERVICE INSTALLATION
-  EMERGENCY VEHICLE LIGHT DETECTOR
-  CONFIRMATION BEACON
-  PUSH-BUTTON DETECTOR
-  VIDEO VEHICLE DETECTOR
-  DENOTES NUMBER OF CONDUCTORS ALL CABLE NO. 14 EXCEPT AS INDICATED ALL LOOP DETECTOR CABLE TO BE SHIELDED
-  FIBER OPTIC CABLE NO. 62.5/125 MM2F SMI2F
-  VIDEO DETECTOR CABLE PER VIDEO SYSTEM MANUFACTURER'S RECOMMENDATION
-  GROUND ROD

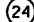

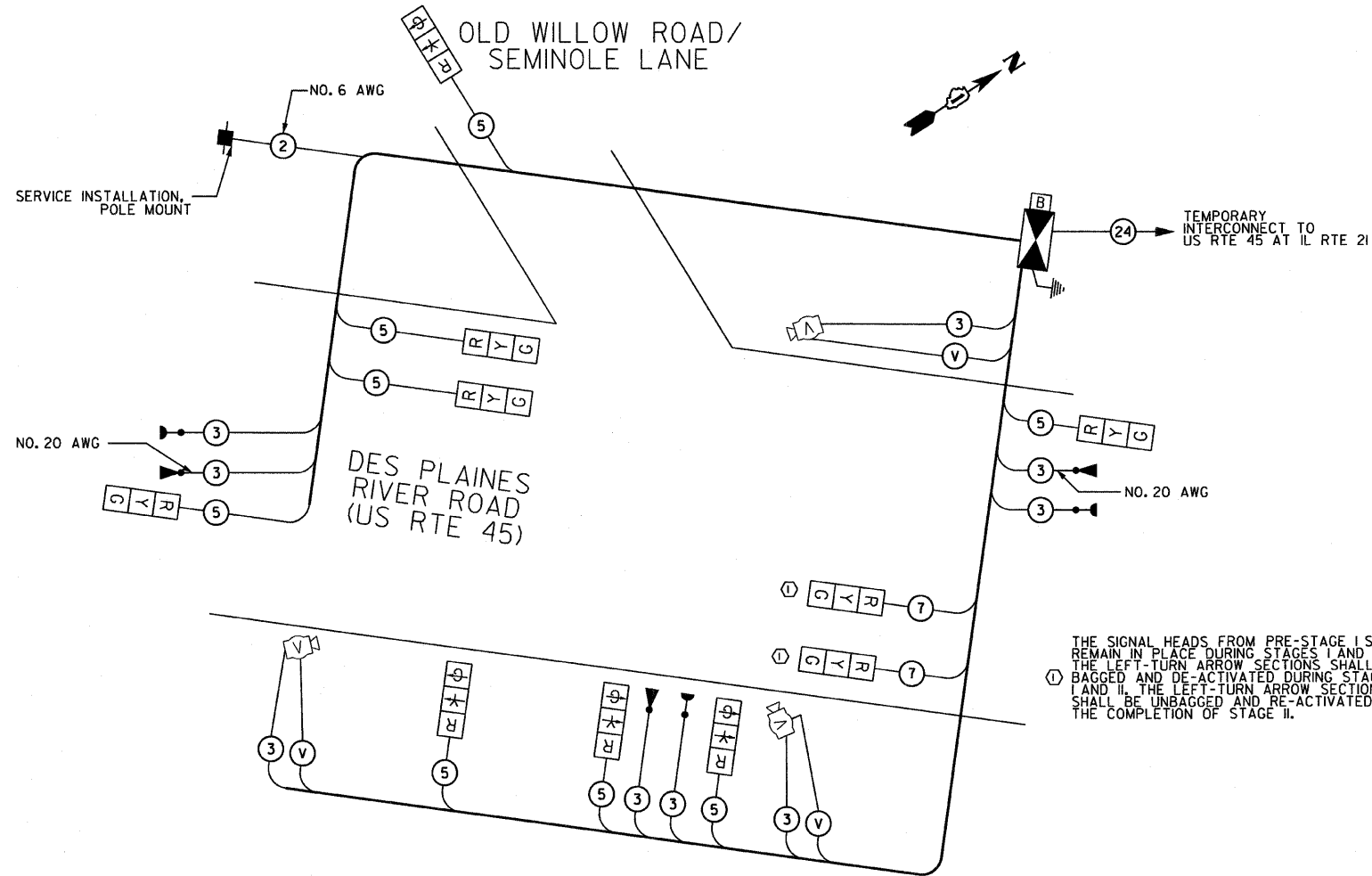
TEMPORARY CABLE PLAN

CONTROLLER SEQUENCE

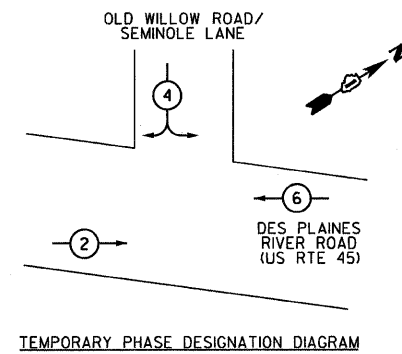

TEMPORARY PHASE DESIGNATION DIAGRAM

EMERGENCY VEHICLE PRIORITY SEQUENCE

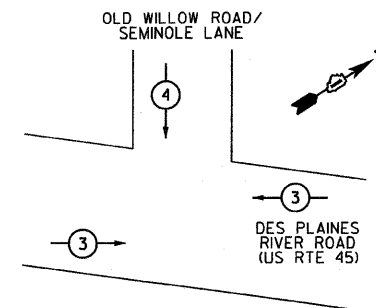

| EMERGENCY VEHICLE PREEMPTORS |     |
|------------------------------|-----|
| EMERGENCY VEHICLE PREEMPTOR  | 3 4 |
| MOVEMENT                     | ← ↓ |

NOTE: THE TEMPORARY TRAFFIC SIGNAL CONTROL EQUIPMENT FOR THIS INTERSECTION SHALL BE "ECONOLITE" BRAND TO MATCH THE EXISTING SYSTEM.

TS-26 OF 39

| I.D.O.T. TRAFFIC SIGNAL INSTALLATION ELECTRICAL SERVICE REQUIREMENTS |              |         |             |      | TOTAL WATTAGE |
|----------------------------------------------------------------------|--------------|---------|-------------|------|---------------|
| TYPE                                                                 | NO. OF LAMPS | WATTAGE | % OPERATION |      |               |
| SIGNAL (RED)                                                         | 10           | 135     | 17          | 0.50 | 85            |
| (YELLOW)                                                             | 10           | 135     | 25          | 0.25 | 62.5          |
| (GREEN)                                                              | 10           | 135     | 15          | 0.25 | 37.5          |
| ARROW                                                                |              | 135     | 12          | 0.10 |               |
| PED. SIGNAL                                                          |              | 90      | 25          | 1.00 |               |
| CONTROLLER                                                           | 1            | 100     | 100         | 1.00 | 100           |
| ILLUM. SIGN                                                          |              | 252     |             | 0.05 |               |
| FLASHER                                                              |              |         |             | 0.50 |               |
| TOTAL =                                                              |              |         |             |      | 285           |

ENERGY COSTS TO: VILLAGE OF MOUNT PROSPECT (50%) 50 SOUTH EMERSON STREET/MOUNT PROSPECT, ILLINOIS 60056  
 CITY OF PROSPECT HEIGHTS (50%) 8 NORTH ELMHURST ROAD/PROSPECT HEIGHTS, ILLINOIS 60070  
 ENERGY SUPPLY CONTACT: MS. JUDY SCHOMER  
 PHONE: (847) 870-2056  
 COMPANY: COMED

| FOUNDATION (DEPTH) | FT. (m)  | CABLE SLACK      | FT. (m)   | VERTICAL          | FT. (m)              |
|--------------------|----------|------------------|-----------|-------------------|----------------------|
| TYPE A - POST      | 4 (1.2)  | HANDHOLE         | 6.5 (2.0) | ALL FOUNDATIONS   | 3.5 (1.0)            |
| D - CONTROLLER     | 4 (1.2)  | DOUBLE HANDHOLE  | 13 (4.0)  | MAST ARM (L) POLE | 20'+L-2' (6m+L-0.6m) |
| E - M. ARM POLE    |          | SIGNAL POST      | 2 (1.0)   | BRACKET MOUNTED   | 13 (4.0)             |
| 24" (600 mm)       | 10 (3.0) | CONTROLLER CAB.  | 1 (0.5)   | PED PUSHBUTTON    | 4 (1.2)              |
| 30" (750 mm)       | 15 (4.6) | FIBER OPTIC      | 13 (4.0)  | ELECTRIC SERVICE  | 13.5 (4.1)           |
|                    |          | ELECTRIC SERVICE | 1 (0.5)   | SERVICE TO GROUND | 13.5 (4.1)           |
|                    |          | GROUND CABLE     | 1 (0.5)   | POST MOUNTED      | 6 (1.8)              |

**SPAAN Tech, Inc.**  
 311 S. Wacker Drive, Suite 2400  
 Chicago, Illinois 60606  
 phone: 312.277.8800  
 fax: 312.277.8808  
 web: www.SpaanTech.com

| REVISIONS |      |
|-----------|------|
| NAME      | DATE |
|           |      |
|           |      |
|           |      |
|           |      |
|           |      |
|           |      |
|           |      |
|           |      |
|           |      |

ILLINOIS DEPARTMENT OF TRANSPORTATION  
 TEMPORARY CABLE PLAN AND TEMPORARY PHASE DESIGNATION DIAGRAM  
 DES PLAINES RIVER ROAD (US RTE 45)  
 AT OLD WILLOW ROAD/SEMINOLE LANE STAGES I AND II  
 SCALE: NONE  
 DATE: 02/05/08  
 DRAWN BY: RAS  
 DESIGN BY: RAS  
 CHECKED BY: ADD

default  
 untitled  
 07167.000 - ILL Rte 21 - IDOT Dist 1  
 p:\07167.000 - ILL Rte 21 - IDOT Dist 1\Working Files\Drawings Files\shnt\Final\TS15-26.dgn  
 2/30/2008 11:55:22 AM 20.0000 # / IN.