

F.A.P. RTE.	SECTION	COUNTY	TOTAL SHEETS	SHEET NO.
374	326BF-R-1	COOK	279	189
STA. 176+58.67		TO STA. 183+28.67		
FED. ROAD DIST. NO.	ILLINOIS	FED. AID PROJECT		
CONTRACT NO. 62387				

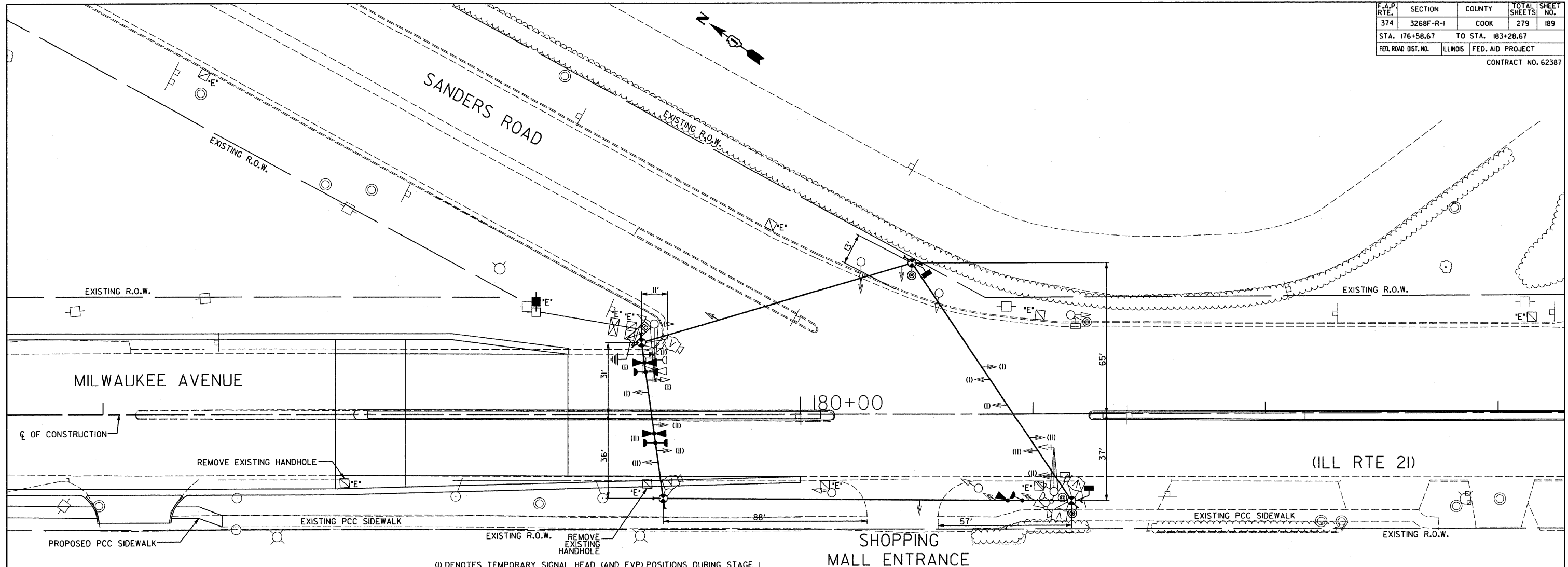

(I) DENOTES TEMPORARY SIGNAL HEAD (AND EVP) POSITIONS DURING STAGE I
 (II) DENOTES TEMPORARY SIGNAL HEAD (AND EVP) POSITIONS DURING STAGE II
 TEMPORARY SIGNAL HEADS (AND EVP) POSITIONS FOR SANDERS ROAD AND THE SHOPPING MALL ENTRANCE ARE TO REMAIN THE SAME FOR BOTH STAGES.

IN THE PERIODS PRIOR TO THE PLACEMENT OF STAGE I TRAFFIC STAGING AND AFTER THE REMOVAL OF STAGE II TRAFFIC STAGING, THE SIGNAL HEADS FOR NB MILWAUKEE AVENUE SHALL BE PLACED IN THEIR STAGE I POSITIONS. THE SIGNAL HEADS FOR SB MILWAUKEE AVENUE SHALL BE PLACED IN THEIR STAGE II POSITIONS.

NOTES FOR TEMPORARY TRAFFIC SIGNALS

- ALL CONTROL EQUIPMENT INCLUDING EMERGENCY VEHICLE PRE-EMPTION AND COMMUNICATION DEVICES FOR THE TEMPORARY TRAFFIC SIGNAL(S) SHALL BE FURNISHED BY THE CONTRACTOR.
- ONLY CONTROLLERS SUPPLIED BY ONE OF THE DISTRICT APPROVED CLOSED LOOP EQUIPMENT MANUFACTURERS WILL BE APPROVED FOR USE AT TEMPORARY SIGNAL LOCATIONS. ALL CONTROLLERS USED FOR TEMPORARY TRAFFIC SIGNALS SHALL BE FULLY ACTUATED NEMA MICROPROCESSOR BASED WITH RS232 DATA ENTRY PORTS COMPATIBLE WITH EXISTING MONITORING SOFTWARE APPROVED BY IDOT DISTRICT 1, INSTALLED IN A NEMA TS1 OR TS2 CABINET. ONLY ONE BRAND OF CONTROLLER WILL BE ACCEPTED FOR ANY ONE CONTRACT.
- ALL TRAFFIC SIGNAL SECTIONS AND PEDESTRIAN SIGNAL SECTIONS SHALL BE 12" (300 mm). HEADS SHALL BE PLACED AS INDICATED ON THE TEMPORARY TRAFFIC SIGNAL PLAN OR AS DIRECTED BY THE ENGINEER. THE CONTRACTOR SHALL FURNISH ENOUGH CABLE SLACK TO RELOCATE HEADS TO ANY POSITION ON THE SPAN WIRE OR AT LOCATIONS ILLUSTRATED ON THE PLANS FOR CONSTRUCTION STAGING. THE TEMPORARY TRAFFIC SIGNAL SHALL REMAIN IN OPERATION DURING ALL SIGNAL HEAD RELOCATIONS. EACH TEMPORARY TRAFFIC SIGNAL HEAD SHALL HAVE ITS OWN CABLE FROM THE CONTROLLER CABINET TO THE SIGNAL HEAD.
- ALL EXISTING STREET NAME AND INTERSECTION REGULATORY SIGNS SHALL BE REMOVED FROM EXISTING POLES, RELOCATED AND SECURELY FASTENED TO THE SIGNAL SPAN WIRE OR WOOD POLE AS DIRECTED BY THE ENGINEER.
- ANY TEMPORARY SIGNAL WITHIN AN EXISTING CLOSED LOOP TRAFFIC SIGNAL SYSTEM SHALL BE INTERCONNECTED TO THAT SYSTEM USING SIMILAR BRAND CONTROL EQUIPMENT.
- THE TEMPORARY SIGNAL SHALL HAVE THE SIGNAL HEAD DISPLAYS, SIGNAL HEAD PLACEMENTS AND CONTROLLER PHASING MATCH THE EXISTING TRAFFIC SIGNAL, AT THE TIME OF THE TURN ON, IF NO TRAFFIC STAGING IS IN PLACE OR WILL NOT BE STAGED ON THE DAY OF THE TURN ON.
- IF EXISTING MAST ARMS ARE IN CONFLICT WITH THE TEMPORARY TRAFFIC SIGNAL, THE MAST ARMS SHALL BE ROTATED TO ELIMINATE THE CONFLICT. THE COST OF THIS WORK IS INCLUDED IN THE COST OF THE TEMPORARY TRAFFIC SIGNAL INSTALLATION.

EXISTING EQUIPMENT LEGEND

- EXISTING SIGNAL HEAD
- EXISTING SERVICE INSTALLATION
- EXISTING SIGNAL POST AND FOUNDATION
- EXISTING ALUMINUM MAST ARM POLE AND FOUNDATION
- EXISTING CONTROLLER AND FOUNDATION
- EXISTING HANDHOLE
- EXISTING DOUBLE HANDHOLE
- EXISTING PEDESTRIAN SIGNAL HEAD
- EXISTING PEDESTRIAN PUSH-BUTTON
- EXISTING HEAVY-DUTY HANDHOLE
- EXISTING STEEL MAST ARM POLE AND FOUNDATION

NOTE:
 ALL EXISTING TRAFFIC SIGNAL EQUIPMENT IS TO REMAIN IN PLACE UNLESS NOTED OTHERWISE.

TS-29 OF 39

TEMPORARY TRAFFIC SIGNAL LEGEND

- TEMPORARY TRAFFIC SIGNAL HEAD, SPAN WIRE MOUNTED
- TEMPORARY WOOD POLE (CLASS 5 OR BETTER) 45 FOOT MINIMUM
- TEMPORARY CONTROLLER CABINET
- TEMPORARY UNINTERRUPTIBLE POWER SUPPLY
- TEMPORARY SPAN WIRE, TETHER WIRE, AND CABLE
- TEMPORARY SERVICE INSTALLATION
- TEMPORARY PEDESTRIAN SIGNAL HEAD, BRACKET MOUNTED
- VIDEO VEHICLE DETECTOR
- PEDESTRIAN PUSH-BUTTON DETECTOR
- EMERGENCY VEHICLE LIGHT DETECTOR
- CONFIRMATION BEACON
- GROUND ROD AT TEMPORARY CONTROLLER CABINET

REVISIONS	
NAME	DATE

ILLINOIS DEPARTMENT OF TRANSPORTATION

TEMPORARY TRAFFIC SIGNAL INSTALLATION
 MILWAUKEE AVENUE (ILL RTE 21)
 AT SANDERS ROAD

SCALE: 1" = 20'
 DATE: 02/05/08

DRAWN BY: RAS
 DESIGN BY: RAS
 CHECKED BY: ADD

SPAN Tech, Inc.

311 S. Wacker Drive, Suite 2400
 Chicago, Illinois 60606

phone: 312.277.8800
 fax: 312.277.8808
 web: www.SpanTech.com

07167.000 - ILL Rte 21 - IDOT Dist 1
 07167.000 - ILL Rte 21 - IDOT Dist 1
 p:\07167.000 - ILL Rte 21 - IDOT Dist 1\Working Files\Drawing Files\ts\ts-29.dgn
 20.0000 ft / in.
 12:59:52 PM
 1/30/2008